

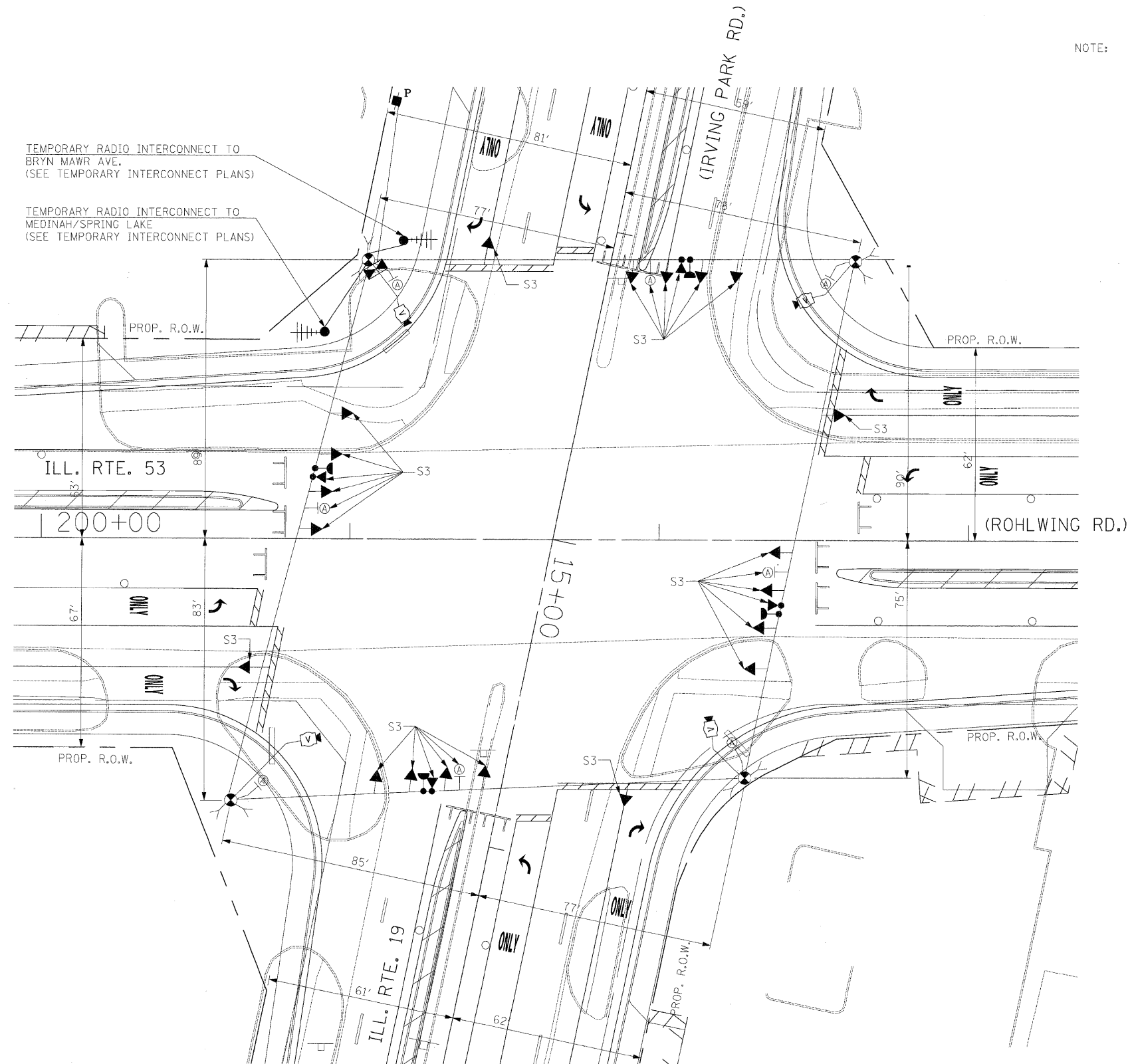

NOTE: THE VIDEO DETECTION ZONES SHOWN ON THE PLANS ARE FOR CONSTRUCTION STAGE 1 - SUBSTAGE 1 AND SHALL BE REDEFINED FOR EACH CONSTRUCTION STAGE AS A PART OF "TEMPORARY TRAFFIC SIGNAL INSTALLATION" WORK.



SIGNAL HEAD PLACEMENTS FOR STAGE S3

Ⓐ
LEFT ON GREEN ARROW ONLY
 R10-5 SIGNS SHALL BE MOUNTED, ONE EACH ON SPAN WIRE AND FAR LEFT POLE FOR ALL APPROACHES OF THE INTERSECTION
 R10-5,
 24" X 30"
 (8 REQUIRED)

THE TRAFFIC SIGNAL CONTROL EQUIPMENT FOR THIS PROJECT SHALL BE "ECONOLITE" TO MATCH THE EXISTING ADJACENT SYSTEM.

FILE NAME = #FILE#	USER NAME = #USER#	DESIGNED - PKG	REVISED -	STATE OF ILLINOIS DEPARTMENT OF TRANSPORTATION	TEMPORARY TRAFFIC SIGNAL INSTALLATION AND REMOVAL PLAN ILLINOIS ROUTE 53 (ROHLWING RD.) AT ILL. RTE. 19 (IRVING PARK RD) STAGE 3 (SHEET 4 OF 5)			F.A.P. RTE. 2578	SECTION 532B	COUNTY DuPage	TOTAL SHEETS 781	SHEET NO. 480
	PLOT SCALE = #SCALE#	DRAWN - MAA, EA	REVISED -		SCALE:	SHEET NO.	OF SHEETS	STA.	TO STA.	CONTRACT NO. 60477		
	PLOT DATE = #DATE#	CHECKED - PKG, EA	REVISED -							FED. ROAD DIST. NO. - [ILLINOIS] FED. AID PROJECT		
		DATE - 5/10/2010	REVISED -									