

THE TRAFFIC SIGNAL CONTROL EQUIPMENT FOR THIS PROJECT SHALL BE "ECONOLITE" TO MATCH THE EXISTING ADJACENT SYSTEM.

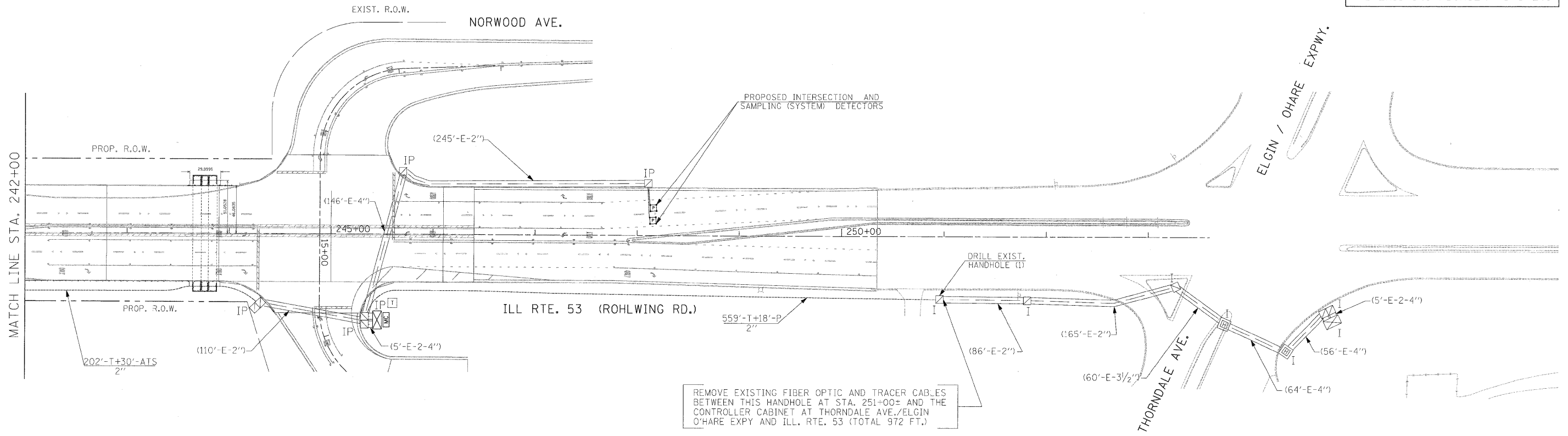

FILE NAME = \$FILEL\$	USER NAME = \$USER\$	DESIGNED - PKG	REVISED -	STATE OF ILLINOIS DEPARTMENT OF TRANSPORTATION	PROPOSED INTERCONNECT PLAN ILL. RTE. 53 (ROHLWING RD.) FROM NORDIC RD./BLOOMINGDALE RD. TO ELGIN-O'HARE EXPWY/THORNDALE AVE. (SHEET 4 OF 4)			F.A.P. RTE. 2578	SECTION 532B	COUNTY DuPage	TOTAL SHEETS 781	SHEET NO. 545
	PLOT SCALE = \$SCALE\$	DRAWN - MAA, EA	REVISED -		SCALE: 1"=50'	SHEET NO.	OF	SHEETS	STA.	TO STA.	CONTRACT NO. 60477	
	PLOT DATE = \$DATE\$	CHECKED - PKG, EA	REVISED -		FED. ROAD DIST. NO. [ILLINOIS] FED. AID PROJECT							
		DATE - 5/10/2010	REVISED -									