

NOTES:

1. ALL LIGHT POLE SETBACKS SHOWN ARE MEASURED FROM THE BACK OF CURB, UNLESS STATED OTHERWISE. IF THERE IS NO CURB, THE SETBACK WILL BE MEASURED FROM THE EDGE OF TRAVELLED PAVEMENT.
2. RESTORATION OF WORK AREA - RESTORATION OF LIGHTING WORK AREA SHALL BE INCIDENTAL TO THE RELATED PAY ITEM SUCH AS FOUNDATION, CONDUIT, HANDHOLE, ETC. AND NO EXTRA COMPENSATION SHALL BE ALLOWED. ALL ROADWAY SURFACES SUCH AS SHOULDERS, MEDIANS, SIDEWALKS, PAVEMENT, ETC. SHALL BE REPLACED IN KIND. ALL DAMAGE TO MOWED LAWNS SHALL BE REPLACED WITH AN APPROVED SOD AND ALL DAMAGE TO UNMOWED FIELD, SHALL BE SEEDING IN ACCORDANCE WITH STANDARD SPECIFICATIONS 252 AND 250 RESPECTIVELY.
3. THE CONTRACTOR SHALL CONNECT ELECTRIC SERVICE CABLES FROM COMED SERVICE POLE TO LIGHTING CONTROLLER. CONTRACTOR SHALL COORDINATE SERVICE INSTALLATION WITH COMED AS SOON AS POSSIBLE TO AVOID ANY DELAYS.

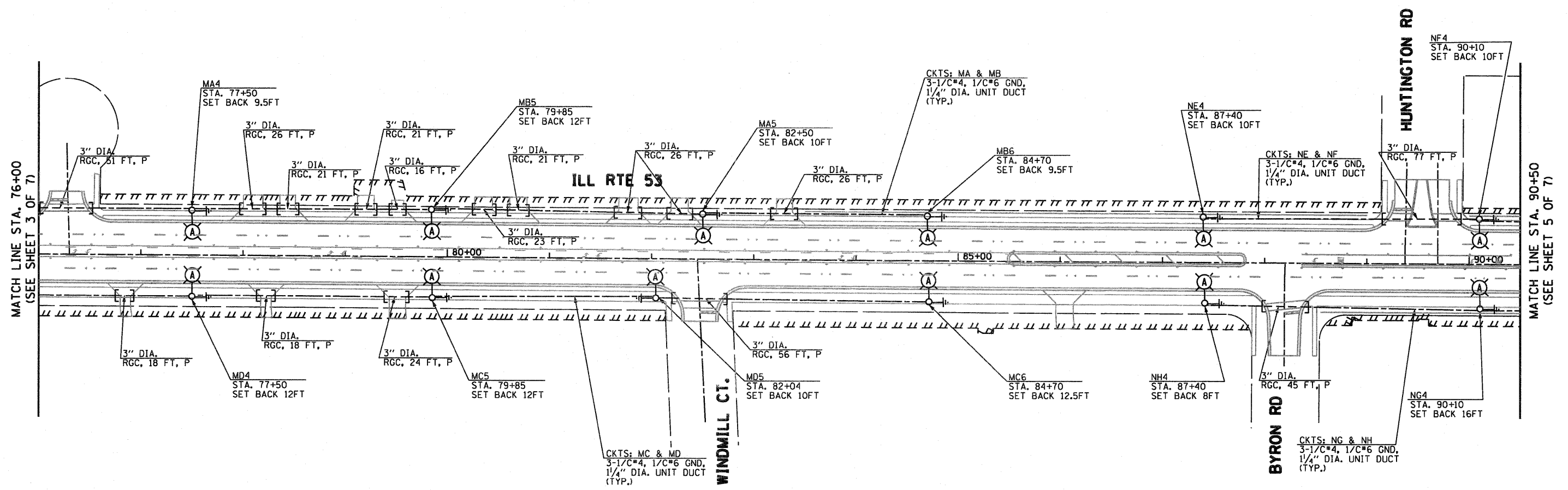
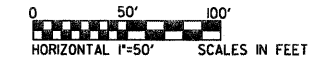

ga GANDHI AND ASSOCIATES, INC.
 ENGINEERS AND PLANNERS
 6035 N. NORTHWEST HIGHWAY
 SUITE 306
 CHICAGO, ILLINOIS 60631 TEL. 773/774-5910

FILE NAME =	USER NAME = _GAL	DESIGNED - PKG	REVISED -	STATE OF ILLINOIS DEPARTMENT OF TRANSPORTATION	PROPOSED LIGHTING PLAN (SHEET 4 OF 7)			F.A.P. RTE.	SECTION	COUNTY	TOTAL SHEETS	SHEET NO.
#FILE#		DRAWN - MAA, SHM	REVISED -		ILL. RTE. 53 FROM MITCHELL CT. TO US RTE. 20 (LAKE ST.)			2578	532B	DuPage	781	559
	PLOT SCALE = 1"=50'	CHECKED - PKG	REVISED -		SCALE: 1"= 50'	SHEET NO.	OF SHEETS	STA.	TO STA.	CONTRACT NO. 60477		
	PLOT DATE = 2/25/2011	DATE -	REVISED -		<small>FED. ROAD DIST. NO. 1 ILLINOIS FED. AID PROJECT</small>							