

|               |  |
|---------------|--|
| DATE          |  |
| BY            |  |
| FINAL SURVEY  |  |
| PLOTTED       |  |
| NOTE BOOK     |  |
| NO.           |  |
| AREAS CHECKED |  |

|                 |  |
|-----------------|--|
| DATE            |  |
| BY              |  |
| ORIGINAL SURVEY |  |
| PLOTTED         |  |
| NOTE BOOK       |  |
| NO.             |  |
| AREAS CHECKED   |  |

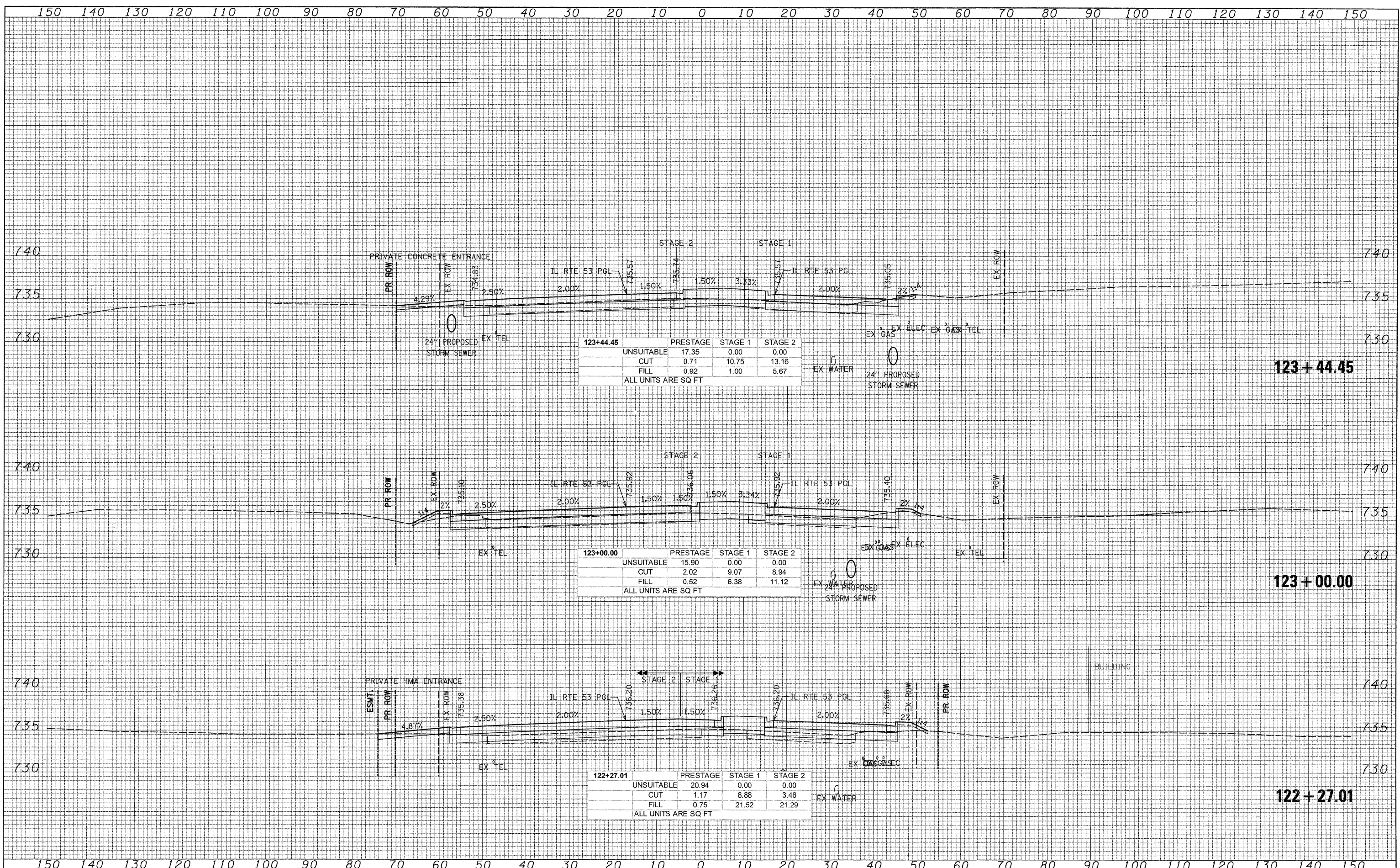

|  |  |  |  |   |   |  |
|--|--|--|--|---|---|--|
| <b>PATRICK ENGINEERING INC.</b><br>4970 VARSITY DRIVE<br>LISLE, IL 60532<br>patrickengineering.com | USER NAME = tkoeppen(Rdwy.Lis1e)<br>PLOT SCALE = 10.0000' / IN.<br>PLOT DATE = 12/3/2010 | DESIGNED -<br>DRAWN -<br>CHECKED -<br>DATE - 12/3/2010 | REVISED -<br>REVISED -<br>REVISED -<br>REVISED - | <b>STATE OF ILLINOIS</b><br><b>DEPARTMENT OF TRANSPORTATION</b> | <b>ILLINOIS ROUTE 53</b><br><b>CROSS SECTIONS</b> | F.A.U. RTE. 2578<br>SECTION 532B<br>COUNTY DUPAGE<br>TOTAL SHEETS 781<br>SHEET NO. 699<br>CONTRACT NO. 60477 |
|  | SCALE: 1"=10' HORIZ. 1"=5' VERT. SHEET NO. STA. 122+27.01 TO STA. 123+44.45              |  | FED. ROAD DIST. NO. ILLINOIS FED. AID PROJECT    |   |   |  |

G:\100T\9356\_A0\_(IL53)\Drawings\CADD Sheets\019139797-ah-t-xasht-657-748.dgn