

G-G

STAGE 1: CENTRAL AVENUE; STA. 17+00

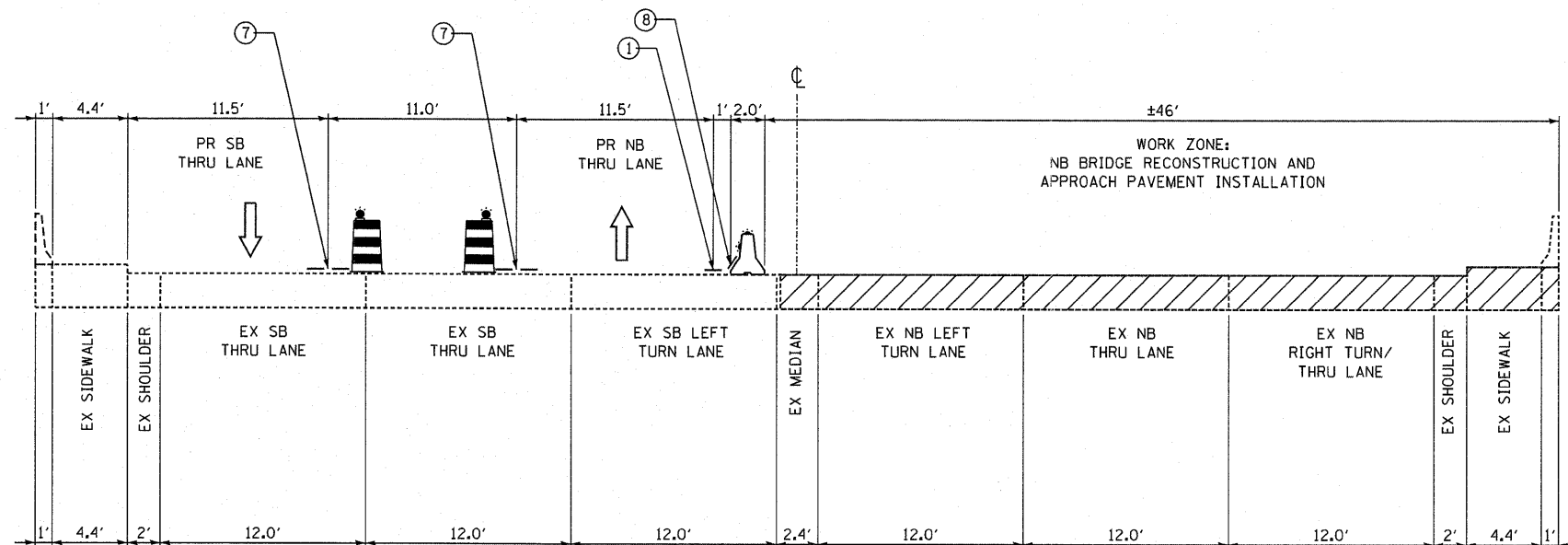

H-H

STAGE 1: CENTRAL AVENUE; STA. 23+00

LEGEND

- ↑ TRAFFIC MOVEMENT
- PROPOSED TEMPORARY CONCRETE BARRIER (WITH MONO-DIRECTIONAL PRISMATIC REFLECTORS ON TOP AND SIDE FACING TRAFFIC)
- WORK ZONE
- DRUM WITH MONO-DIRECTIONAL STEADY BURNING LIGHT

NOTES:

1. WET REFLECTIVE TEMPORARY TAPE TYPE III, 4" LINE (WHITE)
2. WET REFLECTIVE TEMPORARY TAPE TYPE III, 5" SKIP-DASH (WHITE) 10' LINE WITH 30' SPACE
3. WET REFLECTIVE TEMPORARY TAPE TYPE III, 4" LINE (YELLOW)
4. WET REFLECTIVE TEMPORARY PAVEMENT MARKING-LINE 6" (WHITE)
5. WET REFLECTIVE TEMPORARY PAVEMENT MARKING-LINE 6" (YELLOW)
6. WET REFLECTIVE TEMPORARY TAPE TYPE III, 4" SKIP-DASH (WHITE) 10' LINE WITH 30' SPACE
7. WET REFLECTIVE TEMPORARY TAPE TYPE III, 4" DOUBLE YELLOW CENTERLINE AT 11" C-C
8. TEMPORARY PAVEMENT MARKING - LINE 6"
9. EXISTING PAVEMENT MARKING LINE 4" (WHITE)
10. POLYUREA PAVEMENT MARKING TYPE I - LINE 4" (WHITE)
11. POLYUREA PAVEMENT MARKING TYPE I - LINE 6" (WHITE)
12. POLYUREA PAVEMENT MARKING TYPE I - 4" DOUBLE YELLOW CENTERLINE AT 11" C-C

TYLIN INTERNATIONAL	USER NAME = #USER#	DESIGNED - RLB	REVISED - 05/13/2011 RLD	STATE OF ILLINOIS DEPARTMENT OF TRANSPORTATION	CENTRAL AVENUE OVER I-55 MAINTENANCE OF TRAFFIC - PROPOSED TYPICAL SECTION STAGE 1			F.A.I. RTE.	SECTION	COUNTY	TOTAL SHEETS	SHEET NO.
	PLOT SCALE = #SCALE#	DRAWN - RLB	REVISED -		1-55	0711.2R & 1011.LBR	COOK	741	30			
	PLOT DATE = 5/13/2011	CHECKED - AZ	REVISED -		CONTRACT NO. 60999			FED. ROAD DIST. NO.	ILLINOIS FED. AID PROJECT			
				SCALE: NONE	SHEET NO. 3 OF 5 SHEETS	STA.	TO STA.					