

**LEGEND**

- CONSTRUCTION ZONE
- TRAFFIC MOVEMENT
- SIGN
- ARROW BOARD
- TYPE II BARRICADES OR DRUMS WITH MONO-DIRECTIONAL STEADY BURNING LIGHT
- TYPE III BARRICADE WITH MONO-DIRECTIONAL STEADY BURNING LIGHTS
- BARRICADE OR DRUM

**NOTES:**

1. TRUCKS WITH TRAILERS 48' IN LENGTH AND OVER ARE RESTRICTED FROM MAKING THE NORTHBOUND LEFT TURN FROM RAMP 1. SEE DETOUR PLAN.
2. THE "NO TURNS" SIGNS SHALL BE MOUNTED ON THE TEMPORARY TRAFFIC SIGNALS AND THE AERIALY SUSPENDED CABLE.
3. ORANGE SAFETY FENCE SHALL BE PLACED IN ACCORDANCE WITH STANDARD 701801.

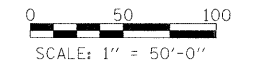
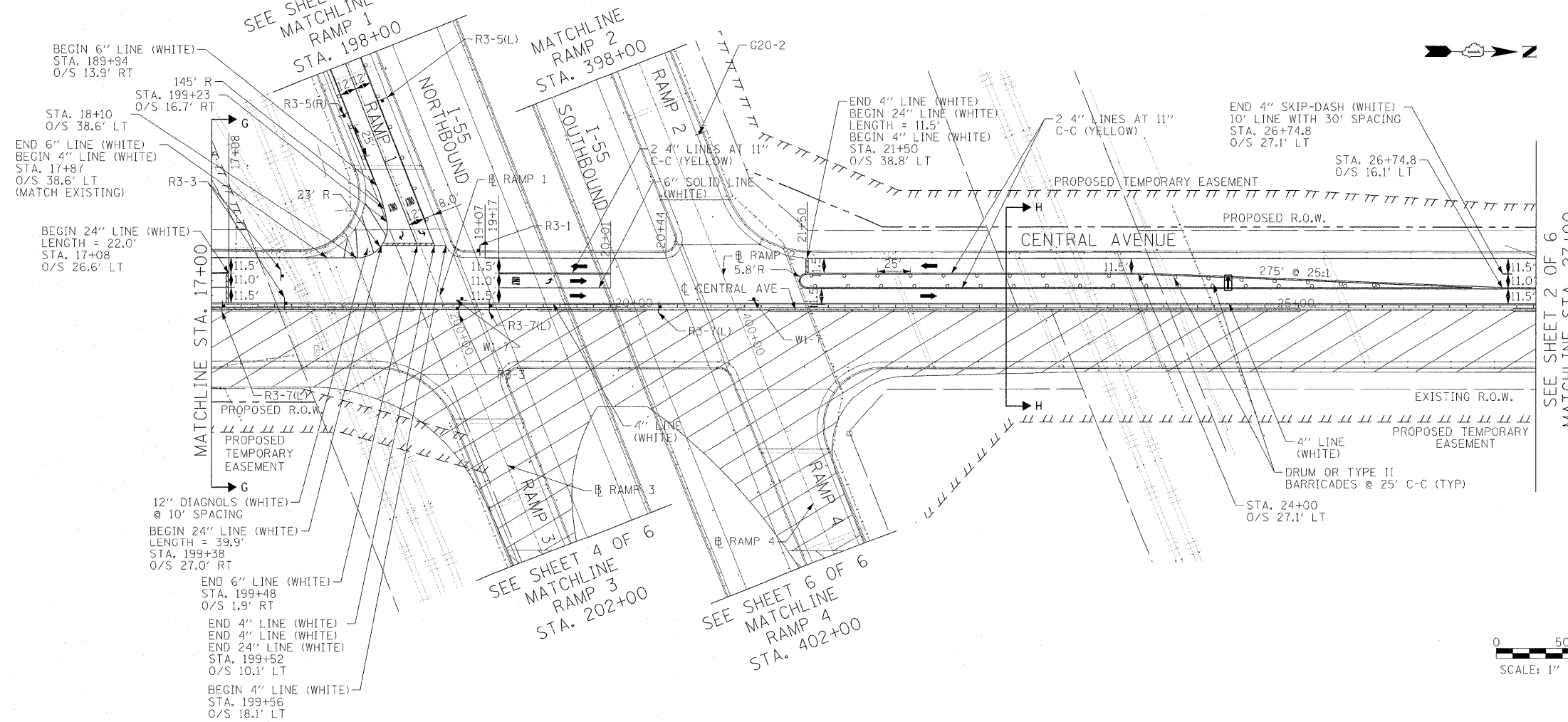
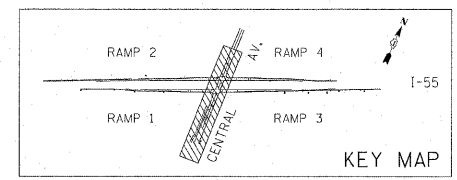

<b>TYLIN INTERNATIONAL</b>	USER NAME = #USER#	DESIGNED - RLB	REVISED - 05/13/2011 AZ	<b>STATE OF ILLINOIS DEPARTMENT OF TRANSPORTATION</b>	<b>CENTRAL AVENUE OVER I-55 MAINTENANCE OF TRAFFIC - STAGE 1 - CENTRAL AVENUE</b>		F.A.I. RTE. 1-55	SECTION 0711.2R & 1011.1BR	COUNTY COOK	TOTAL SHEETS 741	SHEET NO. 35	
	PLOT SCALE = #SCALE#	CHECKED - JDF	REVISED -		SCALE: 1:50	SHEET NO. 1 OF 6 SHEETS	STA. TO STA. 27+00	FED. ROAD DIST. NO.	ILLINOIS FED. AID PROJECT	CONTRACT NO. 60999		
	PLOT DATE = 5/13/2011	DATE - 03/25/2011	REVISED -									