

p:\01345\road\55motML21a.dgn 1:23:05 PM 4/28/2011

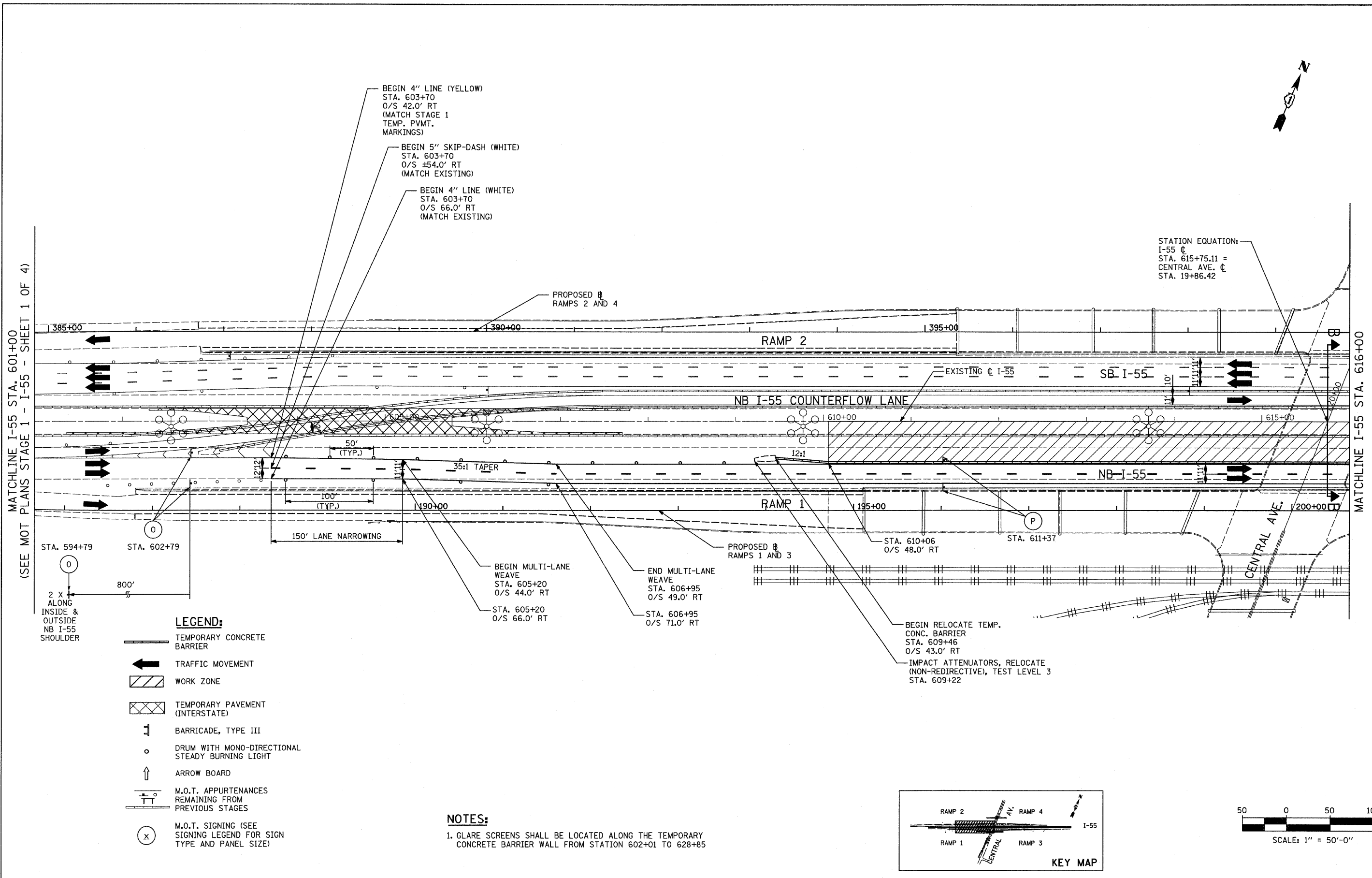

MATCHLINE I-55 STA. 601+00
(SEE MOT PLANS STAGE 1 - I-55 - SHEET 1 OF 4)

MATCHLINE I-55 STA. 616+00

BEGIN 4" LINE (YELLOW)
STA. 603+70
O/S 42.0' RT
(MATCH STAGE 1
TEMP. PVMT.
MARKINGS)

BEGIN 5" SKIP-DASH (WHITE)
STA. 603+70
O/S ±54.0' RT
(MATCH EXISTING)

BEGIN 4" LINE (WHITE)
STA. 603+70
O/S 66.0' RT
(MATCH EXISTING)

PROPOSED RAMP 2 AND 4

STATION EQUATION:
I-55 CL
STA. 615+75.11 =
CENTRAL AVE. CL
STA. 19+86.42

2 X
ALONG
INSIDE &
OUTSIDE
NB I-55
SHOULDER

- LEGEND:**
- TEMPORARY CONCRETE BARRIER
 - TRAFFIC MOVEMENT
 - WORK ZONE
 - TEMPORARY PAVEMENT (INTERSTATE)
 - BARRICADE, TYPE III
 - DRUM WITH MONO-DIRECTIONAL STEADY BURNING LIGHT
 - ARROW BOARD
 - M.O.T. APPURTENANCES REMAINING FROM PREVIOUS STAGES
 - M.O.T. SIGNING (SEE SIGNING LEGEND FOR SIGN TYPE AND PANEL SIZE)

NOTES:

1. GLARE SCREENS SHALL BE LOCATED ALONG THE TEMPORARY CONCRETE BARRIER WALL FROM STATION 602+01 TO 628+85

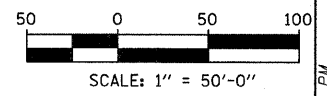
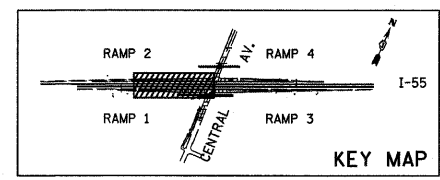

TYLIN INTERNATIONAL	USER NAME = #USER#	DESIGNED - JDF	REVISED -	STATE OF ILLINOIS DEPARTMENT OF TRANSPORTATION	CENTRAL AVENUE OVER I-55 MAINTENANCE OF TRAFFIC PLANS STAGE 1A - I-55			F.A.I. RTE. I-55	SECTION 0711.2R & 1011.1BR	COUNTY COOK	TOTAL SHEETS 741	SHEET NO. 82
	PLOT SCALE = #SCALE#	DRAWN - JDF	REVISED -		SCALE: 1" = 50'			SHEET NO. 1 OF 2 SHEETS			CONTRACT NO. 60999	
	PLOT DATE = 4/28/2011	CHECKED - JPM	REVISED -		STA. 601+00 TO STA. 616+00			FED. ROAD DIST. NO. [ILLINOIS] FED. AID PROJECT				
		DATE - 03/25/2011	REVISED -									