

PLAN SURVEYED BY DATE
 NOTE BOOK NO. CHECKED BY
 RT. OF WAY CHECKED BY
 JOB FILE NAME

PROFILE SURVEYED BY DATE
 NOTE BOOK NO. CHECKED BY
 GRADES CHECKED BY
 B.M. NOTED BY
 STRUCTURE NOTATIONS CHFD

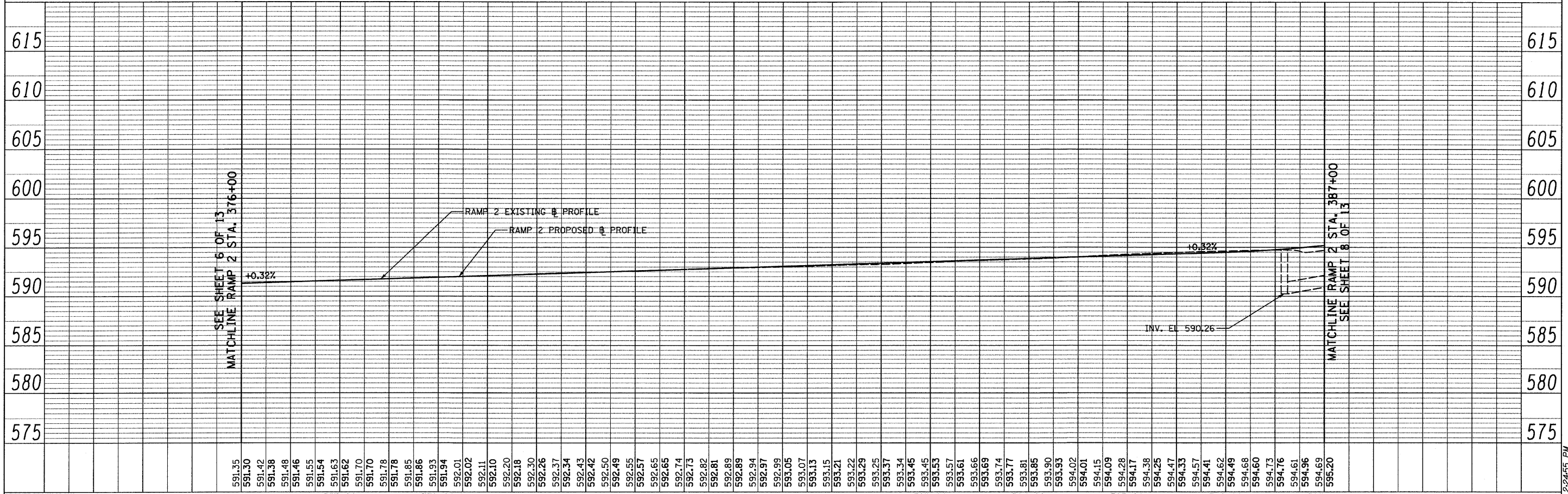
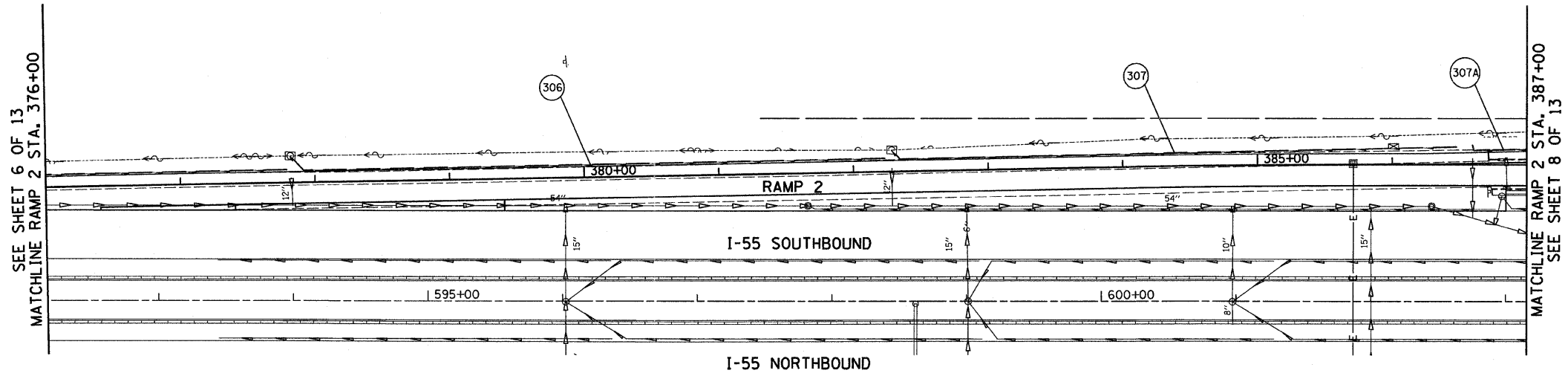
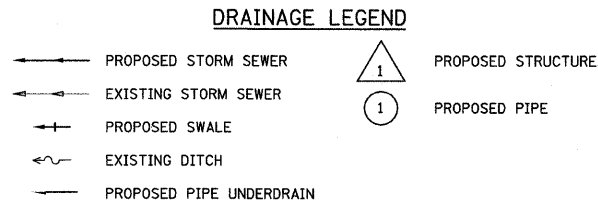
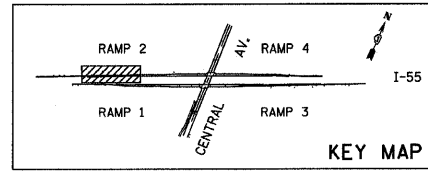

TYLIN INTERNATIONAL	USER NAME = #USER#	DESIGNED - MR	REVISED -	STATE OF ILLINOIS DEPARTMENT OF TRANSPORTATION	CENTRAL AVENUE OVER I-55 DRAINAGE PLAN AND PROFILE, I-55 - RAMP 2		F.A.I. RTE. 55	SECTION 0711.2R & 1011.1BR	COUNTY COOK	TOTAL SHEETS 741	SHEET NO. 143
	PLOT SCALE = #SCALE#	DRAWN - MR	REVISED -		SCALE: HOR: 1"=50'	SHEET NO. 7 OF 13 SHEETS	STA. 376+00.00 TO STA. 387+00.00	FED. ROAD DIST. NO. ILLINOIS FED. AID PROJECT		CONTRACT NO. 60999	
	PLOT DATE = 4/28/2011	CHECKED - AZ	REVISED -		SCALE: VER: 1"=5'						
		DATE - 03/25/2011	REVISED -								

P:\01345\ROAD\55drpp21.dgn

P:\01345\ROAD\55drpp21.dgn 2:24:55 PM 4/28/2011