

STATE OF ILLINOIS  
DEPARTMENT OF TRANSPORTATION

**Stage I:**  
Construction of east half of the new SPUI. This includes the widening and rehabilitation of the northbound lanes of the Central Ave. Bridge (main line) and removal and reconstruction of Ramps 3 and 4. Central Ave. will remain open with one lane of traffic maintained in each direction, using southbound lanes. Ramps 1 and 2 will also remain open, and a left turn lane will be maintained along northbound Central Ave. for access to westbound I-55 (Ramp 2).

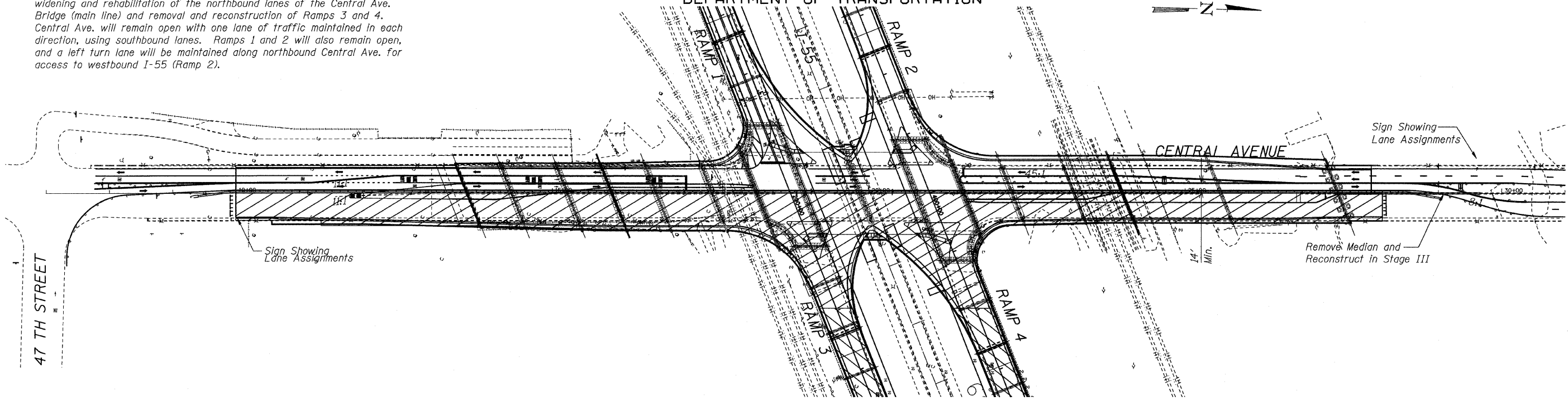

**Stage II:**  
Construction of west half of the new SPUI. This includes the rehabilitation of the southbound lanes of Central Ave. Bridge (main line) and removal and reconstruction of Ramps 1 and 2. Central Ave. will remain open with one lane of traffic maintained in each direction, using the newly reconstructed southbound lanes. Ramps 3 and 4 will be open to traffic at the beginning of this stage, with Ramps 1 and 2 being closed at that time. At no time will all four of the interchange ramps be closed simultaneously. A left turn lane will be maintained along Central Ave. for access to the eastbound ramp (Ramp 3).

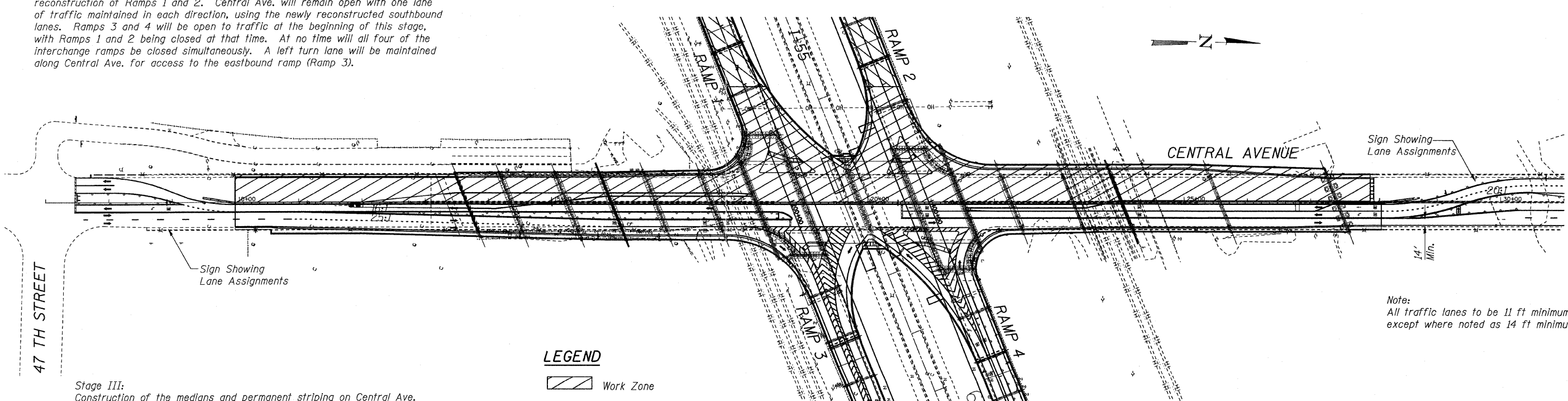

**Stage III:**  
Construction of the medians and permanent striping on Central Ave. within the geometric limits of the SPUI. The two center lanes along Central Ave. will be closed during this stage. Only one through lane in each direction will be available. Auxiliary left (one) lane and right turn lanes will be in place for Stage III operations; phasing will be adjusted on the reduced number of lanes available.

- LEGEND**
- Work Zone
  - Travel Lanes
  - Pavement Marking
  - Barricades

Note:  
All traffic lanes to be 11 ft minimum width except where noted as 14 ft minimum.

**OVERALL STAGE  
CONSTRUCTION**  
SN 016-0724, SN 016-3240  
& SN 016-3241

**TYLIN INTERNATIONAL**

DESIGNED - MI	REVISIONS	
	NAME	DATE
CHECKED - AMD,TD		
DRAWN - PL, CS		
CHECKED - AMD, MI, TD		
DATE - 03/25/2011		

SHEET NO. 3	F.A.I. RTE.	SECTION	COUNTY	TOTAL SHEETS	SHEET NO.
	55	0711.2R & 1011.1BR	COOK	741	253
3 SHEETS			CONTRACT NO. 60999		
FED. ROAD DIST. NO. 1 ILLINOIS FED. AID PROJECT					

7:24:06 PM  
pi:\01345\structure\155const\tdan  
4/28/2011