

STATE OF ILLINOIS  
DEPARTMENT OF TRANSPORTATION

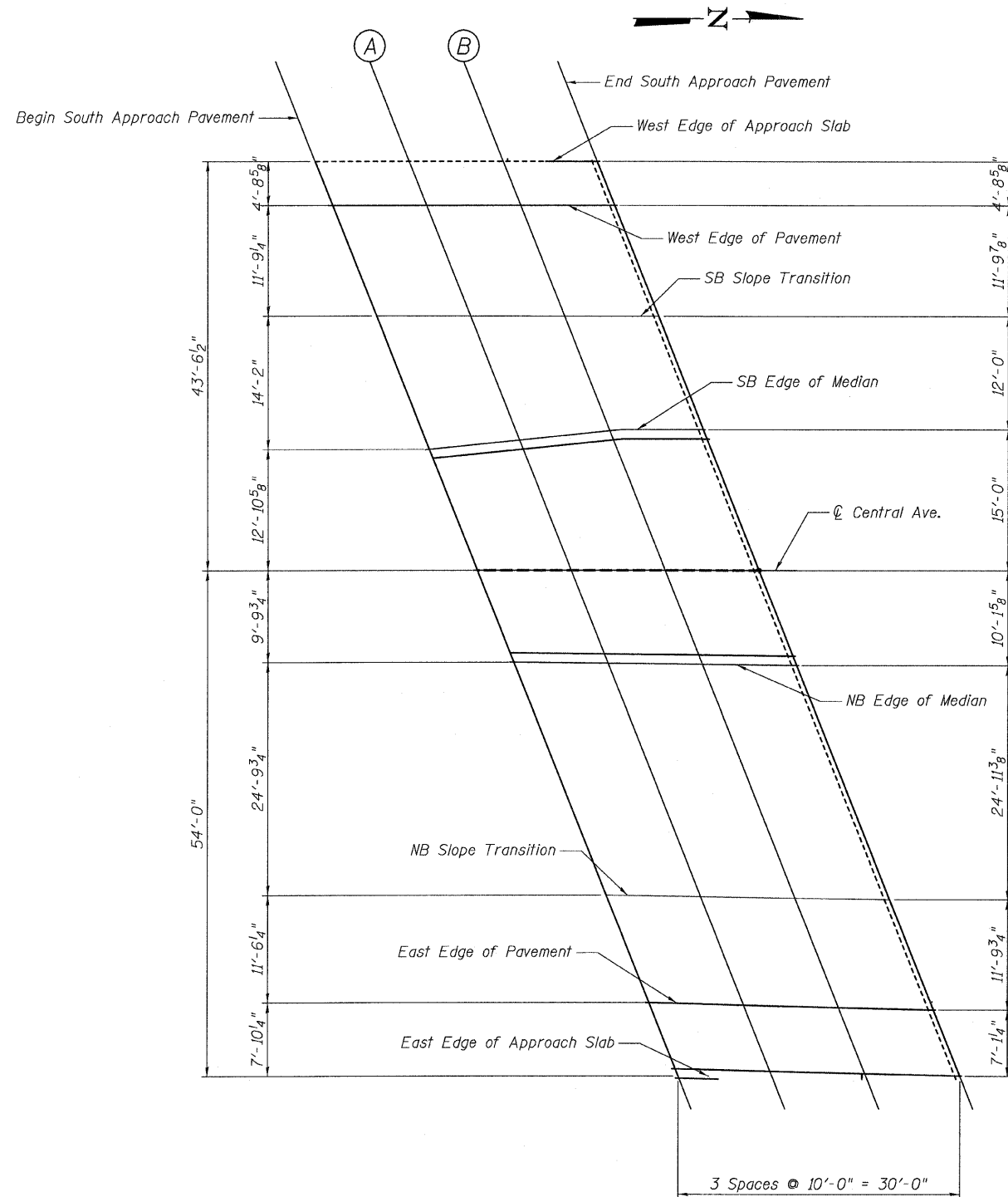

**WEST EDGE OF APPROACH SLAB**

Location	Station	Offset	Theoretical Grade Elevations
Begin S. Appr. Pav't	13+16.35	-43.54	612.20
A	13+26.35	-43.54	612.55
B	13+36.35	-43.54	612.90
End S. Appr. Pav't	13+46.35	-43.54	613.25

**N.B. EDGE OF MEDIAN**

Location	Station	Offset	Theoretical Grade Elevations
Begin S. Appr. Pav't	13+37.54	9.81	611.88
A	13+47.58	9.92	612.23
B	13+57.62	10.03	612.58
End S. Appr. Pav't	13+67.67	10.14	612.93

**WEST EDGE OF PAVEMENT**

Location	Station	Offset	Theoretical Grade Elevations
Begin S. Appr. Pav't	13+18.23	-38.82	612.18
A	13+28.23	-38.82	612.53
B	13+38.23	-38.82	612.88
End S. Appr. Pav't	13+48.23	-38.82	612.23

**N.B. SLOPE TRANSITION**

Location	Station	Offset	Theoretical Grade Elevations
Begin S. Appr. Pav't	13+47.39	34.62	611.77
A	13+57.45	34.78	612.12
B	13+67.51	34.93	612.46
End S. Appr. Pav't	13+77.57	35.09	612.81

**S.B. SLOPE TRANSITION**

Location	Station	Offset	Theoretical Grade Elevations
Begin S. Appr. Pav't	13+22.90	-27.06	612.03
A	13+32.91	-27.04	612.38
B	13+42.92	-27.01	612.73
End S. Appr. Pav't	13+52.92	-27.00	613.08

**EAST EDGE OF PAVEMENT**

Location	Station	Offset	Theoretical Grade Elevations
Begin S. Appr. Pav't	13+51.96	46.14	611.66
A	13+62.06	46.39	612.01
B	13+72.16	46.65	612.36
End S. Appr. Pav't	13+82.26	46.90	612.72

**S.B. EDGE OF MEDIAN**

Location	Station	Offset	Theoretical Grade Elevations
Begin S. Appr. Pav't	13+28.52	-12.89	612.02
A	13+38.13	-13.88	612.35
B	13+47.74	-14.86	612.69
End S. Appr. Pav't	13+57.69	-15.00	613.04

**EAST EDGE OF APPROACH SLAB**

Location	Station	Offset	Theoretical Grade Elevations
Begin S. Appr. Pav't	13+55.08	54.00	611.61
A	13+65.08	54.00	611.96
B	13+75.08	54.00	612.31
End S. Appr. Pav't	13+85.08	54.00	612.66

**CENTRAL AVENUE P.G.L.**

Location	Station	Offset	Theoretical Grade Elevations
Begin S. Appr. Pav't	13+33.64	0.00	611.94
A	13+43.64	0.00	612.29
B	13+53.64	0.00	612.64
End S. Appr. Pav't	13+63.64	0.00	612.99

**TOP OF SOUTH APPROACH  
SLAB ELEVATIONS  
STRUCTURE NO. 016-3241**

<b>TYLIN INTERNATIONAL</b>	DESIGNED - EKH	REVISIONS	
	CHECKED - AMD,	NAME	DATE
	DRAWN - EKH		
	CHECKED - AMD,		
	DATE - 03/25/2011		

SHEET NO. 16	F.A.I. RTE.	SECTION	COUNTY	TOTAL SHEETS	SHEET NO.
	55	0711.2R & 1011.1BR	COOK	741	269
71 SHEETS	CONTRACT NO. 60999				
FED. ROAD DIST. NO. 1 ILLINOIS FED. AID PROJECT					

p:\01345\structure\01 South Approach 016-3241\55fcltseappr.dgn 11:29:46 AM 4/28/2011