

STATE OF ILLINOIS  
DEPARTMENT OF TRANSPORTATION

GIRDER G1.11

LOCATION	STATION	OFFSET	THEORETICAL GRADE ELEVATIONS	THEORETICAL GRADE ELEVATIONS ADJUSTED FOR DEAD LOAD DEFLECTIONS
℄ G1.8	198+67.89	24.00	625.32	625.34
F1	198+69.33	24.87	625.34	625.36
G1	198+79.33	30.91	625.45	625.47
H1	198+89.33	36.96	625.56	625.58
I1	198+99.33	43.01	625.68	625.68
℄ G22	199+04.78	46.30	625.73	625.73

GIRDER G1.12

LOCATION	STATION	OFFSET	THEORETICAL GRADE ELEVATIONS	THEORETICAL GRADE ELEVATIONS ADJUSTED FOR DEAD LOAD DEFLECTIONS
Bk. of R1 Abut.	197+33.33	-21.50	623.34	623.34
℄ Joint R1 Abut.	197+35.58	-21.50	623.38	623.38
℄ E. Brg.	197+36.33	-21.50	623.40	623.40
R1 Abut.				
U	197+46.33	-21.84	623.60	623.61
V	197+56.33	-22.47	623.81	623.82
W	197+66.33	-23.34	624.02	624.03
X	197+76.33	-24.44	624.23	624.24
Y	197+86.33	-25.77	624.45	624.46
Z	197+96.33	-27.35	624.67	624.67
A1	198+06.33	-29.16	624.89	624.89
B1	198+16.33	-31.22	625.12	625.12
C1	198+26.33	-33.52	625.35	625.35
℄ R1 Pier	198+39.33	-36.89	625.65	625.66
D1	198+49.33	-39.77	625.87	625.90
E1	198+59.33	-42.92	626.10	626.15
F1	198+69.33	-46.34	626.32	626.39
G1	198+79.33	-50.03	626.53	626.62
H1	198+89.33	-54.01	626.75	626.85
I1	198+99.33	-58.27	626.96	627.07
J1	199+09.33	-62.84	627.18	627.29
K1	199+19.33	-67.71	627.39	627.49
L1	199+29.33	-72.91	627.60	627.68
M1	199+39.33	-78.45	627.79	627.86
N1	199+49.33	-84.34	627.98	628.01
℄ G22	199+59.06	-90.42	628.15	628.16

GIRDER G1.13

LOCATION	STATION	OFFSET	THEORETICAL GRADE ELEVATIONS	THEORETICAL GRADE ELEVATIONS ADJUSTED FOR DEAD LOAD DEFLECTIONS
℄ FB-1.2	199+38.38	-73.50	627.75	627.81
M1	199+38.33	-73.50	627.76	627.82
N1	199+49.33	-73.50	627.91	627.94
℄ G22	199+52.34	-73.50	627.95	627.97

GIRDER G1.15

LOCATION	STATION	OFFSET	THEORETICAL GRADE ELEVATIONS	THEORETICAL GRADE ELEVATIONS ADJUSTED FOR DEAD LOAD DEFLECTIONS
℄ FB-1.4	199+11.38	-60.50	627.19	627.30
K1	199+19.33	-60.50	627.32	627.42
L1	199+29.33	-60.50	627.48	627.56
M1	199+39.33	-60.50	627.65	627.70
℄ G22	199+47.18	-60.50	627.78	627.80

P.G.L. RAMP 1 FLARE

LOCATION	STATION	OFFSET	THEORETICAL GRADE ELEVATIONS	THEORETICAL GRADE ELEVATIONS ADJUSTED FOR DEAD LOAD DEFLECTIONS
Bk. of R1 Abut.	197+33.33	0.00	623.02	623.02
℄ Joint R1 Abut.	197+35.58	0.00	623.06	623.06
℄ E. Brg.	197+36.33	0.00	623.08	623.08
R1 Abut.				
U	197+46.33	0.00	623.27	623.31
V	197+56.33	0.00	623.47	623.53
W	197+66.33	0.00	623.67	623.75
X	197+76.33	0.00	623.86	623.96
Y	197+86.33	0.00	624.06	624.16
Z	197+96.33	0.00	624.26	624.35
A1	198+06.33	0.00	624.45	624.53
B1	198+16.33	0.00	624.65	624.71
C1	198+26.33	0.00	624.85	624.88
℄ R1 Pier	198+39.33	0.00	625.10	625.12
D1	198+49.33	0.00	625.30	625.31
E1	198+59.33	0.00	625.49	625.51
F1	198+69.33	0.00	625.69	625.71
G1	198+79.33	0.00	625.89	625.91
H1	198+89.33	0.00	626.08	626.11
I1	198+99.33	0.00	626.28	626.31
J1	199+09.33	0.00	626.48	626.50
K1	199+19.33	0.00	626.67	626.69
℄ G22	199+23.16	0.00	626.75	626.76

GIRDER G1.17

LOCATION	STATION	OFFSET	THEORETICAL GRADE ELEVATIONS	THEORETICAL GRADE ELEVATIONS ADJUSTED FOR DEAD LOAD DEFLECTIONS
℄ FB-1.6	198+81.39	-47.50	626.54	626.64
H1	198+89.33	-47.50	626.67	626.78
I1	198+99.33	-47.50	626.84	626.96
J1	199+09.33	-47.50	627.02	627.13
K1	199+19.33	-47.50	627.19	627.28
L1	199+29.33	-47.50	627.36	627.43
M1	199+39.33	-47.50	627.53	627.57
℄ G22	199+42.02	-47.50	627.58	627.60

GIRDER G1.14

LOCATION	STATION	OFFSET	THEORETICAL GRADE ELEVATIONS	THEORETICAL GRADE ELEVATIONS ADJUSTED FOR DEAD LOAD DEFLECTIONS
℄ FB-1.3	199+26.38	-67.00	627.49	627.58
L1	199+29.33	-67.00	627.54	627.62
M1	199+39.33	-67.00	627.70	627.76
N1	199+49.33	-67.00	627.86	627.89
℄ G22	199+49.76	-67.00	627.87	627.89

GIRDER G1.16

LOCATION	STATION	OFFSET	THEORETICAL GRADE ELEVATIONS	THEORETICAL GRADE ELEVATIONS ADJUSTED FOR DEAD LOAD DEFLECTIONS
℄ FB-1.5	198+96.38	-54.00	626.87	626.98
I1	198+99.33	-54.00	626.92	627.03
J1	199+09.33	-54.00	627.09	627.19
K1	199+19.33	-54.00	627.25	627.35
L1	199+29.33	-54.00	627.42	627.49
M1	199+39.33	-54.00	627.59	627.63
℄ G22	199+44.60	-54.00	627.68	627.70

GIRDER G1.18

LOCATION	STATION	OFFSET	THEORETICAL GRADE ELEVATIONS	THEORETICAL GRADE ELEVATIONS ADJUSTED FOR DEAD LOAD DEFLECTIONS
℄ FB-1.7	198+66.39	-41.00	626.20	626.27
F1	198+69.33	-41.00	626.25	626.32
G1	198+79.33	-41.00	626.42	626.52
H1	198+89.33	-41.00	626.60	626.72
I1	198+99.33	-41.00	626.77	626.90
J1	199+09.33	-41.00	626.95	627.06
K1	199+19.33	-41.00	627.12	627.21
L1	199+29.33	-41.00	627.30	627.36
M1	199+39.33	-41.00	627.48	627.51
℄ G22	199+39.44	-41.00	627.48	627.50

GIRDER G1.19

LOCATION	STATION	OFFSET	THEORETICAL GRADE ELEVATIONS	THEORETICAL GRADE ELEVATIONS ADJUSTED FOR DEAD LOAD DEFLECTIONS
℄ FB-1.8	198+51.39	-34.50	625.84	625.87
E1	198+59.33	-34.50	625.98	626.02
F1	198+69.33	-34.50	626.16	626.22
G1	198+79.33	-34.50	626.34	626.42
H1	198+89.33	-34.50	626.52	626.60
I1	198+99.33	-34.50	626.70	626.78
J1	199+09.33	-34.50	626.88	626.95
K1	199+19.33	-34.50	627.06	627.11
L1	199+29.33	-34.50	627.24	627.27
℄ G22	199+36.86	-34.50	627.38	627.39

GIRDER G1.20

LOCATION	STATION	OFFSET	THEORETICAL GRADE ELEVATIONS	THEORETICAL GRADE ELEVATIONS ADJUSTED FOR DEAD LOAD DEFLECTIONS
℄ FB-1.9	198+24.39	-28.00	625.23	625.23
C1	198+26.33	-28.00	625.27	625.27
℄ R1 Pier	198+39.33	-28.00	625.52	625.52
D1	198+49.33	-28.00	625.70	625.72
E1	198+59.33	-28.00	625.89	625.92
F1	198+69.33	-28.00	626.07	626.11
G1	198+79.33	-28.00	626.26	626.31
H1	198+89.33	-28.00	626.44	626.49
I1	198+99.33	-28.00	626.62	626.67
J1	199+09.33	-28.00	626.81	626.85
K1	199+19.33	-28.00	626.99	627.02
L1	199+29.33	-28.00	627.18	627.19
℄ G22	199+34.28	-28.00	627.27	627.27

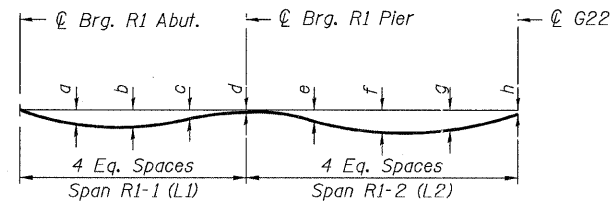

DEAD LOAD DEFLECTION DIAGRAM  
(Includes weight of concrete only.)

Note:

The above deflections are not to be used in the field if the engineer is working from the grade elevations adjusted for dead load deflections as shown above.

Girder	a	b	c	d	e	f	g	h	L1	L2
G1.1*	-	1/2"	1/8"	0	1/4"	1/2"	3/8"	0	60'-0"	92'-3 3/4"
G1.2	1/8"	1/8"	1/2"	0	1/8"	1/4"	1/4"	0	103'-0"	89'-8 3/4"
G1.3	1/8"	1/8"	1/2"	1/8"	1/4"	1/4"	1/4"	1/8"	103'-0"	87'-1 3/4"
G1.4	1/8"	1/8"	1/2"	1/8"	1/4"	3/8"	3/8"	1/8"	103'-0"	84'-6 1/8"
G1.5	1/8"	1/8"	1/2"	1/8"	1/4"	3/8"	3/8"	1/8"	103'-0"	81'-11 1/8"
G1.6	1/8"	1/8"	1/2"	1/8"	1/4"	3/8"	3/8"	1/4"	103'-0"	79'-4 1/8"
G1.7	1/8"	1/8"	1/2"	1/8"	1/4"	3/8"	3/8"	1/4"	103'-0"	76'-9 1/8"
G1.8	1/4"	1/8"	1/2"	0	1/8"	1/4"	3/8"	1/4"	103'-0"	74'-3 1/8"
G1.9	-	-	-	-	1/4"	-	1/8"	-	-	10'-9 3/8"
G1.10	-	-	-	-	3/8"	-	1/8"	-	-	21'-6 1/8"
G1.10A	-	-	-	-	3/8"	-	1/8"	-	-	32'-4"
G1.11	-	-	-	-	1/4"	1/4"	1/8"	0	-	43'-1 1/4"
G1.12	1/8"	1/8"	0	1/8"	1/8"	1/8"	1"	1/8"	104'-4 1/8"	131'-7 1/8"
G1.13	-	-	-	-	3/4"	-	1/8"	-	-	13'-11 1/2"
G1.14	-	-	-	-	1"	-	3/4"	-	-	23'-4 1/2"
G1.15	-	-	-	-	1 1/4"	1/8"	1"	5/8"	-	35'-9 1/2"
G1.16	-	-	-	-	1 3/8"	1 1/4"	1 1/8"	3/4"	-	48'-2 3/8"
G1.17	-	-	-	-	1 1/4"	1 3/8"	1 3/8"	1/4"	-	60'-7 5/8"
G1.18	-	-	-	-	3/4"	1 3/8"	1 1/2"	1"	-	73'-0 3/8"
G1.19	-	-	-	-	3/8"	7/8"	1"	3/4"	-	85'-5 3/8"
G1.20	-	-	-	-	0	3/8"	5/8"	1/2"	-	94'-10 3/4"

\* For G1.1 only, b is end of girder and c is midspan

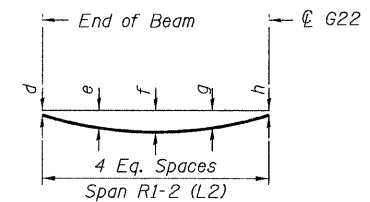

DEAD LOAD DEFLECTION DIAGRAM  
(Includes weight of concrete only.)

TOP OF SLAB ELEV. - 2  
RAMP 1 FLARE  
STRUCTURE NO. 016-0724

TYLIN INTERNATIONAL

DESIGNED	REVISIONS
JPM, EKH	
CHECKED - AMD,	NAME DATE
DRAWN - JPM, EKH	
CHECKED - AMD,	
DATE - 03/25/2011	

SHEET NO. 28	F.A.I RTE.	SECTION	COUNTY	TOTAL SHEETS	SHEET NO.
239 SHEETS	55	0711.2R & 1011.1BR	COOK	741	352
			CONTRACT NO. 60999		
FED. ROAD DIST. NO. 1 ILLINOIS FED. AID PROJECT					