

STATE OF ILLINOIS
DEPARTMENT OF TRANSPORTATION

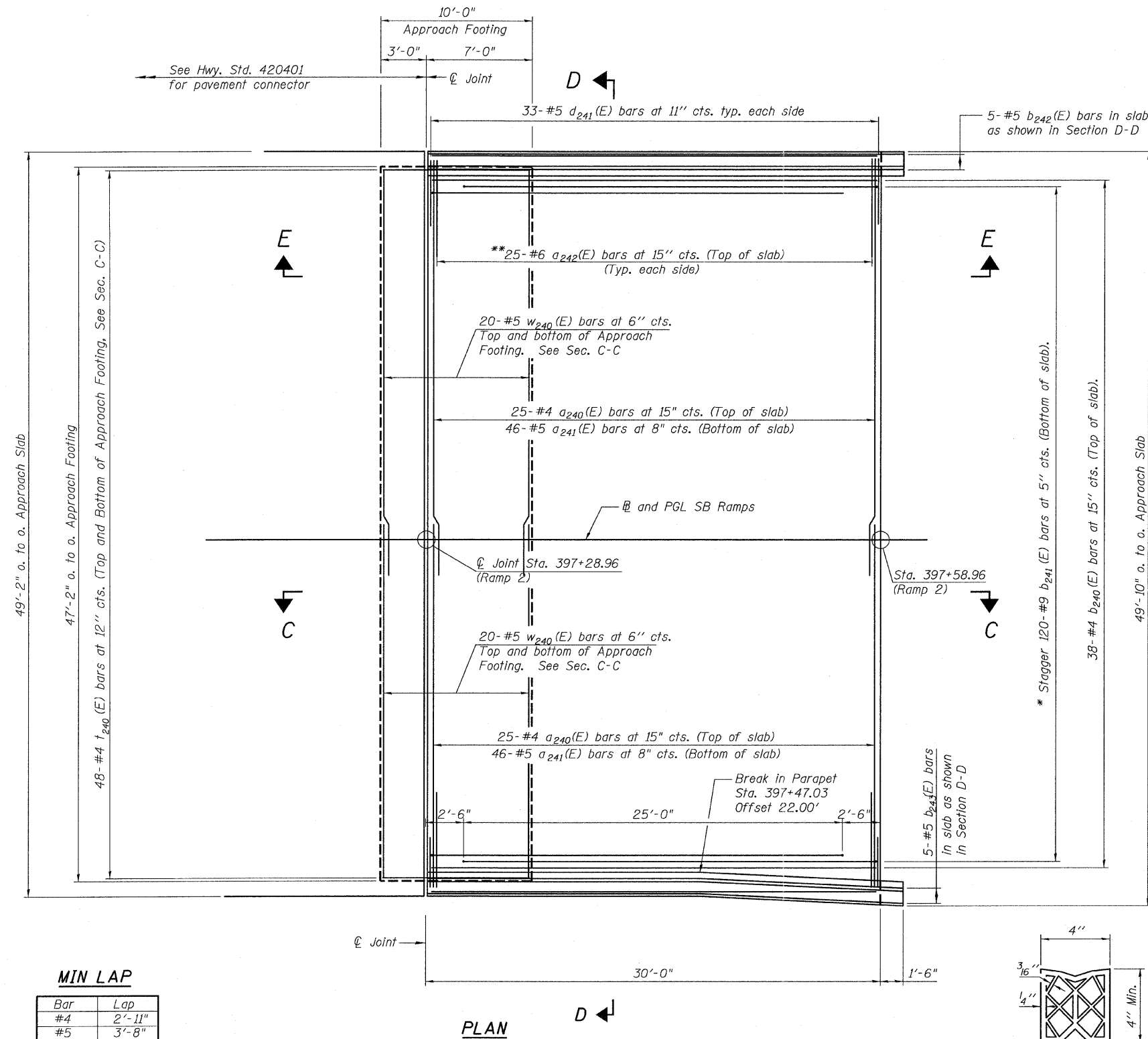

Notes:
See sheet 73 for Sections C-C & D-D and View E-E.
a₂₄₀(E) and a₂₄₁(E) bar spacings measured along \varnothing Rdwy.

49'-2" o. to o. Approach Slab

47'-2" o. to o. Approach Footing

48'-#4 a₂₄₀(E) bars at 12" cts. (Top and Bottom of Approach Footing, See Sec. C-C)

E

E

C

C

PLAN

MIN LAP

Bar	Lap
#4	2'-11"
#5	3'-8"

* Tilt #9 b₂₄₁(E) bars as required to maintain clearance.
** Space between a₂₄₀(E) bars, typ. each parapet.

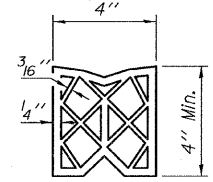

PREFORMED
JOINT SEAL

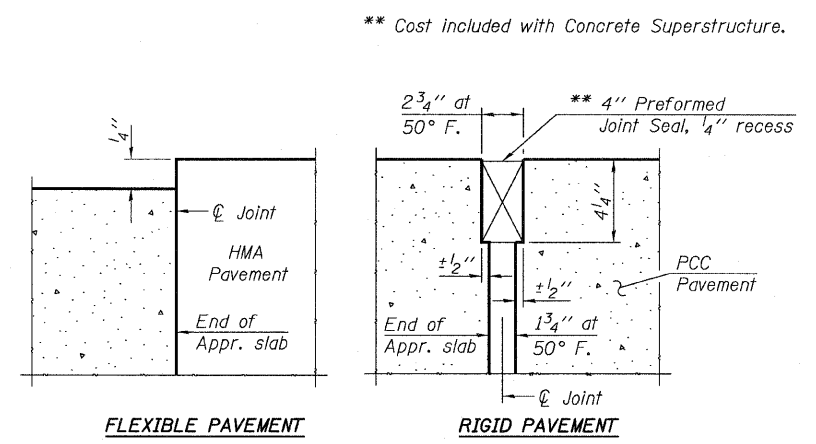

DETAIL A

** Cost included with Concrete Superstructure.

(Sheet 1 of 2)

RAMP 2 APPROACH SLAB
STRUCTURE NO. 016-0724

TYLIN INTERNATIONAL	DESIGNED - CBS	REVISIONS		SHEET NO. 72	F.A.I. RTE.	SECTION	COUNTY	TOTAL SHEETS	SHEET NO.	
	CHECKED - AMD,MMB	NAME	DATE		55	0711.2R & 1011.1BR	COOK	741	396	
	DRAWN - CBS				239 SHEETS	CONTRACT NO. 60999				
	CHECKED - AMD,MMB				FED. ROAD DIST. NO. 1 ILLINOIS FED. AID PROJECT					
	DATE - 03/25/2011									

p:\01345\structure\02 Central Ave. 016-0724\155-2appr-01.dgn 4/28/2011 11:51:47 AM