

STATE OF ILLINOIS
DEPARTMENT OF TRANSPORTATION

NOTES

1. Work this sheet with sheets 193 to 195.

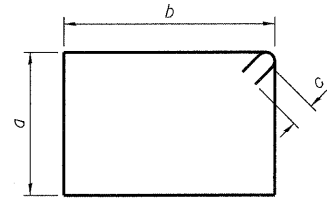

Bar	a	b	c
s ₁₃ (E)	2'-8"	3'-8"	5 1/2"
s ₁₅ (E)	4'-11"	3'-6"	5 1/2"
s ₁₆ (E)	5'-10"	3'-6"	5 1/2"
s ₁₇ (E)	8'-7"	2'-5"	5 1/2"
s ₁₈ (E)	8'-2"	2'-5"	5 1/2"
s ₁₉ (E)	8'-2"	5'-2"	5 1/2"

BARS s₁₃(E), s₁₅(E), s₁₆(E), s₁₇(E), s₁₈(E) & s₁₉(E)

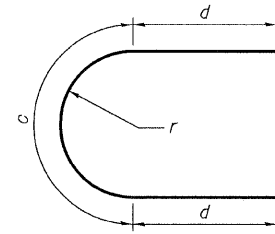

Bar	c	d	r
u ₁₁ (E)	5'-0"	3'-8"	1'-7"
u ₁₂ (E)	4'-2"	3'-8"	1'-4"
u ₁₃ (E)	8'-1"	3'-8"	2'-7"
u ₁₅ (E)	8'-1"	6'-11"	2'-7"

BARS u₁₁(E), u₁₂(E), u₁₃(E) & u₁₅(E)

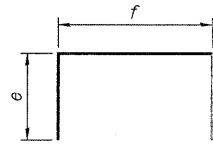

Bar	e	f
p ₁₈ (E)	1'-10"	7'-0"
s ₁₁ (E)	6'-1"	3'-2"
s ₁₂ (E)	3'-10"	3'-2"
s ₂₀ (E)	5'-3"	5'-2"
s ₈₁ (E)	3'-6"	2'-5"
u ₁₆ (E)	3'-8"	5'-2"
v ₁₅ (E)	10"	8'-2"
v ₁₆ (E)	10"	4'-11"
v ₁₇ (E)	10"	8'-7"
v ₁₉ (E)	10"	7'-10"

BARS p₁₈(E), s₁₁(E), s₁₂(E), s₂₀(E), s₈₁(E), u₁₆(E), v₁₅(E) thru v₁₇(E) & v₁₉(E)

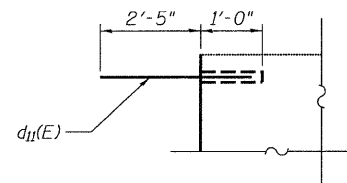

EMBEDMENT DETAIL

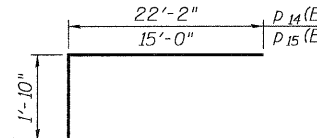

BARS p₁₄(E) & p₁₅(E)

BILL OF MATERIAL

Bar	No.	Size	Length	Shape
d ₁₁ (E)	36	#7	3'-5"	—
h ₁₁ (E)	15	#6	29'-0"	—
h ₁₂ (E)	78	#5	28'-6"	—
h ₁₃ (E)	15	#6	34'-1"	—
h ₁₄ (E)	78	#5	33'-7"	—
h ₁₅ (E)	40	#7	35'-2"	—
h ₁₆ (E)	14	#7	22'-6"	—
h ₁₇ (E)	14	#7	33'-2"	—
h ₁₈ (E)	6	#5	26'-8"	—
h ₁₉ (E)	3	#5	35'-8"	—
h ₅₁ (E)	3	#5	20'-10"	—
h ₅₂ (E)	3	#5	36'-7"	—
h ₅₃ (E)	3	#5	42'-10"	—
h ₅₄ (E)	3	#5	24'-6"	—
h ₅₅ (E)	3	#5	6'-4"	—
h ₅₆ (E)	3	#5	32'-2"	—
h ₅₇ (E)	3	#5	9'-6"	—
h ₅₈ (E)	3	#5	11'-3"	—
n ₁₁ (E)	10	#6	6'-9"	—
n ₁₂ (E)	266	#9	10'-8"	—
p ₁₁ (E)	44	#10	38'-5"	—
p ₁₂ (E)	8	#10	29'-6"	—
p ₁₃ (E)	8	#10	35'-2"	—
p ₁₄ (E)	12	#10	24'-0"	—
p ₁₅ (E)	44	#10	16'-10"	—
p ₁₆ (E)	16	#10	59'-2"	—
p ₁₇ (E)	8	#10	24'-1"	—
p ₁₈ (E)	4	#10	10'-8"	—
s ₁₁ (E)	74	#6	15'-4"	—
s ₁₂ (E)	179	#6	10'-10"	—
s ₁₃ (E)	228	#5	13'-8"	—
s ₁₄ (E)	228	#5	3'-8"	—
s ₁₅ (E)	358	#5	17'-9"	—
s ₁₆ (E)	194	#5	19'-7"	—
s ₁₇ (E)	23	#5	22'-11"	—
s ₁₈ (E)	35	#5	22'-1"	—
s ₁₉ (E)	12	#5	27'-7"	—
s ₂₀ (E)	9	#5	15'-8"	—
s ₈₁ (E)	267	#5	9'-5"	—
t ₁₁ (E)	75	#5	9'-8"	—
t ₁₂ (E)	123	#8	9'-8"	—
u ₁₁ (E)	28	#5	12'-4"	—
u ₁₂ (E)	30	#5	11'-6"	—
u ₁₃ (E)	6	#5	15'-5"	—
u ₁₄ (E)	4	#5	14'-0"	—
u ₁₅ (E)	10	#5	21'-11"	—
u ₁₆ (E)	15	#5	12'-6"	—

Bar	No.	Size	Length	Shape
v ₁₁ (E)	368	#6	12'-8"	—
v ₁₂ (E)	23	#9	12'-3"	—
v ₁₃ (E)	223	#9	16'-3"	—
v ₁₄ (E)	20	#9	13'-7"	—
v ₁₅ (E)	4	#5	9'-10"	—
v ₁₆ (E)	4	#5	6'-7"	—
v ₁₇ (E)	4	#5	10'-3"	—
v ₁₈ (E)	210	#6	3'-10"	—
v ₁₉ (E)	4	#5	9'-6"	—
w ₁₁ (E)	23	#5	21'-3"	—
w ₁₂ (E)	46	#5	26'-11"	—
Test Pile Metal Shells	Each			2
Concrete Structures	Cu Yd			672.6
Reinforcement Bars, Epoxy Coated	Pound			94,140
Concrete Sealer	Sq Ft			8,065
Furnishing Metal Shell Piles 12" x 0.250"	Foot			2,544
Driving Piles	Foot			2,544
Mechanical Splicers	Each			210

MIN. LAP LENGTH
(Unless noted otherwise)

#5	3'-8"
#6	4'-5"
#7	5'-10"
#10	12'-4"

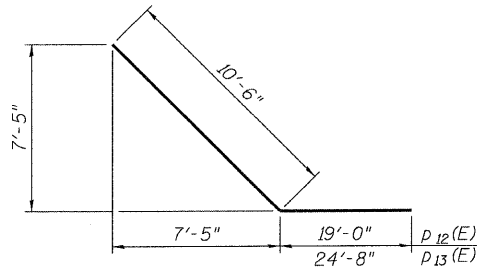

BARS p₁₂(E) & p₁₃(E)

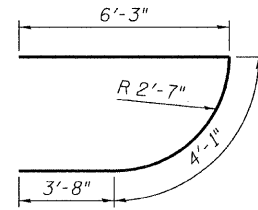

BARS u₁₄(E)

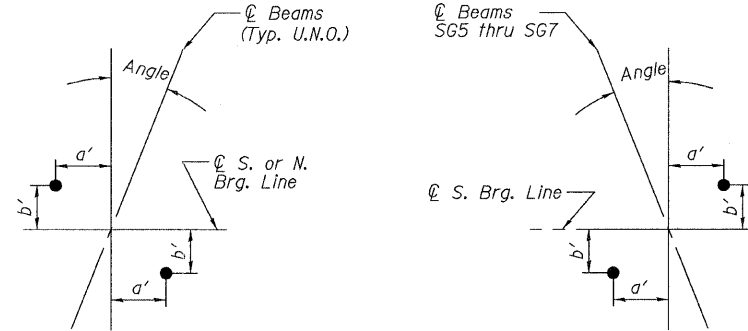

ANCHOR BOLT LAYOUT

Beam	Bearing Line	Angle	a'	b'
1 thru 16	South	21°39'15"	8 5/8"	3 3/8"
SG4	South	20°58'38"	9 5/8"	3 5/8"
SG5, SG6, SG7	South	11°21'9"	9 1/8"	1 7/8"
SG8, SG9	South	21°39'15"	9 1/2"	3 3/4"
SG10, SG11, SG12	South	42°48'34"	6 3/4"	6 1/4"
G1, G22	North	21°39'15"	13 3/4"	5 3/8"
G2, G21	North	21°39'15"	11 3/8"	4 1/2"
G3 thru G20	North	21°39'15"	8 1/8"	3 1/4"
G3.11	North	63°18'33"	4 5/8"	9 1/8"

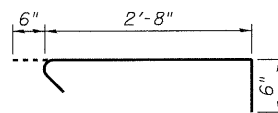

BAR s₁₄(E)

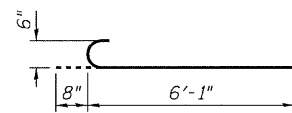

BAR n₁₁(E)

C. ABUT. 1 - DETAILS
CENTRAL/I-55
STRUCTURE NO. 016-0724

TYLIN INTERNATIONAL	DESIGNED - MB	REVISIONS		SHEET NO. 196	F.A.I. RTE.	SECTION	COUNTY	TOTAL SHEETS	SHEET NO.					
	CHECKED - AMD,	NAME	DATE							55	0711.2R & 1011.1BR	COOK	741	520
	DRAWN - MB									CONTRACT NO. 60999				
	CHECKED - AMD,									FED. ROAD DIST. NO. 1 ILLINOIS FED. AID PROJECT				
	DATE - 03/25/2011			239 SHEETS										

5/9/2011 9:09:19 AM p:\01345\structure\02_Central_Ave_016-0724\155c2abur\dt12.dgn