

STATE OF ILLINOIS
DEPARTMENT OF TRANSPORTATION

203'-0 1/8" End to End of Barrier

101'-6"

6 Spa @ 15'-0" = 90'-0"

11'-6"

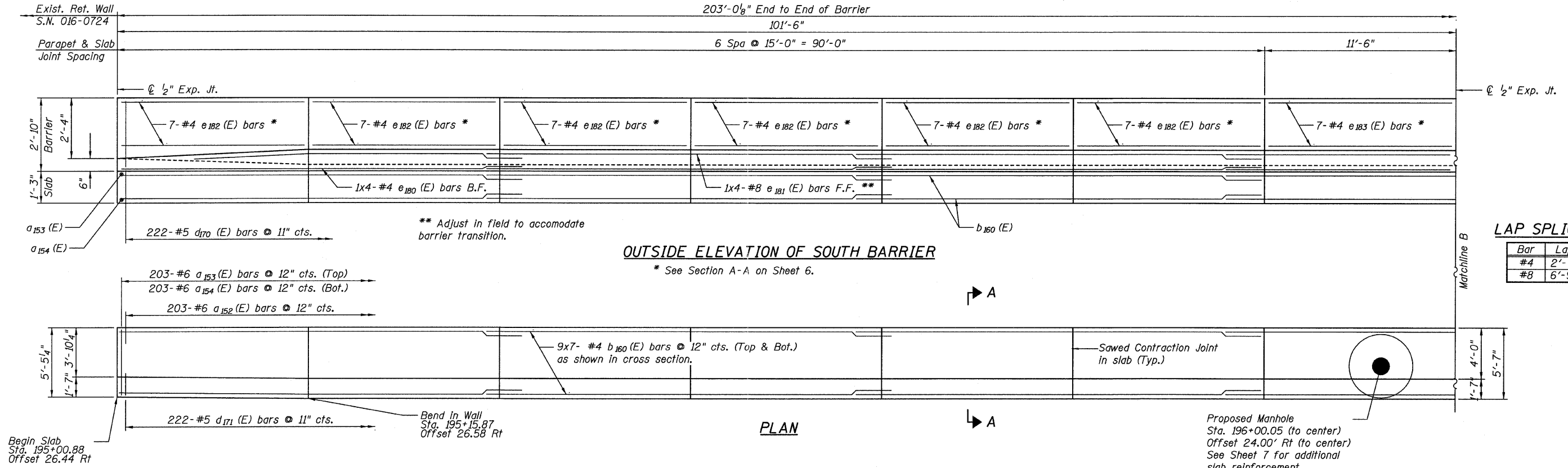

LAP SPLICES

Bar	Lap
#4	2'-7"
#8	6'-9"

203'-0 1/8" End to End of Barrier

101'-6 1/8"

6 Spa @ 15'-0" = 90'-0"

11'-6 1/8"

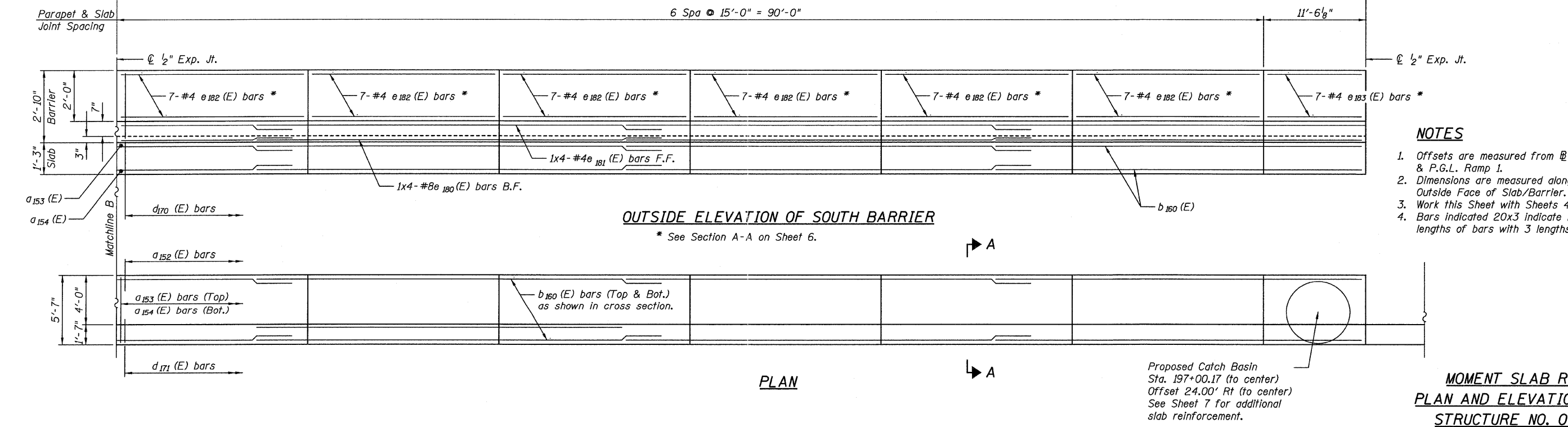

- NOTES**
- Offsets are measured from @ & P.G.L. Ramp 1.
 - Dimensions are measured along Outside Face of Slab/Barrier.
 - Work this Sheet with Sheets 4 to 7.
 - Bars indicated 20x3 indicate 20 lengths of bars with 3 lengths per line.

**MOMENT SLAB RAMP 1
PLAN AND ELEVATION 2 OF 2
STRUCTURE NO. 016-1304**

<p>TYLIN INTERNATIONAL</p>	DESIGNED - EKH	REVISIONS		<p>SHEET NO. 5</p>	F.A.I. RTE.	SECTION	COUNTY	TOTAL SHEETS	SHEET NO.	
	CHECKED - AMD,MMB	NAME	DATE		55	0711.2R & 1011.1BR	COOK	741	568	
	DRAWN - EKH				10 SHEETS	CONTRACT NO. 60999				
	CHECKED - AMD,MMB				FED. ROAD DIST. NO. 1 ILLINOIS FED. AID PROJECT					
	DATE - 03/25/2011									

4/28/2011 1:29:25 PM p:\01345\structure\02 Central Ave. 016-0724\155-1moms\lab2.dgn