

PLAN	SURVEYED	BY	DATE
	PLOTTED		
	CHECKED		
	NO. OF WAY CHECKED		
	CADD FILE NAME		

PROFILE	SURVEYED	BY	DATE
	PLOTTED		
	CHECKED		
	NO. OF WAY CHECKED		
	STRUCTURE NOTATIONS CHECKED		

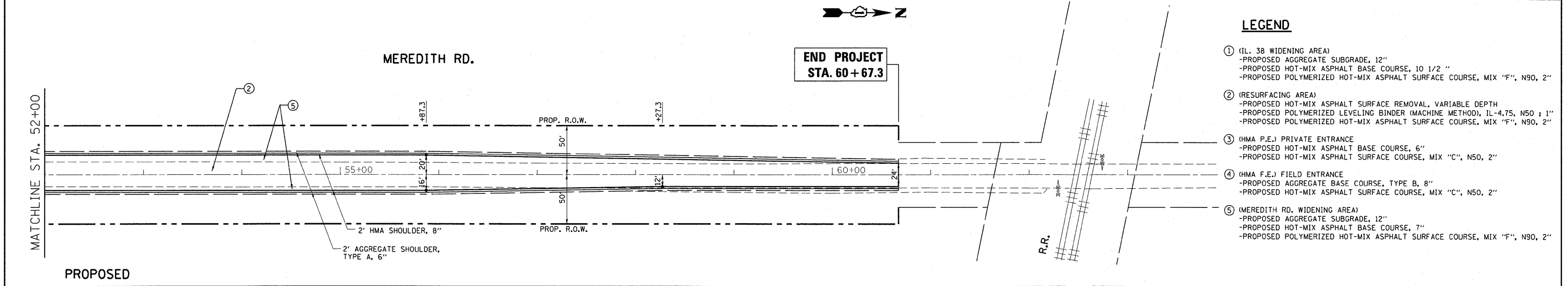

- LEGEND**
- ① (IL. 38 WIDENING AREA)
 - PROPOSED AGGREGATE SUBGRADE, 12"
 - PROPOSED HOT-MIX ASPHALT BASE COURSE, 10 1/2 "
 - PROPOSED POLYMERIZED HOT-MIX ASPHALT SURFACE COURSE, MIX "F", N90, 2"
 - ② (RESURFACING AREA)
 - PROPOSED HOT-MIX ASPHALT SURFACE REMOVAL, VARIABLE DEPTH
 - PROPOSED POLYMERIZED LEVELING BINDER (MACHINE METHOD), IL-4.75, N50, 1"
 - PROPOSED POLYMERIZED HOT-MIX ASPHALT SURFACE COURSE, MIX "F", N90, 2"
 - ③ (HMA P.E.) PRIVATE ENTRANCE
 - PROPOSED HOT-MIX ASPHALT BASE COURSE, 6"
 - PROPOSED HOT-MIX ASPHALT SURFACE COURSE, MIX "C", N50, 2"
 - ④ (HMA F.E.) FIELD ENTRANCE
 - PROPOSED AGGREGATE BASE COURSE, TYPE B, 8"
 - PROPOSED HOT-MIX ASPHALT SURFACE COURSE, MIX "C", N50, 2"
 - ⑤ (MEREDITH RD. WIDENING AREA)
 - PROPOSED AGGREGATE SUBGRADE, 12"
 - PROPOSED HOT-MIX ASPHALT BASE COURSE, 7"
 - PROPOSED POLYMERIZED HOT-MIX ASPHALT SURFACE COURSE, MIX "F", N90, 2"

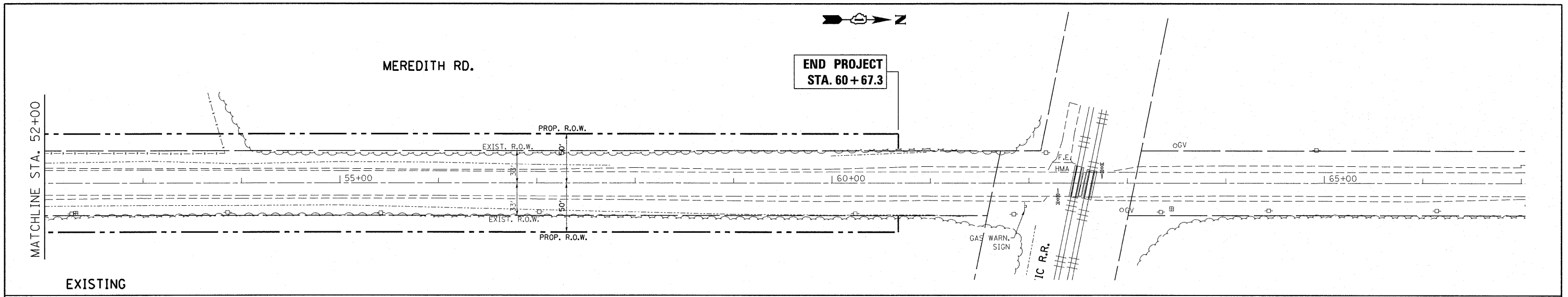
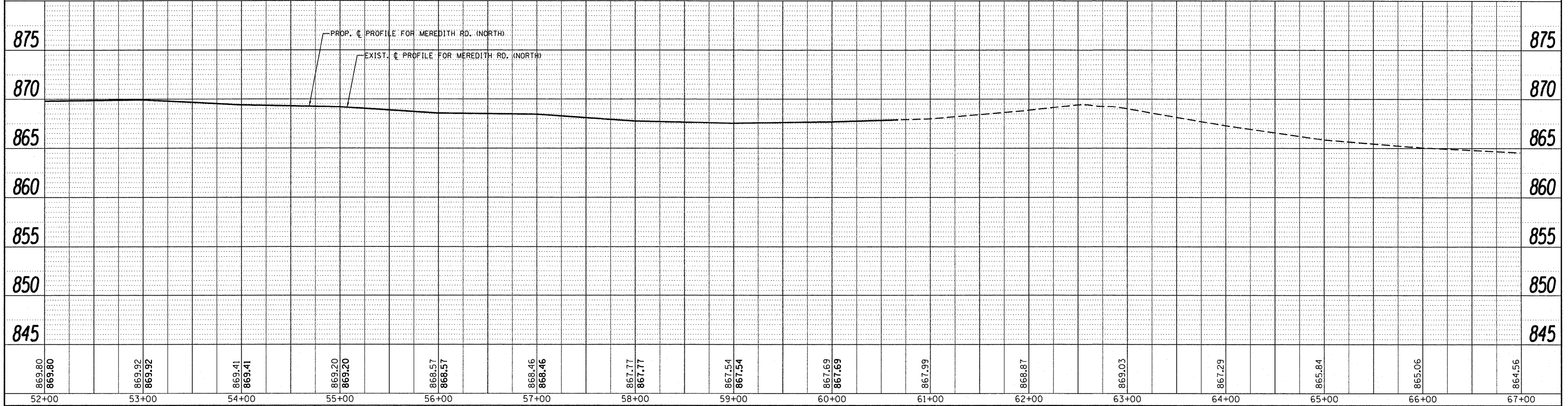

FILE NAME =	USER NAME = abreuh	DESIGNED -	REVISED -	STATE OF ILLINOIS DEPARTMENT OF TRANSPORTATION	ROADWAY PLAN & PROFILE IL. RTE. 38 AT MEREDITH RD.	F.A.P. RTE.	SECTION	COUNTY	TOTAL SHEETS	SHEET NO.	
es:\pwork\puidot\abreuh\d0139641\115308	shs-plnprf.dgn	DRAWN -	REVISED -			567	5 R-N-1	KANE	77	22	
		CHECKED -	REVISED -			CONTRACT NO. 60K65					
		DATE -	REVISED -			ILLINOIS FED. AID PROJECT					