

|              |               |    |      |
|--------------|---------------|----|------|
| FINAL SURVEY | SURVEYED      | BY | DATE |
| NOTE BOOK    | PLOTTED       |    |      |
| NO.          | TEMPLATE      |    |      |
|              | AREAS CHECKED |    |      |

|                 |               |    |      |
|-----------------|---------------|----|------|
| ORIGINAL SURVEY | SURVEYED      | BY | DATE |
| NOTE BOOK       | PLOTTED       |    |      |
| NO.             | TEMPLATE      |    |      |
|                 | AREAS CHECKED |    |      |

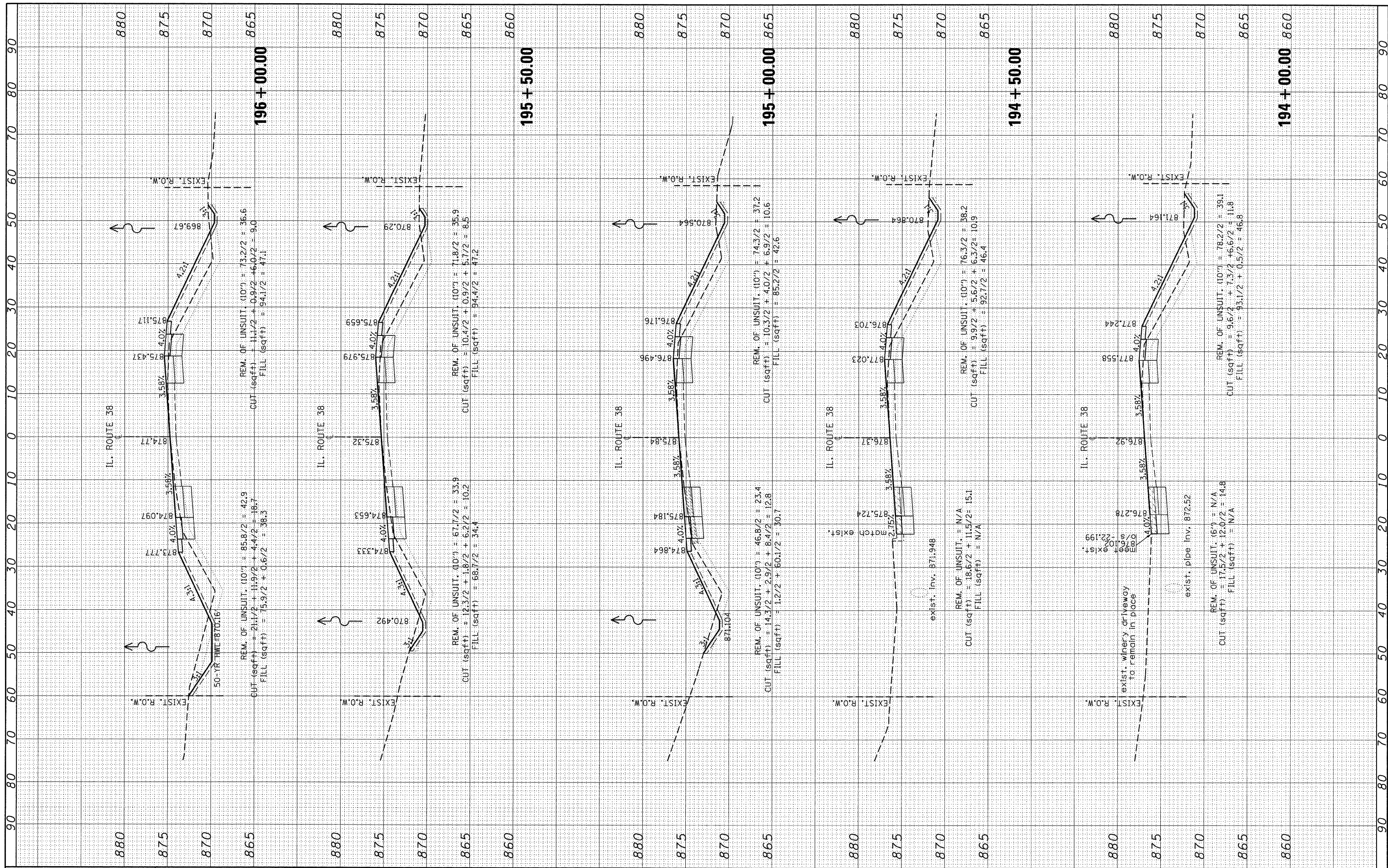

FILE NAME = F115388-sht-ssht-IL38.dgn

USER NAME = abrauh  
 PLOT SCALE = 10.0000' / IN.  
 PLOT DATE = 2/22/2011

|            |           |
|------------|-----------|
| DESIGNED - | REVISED - |
| DRAWN -    | REVISED - |
| CHECKED -  | REVISED - |
| DATE -     | REVISED - |

**STATE OF ILLINOIS  
DEPARTMENT OF TRANSPORTATION**

**IL. ROUTE 38  
CROSS SECTIONS**  
 SCALE: SHEET NO. OF SHEETS STA. 194+00.00 TO STA. 196+00.00

|                           |                 |             |                 |              |
|---------------------------|-----------------|-------------|-----------------|--------------|
| F.A.P. RTE. 567           | SECTION 5 R-N-1 | COUNTY KANE | TOTAL SHEETS 77 | SHEET NO. 60 |
| CONTRACT NO. 60K65        |                 |             |                 |              |
| ILLINOIS FED. AID PROJECT |                 |             |                 |              |