

**STATE OF ILLINOIS
DEPARTMENT OF TRANSPORTATION
DIVISION OF HIGHWAYS**

OR RTE.	SECTION	COUNTY	TOTAL SHEETS	SHEET NO.
0297	1G-RS-2	WILL	17	1
		ILLINOIS	CONTRACT NO. 60L10	

D-91-638-10

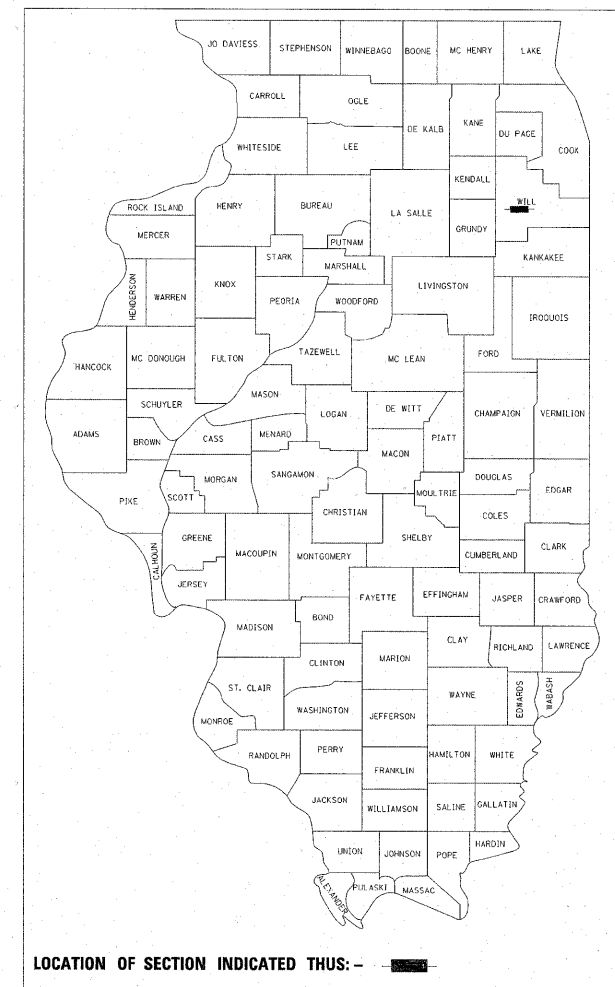

PROPOSED HIGHWAY PLANS

**OR RTE 0297: HOFF RD
OLD CHICAGO RD TO ABANDONED CMSTP&P RR
SECTION: 1G-RS-2
RESURFACING**

WILL COUNTY

C-91-638-10

**PROJECT BEGINS
STA 10+50**

**PROJECT ENDS
STA 210+29**

R10E R11E

FOR INDEX OF SHEETS, SEE SHEET NO. 2

**PROJECT IS LOCATED
IN THE MANHATTAN AND
JACKSON TOWNSHIPS**

TRAFFIC DATA

**2009 ADT = 10,000
POSTED SPEED = 55 MPH**

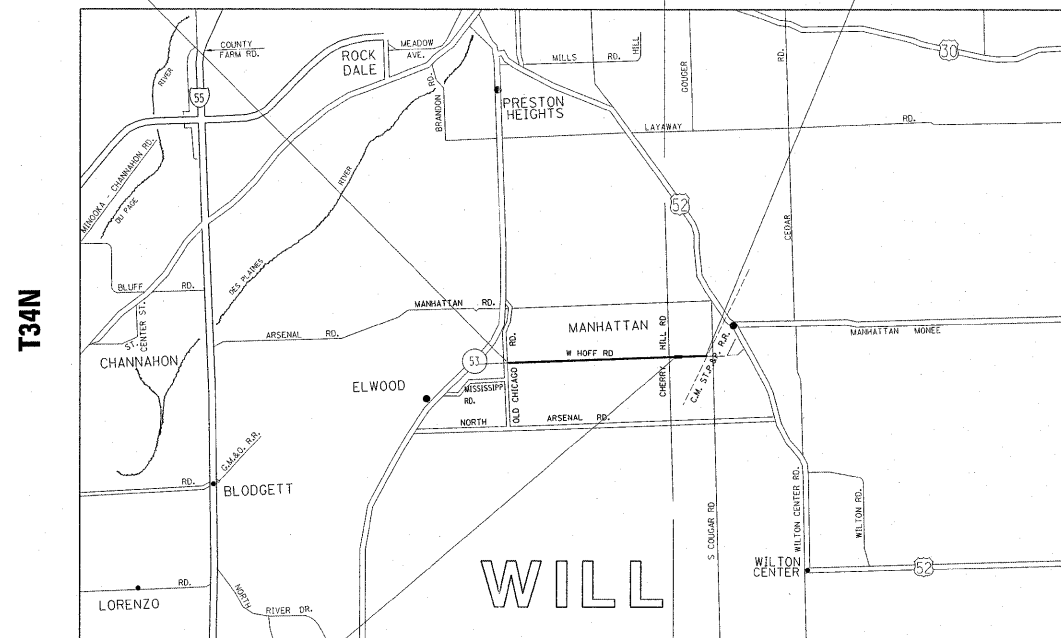

**HOFF RD OVER
PRAIRIE CREEK
SN 099-0157**

JACKSON TOWNSHIP MANHATTAN TOWNSHIP

**J.U.L.I.E.
JOINT UTILITY LOCATION INFORMATION FOR EXCAVATION
1-800-892-0123
OR 811**

**PROJECT ENGINEER BORO, ROBERT (847) 705 - 4178
PROJECT MANAGER RAYYAN, ISSAM**

GROSS AND NET LENGTH OF IMPROVEMENT = 19979 FT = 3.78 MILES

**STATE OF ILLINOIS
DEPARTMENT OF TRANSPORTATION
DIVISION OF HIGHWAYS**

SUBMITTED APRIL 12 2011

Diana M. O'Keefe
DEPUTY DIRECTOR OF HIGHWAYS, REGION ENGINEER

May 13 2011
Scott E. Stitt, P.E.
Acting ENGINEER OF DESIGN AND ENVIRONMENT

May 13 2011
Christine M. Rowland
DIRECTOR OF HIGHWAYS, CHIEF ENGINEER

**PRINTED BY THE AUTHORITY
OF THE STATE OF ILLINOIS**

CONTRACT NO. 60L10

INDEX OF SHEETS

SHEET NO.	DESCRIPTION
1	COVER SHEET
2	INDEX OF SHEETS, STANDARDS AND GENERAL NOTES
3	SUMMARY OF QUANTITIES
4	TYPICAL SECTIONS
5-10	ROADWAY & PAVEMENT MARKING PLANS
11	EXISTING BRIDGE PLAN (SN 099-0157)
12	PAVEMENT PATCHING FOR HMA SURFACED PAVEMENT (BD-22)
13	BUTT JOINT AND HMA TAPER DETAILS (BD-32)
14	TRAFFIC CONTROL AND PROTECTION FOR SIDE ROADS, INTERSECTIONS AND DRIVEWAYS (TC-10)
15	TYPICAL APPLICATIONS RAISED REFLECTIVE PAVEMENT MARKERS (SNOW-PLOW RESISTANT) (TC-11)
16	DISTRICT ONE TYPICAL PAVEMENT MARKINGS (TC-13)
17	ARTERIAL ROAD INFORMATION SIGNING (TC-22)

LIST OF STATE STANDARDS

STANDARD NO.	DESCRIPTION
442201-03	CLASS C AND D PATCHES
630001-09	STEEL PLATE BEAM GUARDRAIL
630301-05	SHOULDER WIDENING FOR TYPE 1 (SPECIAL) GUARDRAIL TERMINAL
701011-02	OFF-ROAD MOVING OPERATIONS, 2L, 2W, DAY ONLY
701201-04	LANE CLOSURE 2L, 2W, DAY ONLY FOR SPEEDS >45 MPH
701301-04	LANE CLOSURE 2L, 2W SHORT TIME OPERATIONS
701306-03	LANE CLOSURE 2L, 2W SLOW MOVING OPERATIONS DAY ONLY, FOR SPEEDS >45 MPH
701311-03	LANE CLOSURE 2L, 2W MOVING OPERATIONS - DAY ONLY
701901-01	TRAFFIC CONTROL DEVICES
780001-02	TYPICAL PAVEMENT MARKINGS

GENERAL NOTES

BEFORE STARTING ANY EXCAVATION, THE CONTRACTOR SHALL CALL "JULIE" AT 800-892-0123 OR 811 FOR FIELD LOCATIONS OF BURIED ELECTRIC, TELEPHONE AND GAS FACILITIES. (48 HOUR NOTIFICATION IS REQUIRED)

THE CONTRACTOR SHALL COORDINATE CONSTRUCTION ACTIVITIES WITH UTILITY COMPANIES.

THE CONTRACTOR WILL NOT BE ALLOWED TO SET UP A YARD OR FIELD OFFICE ON STATE PROPERTY WITHOUT WRITTEN PERMISSION FROM THE DEPARTMENT.

ALL DAMAGE TO EXISTING PAVEMENT MARKINGS OR RAISED REFLECTIVE PAVEMENT MARKERS OUTSIDE THE REMOVAL LINE SHOWN ON THE PLANS SHALL BE REPLACED AT NO ADDITIONAL COST TO THE DEPARTMENT.

WHEN MILLED PAVEMENT IS OPEN TO TRAFFIC THE MAXIMUM GRADE DIFFERENTIAL BETWEEN PASSES OF THE MILLING MACHINE SHALL NOT EXCEED 1 1/2 INCHES (40MM) WHERE THE SPEED LIMIT IS 45 MPH (80KM/H) OR LESS AND 1 INCH (25 MM) WHERE THE SPEED LIMIT IS GREATER THAN 45 MPH (80 KM/H), WITH WRITTEN APPROVAL FROM THE ENGINEER, A MAXIMUM GRADE DIFFERENTIAL OF 3 INCHES (75 MM) MAY BE ALLOWED IF THE EDGE OF THE MILLING IS SLOPED A MINIMUM 1:3 (V:H).

BEFORE BEGINING ANY WORK, THE CONTRACTOR SHALL RETAIN AND RECORD FOR FUTURE REFERENCE, ALL EXISTING PAVEMENT MARKING LINES AND REVISED REFLECTIVE PAVEMENT MARKERS IN ORDER THAT THESE LOCATIONS CAN BE RE-ESTABLISHED FOR STRIPING. EXACT LOCATIONS OF ALL PAVEMENT MARKINGS SHALL BE AS DIRECTED BY THE ENGINEER.

THE ENGINEER SHALL CONTACT LAWRENCE HILL, AREA TRAFFIC FIELD ENGINEER AT (815) 485-6475 A MINIMUM OF TWO (2) WEEKS PRIOR TO THE PLACEMENT OF PERMANENT PAVEMENT MARKINGS.

DRAINAGE ADJUSTMENT OR RECONSTRUCTION LOCATIONS WILL BE DETERMINED IN THE FIELD BY THE ENGINEER.

THE CONTRACTOR SHALL CONTACT THE DISTRICT ONE TRAFFIC CONTROL SUPERVISOR AT (847) 705-4470 A MINIMUM OF 72 HOURS IN ADVANCE OF BEGINNING WORK.

IT SHALL BE THE CONTRACTOR'S RESPONSIBILITY TO VERIFY ALL DIMENSIONS AND CONDITIONS EXISTING IN THE FIELD PRIOR TO CONSTRUCTION AND ORDERING OF MATERIALS.

THE CONTRACTOR SHALL BE REQUIRED TO PROVIDE ACCESS TO ADJUTING PROPERTY AT ALL TIMES DURING THE CONSTRUCTION OF THIS PROJECT.

DO NOT SCALE PLANS FOR CONSTRUCTION DIMENSIONS.

DOUBLE LANE MARKERS ARE TO BE USED AS SHOWN ON THE DISTRICT ONE DETAIL "TYPICAL APPLICATIONS - RAISED REFLECTIVE PAVEMENT MARKERS (SNOW-PLOW RESISTANT)" SHOWN IN THE PLANS.

ALL PAVEMENT PATCHING LOCATIONS WILL BE DETERMINED IN THE FIELD BY THE ENGINEER.

THE CONTRACTOR SHALL VERIFY THE EXISTING TYPE/HEIGHT OF EXISTING GUARDRAIL BEFORE ORDERING THE NEW TERMINAL SECTION. COST INCLUDED IN THE COST OF "TRAFFIC BARRIER TERMINAL, TYPE I (SPECIAL) TANGENT".

THE REMOVAL OF GUARDRAIL TERMINAL SECTIONS SHALL BE INCLUDED IN THE UNIT PRICE PER FOOT FOR "GUARDRAIL REMOVAL."

PAVEMENT MARKING TAPE, TYPE III SHALL BE USED FOR SHORT TERM PAVEMENT MARKINGS ON ALL FINAL SURFACES. THE COST OF THE PAVEMENT MARKING TAPE, TYPE III AND ITS REMOVAL SHALL BE INCLUDED IN THE COST OF SHORT TERM PAVEMENT MARKING.

FILE NAME =	USER NAME = korabowiczje	DESIGNED -	REVISED -	STATE OF ILLINOIS DEPARTMENT OF TRANSPORTATION	OR 0297 /HOFF RD (OLD CHICAGO RD TO CMSTR & P RR) INDEX OF SHEETS, STATE STANDARDS AND GENERAL NOTES	OR	SECTION	COUNTY	TOTAL	SHEET	
c:\pw_work\pwi\dot\korabowiczje\08208530	0163810-shr-plan.dgn	DRAWN -	REVISED -			0297	1G-RS-2	WILL	17	2	
	PLOT SCALE = 50.0000' / IN.	CHECKED -	REVISED -			CONTRACT NO. 60L10					
	PLOT DATE = 4/11/2011	DATE -	REVISED -			ILLINOIS FED. AID PROJECT					
					SCALE:	SHEET NO.	OF	SHEETS	STA.	TO STA.	

SUMMARY OF QUANTITIES				CONSTRUCTION TYPE CODE					SUMMARY OF QUANTITIES				CONSTRUCTION TYPE CODE						
CODE NO	ITEM	UNIT	TOTAL QUANTITIES						CODE NO	ITEM	UNIT	TOTAL QUANTITIES							
			0005									0005							
20201200	REMOVAL AND DISPOSAL OF UNSUITABLE MATERIAL	CU YD	75	75						* 78000200	THERMOPLASTIC PAVEMENT MARKING - LINE 4"	FOOT	49093	49093					
20400800	FURNISHED EXCAVATION	CU YD	244	244						* 78008210	POLYUREA PAVEMENT MARKING TYPE I - LINE 4"	FOOT	212	212					
21101615	TOPSOIL FURNISH AND PLACE, 4"	SO YD	424	424						* 78100100	RAISED REFLECTIVE PAVEMENT MARKER	EACH	321	321					
25000210	SEEDING, CLASS 2A	ACRE	0.09	0.09						* 78201000	TERMINAL MARKER - DIRECT APPLIED	EACH	4	4					
25000400	NITROGEN FERTILIZER NUTRIENT	POUND	8.5	8.5						78300200	RAISED REFLECTIVE PAVEMENT MARKER REMOVAL	EACH	321	321					
25000500	PHOSPHORUS FERTILIZER NUTRIENT	POUND	8.5	8.5						X4060826	POLYMERIZED LEVELING BINDER (MACHINE METHOD), IL-4.75, N50	TON	2300	2300					
25000600	POTASSIUM FERTILIZER NUTRIENT	POUND	8.5	8.5						X4401198	HOT-MIX ASPHALT SURFACE REMOVAL, VARIABLE DEPTH	SO YD	24	24					
25100630	EROSION CONTROL BLANKET	SO YD	424	424						Z0030850	TEMPORARY INFORMATION SIGNING	SO FT	51.4	51.4					
40600200	BITUMINOUS MATERIALS (PRIME COAT)	TON	43	43															
40600300	AGGREGATE (PRIME COAT)	TON	214	214															
40600400	MIXTURE FOR CRACKS, JOINTS, AND FLANGWAYS	TON	80	80															
40600895	CONSTRUCTING TEST STRIP	EACH	1	1															
40600982	HOT-MIX ASPHALT SURFACE REMOVAL - BUTT JOINT	SO YD	50	50															
40600985	PORTLAND CEMENT CONCRETE SURFACE REMOVAL - BUTT JOINT	SO YD	24	24															
40603340	HOT-MIX ASPHALT SURFACE COURSE, MIX "D", N70	TON	4478	4478															
44000158	HOT-MIX ASPHALT SURFACE REMOVAL, 2 1/4"	SO YD	53300	53300															
44201815	CLASS D PATCHES, TYPE II, 14 INCH	SO YD	1020	1020															
44201819	CLASS D PATCHES, TYPE III, 14 INCH	SO YD	1020	1020															
44201821	CLASS D PATCHES, TYPE IV, 14 INCH	SO YD	1356	1356															
48101620	AGGREGATE SHOULDERS, TYPE B 10"	SO YD	65	65															
48102100	AGGREGATE WEDGE SHOULDER, TYPE B	TON	987	987															
58700300	CONCRETE SEALER	SO FT	2345	2345															
* 63100167	TRAFFIC BARRIER TERMINAL, TYPE 1 (SPECIAL) TANGENT	EACH	4	4															
63200310	GUARDRAIL REMOVAL	FOOT	200	200															
67000400	ENGINEER'S FIELD OFFICE, TYPE A	CAL MO	3	3															
67100100	MOBILIZATION	L SUM	1	1															
70100450	TRAFFIC CONTROL AND PROTECTION, STANDARD 701201	L SUM	1	1															
70100460	TRAFFIC CONTROL AND PROTECTION, STANDARD 701306	L SUM	1	1															
70300100	SHORT TERM PAVEMENT MARKING	FOOT	6670	6670															
70300220	TEMPORARY PAVEMENT MARKING - LINE 4"	FOOT	49305	49305															

* Specialty Items

FILE NAME =	USER NAME = karabawiczje	DESIGNED -	REVISED -	STATE OF ILLINOIS DEPARTMENT OF TRANSPORTATION	OR 0297 /HOFF RD (OLD CHICAGO RD TO CMSTR & P RR) SUMMARY OF QUANTITIES	F.A. RTE.	SECTION	COUNTY	TOTAL SHEETS	SHEET NO.
c:\pw_swork\pw\dor\karabawiczje\0208530\0163810-stp\plan.dgn	DRAWN -	REVISED -	0297			1G-RS-2	WILL	17	3	
PLOT SCALE = 50.0000' / IN.	CHECKED -	REVISED -	CONTRACT NO. 60L10							
PLOT DATE = 4/11/2011	DATE -	REVISED -	SCALE:			SHEET NO. OF SHEETS	STA. TO STA.	FED. ROAD DIST. NO. I	ILLINOIS FED. AID PROJECT	

LEGEND

- 1 EXISTING HMA SURFACE COURSE, 1 1/2"
- 2 EXISTING HMA BINDER COURSE MIX, 1 1/2"
- 3 EXISTING HMA OVERLAY, ±2"
- 4 EXISTING CRUSHED STONE BASE COURSE, ±5"
- 5 EXISTING CRUSHED STONE SUB-BASE, ±6"
- 6 EXISTING AGGREGATE SHOULDER, TYPE B
- 7 PROPOSED HMA SURFACE REMOVAL, 2 1/4"
- 8 PROPOSED POLYMERIZED LEVELING BINDER (M M), IL -4.75, N 50, 3/4"
- 9 PROPOSED HMA SURFACE COURSE, MIX "D", N70, 1 1/2"
- 10 PROPOSED WEDGE AGGREGATE SHOULDERS, TYPE B
- 11 SAFETY EDGE

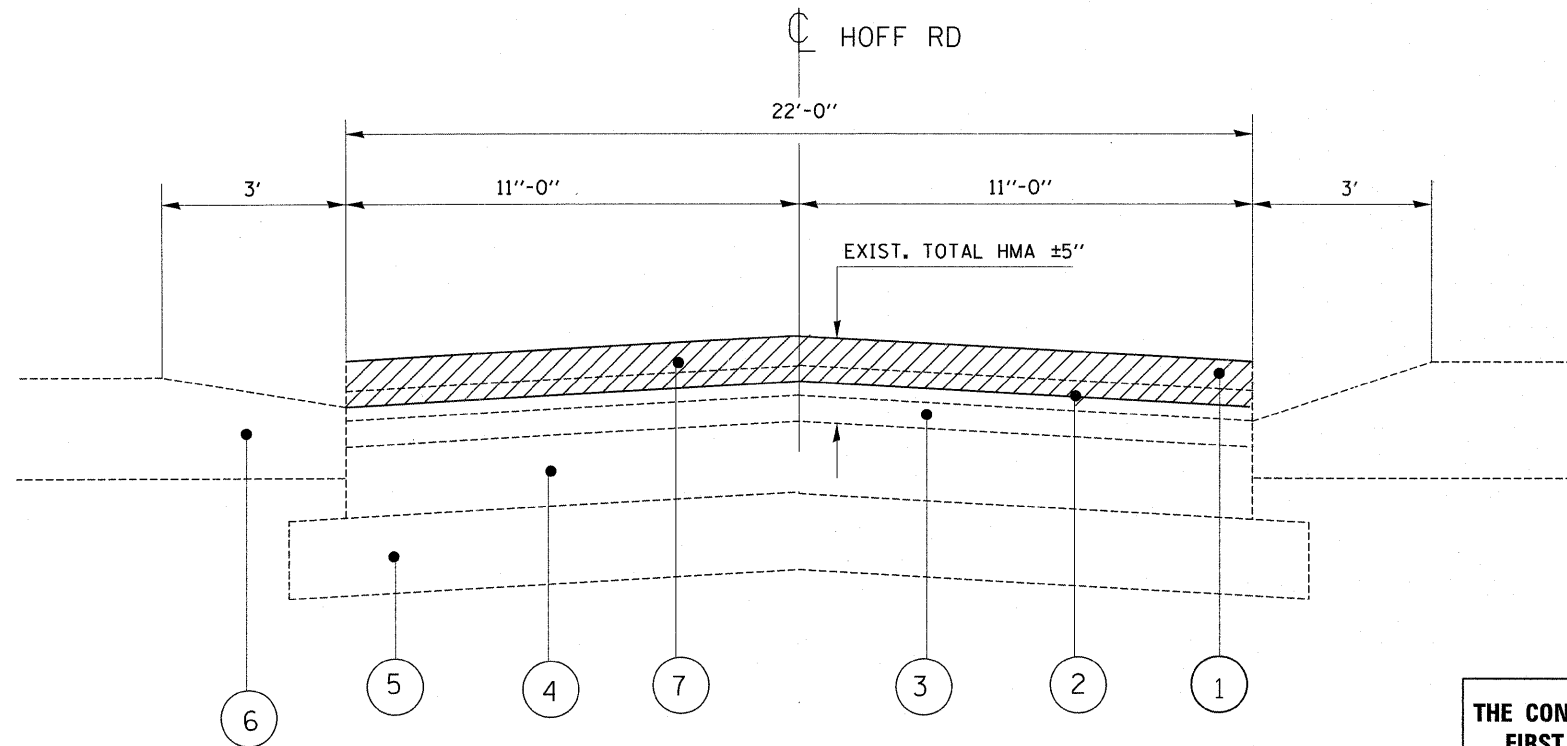

THE CONTRACTOR SHALL MILL FIRST BEFORE PATCHING

EXISTING TYPICAL SECTION

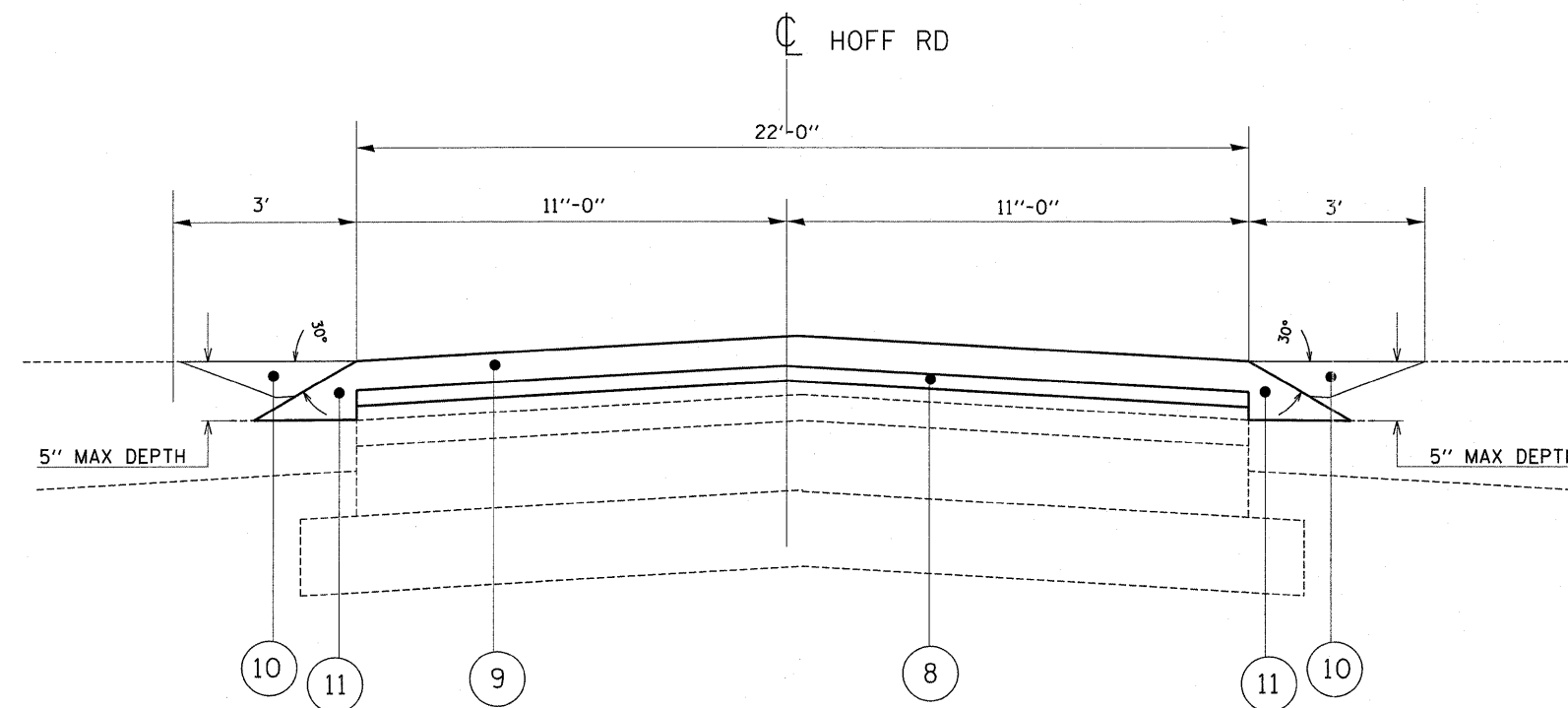

PROPOSED TYPICAL SECTION

HMA MIXTURE REQUIREMENTS	
MIXTURE TYPE	AIR VOIDS & Ndes
HOT-MIX ASPHALT SURFACE COURSE, MIX D, N70, (IL 9.5 mm)	4% @ 70 GYR
POLYMERIZED LEVELING BINDER (M M), IL -4.75, N50	4% @ 50 GYR
CLASS D PATCHES, (HMA BINDER IL-19mm)	4% @ 70 GYR

NOTE:

THE UNIT WEIGHT USED TO CALCULATE ALL HMA SURFACE MIXTURE QUANTITIES IS 112 LBS/SQ. YD. / IN.

THE "AC TYPE" FOR POLYMERIZED HMA MIXES SHALL BE "SBS / SBR PG 70 -22" AND FOR NON POLYMERIZED HMA THE "AC TYPE" SHALL BE "PG 64 -22" UNLESS MODIFIED BY DISTRICT ONE SPECIAL PROVISIONS.

FOR "PERCENT OF RAP" SEE DISTRICT ONE SPECIAL PROVISIONS.

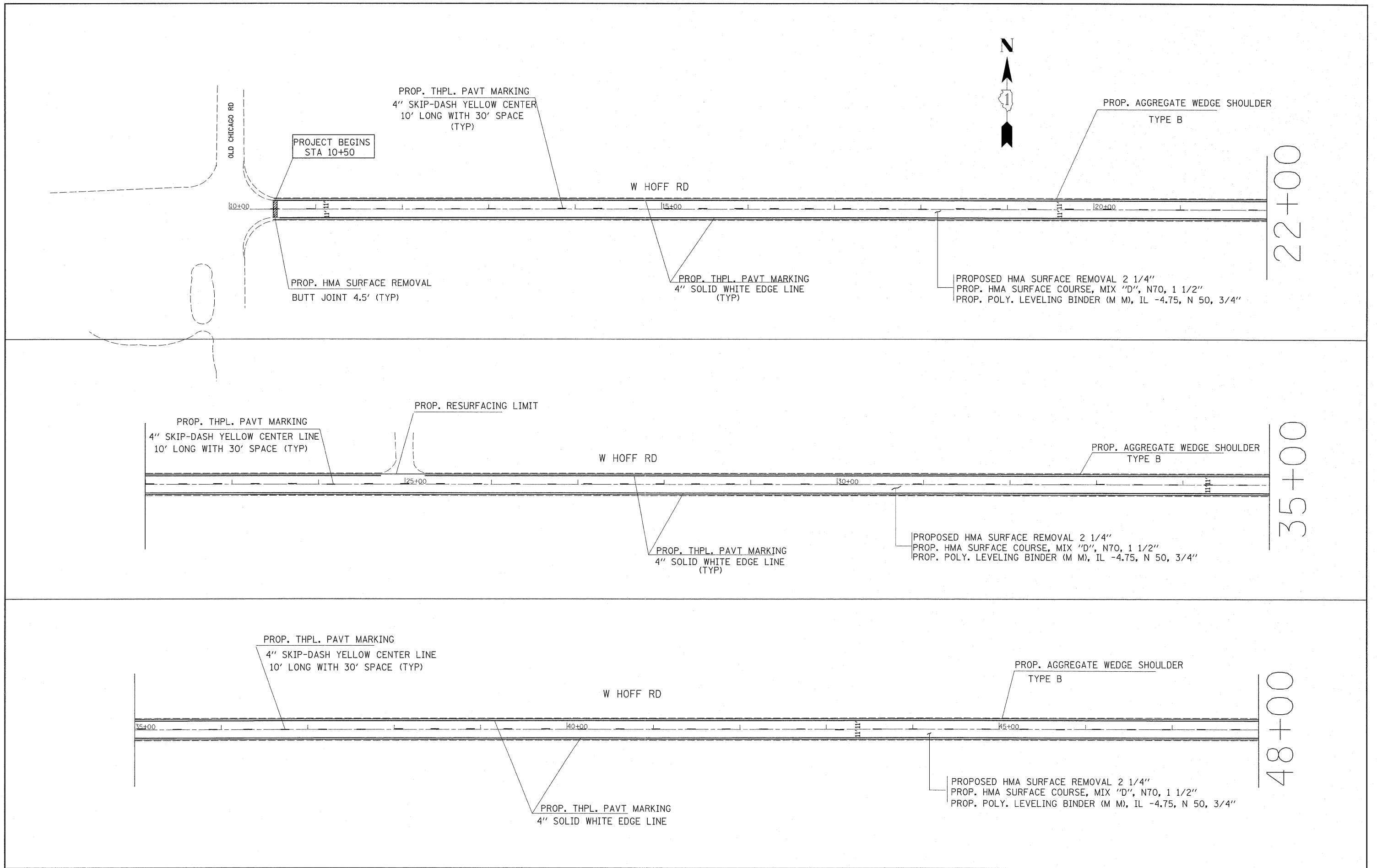

FILE NAME =
 c:\pwwork\pwwork\karabowicz\je\d0208530

USER NAME = karabowiczje
 D163810-sht-plan.dgn
 PLOT SCALE = 58.0000' / IN.
 PLOT DATE = 4/11/2011

DESIGNED -
 DRAWN -
 CHECKED -
 DATE -

REVISED -
 REVISED -
 REVISED -
 REVISED -

**STATE OF ILLINOIS
 DEPARTMENT OF TRANSPORTATION**

**OR 0297 /HOFF RD (OLD CHICAGO RD TO CMSTR&P RR)
 ROADWAY AND PAVEMENT MARKING PLANS**

SCALE: SHEET NO. OF SHEETS STA. TO STA.

OR RTE.	SECTION	COUNTY	TOTAL SHEETS	SHEET NO.
0297	1G-RS-2	WILL	17	5
CONTRACT NO. 60L10				
ILLINOIS FED. AID PROJECT				

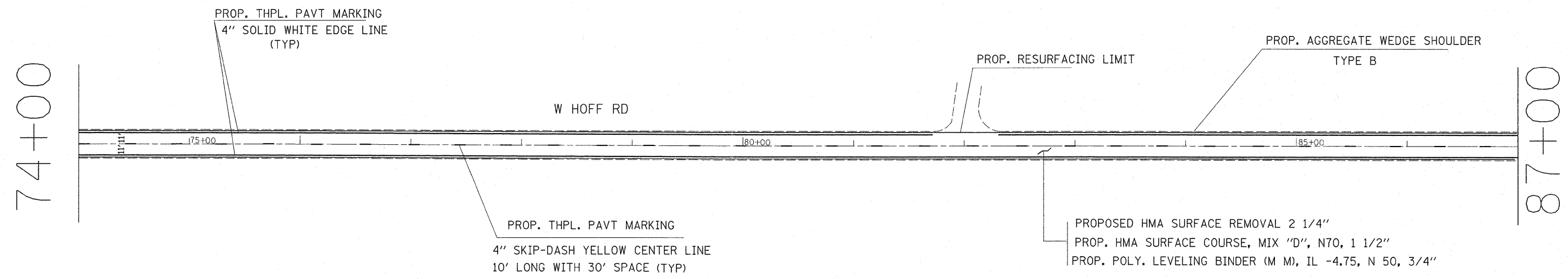
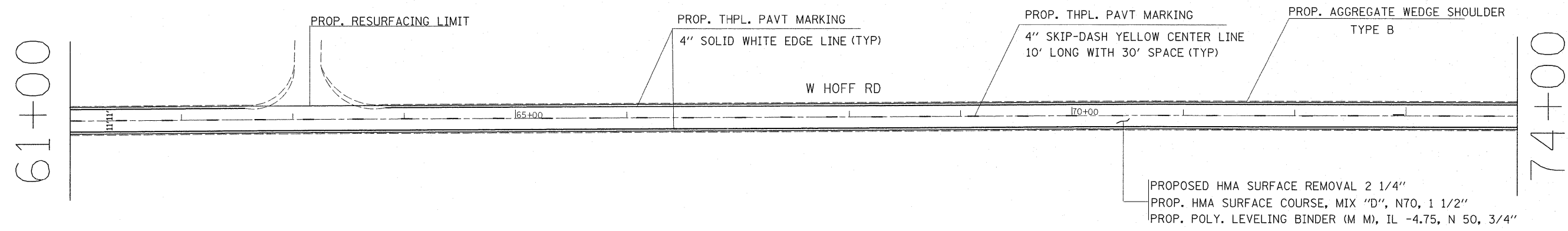
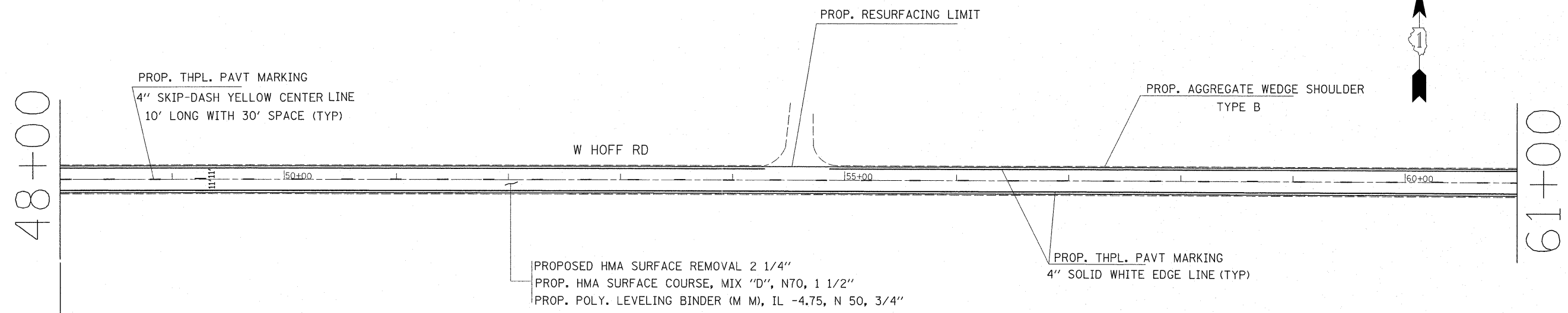

FILE NAME =	USER NAME = karabowiczje	DESIGNED -	REVISED -	STATE OF ILLINOIS DEPARTMENT OF TRANSPORTATION	OR 0297 /HOFF RD (OLD CHICAGO RD TO CMSTR&P RR) ROADWAY AND PAVEMENT MARKING PLANS	OR	SECTION	COUNTY	TOTAL	SHEET	
ca\pwwork\pwwdot\karabowiczje\d0208530	D163010-sht-plan.dgn	DRAWN -	REVISED -			0297	1G-RS-2	WILL.	17	6	
PLOT SCALE = 50,0000 ' / IN.		CHECKED -	REVISED -			CONTRACT NO. 60L10					
PLOT DATE = 4/11/2011		DATE -	REVISED -			ILLINOIS FED. AID PROJECT					
					SCALE:	SHEET NO.	OF	SHEETS	STA.	TO STA.	

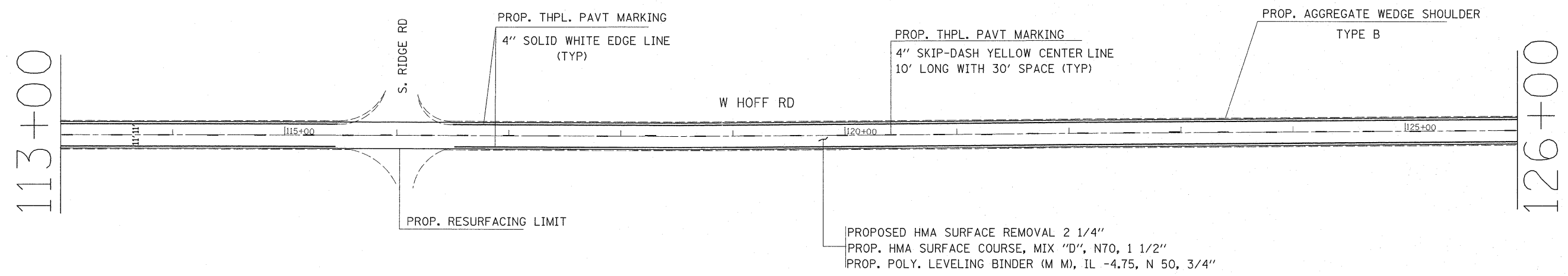
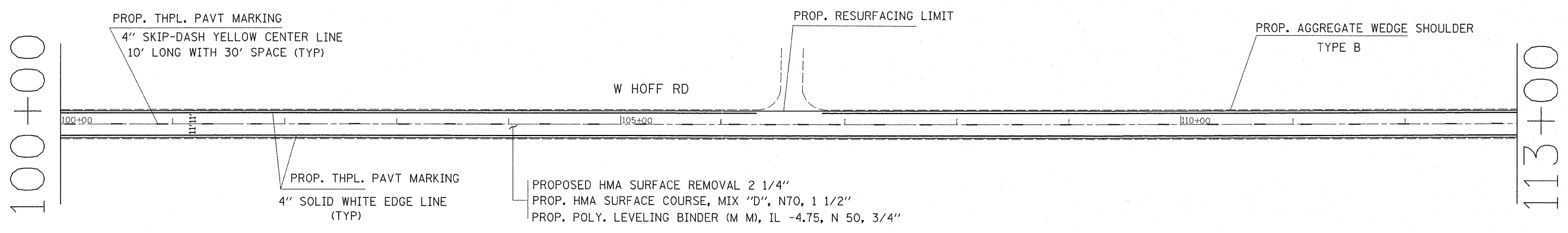
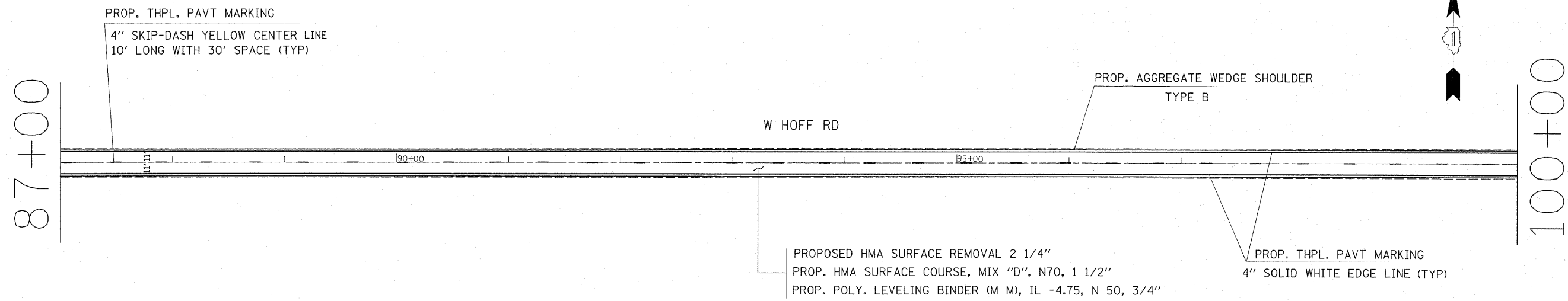
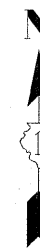

FILE NAME = c:\pwwork\pwwork\karabowiczje\d208530	USER NAME = karabowiczje	DESIGNED -	REVISED -	STATE OF ILLINOIS DEPARTMENT OF TRANSPORTATION	OR 0297 /HOFF RD (OLD CHICAGO RD TO CMSTR&P RR) ROADWAY AND PAVEMENT MARKING PLANS	OR RTE.	SECTION	COUNTY	TOTAL SHEETS	SHEET NO.	
	D163810-sht-pln.dgn	DRAWN -	REVISED -			0297	16-RS-2	WILL	17	7	
	PLOT SCALE = 50.0000' / IN.	CHECKED -	REVISED -			SCALE: SHEET NO. OF SHEETS STA. TO STA.			CONTRACT NO. 60L10		
	PLOT DATE = 4/11/2011	DATE -	REVISED -			ILLINOIS FED. AID PROJECT					

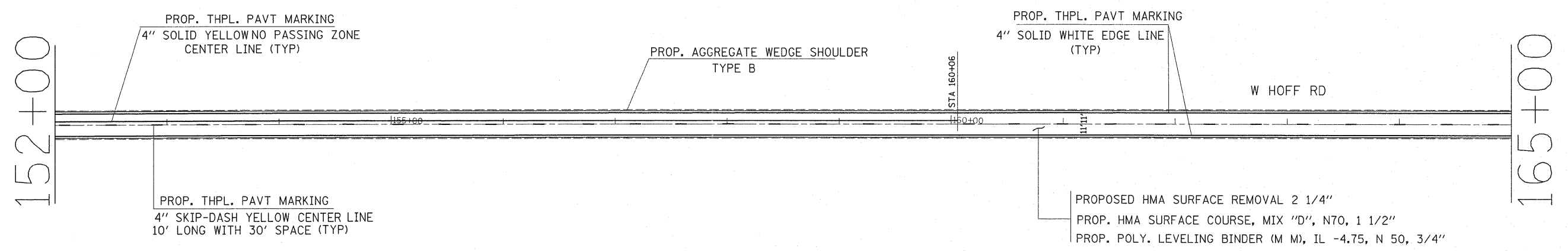
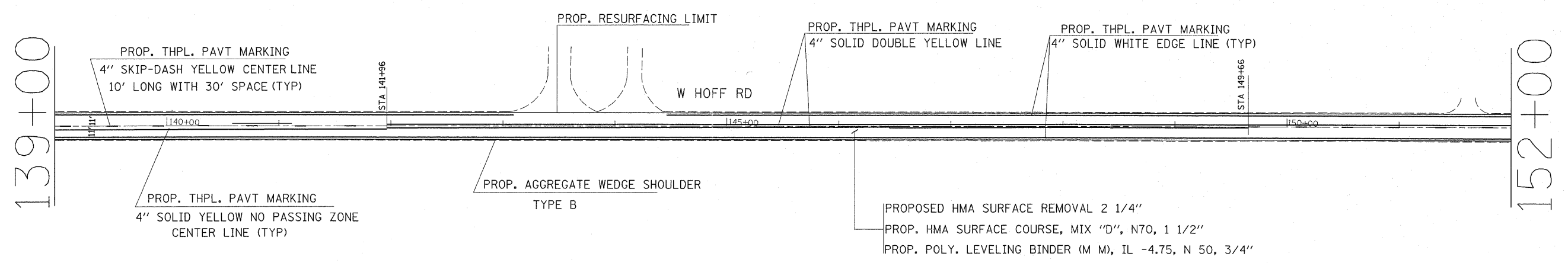
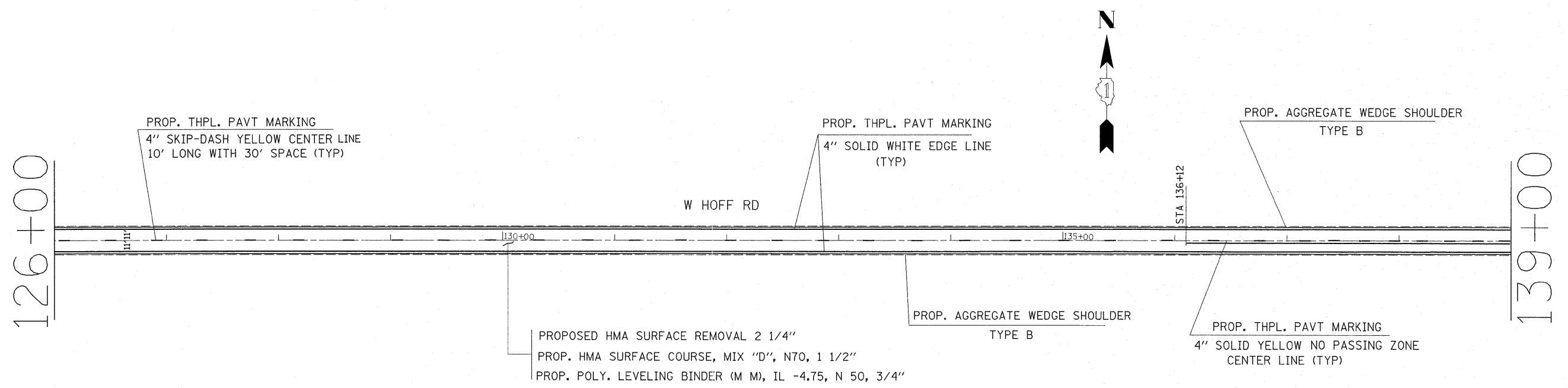

FILE NAME =	USER NAME = karabowiczje	DESIGNED -	REVISED -	STATE OF ILLINOIS DEPARTMENT OF TRANSPORTATION	OR 0297 /HOFF RD (OLD CHICAGO RD TO CMSTR&P RR) ROADWAY AND PAVEMENT MARKING PLANS	OR	SECTION	COUNTY	TOTAL	SHEET
c:\pwork\pwork\karabowiczje\d02208530	D163810-shht-plan.dgn	DRAWN -	REVISED -			0297	1G-R5-2	WILL	17	8
PLT SCALE = 50.0000' / IN.	CHECKED -	REVISED -	REVISED -			CONTRACT NO. 60L10				
PLT DATE = 4/11/2011	DATE -	REVISED -	REVISED -			SCALE:	SHEET NO.	OF	SHEETS	STA.

165+00

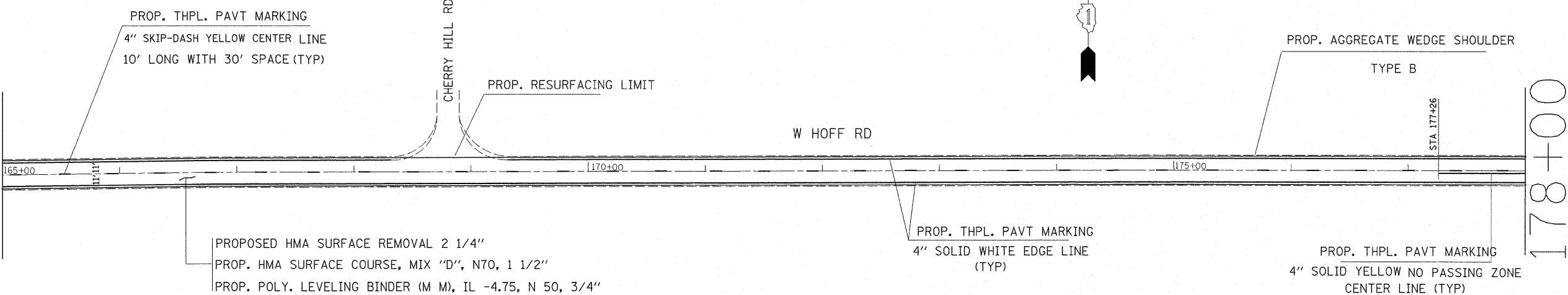

178+00

178+00

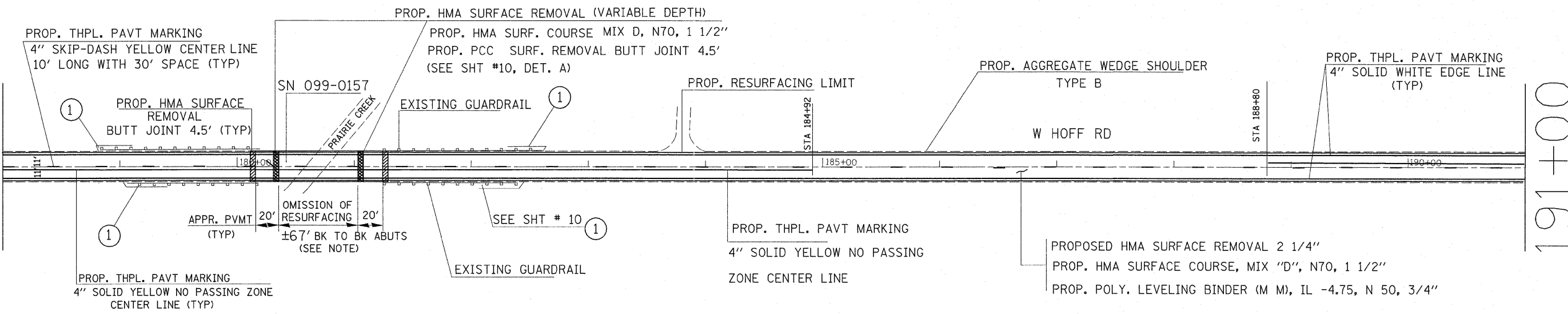

191+00

191+00

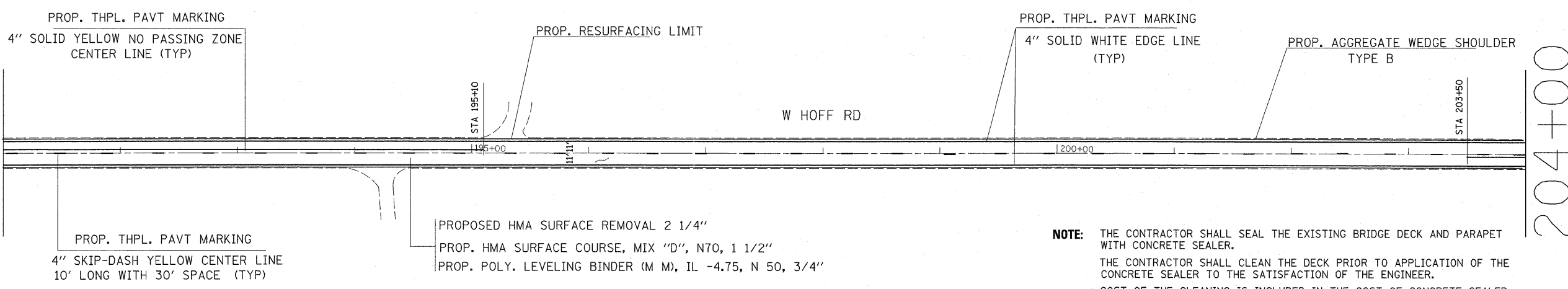

204+00

NOTE: THE CONTRACTOR SHALL SEAL THE EXISTING BRIDGE DECK AND PARAPET WITH CONCRETE SEALER.
 THE CONTRACTOR SHALL CLEAN THE DECK PRIOR TO APPLICATION OF THE CONCRETE SEALER TO THE SATISFACTION OF THE ENGINEER.
 COST OF THE CLEANING IS INCLUDED IN THE COST OF CONCRETE SEALER.
 SEE BRIDGE PLANS SHT # 11.

FILE NAME =	USER NAME = karabowiczje	DESIGNED -	REVISED -	STATE OF ILLINOIS DEPARTMENT OF TRANSPORTATION	OR 0297 /HOFF RD (OLD CHICAGO RD TO CMSTR&P RR) ROADWAY AND PAVEMENT MARKING PLANS	OR	SECTION	COUNTY	TOTAL	SHEET
ca:\pwork\pwork\karabowiczje\d208530	D163810-sht-plen.dgn	DRAWN -	REVISED -			0297	1G-RS-2	WILL	17	9
	PLOT SCALE = 50,0000 ' / IN.	CHECKED -	REVISED -			CONTRACT NO. 60L10				
	PLOT DATE = 4/11/2011	DATE -	REVISED -			ILLINOIS FED. AID PROJECT				

204+00

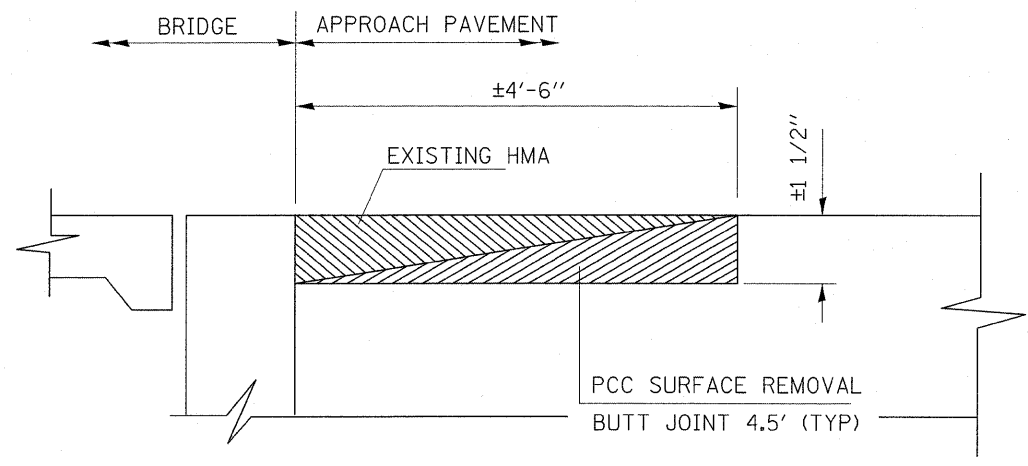
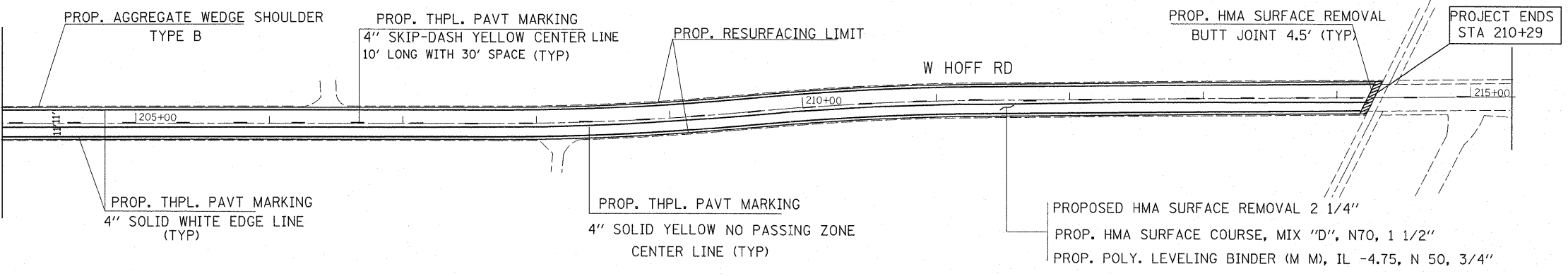

DETAIL A

- 1 EXIST. TERMINAL SECTION TO BE REPLACED WITH NEW TYPE 1 (SPECIAL) - TANGENT 50 FT LONG, SEE STD 630301 & DISTRICT DETAIL (BD-34).
- OTHER PAY ITEMS WITH QUANTITIES ESTIMATED FOR THIS AREA INCLUDE:
- REMOVAL AND DISPOSAL OF UNSUITABLE MATERIAL;
- FURNISHED EXCAVATION;
- TOP SOIL FURNISH AND PLACE, 4";
- SEEDING, CLASS 2A;
- NITROGEN FERTILIZER NUTRIENT;
- PHOSPHORUS FERTILIZER NUTRIENT;
- POTASSIUM FERTILIZER NUTRIENT;
- EROSION CONTROL BLANKET;
- AGGREGATE SHOULDER, TYPE B-6";
- GUARDRAIL REMOVAL;

FILE NAME =	USER NAME = gorengautab	DESIGNED -	REVISED -	STATE OF ILLINOIS DEPARTMENT OF TRANSPORTATION	OR 0297 /HOFF RD (OLD CHICAGO RD TO CMSTR&P RR) ROADWAY AND PAVEMENT MARKING PLANS	OR	SECTION	COUNTY	TOTAL	SHEET	
ci\pw_work\pwsdot\gorengautab\0208530	163810-ahp-plan.dgn	DRAWN -	REVISED -			0297	1G-RS-2	WILL	17	10	
	PLOT SCALE = 50.0000' / IN.	CHECKED -	REVISED -			CONTRACT NO. 60L10					
	PLOT DATE = 4/12/2011	DATE -	REVISED -			ILLINOIS FED. AID PROJECT					

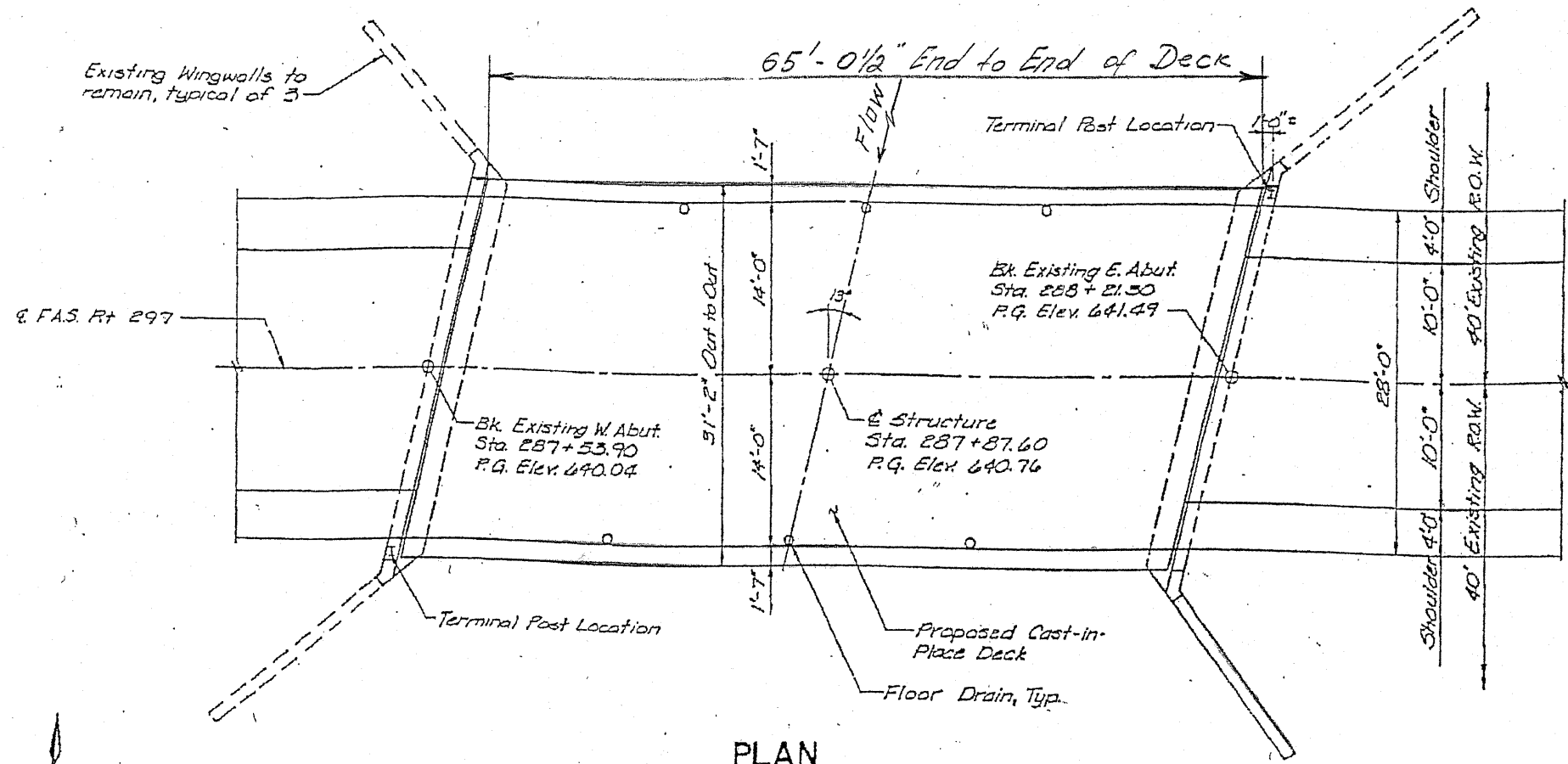

PLAN

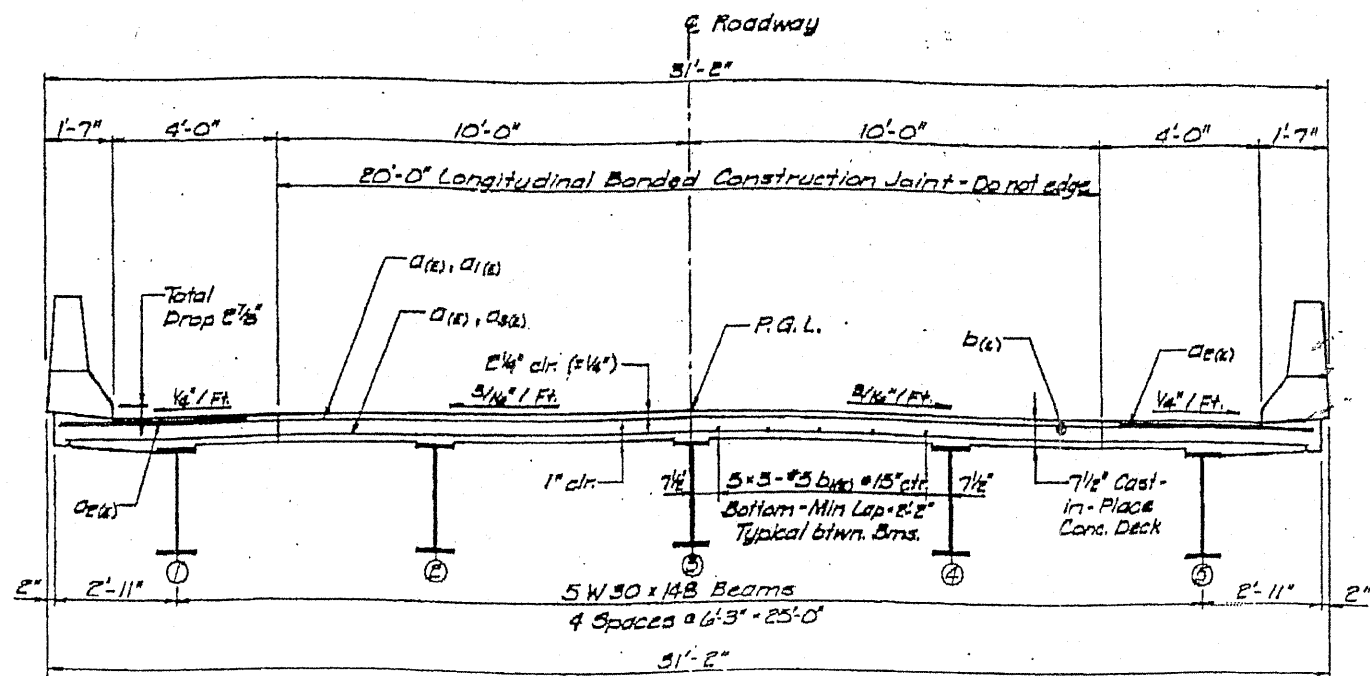

CROSS SECTION
(Looking East)

GENERAL NOTES

1. Fasteners shall be high strength bolts (AASHTO M-164, Type 3). Bolts $\frac{3}{4}$ " ϕ , Open holes $\frac{1}{16}$ " ϕ , unless otherwise noted.
2. Calculated weight of Structural Steel = 47,026 pounds (M-223 Gr. 50). Calculated weight of Structural Steel = 6,340 pounds (M-153).
3. The Zinc-silicate and vinyl paint system shall be used for shop and field painting of Structural Steel except where noted otherwise. The color of the vinyl finish coat shall be Munsell No. 7.5 G 4/13, Interstate Green.
4. All Structural Steel shall be AASHTO M-153, unless noted otherwise.
5. Field welding of construction accessories will not be permitted to the bottom flange of beams. Field welding in other areas will be permitted only when approved by the Engineer.
6. The Structural Steel Bearing Plates of the Elastomeric Bearing Assembly shall conform to the requirements of AASHTO M-183, Grade 36.
7. The main load carrying member components subject to tensile stress shall conform to the Supplemental Requirements for Notch Toughness Zone 2. These components are the wide flange beams.
8. Reinforcement bars shall conform to the requirements of AASHTO M-31, M-42, or M-53 Grade 60.
9. Plan dimensions and details relative to existing structure have been taken from existing plans and are subject to nominal construction variations. It shall be the Contractor's responsibility to verify such dimensions and details in the field and make necessary approved adjustments prior to construction or ordering of materials. Such variations shall not be cause for additional compensation for a change in the scope of the work, however, the Contractor will be paid for the quantity actually furnished at the unit price bid for the work.
10. For cantilever forming brackets, See Special Provisions.
11. Bridge Seat Sealer shall be applied to seat area of the abutments. Estimated Quantity = 121 sq. ft.

FOR INFORMATION ONLY

FILE NAME = c:\pwwork\pwwork\karabowicz\je\d0208538	USER NAME = karabowicz_je D163818-sht-plan.dgn	DESIGNED - DRAWN -	REVISED - REVISED -	STATE OF ILLINOIS DEPARTMENT OF TRANSPORTATION	SN 099-0157 HOFF RD OVER PRAIRIE CREEK EXISTING BRIDGE PLAN			OR RTE. 297	SECTION 1G-RS-2	COUNTY WILL	TOTAL SHEETS 17	SHEET NO. 11
PLOT SCALE = 100.0000' / IN.	PLOT DATE = 4/9/2011	CHECKED - DATE -	REVISED - REVISED -		SCALE:	SHEET NO. OF SHEETS	STA. TO STA.	CONTRACT NO. 60L10 ILLINOIS FED. AID PROJECT				

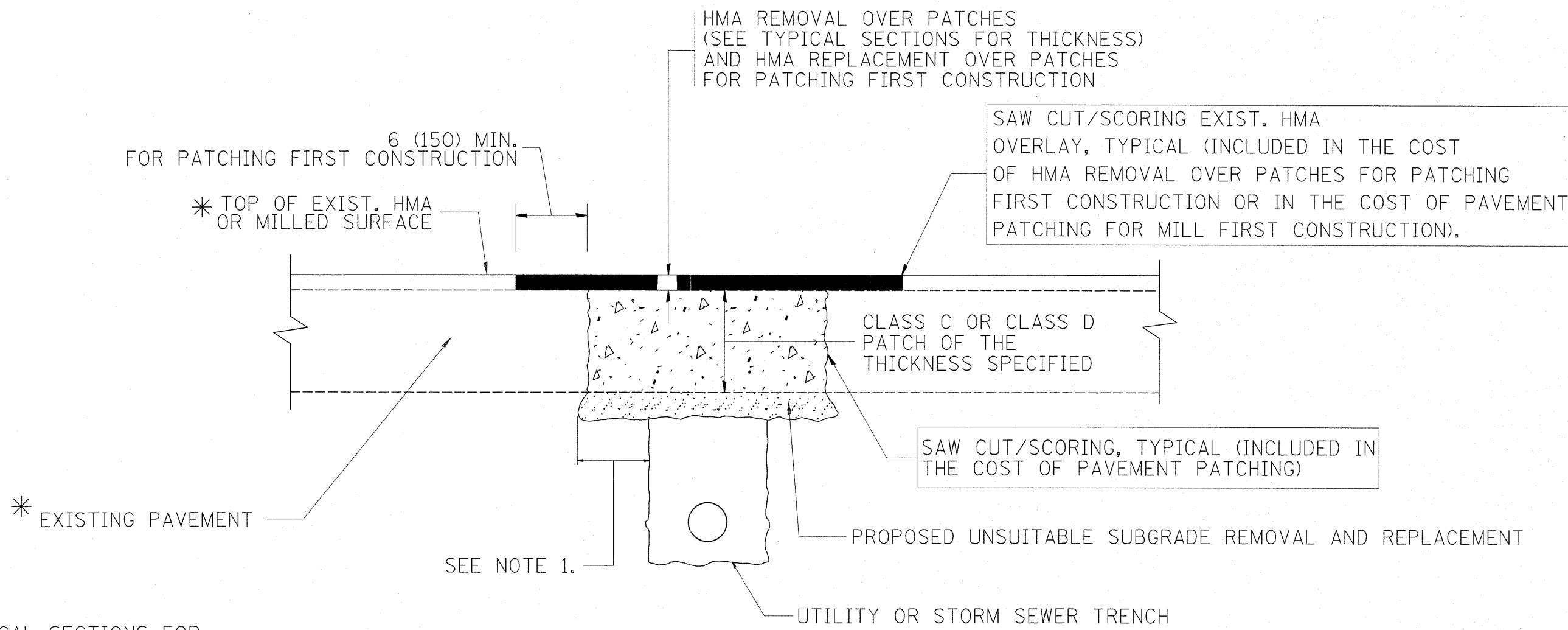

* SEE TYPICAL SECTIONS FOR THICKNESS AND MATERIALS

NOTES:

1. THE WIDTH OF THE FULL DEPTH PATCH OVER A TRENCH SHALL BE 12 (300) WIDER ON EACH SIDE OF THE TRENCH.
2. FOR METHOD OF MEASUREMENT AND BASIS OF PAYMENT, SEE RECURRING SPECIAL PROVISION "PATCHING WITH HOT-MIX ASPHALT OVERLAY REMOVAL".

SEQUENCE OF CONSTRUCTION (PATCHING FIRST)

1. REMOVE THE EXISTING HMA MATERIAL OVER THE AREA TO BE PATCHED.
2. REMOVE AND REPLACE WITH CLASS C OR D PATCH.
3. REPLACE HMA MATERIAL OVER THE AREA TO BE PATCHED.

SEQUENCE OF CONSTRUCTION (MILLING FIRST)

1. MILL HMA FIRST IF THERE IS AT LEAST 4 1/2 INCHES OR MORE OF HMA MATERIAL ON TOP OF THE EXISTING PAVEMENT OR IF THE PAVEMENT IS FULL DEPTH HMA. A MINIMUM OF 2 INCHES OF HMA MATERIAL SHALL BE IN PLACE AFTER MILLING.
2. REMOVE AND REPLACE WITH FULL DEPTH CLASS D PATCHES TO TOP OF MILLED SURFACE.

ALL DIMENSIONS ARE IN INCHES (MILLIMETERS) UNLESS OTHERWISE SHOWN.

FILE NAME =	USER NAME = karabowicz.je	DESIGNED - R. SHAH	REVISED - A. ABBAS 04-27-98	STATE OF ILLINOIS DEPARTMENT OF TRANSPORTATION	PAVEMENT PATCHING FOR HMA SURFACED PAVEMENT		F.A. RTE. 0297	SECTION 1G-RS-2	COUNTY WILL	TOTAL SHEETS 17	SHEET NO. 12
c:\pw_work\pw\dot\karabowicz.je\d0208530	DistStd.dgn	DRAWN -	REVISED - R. BORO 01-01-07		SCALE: NONE	SHEET NO. 1 OF 1 SHEETS	STA. TO STA.	BD400-04 (BD-22)		CONTRACT NO. 60L10	
	PLOT SCALE = 50.0000 / / IN.	CHECKED -	REVISED - R. BORO 09-04-07		FED. ROAD DIST. NO. 1 ILLINOIS FED. AID PROJECT						
	PLOT DATE = 4/11/2011	DATE - 10-25-94	REVISED - K. ENG 10-27-08								

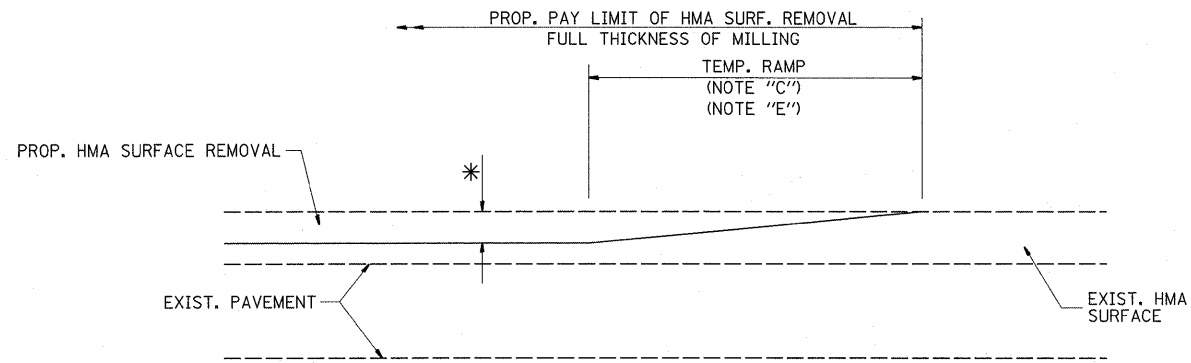

MILLED TEMPORARY RAMP
(FOR BUTT JOINT AND HMA TAPER SEE DETAIL BELOW)

OPTION 1

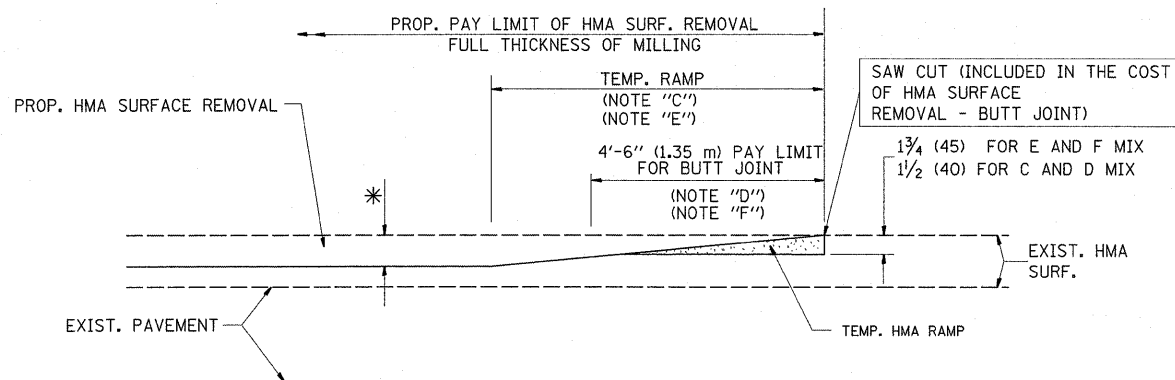

HMA CONSTRUCTED TEMPORARY RAMP
(FOR BUTT JOINT AND HMA TAPER SEE DETAIL BELOW)

OPTION 2
TYPICAL TEMPORARY RAMP

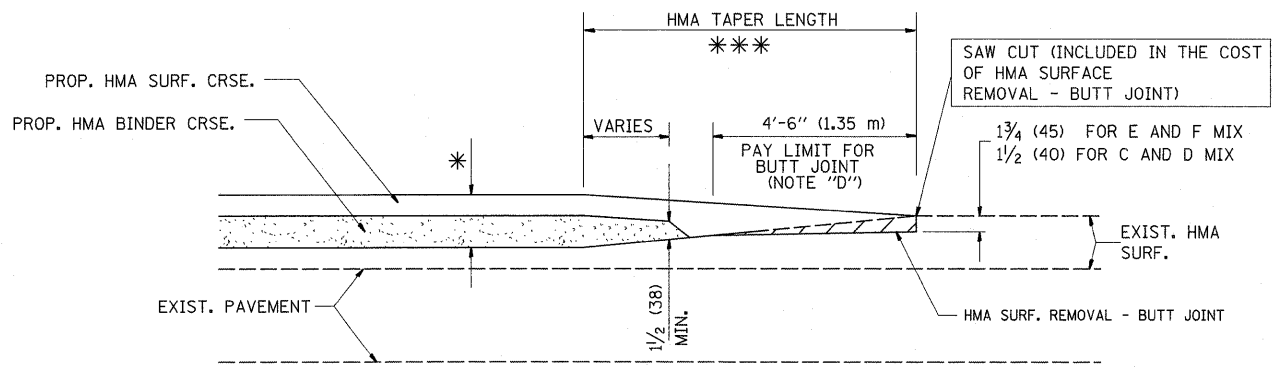

BUTT JOINT AND HMA TAPER
TYPICAL BUTT JOINT AND HMA TAPER FOR MILLING AND RESURFACING

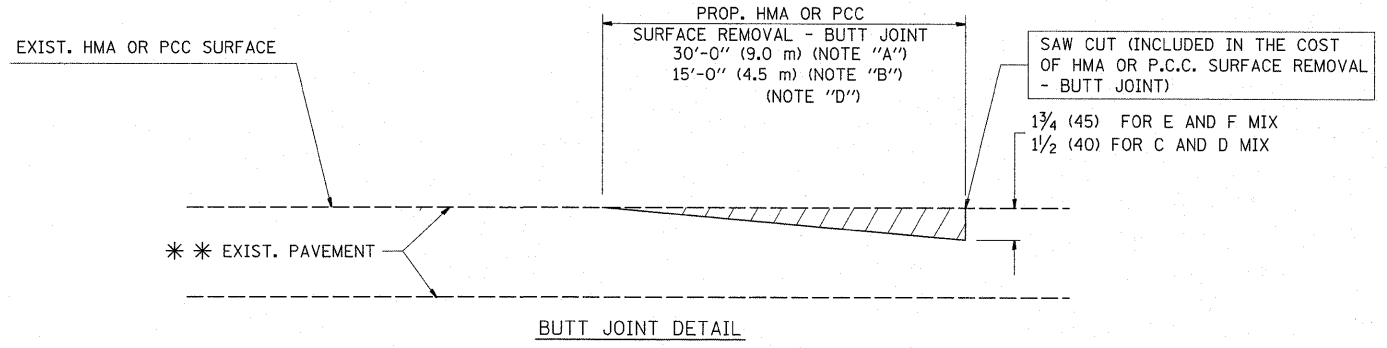

BUTT JOINT DETAIL

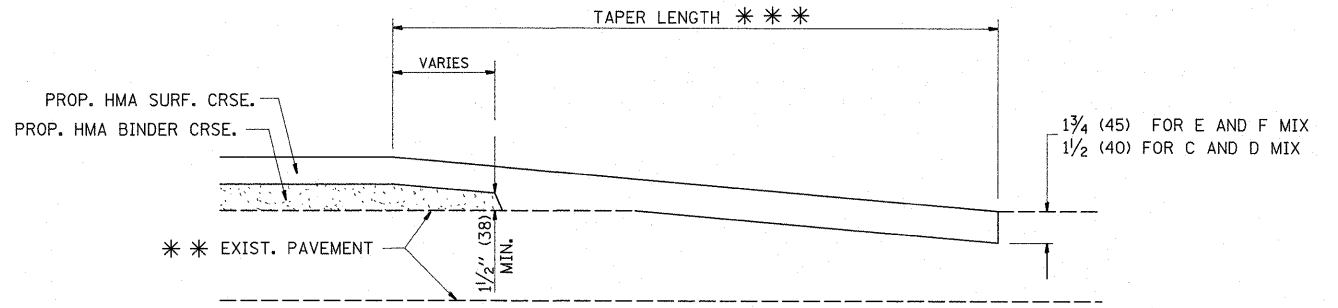

HMA TAPER DETAIL

TYPICAL BUTT JOINT AND HMA TAPER FOR RESURFACING ONLY

*** PC CONCRETE, HMA OR HMA RESURFACED PAVEMENT.

NOTES

- A: MAINLINE ROADWAYS AND MAJOR SIDE ROADS.
 - B: MINOR SIDE ROADS.
 - C: THE TEMP. RAMP SHALL BE CONSTRUCTED IMMEDIATELY UPON REMOVAL OF THE EXISTING HMA SURFACE.
 - D: THE BUTT JOINT SHALL BE CONSTRUCTED IMMEDIATELY PRIOR TO PLACING THE PROPOSED HMA COURSES.
 - E: TAPER THE TEMP. RAMP AT A RATE OF 3'-0" (900 mm) PER 1 INCH (25 mm) OF MILLING THICKNESS.
 - F: INSTALLATION AND REMOVAL OF THE 4'-6" (1.35 m) TEMP. RAMP IS INCLUDED IN COST OF HMA SURFACE REMOVAL - BUTT JOINT
 - G: SEE ARTICLE 406.08 AND 406.14 OF THE STANDARD SPECIFICATIONS FOR "HMA AND/OR PCC SURFACE REMOVAL, BUTT JOINT".
- * SEE TYPICAL SECTIONS FOR MILLING THICKNESS.
- *** 20'-0" (6.1 m) PER 1 (25) RESURFACING (NOTE "A")
10'-0" (3.0 m) PER 1 (25) RESURFACING (NOTE "B")

BASIS OF PAYMENT:

THE BUTT JOINT WILL BE PAID FOR AT THE CONTRACT UNIT PRICE PER SQUARE YARD (SQUARE METER) FOR "HOT-MIX ASPHALT SURFACE REMOVAL - BUTT JOINT" OR FOR "PORTLAND CEMENT CONCRETE SURFACE REMOVAL - BUTT JOINT".

ALL DIMENSIONS ARE IN INCHES (MILLIMETERS) UNLESS OTHERWISE SHOWN.

FILE NAME =	USER NAME = karabowiczje	DESIGNED - M. DE YONG	REVISED - R. SHAH 10-25-94
es:\pwork\pwork\karabowiczje\d0208530	D:\Std.dgn	DRAWN -	REVISED - A. ABBAS 03-21-97
	PLOT SCALE = 50,0000' / IN.	CHECKED -	REVISED - M. GOMEZ 04-06-01
	PLOT DATE = 4/12/2011	DATE - 06-13-90	REVISED - R. BORO 01-01-07

STATE OF ILLINOIS
DEPARTMENT OF TRANSPORTATION

BUTT JOINT AND HMA TAPER DETAILS			
SCALE: NONE	SHEET NO. 1 OF 1 SHEETS	STA.	TO STA.

F.A. RTE. =	SECTION	COUNTY	TOTAL SHEETS	SHEET NO.
0297	1G-RS-2	WILL	17	13
BD400-05 BD32		CONTRACT NO. 60L10		
FED. ROAD DIST. NO. 1 ILLINOIS FED. AID PROJECT				

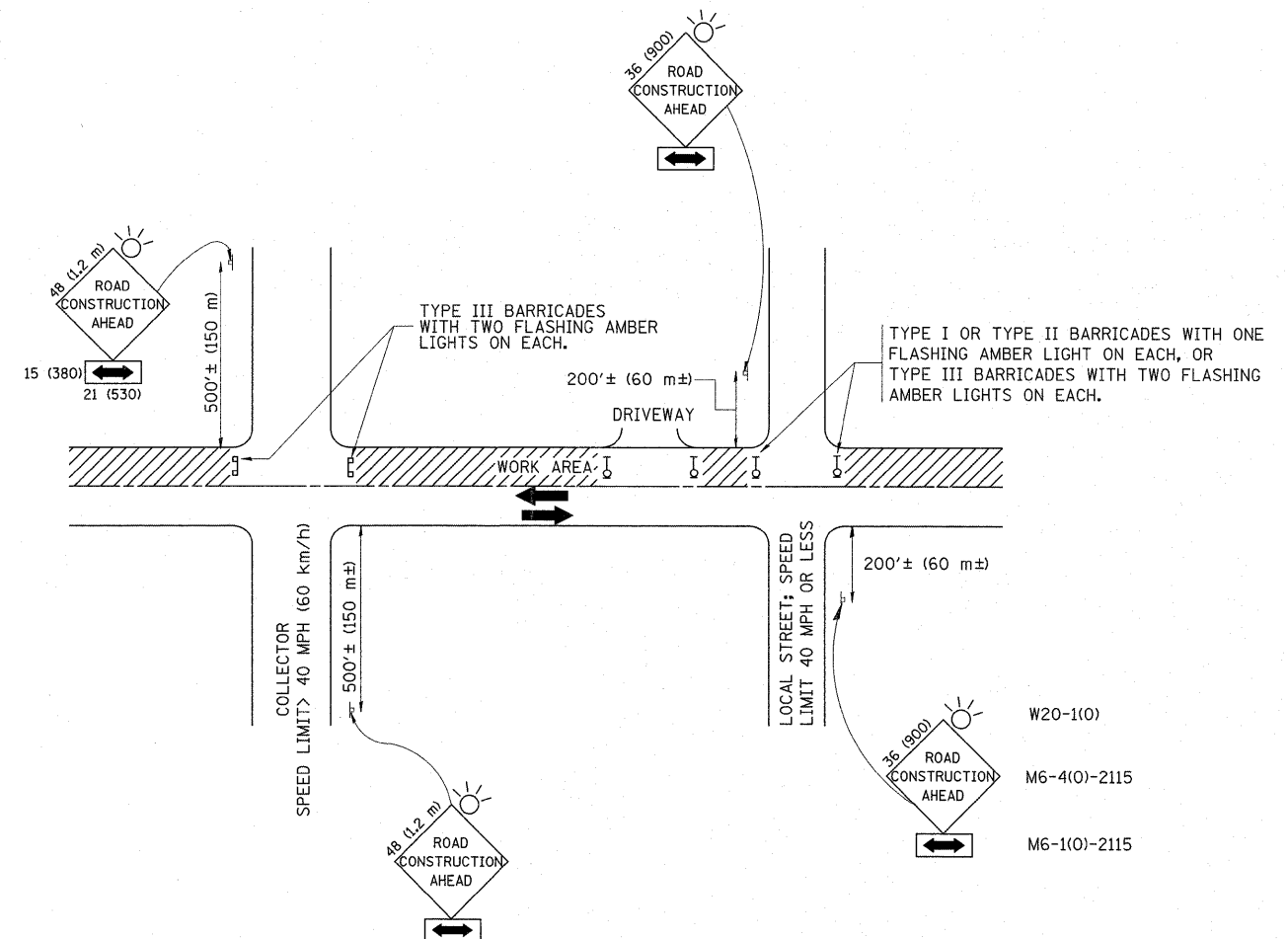

TRAFFIC CONTROL AND PROTECTION FOR SIDE ROADS, INTERSECTIONS, AND DRIVEWAYS

NOTES:

- A. FOR NO LANE RESTRICTION ON THE SIDE ROAD OR DRIVEWAYS
- SIDE ROAD WITH A SPEED LIMIT OF 40 MPH (60 km/h) OR LESS AS SHOWN ON THE DRAWING AND AS DIRECTED BY THE ENGINEER:
 - ONE ROAD CONSTRUCTION AHEAD SIGN 36 x 36 (900x900) WITH A FLASHER AND FLAG MOUNTED ON IT APPROXIMATELY 200' (60 m) IN ADVANCE OF THE MAIN ROUTE.
 - THE CLOSED PORTION OF THE MAIN ROUTE SHALL BE PROTECTED BY BLOCKING WITH TYPE I, TYPE II OR TYPE III BARRICADES, 1/3 OF THE CROSS SECTION OF THE CLOSED PORTION.
 - SIDE ROAD WITH A SPEED LIMIT GREATER THAN 40 MPH (60 km/h) AS SHOWN ON THE DRAWING AND AS DIRECTED BY THE ENGINEER:
 - ONE ROAD CONSTRUCTION AHEAD SIGN 48 x 48 (1.2 m x 1.2 m) WITH A FLASHER MOUNTED ON IT APPROXIMATELY 500' (150 m) IN ADVANCE OF THE MAIN ROUTE.
 - THE CLOSED PORTION OF THE MAIN ROUTE SHALL BE PROTECTED BY BLOCKING WITH TYPE III BARRICADES, 1/2 OF THE CROSS SECTION OF THE CLOSED PORTION.
 - WHEN THE SIDE ROAD LIES BETWEEN THE BEGINNING OF THE MAINLINE SIGNING AND THE WORK ZONE, A SINGLE HEADED ARROW (M6-1) SHALL BE USED IN LIEU OF THE DOUBLE HEADED ARROW (M6-4).
- B. FOR A LANE CLOSURE ON A SIDE ROAD OR DRIVEWAY:
- USE APPLICABLE PORTIONS OF THE TYPICAL APPLICATION OF TRAFFIC CONTROL DEVICES (STD. 701501, STD. 701606 OR THE APPROPRIATE STANDARD). THE SPACING OF SIGNS AND BARRICADES SHALL BE ADJUSTED FOR FIELD CONDITIONS AS DIRECTED BY THE ENGINEER. THE DIRECTIONAL ARROW SHALL BE COVERED OR REMOVED WHEN NO LONGER CONSISTENT WITH THE SIDE ROAD LANE CLOSURE.
- C. ADVANCE WARNING SIGNS ARE TO BE OMITTED ON DRIVEWAY UNLESS OTHERWISE NOTED.
- D. THE TRAFFIC CONTROL AND PROTECTION FOR SIDE ROADS, INTERSECTIONS, AND DRIVEWAYS SHALL BE INCIDENTAL TO THE COST OF SPECIFIED TRAFFIC CONTROL STANDARDS OR ITEMS.

All dimensions are in millimeters (Inches) unless otherwise shown.

FILE NAME =	USER NAME = karabowiczje	DESIGNED - LHA	REVISED - J. OBERLE 10-18-95	STATE OF ILLINOIS DEPARTMENT OF TRANSPORTATION	TRAFFIC CONTROL AND PROTECTION FOR SIDE ROADS, INTERSECTIONS, AND DRIVEWAYS			F.A. RTE.:	SECTION	COUNTY	TOTAL SHEETS	SHEET NO.	
0:\pr_work\puidot\karabowiczje\d0208530	D:\std.dgn	DRAWN -	REVISED - A. HOUSEH 03-06-96		SCALE: NONE	SHEET NO. 1 OF 1 SHEETS	STA.	TO STA.	0297	1G-RS-2	WILL	17	14
	PLOT SCALE = 50.0000 "/ IN.	CHECKED -	REVISED - A. HOUSEH 10-15-96		TC-10			CONTRACT NO.		60L10			
	PLOT DATE = 4/11/2011	DATE - 06-89	REVISED - T. RAMMACHER 01-06-00		FED. ROAD DIST. NO. 1 ILLINOIS FED. AID PROJECT								

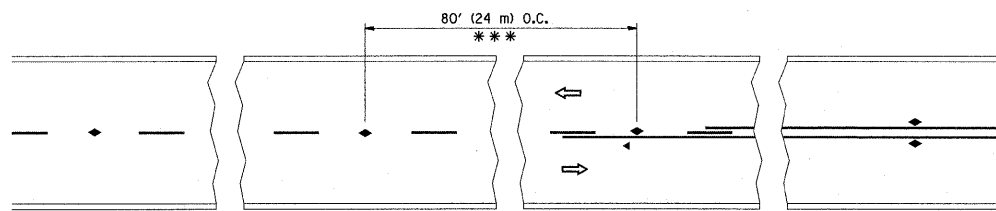

*** REDUCE TO 40' (12 m) O.C. ON CURVES WITH POSTED OR ADVISORY SPEED 45 M.P.H. (70 km/h) OR LESS.

TWO-LANE/TWO-WAY

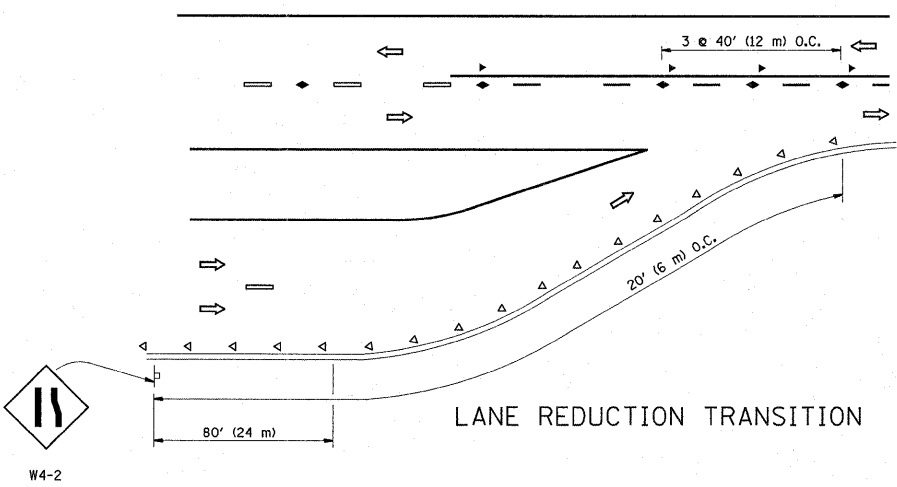

LANE REDUCTION TRANSITION

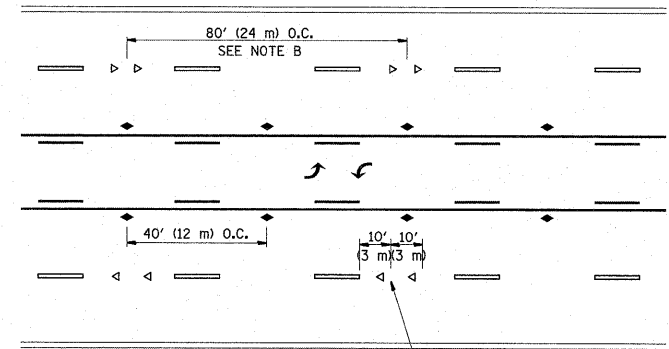

TWO-WAY LEFT TURN

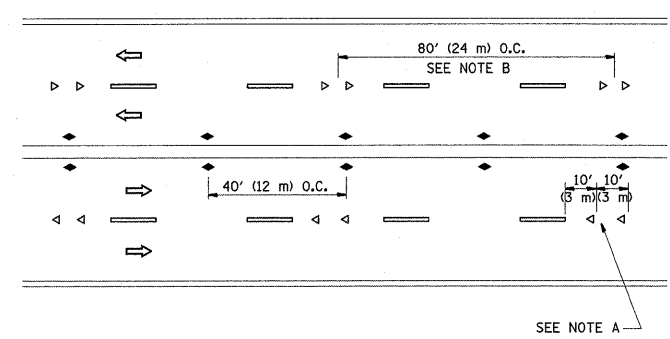

MULTI-LANE/UNDIVIDED

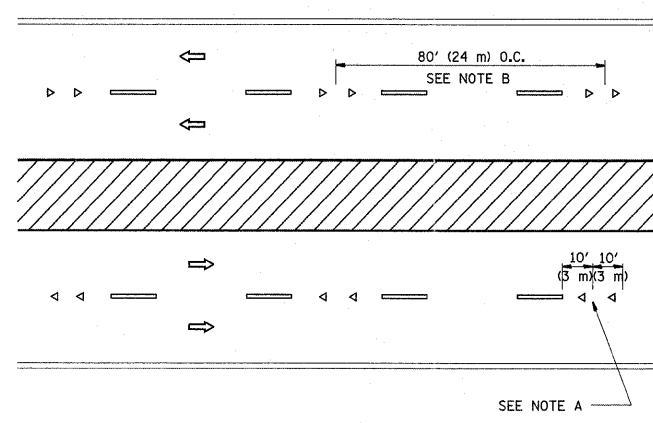

MULTI-LANE/DIVIDED

GENERAL NOTES

1. MARKERS USED WITH DASHED LINES SHALL BE CENTERED IN THE GAP BETWEEN SEGMENTS.
2. MARKERS USED ADJACENT TO SOLID LINES SHALL BE OFFSET 2 TO 3 (50 TO 75) TOWARD TRAFFIC AS SHOWN.
3. MARKERS THROUGH TANGENTS LESS THAN 500' (150 m) IN LENGTH BETWEEN CURVES SHALL BE INSTALLED AT THE LESSER OF THE TWO CURVE SPACINGS.

SYMBOLS

- YELLOW STRIPE
- WHITE STRIPE
- ◀ ONE-WAY AMBER MARKER
- ◀ ONE-WAY CRYSTAL MARKER (W/O)
- ◆ TWO-WAY AMBER MARKER

LANE MARKER NOTES

- A. USE DOUBLE LANE LINE MARKERS SPACED AS SHOWN.
- B. REDUCE TO 40' (12 m) O.C. ON CURVES WHERE ADVISORY SPEEDS ARE 10 M.P.H. (20 km/h) LOWER THAN POSTED SPEEDS.

DESIGN NOTES

1. DOUBLE LANE LINE MARKERS SHALL BE USED UNLESS SPECIFIED OTHERWISE.
2. EXCEPT AS SHOWN ON THE LANE REDUCTION TRANSITION AND FREEWAY EXIT RAMP DETAIL, MARKERS ARE NOT TO BE SPECIFIED ON RIGHT EDGE LINES.
3. THE EXACT MARKER LIMITS, SPACING, AND COLOR SHALL BE INCLUDED IN THE PLANS WHEN STANDARD SPECIFICATIONS ARE NOT BEING USED.
4. MARKERS SHOULD NOT BE USED ALONGSIDE CURBS EXCEPT FOR EXTREMELY SHORT SECTIONS OF CURBS WHERE NOT MORE THAN TWO MARKERS WOULD BE INVOLVED.

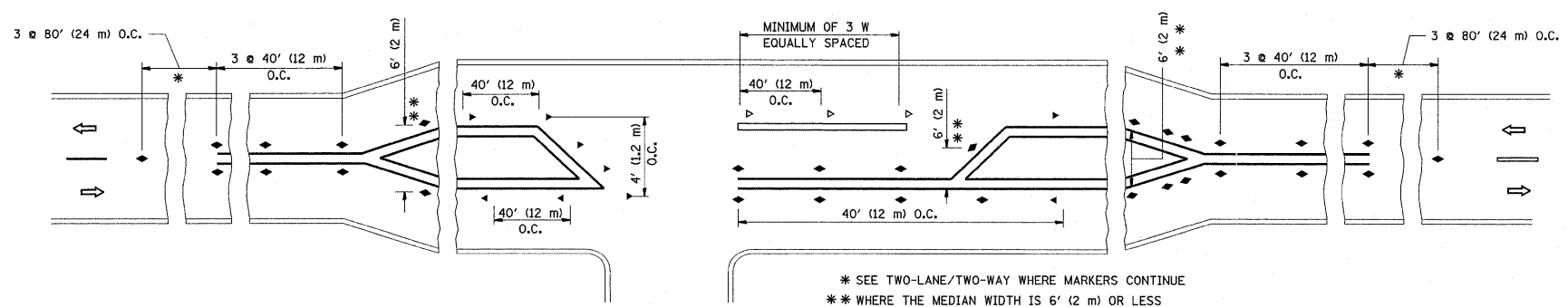

LEFT TURN

* SEE TWO-LANE/TWO-WAY WHERE MARKERS CONTINUE
 ** WHERE THE MEDIAN WIDTH IS 6' (2 m) OR LESS USE TWO-WAY MARKERS.

All dimensions are in Inches (millimeters) unless otherwise shown.

FILE NAME = c:\pwwork\pwwork\karabowiczje\d0208530	USER NAME = karabowiczje	DESIGNED -	REVISED - T. RAMMACHER 09-19-94	STATE OF ILLINOIS DEPARTMENT OF TRANSPORTATION	TYPICAL APPLICATIONS RAISED REFLECTIVE PAVEMENT MARKERS (SNOW-PLOW RESISTANT)		F.A. RTE.	SECTION	COUNTY	TOTAL SHEETS	SHEET NO.
	PLT SCALE = 50.0000' / IN.	DRAWN -	REVISED - T. RAMMACHER 03-12-99				0297	10-RS-2	WILL	17	15
PLT DATE = 4/11/2011	CHECKED -	REVISED - T. RAMMACHER 01-06-00	REVISED - C. JUCIUS 09-09-09	SCALE: NONE		SHEET NO. 1 OF 1 SHEETS	STA.	TO STA.	FED. ROAD DIST. NO. 1 ILLINOIS FED. AID PROJECT		
	DATE -								CONTRACT NO. 60L10		

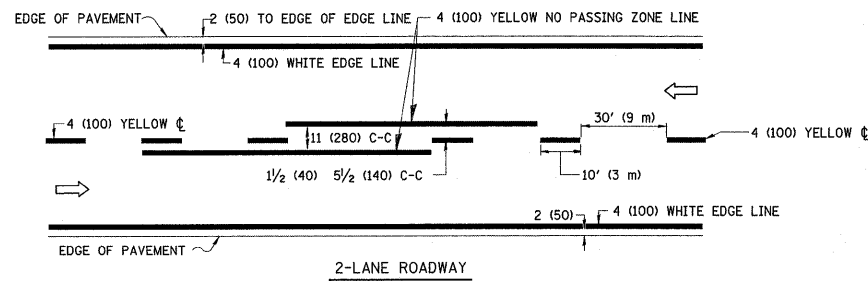

2-LANE ROADWAY

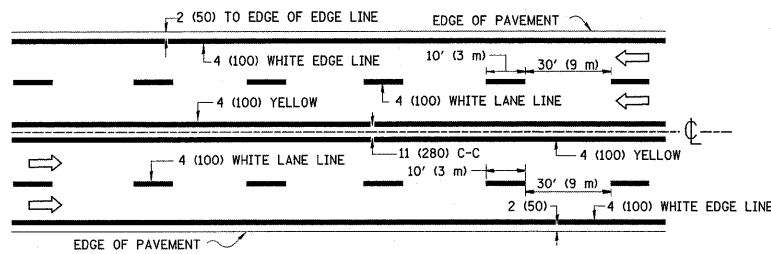

MULTI-LANE UNDIVIDED

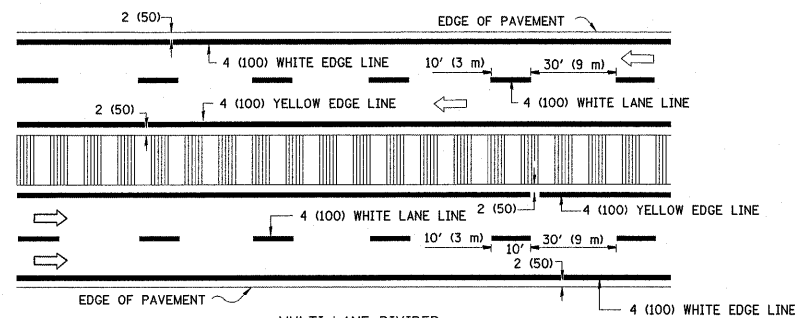

MULTI-LANE DIVIDED WITH MOUNTABLE MEDIAN

NOTE: MEDIANS WITH BARRIER CURB DO NOT REQUIRE AN EDGE LINE

TYPICAL LANE AND EDGE LINE MARKING

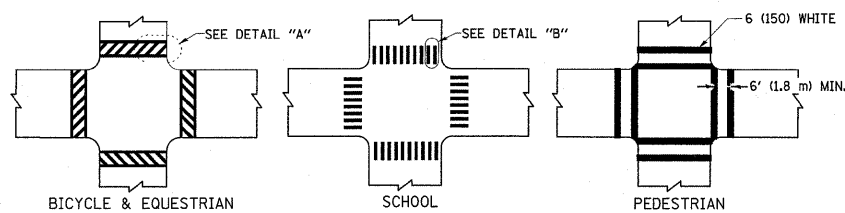

TYPICAL CROSSWALK MARKING

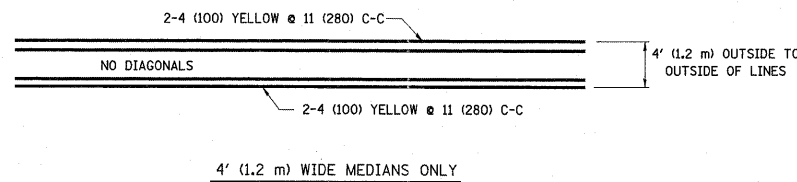

4' (1.2 m) WIDE MEDIANS ONLY

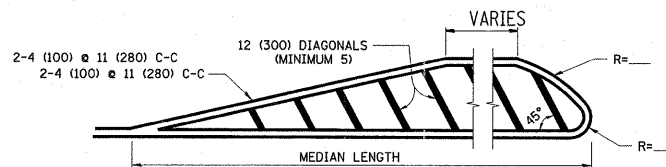

FOR MEDIAN LENGTHS WHERE DIAGONAL SPACING CANNOT BE ATTAINED, USE 5 (FIVE) EQUALLY SPACED DIAGONAL LINES.
DIAGONAL LINE SPACING: 50' (15 m) C-C (LESS THAN 30MPH (50 km/h))
75' (25 m) C-C 30MPH (50 km/h) TO 45MPH (70 km/h)
150' (45 m) C-C (MORE THAN 45MPH (70 km/h))

MEDIANS OVER 4' (1.2 m) WIDE

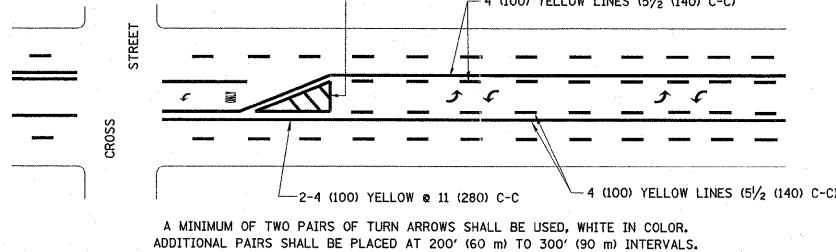

TYPICAL PAINTED MEDIAN MARKING

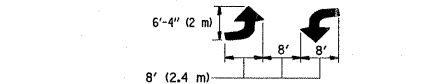

MEDIAN WITH TWO-WAY LEFT TURN LANE

TYPICAL TURN LANE MARKING

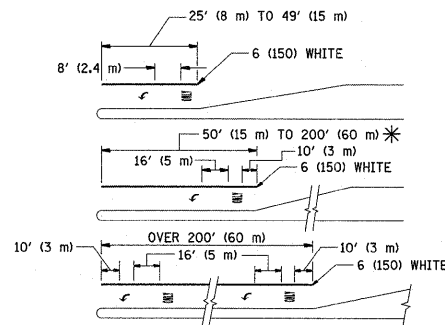

FULL SIZE LETTERS 8' (2.4 m) AND ARROWS SHALL BE USED.
AREA = 15.6 SQ. FT. (1.5 m²) ONLY AREA = 20.8 SQ. FT. (1.9 m²)
* TURN LANES IN EXCESS OF 400' (120 m) IN LENGTH MAY HAVE AN ADDITIONAL SET OF ARROW - "ONLY" INSTALLED MIDWAY BETWEEN THE OTHER TWO SETS OF ARROW - "ONLY".

TYPICAL LEFT (OR RIGHT) TURN LANE

TYPICAL TURN LANE MARKING

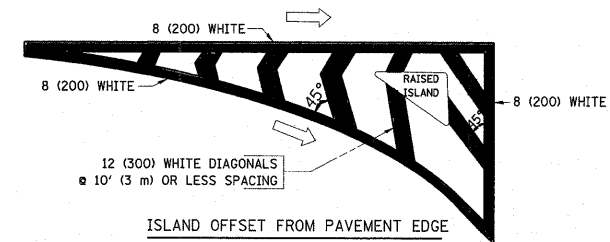

ISLAND OFFSET FROM PAVEMENT EDGE

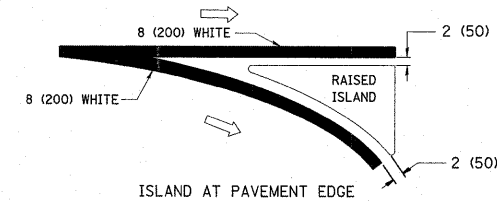

ISLAND AT PAVEMENT EDGE

TYPICAL ISLAND MARKING

TYPE OF MARKING	WIDTH OF LINE	PATTERN	COLOR	SPACING / REMARKS
CENTERLINE ON 2 LANE PAVEMENT	4 (100)	SKIP-DASH	YELLOW	10' (3 m) LINE WITH 30' (9 m) SPACE
CENTERLINE ON MULTI-LANE UNDIVIDED PAVEMENT	2 @ 4 (100)	SOLID	YELLOW	11 (280) C-C
NO PASSING ZONE LINES: FOR ONE DIRECTION FOR BOTH DIRECTIONS	4 (100) 2 @ 4 (100)	SOLID SOLID	YELLOW YELLOW	5/2 (140) C-C FROM SKIP-DASH CENTERLINE 11 (280) C-C OMIT SKIP-DASH CENTERLINE BETWEEN
LANE LINES	4 (100) 5 (125) ON FREEWAYS	SKIP-DASH SKIP-DASH	WHITE WHITE	10' (3 m) LINE WITH 30' (9 m) SPACE
DOTTED LINES (EXTENSIONS OF CENTER, LANE OR TURN LANE MARKINGS)	SAME AS LINE BEING EXTENDED	SKIP-DASH	SAME AS LINE BEING EXTENDED	2' (600) LINE WITH 6' (1.8 m) SPACE
EDGE LINES	4 (100)	SOLID	YELLOW-LEFT WHITE-RIGHT	OUTLINE MOUNTABLE MEDIANS IN YELLOW; EDGE LINES ARE NOT USED NEXT TO BARRIER CURB
TURN LANE MARKINGS	6 (150) LINE; FULL SIZE LETTERS & SYMBOLS (8' (2.4m))	SOLID	WHITE	SEE TYPICAL TURN LANE MARKING DETAIL
TWO WAY LEFT TURN MARKING	2 @ 4 (100) EACH DIRECTION 8' (2.4m) LEFT ARROW	SKIP-DASH AND SOLID IN PAIRS	YELLOW WHITE	10' (3 m) LINE WITH 30' (9 m) SPACE FOR SKIP-DASH; 5/2 (140) C-C BETWEEN SOLID LINE AND SKIP-DASH LINE SEE TYPICAL TWO-WAY LEFT TURN MARKING DETAIL
CROSSWALK LINES (PEDESTRIAN) A. DIAGONALS (BIKE & EQUESTRIAN) B. LONGITUDINAL BARS (SCHOOL)	2 @ 6 (150) 12 (300) @ 45° 12 (300) @ 90°	SOLID SOLID SOLID	WHITE WHITE WHITE	NOT LESS THAN 6' (1.8 m) APART 2' (600) APART 2' (600) APART SEE TYPICAL CROSSWALK MARKING DETAILS.
STOP LINES	24 (600)	SOLID	WHITE	PLACE 4' (1.2 m) IN ADVANCE OF AND PARALLEL TO CROSSWALK, IF PRESENT. OTHERWISE, PLACE AT DESIRED STOPPING POINT. PARALLEL TO CROSSROAD CENTERLINE, WHERE POSSIBLE
PAINTED MEDIANS	2 @ 4 (100) WITH 12 (300) DIAGONALS @ 45° NO DIAGONALS USED FOR 4' (1.2 m) WIDE MEDIANS	SOLID	YELLOW; TWO WAY TRAFFIC WHITE; ONE WAY TRAFFIC	11 (280) C-C FOR THE DOUBLE LINE SEE TYPICAL PAINTED MEDIAN MARKING.
GORE MARKING AND CHANNELIZING LINES	8 (200) WITH 12 (300) DIAGONALS @ 45°	SOLID	WHITE	DIAGONALS: 15' (4.5 m) C-C (LESS THAN 30MPH (50 km/h)) 20' (6 m) C-C 30MPH (50 km/h) TO 45MPH (70 km/h) 30' (9 m) C-C (OVER 45MPH (70 km/h))
RAILROAD CROSSING	24 (600) TRANSVERSE LINES; "RR" IS 6' (1.8 m) LETTERS; 16 (400) LINE FOR "X"	SOLID	WHITE	SEE STATE STANDARD 780001 AREA OF: "R"=3.6 SQ. FT. (0.33 m ²) EACH "X"=54.0 SQ. FT. (5.0 m ²)
SHOULDER DIAGONALS	12 (300) @ 45°	SOLID	WHITE - RIGHT YELLOW - LEFT	50' (15 m) C-C (LESS THAN 30MPH (50 km/h)) 75' (25 m) C-C (30 MPH (50 km/h) TO 45MPH (70 km/h)) 150' (45 m) C-C (OVER 45MPH (70 km/h))

FOR FURTHER DETAILS ON PAVEMENT MARKING REFER TO STANDARD SPECIFICATIONS FOR ROAD AND BRIDGE CONSTRUCTION AND STATE STANDARD 780001.

All dimensions are in inches (millimeters) unless otherwise shown.

FILE NAME =	USER NAME = kerabowiczje	DESIGNED - EVERS	REVISED - T. RAMMACHER 10-27-94
es:\pw_work\puidot\kerabowiczje\d0208530	DistStd.dgn	DRAWN -	REVISED - C. JUCIUS 09-09-09
	PLOT SCALE = 50,000% / IN.	CHECKED -	REVISED -
	PLOT DATE = 4/11/2011	DATE - 03-19-90	REVISED -

STATE OF ILLINOIS
DEPARTMENT OF TRANSPORTATION

DISTRICT ONE
TYPICAL PAVEMENT MARKINGS

SCALE: NONE SHEET NO. 1 OF 1 SHEETS STA. TO STA.

F.A. RTE. NO. 0297	SECTION 1G-RS-2	COUNTY WILL	TOTAL SHEETS 17	SHEET NO. 16
TC-13		CONTRACT NO. 60L10		
FED. ROAD DIST. NO. 1 ILLINOIS FED. AID PROJECT				

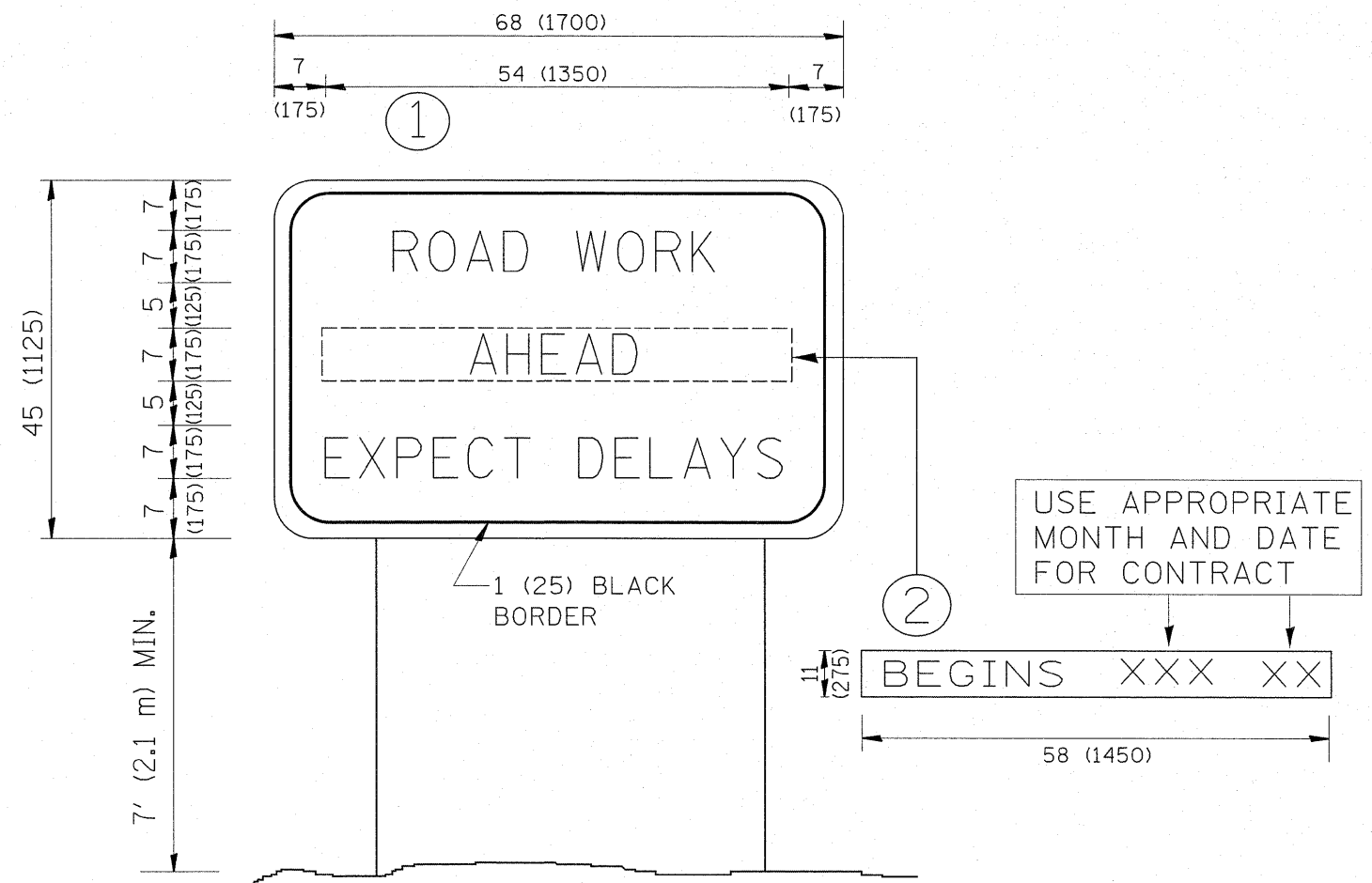

NOTES:

1. USE BLACK LETTERING ON ORANGE BACKGROUND.
2. ERECT SIGNS IN ADVANCE OF THE LOCATION FOR THE "ROAD CONSTRUCTION AHEAD" SIGN AT LOCATIONS AS DIRECTED BY THE ENGINEER.
3. ERECT SIGN ① WITH INSTALLED PANEL ② ONE WEEK PRIOR TO THE START OF CONSTRUCTION.
4. REMOVE PANEL ② SOON AFTER THE START OF CONSTRUCTION.
5. SEE SPECIAL PROVISION FOR "TEMPORARY INFORMATION SIGNING" FOR ADDITIONAL INFORMATION.
6. ONE SIGN ASSEMBLY EQUALS 25.70 SQ. FT. (2.3 SQ. M.)
7. SHALL BE PAID FOR AS TEMPORARY INFORMATION SIGNING.

ALL DIMENSIONS ARE IN INCHES (MILLIMETERS) UNLESS OTHERWISE SHOWN.

FILE NAME =	USER NAME = karabowiczje	DESIGNED -	REVISED - R. MIRS 09-15-97	STATE OF ILLINOIS DEPARTMENT OF TRANSPORTATION	ARTERIAL ROAD INFORMATION SIGN			F.A. RTE.	SECTION	COUNTY	TOTAL SHEETS	SHEET NO.
et\pw_work\puidat\karabowiczje\c0208530	DistStd.dgn	DRAWN -	REVISED - R. MIRS 12-11-97		0297	1G-RS-2	WILL	17	17			
	PLOT SCALE = 50.0000' / IN.	CHECKED -	REVISED - T. RAMMACHER 02-02-99		TC-22			CONTRACT NO. 60L10				
	PLOT DATE = 4/11/2011	DATE -	REVISED - C. JUCIUS 01-31-07		SCALE: NONE SHEET NO. 1 OF 1 SHEETS STA. TO STA.			FED. ROAD DIST. NO. 1 ILLINOIS FED. AID PROJECT				