

**BILL OF MATERIALS**

BAR	NO.	SIZE	LENGTH	SHAPE
a5(E)	8	#5	27'-0"	—
a6(E)	8	#5	29'-10"	—
a7(E)	3	#6	5'-0"	—
d(E)	4	#4	5'-9"	L
d1(E)	4	#5	3'-11"	L
h4(E)	4	#5	27'-3"	—
h5(E)	4	#5	30'-11"	—
u(E)	51	#5	3'-7"	□
x(E)	50	#5	2'-7"	□
x1(E)	4	#5	3'-0"	J
REINFORCEMENT BARS (EPOXY COATED)			POUND	1110
CONCRETE REMOVAL			CU.YD.	6.7
CONCRETE SUPERSTRUCTURE			CU.YD.	6.7
SILICONE JOINT SEALER 2 3/4"			FOOT	12

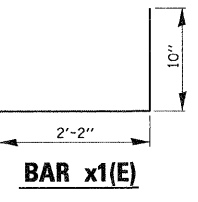

**NOTE:**  
 FOR BAR SPLICERS SEE SHEET NO. 17 OF 36.  
 BARS a2 AND h1 SHALL BE CUT IN PLACE TO FIT  
 SECTION A-A, B-B SEE SHEET NO. 14..

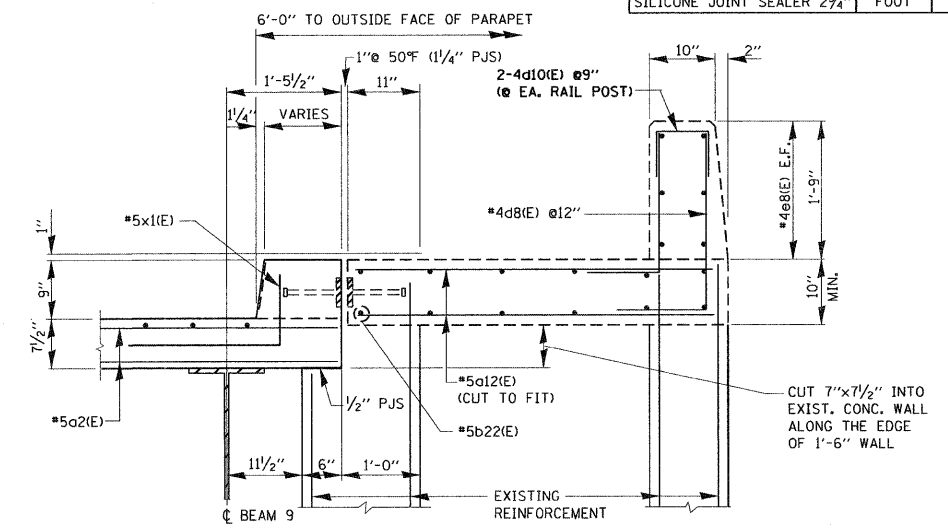