

Bench Mark: "X" cut on west bolt on fire hydrant, northwest corner of Halsted Street and 129th Pl., Elevation 601.53.

Existing Structure: The existing Structure consists of a main channel through truss span and a PPC I-Beam approach span at each end of the truss span. The original Structure was built in 1931 as Section Number K-B-2 and reconstructed in 1996. Staged construction shall be utilized to maintain traffic during construction.

No Salvage.

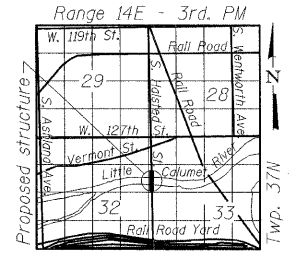

LOCATION SKETCH

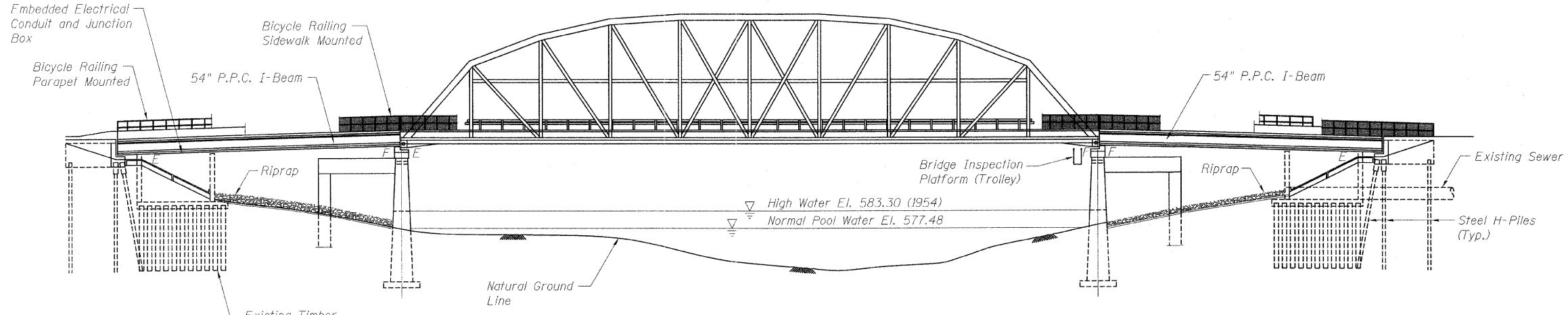

ELEVATION

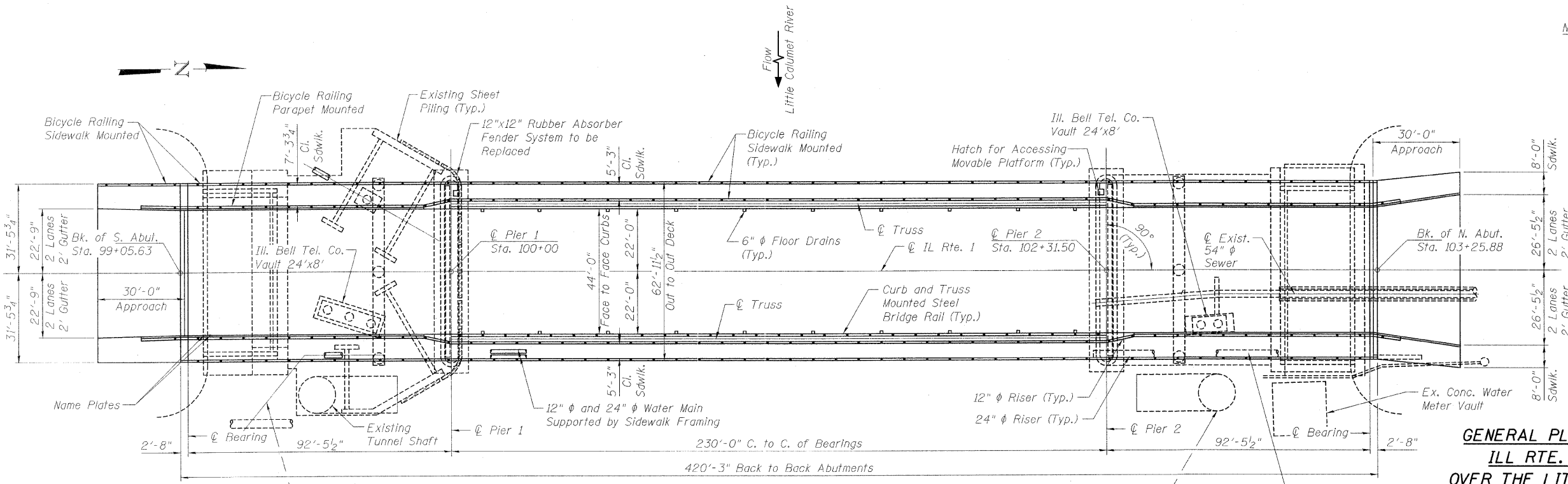

PLAN

Note:
Main truss span of bridge shall be washed from the lower chord to 15 feet above the deck (i.e. splash zone) according to Section 592 of the Standard Specifications. Bridge Washing shall be paid for as Bridge Washing No. 1.



COLLINS ENGINEERS, INC.
JAMES M. HAMELKA
NO. 81-6116
EXPIRES 11-30-2012

**GENERAL PLAN AND ELEVATION
ILL. RTE. 1 (HALSTED ST.)
OVER THE LITTLE CALUMET RIVER
F.A.U. RT. 3730 - SEC. K(B&C)2-BR-1
COOK COUNTY
STATION 101+15.80
STRUCTURE NO. 016-0193**

FILE NAME =	USER NAME =	DESIGNED - AMS	REVISD -	STATE OF ILLINOIS DEPARTMENT OF TRANSPORTATION	GENERAL PLAN AND ELEVATION STRUCTURE NO. 016-0193	F.A.U. RTE. 3730	SECTION K(B&C)2-BR-1	COUNTY COOK	TOTAL SHEETS 16	SHEET NO. 4	
PLOT SCALE =	DRAWN - DR	CHECKED - JMH	REVISD -			SHEET NO. 01 OF 08 SHEETS					
PLOT DATE =	CHECKED - JMH	REVISD -	REVISD -			CONTRACT NO. 60M84					
ILLINOIS FED. AID PROJECT											