

TRAFFIC SIGNAL LEGEND

	PROPOSED	EXISTING
SIGNAL HEAD WITH BACKPLATE		
SIGNAL HEAD		
CALVANIZED STEEL CONDUIT IN TRENCH OR PUSHED		
DETECTOR LOOP		
VEHICLE DETECTOR, NON COMPENSATED MAGNETIC TYPE		
RACEWAY FOR MAGNETIC DETECTOR, TYPE I OR TYPE II		

**SCHEDULE OF QUANTITIES
MAGNETIC DETECTOR AND LOOP DETECTOR REPLACEMENT**

Code No.	Quantity	Unit	Pay Item
87301305		Foot	Electric Cable in Conduit, Lead-in No. 14 1-Pair
88500100		Each	Inductive Loop Detector
88600100		Foot	Detector Loop, Type 1
85000200		Each	Maintenance of Existing Traffic Signal Installation
81900200		Foot	Trench and Backfill for Electrical Work
87900200		Each	Drill Existing Handhole
89502300		Foot	Remove Electric Cable from Conduit

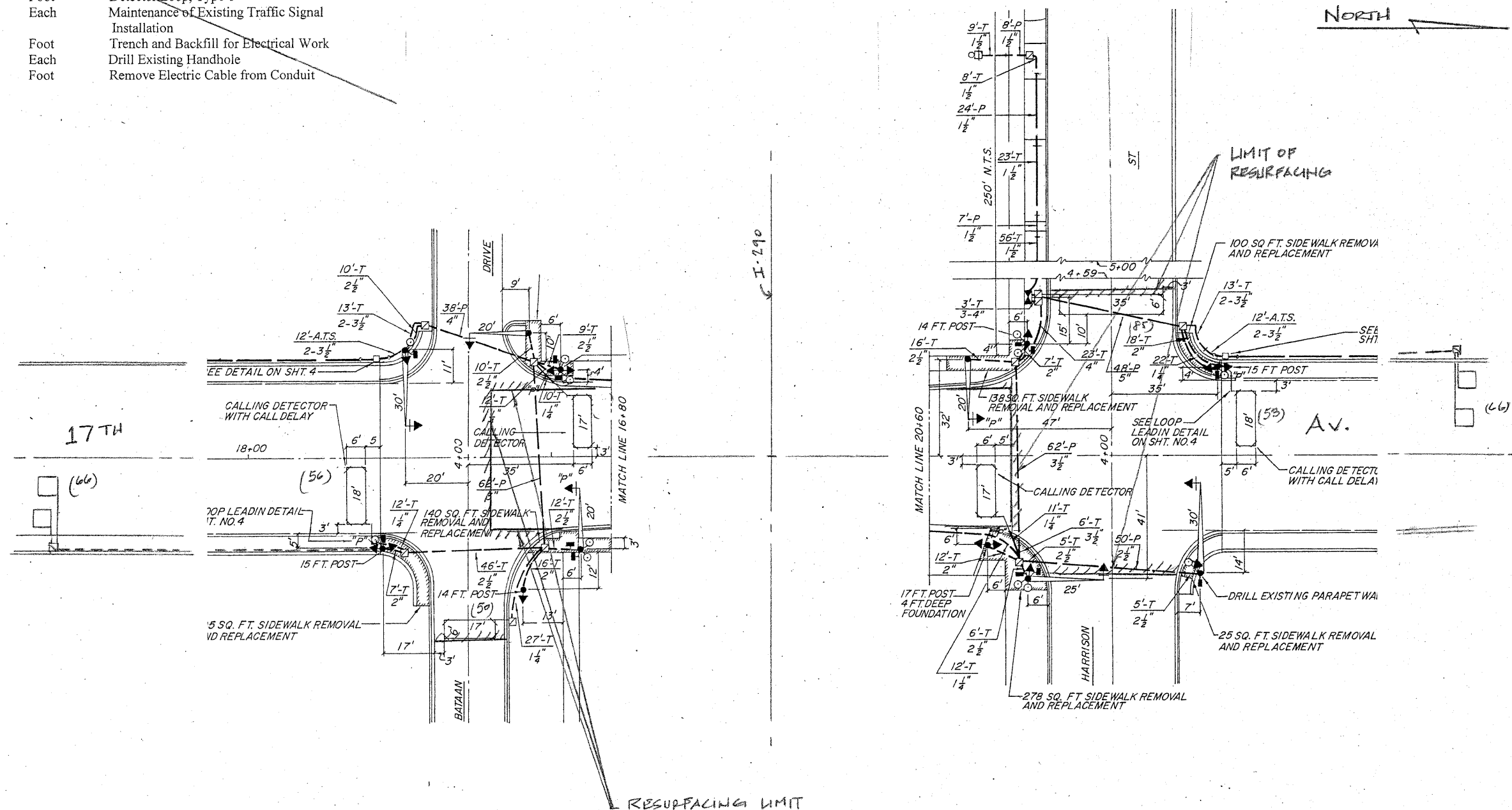

**THIS PLAN IS FOR THE SOLE PURPOSE OF
DETECTOR LOOP REPLACEMENTS ONLY**

**REPLACE ALL DETECTOR LOOPS AS SHOWN
(WITHIN THE RESURFACING LIMITS)**

CODE	QUANTITY	UNIT	ITEM
88600600	370	FOOT	DETECTOR LOOP, REPLACEMENT

Rev. Sheet 6-7-11

FILE NAME =	USER NAME = nguyensm	DESIGNED -	REVISED - MB-5/19/11	STATE OF ILLINOIS DEPARTMENT OF TRANSPORTATION	DISTRICT ONE - DETECTOR LOOP REPLACEMENT 17TH AV. @ I-290 - BATAAN/HARRISON	F.A. RTE.	SECTION	COUNTY	TOTAL SHEETS	SHEET NO.	
ca:\p\work\p\ridot\nguyensm\201125181\1011111111.dgn		DRAWN -	REVISED -			2722	2010-160-R5	COOK	25	12	
PLOT SCALE = 100.0000' / IN.		CHECKED -	REVISED -			CONTRACT NO. 60N74					
PLOT DATE = 12/1/2010		DATE -	REVISED -			FED. ROAD DIST. NO. ILLINOIS FED. AID PROJECT					