

BLACK ROAD

PAVEMENT REMOVAL

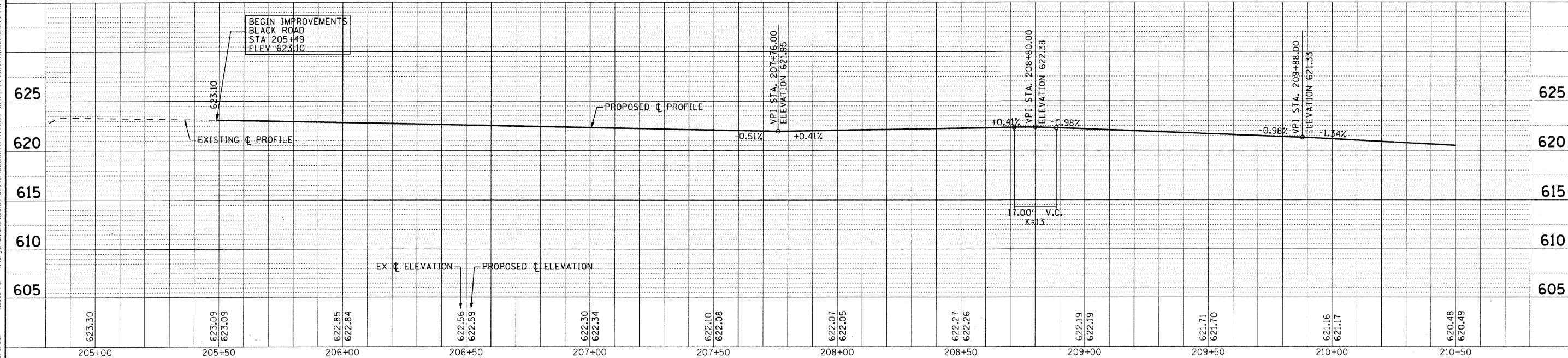

C:\projects\090491-PH2\Drawings\090491-PH2\090491-PH2.dwg
 DATE: 12/6/10
 DRAWN: UKB
 CHECKED: LDH
 DESIGNED: DSH
 REVISIONS: 1-19-11 PER VILLAGE



DESIGNED - DSH	REVISIONS - 1-19-11 PER VILLAGE
DRAWN - UKB	REVISIONS -
CHECKED - LDH	REVISIONS -
DATE - 12/6/10	FILE - 090491-PH2-pp1.sht

VILLAGE OF SHOREWOOD, ILLINOIS BLACK ROAD AND RIVER ROAD INTERSECTION IMPROVEMENTS

GEOMETRIC PLAN AND PROFILE BLACK ROAD

SCALE: H: 1"=20' V: 1"=5'
STA. 205+00 TO STA. 210+50

F.A.U. RTE. 0298 0396	SECTION 09-00028-00-CH	COUNTY WILL	TOTAL SHEETS 63	SHEET NO. 13
C-91-726-09		CONTRACT NO. 63562		
FED. ROAD DIST. NO. 1 ILLINOIS FED. AID PROJECT M-9003(385)				