

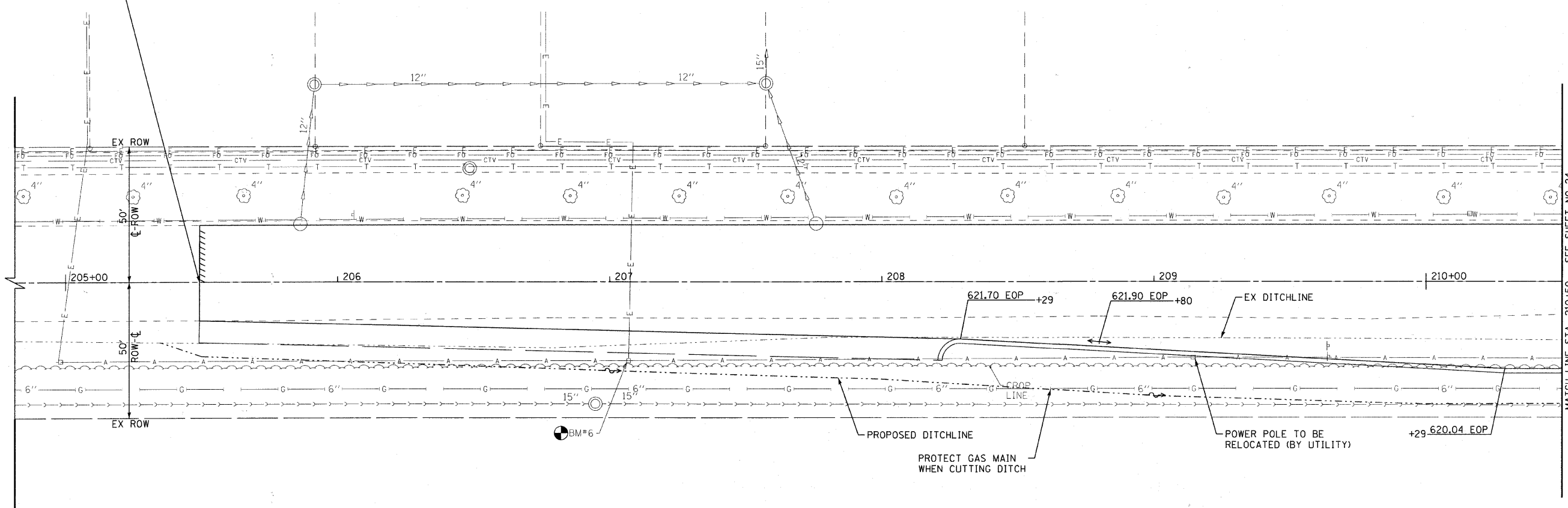

BEGIN IMPROVEMENTS  
BLACK ROAD  
STA. 205+49



MATCH LINE STA. 210+50 - SEE SHEET NO. 24

## BLACK ROAD

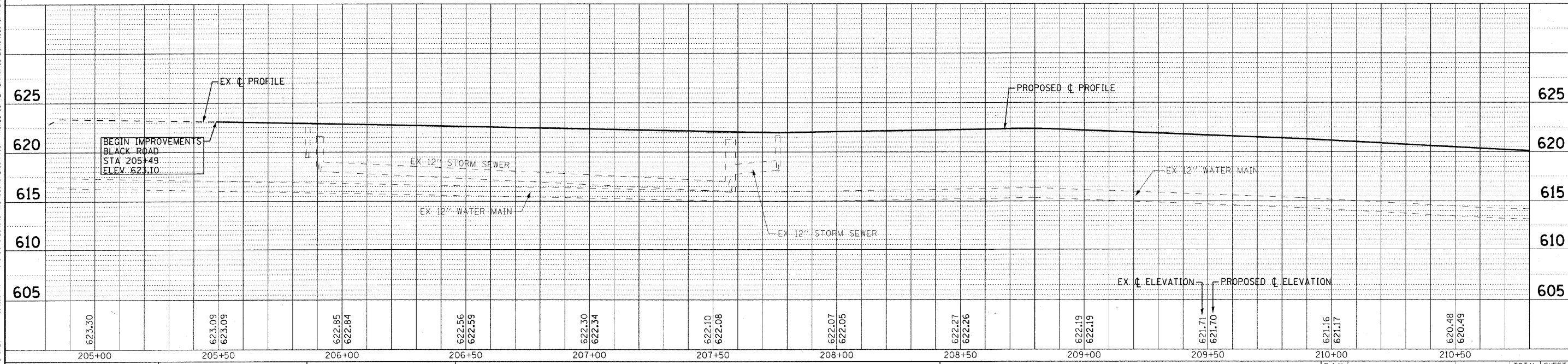

DESIGNED - DSH	REVISED - 1-19-11 PER VILLAGE
DRAWN - LKB	REVISED -
CHECKED - LDH	REVISED -
DATE - 12/6/10	FILE - 090491-PH2-DUI1.sh+

### VILLAGE OF SHOREWOOD, ILLINOIS BLACK ROAD AND RIVER ROAD INTERSECTION IMPROVEMENTS

### DRAINAGE AND UTILITY BLACK ROAD

SCALE: H: 1"=20' V: 1"=5'      STA. 205+00      TO STA. 210+50

F.A.U. RTE. 0298 0396	SECTION 09-00028-00-CH	COUNTY WILL	TOTAL SHEETS 63	SHEET NO. 23
C-91-726-09		CONTRACT NO. 63562		
FED. ROAD DIST. NO. 1 ILLINOIS FED. AID PROJECT M-9003(385)				

COPYRIGHT © 2010 BY BAXTER A. WOODMAN, INC.  
 STATE OF ILLINOIS - PROFESSIONAL DESIGN FIRM  
 LICENSE NO. - 0298-0396 - EXPIRES 4/30/2011  
 2/27/2011 9:56:35 AM