

LEGEND

- PROPOSED COM ED POWER POLE
- EXISTING COM ED POWER POLE
- EXISTING STREET LIGHT, CLEAN AND RELAMP
- PROPOSED RELOCATION OF EXISTING LIGHT, CLEAN AND RELAMP
- PROPOSED STREET LIGHT 310W HPS, 35 FT M.H., 10 FT MAST ARM
- PROPOSED STREET LIGHT, 250W HPS, 45 FT M.H., 15 FT MAST ARM ON COMBINATION TRAFFIC SIGNAL/STREET LIGHT POLE
- PROPOSED LIGHTING CONTROLLER, 100 AMP, 120/240 V, 3 WIRE

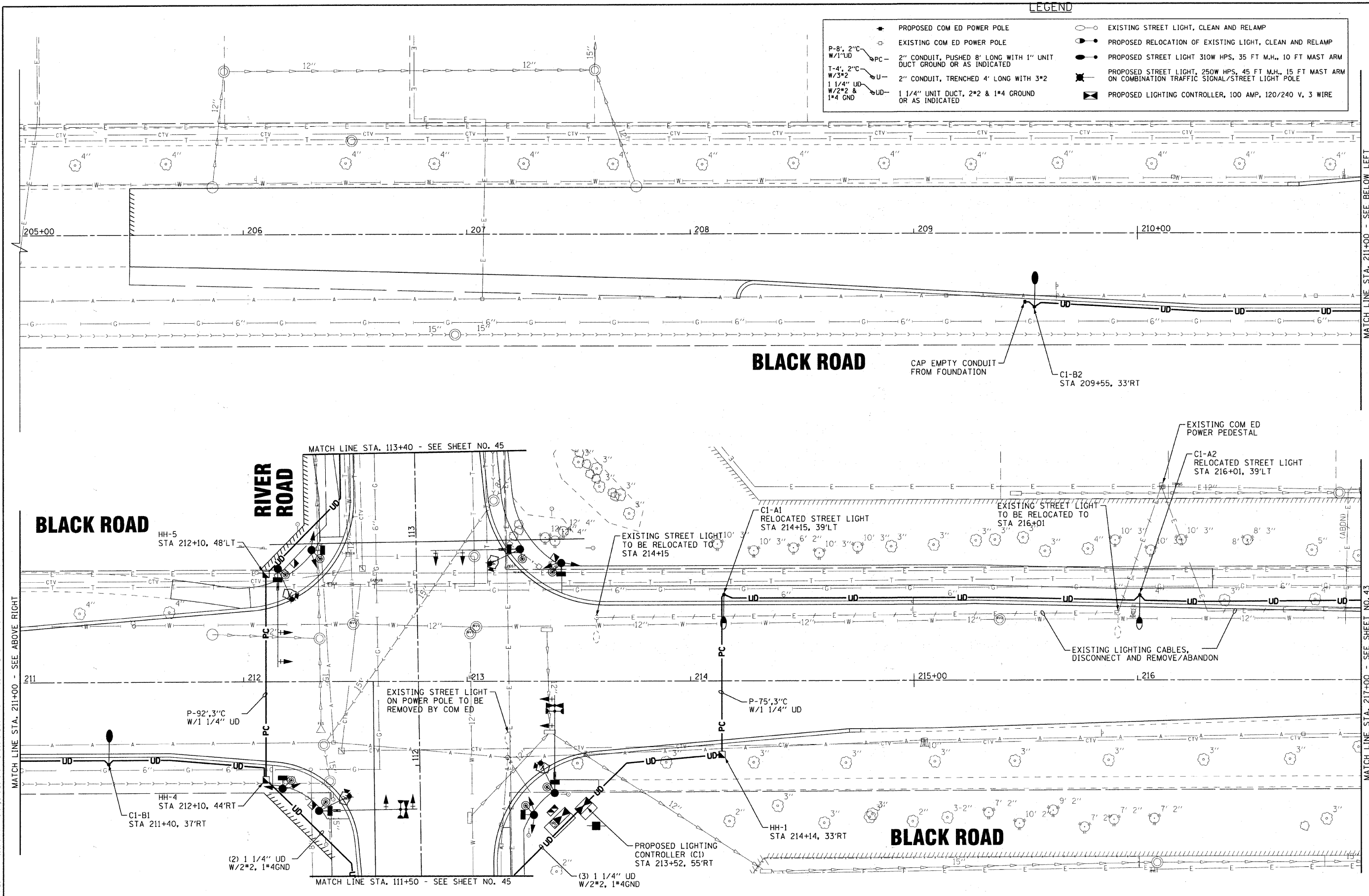

COPYRIGHT © 2009 BY BAXTER & WOODMAN, INC.  
 STATE OF ILLINOIS - PROFESSIONAL DESIGN FIRM  
 LICENSE NO. - 184-00021 - EXPIRES 4/30/2011  
 PROJECT NO. - 090491-PH2-SL1-1  
 DRAWN BY - MWH  
 CHECKED BY - MDK  
 DATE - 12/6/10



DESIGNED - MWH	REVISED -
DRAWN - CJC	REVISED -
CHECKED - MDK	REVISED -
DATE - 12/6/10	FILE - 090491-PH2-SL1.shx

**VILLAGE OF SHOREWOOD, ILLINOIS**  
**BLACK ROAD & RIVER ROAD**  
**INTERSECTION IMPROVEMENT**

**LIGHTING PLAN**  
**BLACK ROAD**

SCALE: 1"=20'      STA. 205+00      TO STA. 217+00

F.A.U. RTE. 0298 0396	SECTION 09-00028-00-CH	COUNTY WILL	TOTAL SHEETS 63	SHEET NO. 42
C-91-726-09		CONTRACT NO. 63562		
FED. ROAD DIST. NO. 1 ILLINOIS FED. AID PROJECT W-9003(385)				