

COPYRIGHT © 2010 BY BAXTER & WOODMAN, INC.
 STATE OF ILLINOIS - PROFESSIONAL DESIGN FIRM
 LICENSE NO. - 081-00027 - EXPIRES 4/30/2011
 22nd St
 80266 PM
 B:\Crystal Lake\Shorewood\090499\BlackRoad\RiverRd\BlackRoadRiverRd\Drawings\090499-10-01.rvt

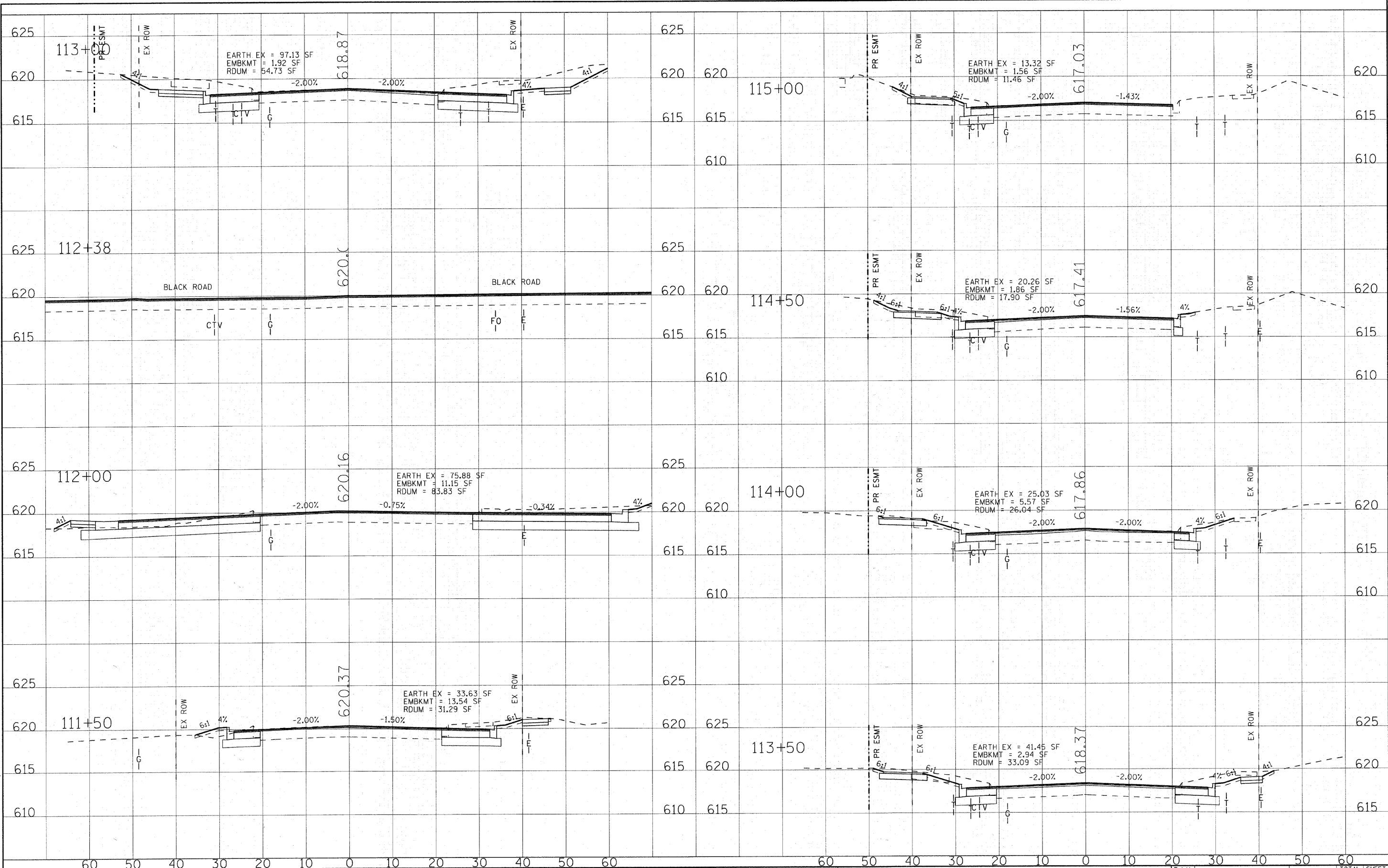

DESIGNED - DSH	REVISED - 1-19-11 PER VILLAGE
DRAWN - MAC	REVISED - 1-31-11 PER IDOT
CHECKED - LDH	REVISED -
DATE - 12/6/10	REVISED -

**VILLAGE OF SHOREWOOD, ILLINOIS
BLACK ROAD AND RIVER ROAD
IMPROVEMENTS**

SCALE: H: 1"=10' V: 1"=5'

**CROSS SECTIONS
RIVER ROAD**

STA. 111+50 TO STA. 115+00

F.A.U. RITE	SECTION	COUNTY	TOTAL SHEETS	SHEET NO.
0258 0386	09-00028-00-CH	WILL	63	62
JOB NO. C-91-726-09			CONTRACT NO. 63562	
FED. ROAD DIST. NO. 1 (ILLINOIS) FED. AID PROJECT NO. M-9003 (385)				