

ALL DISTURBED AREAS SHALL BE RESTORED WITH TOPSOIL, 4" AND SOD.

DATE	
BY	
PLAN	
DATE	
BY	
NOTED	
DATE	
BY	
NOTED	
DATE	
BY	
NOTED	
DATE	
BY	

DATE	
BY	
PROFILE	
DATE	
BY	
NOTED	
DATE	
BY	
NOTED	
DATE	
BY	
NOTED	
DATE	
BY	

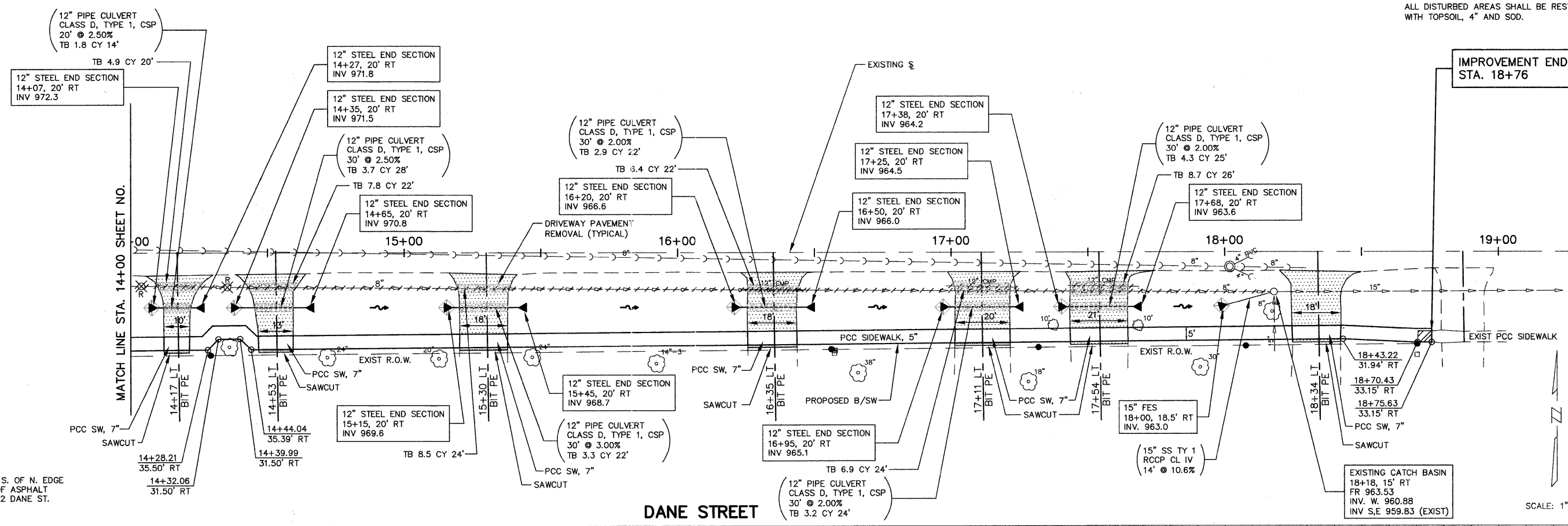

BENCHMARK:
MAG NAIL IN DANE ST. 1.6' S. OF N. EDGE
OF PAVEMENT JUST SOUTH OF ASPHALT
DRIVEWAY TO RESIDENCE #682 DANE ST.
ELEVATION: 968.30

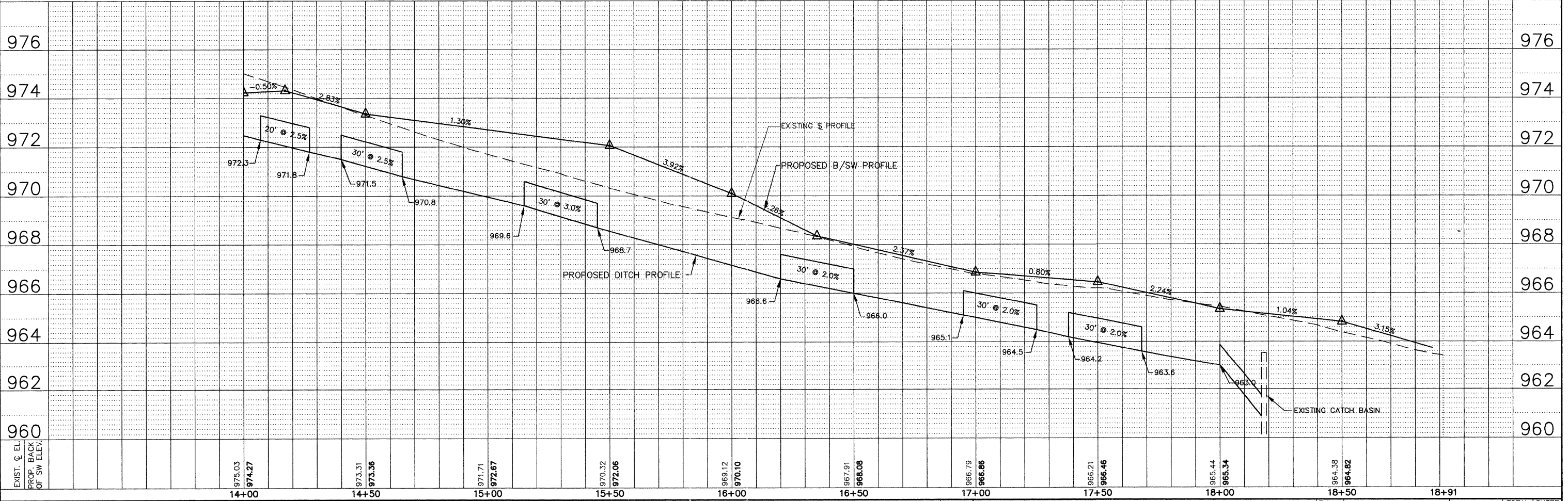

FILE NAME =	USER NAME =	DESIGNED -- DAY	REVISED -- 9-20-10	STATE OF ILLINOIS DEPARTMENT OF TRANSPORTATION		DANE STREET		F.A.U. R.T.E.	SECTION	COUNTY	TOTAL SHEETS	SHEET NO.
PLOT SCALE =	CHECKED -- MAS	REVISED -- 2-3-11	033			10-00111-00-SW	MCHENRY	19	12			
PLOT DATE =	DATE -- 9-20-10	REVISED -- 3-11-11	SCALE: 1" = 20'			SHEET NO. OF SHEETS STA. 14+00 TO STA. 18+75.63		CONTRACT NO. 63565				
			FED. ROAD DIST. NO. ILLINOIS FED. AID PROJECT									