

PAVEMENT MARKINGS LEGEND	
ITEM DESCRIPTION	SYMBOL
THERMOPLASTIC PAVEMENT MARKING LINE, 4", DOUBLE @ 11" C-C, YELLOW	(A)
THERMOPLASTIC PAVEMENT MARKING LINE, 12", CROSS WALK @ 36" C-C, WHITE	(B)
THERMOPLASTIC PAVEMENT MARKING LINE, 6", CROSS WALK, WHITE	(C)
THERMOPLASTIC PAVEMENT MARKING LINE, 24", STOP BAR, WHITE	(D)
THERMOPLASTIC PAVEMENT MARKING LINE, 6", TURN LANE, WHITE	(E)
THERMOPLASTIC PAVEMENT MARKING, LETTERS AND SYMBOLS, WHITE	(F)
THERMOPLASTIC PAVEMENT MARKING LINE, 4", PARKING LINE, WHITE	(G)

**NOTE:**  
 \* DENOTES FRAMES AND LIDS TO BE ADJUSTED (SPECIAL)  
 (A) DETECTABLE WARNING

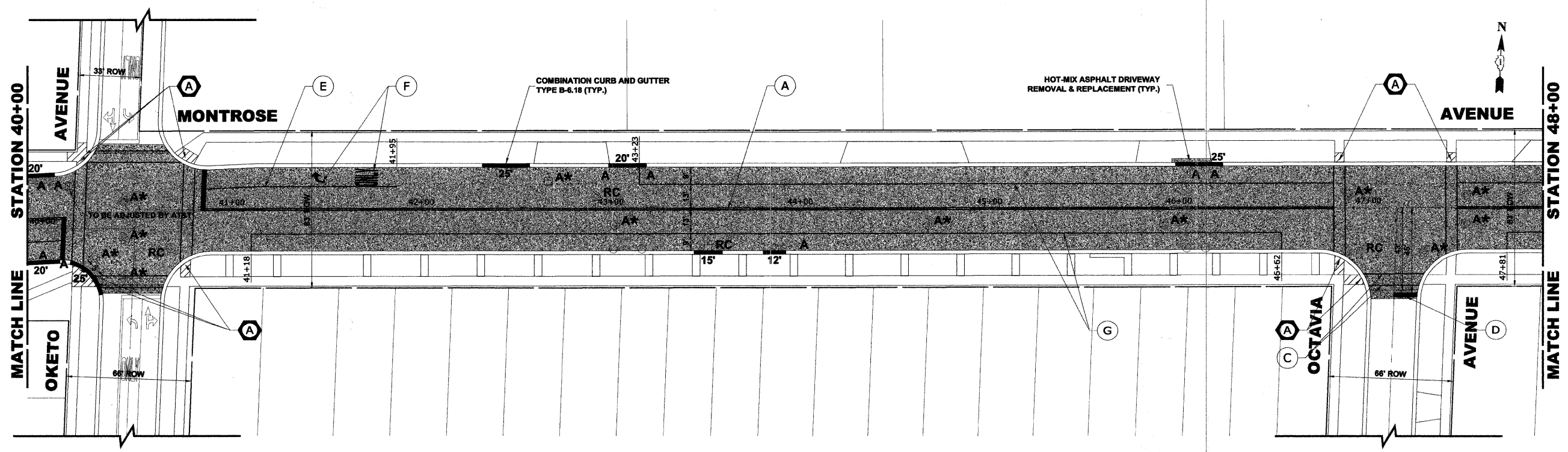

DESIGNED	---	REVISED	---
DRAWN	---	REVISED	---
CHECKED	---	REVISED	---
DATE	03/25/11	REVISED	---

F.A.U. RTE.	SECTION	COUNTY	TOTAL SHEETS	SHEET NO.
2729	10-00060-00-RS	COOK	17	7
FED. ROAD DIST. NO. 1 ILLINOIS			CONTRACT NO. 63582	
FED. AID PROJECT			---	

Drawing file: W:\Projects\61210060 - Montrose Ave LAPP (Harden to Spire)\MontroseAveLAPP.dwg Mar 30, 2011 - 9:33am