

PAVEMENT MARKINGS LEGEND	
ITEM DESCRIPTION	SYMBOL
THERMOPLASTIC PAVEMENT MARKING LINE, 4", DOUBLE @ 11" C-C, YELLOW	(A)
THERMOPLASTIC PAVEMENT MARKING LINE, 6", CROSS WALK, WHITE	(C)
THERMOPLASTIC PAVEMENT MARKING LINE, 24", STOP BAR, WHITE	(D)
THERMOPLASTIC PAVEMENT MARKING LINE, 6", TURN LANE, WHITE	(E)
THERMOPLASTIC PAVEMENT MARKING, LETTERS AND SYMBOLS, WHITE	(F)
THERMOPLASTIC PAVEMENT MARKING LINE, 4", PARKING LINE, WHITE	(G)

NOTE:

* DENOTES FRAMES AND LIDS TO BE ADJUSTED (SPECIAL)

(A) DETECTABLE WARNING

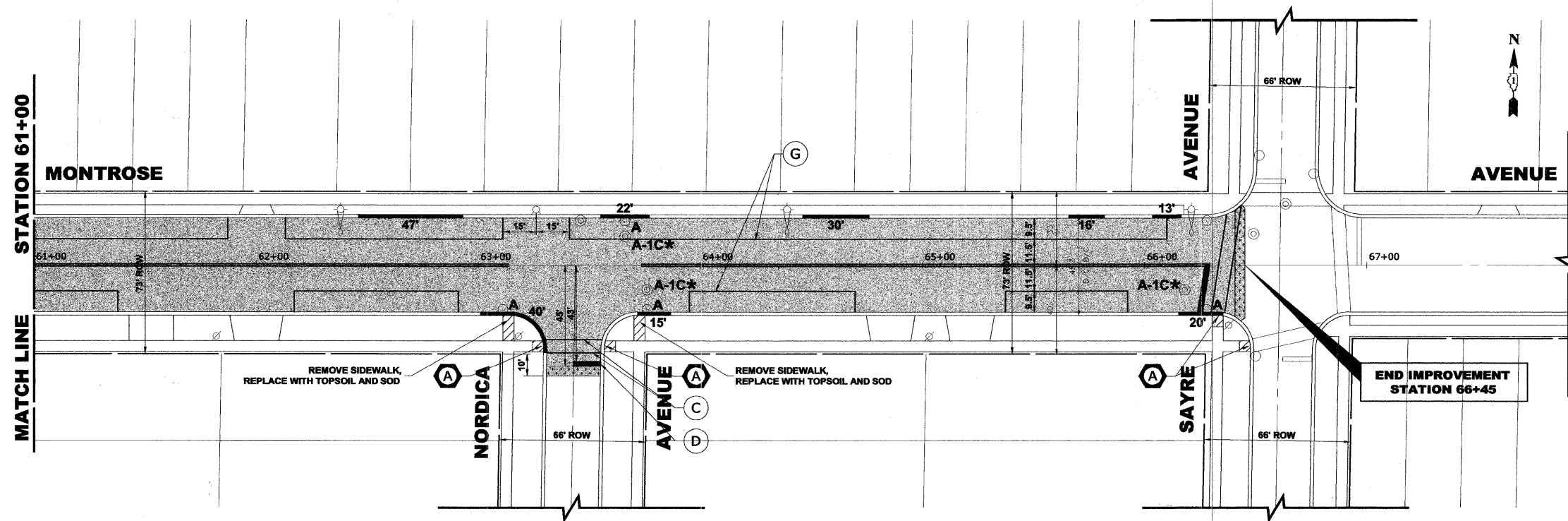

Drawing file: W:\Projects\61210060 - Montrose Ave LPP (Harlem to Sayre)\MontroseAveLPP.dwg Apr 05, 2011 - 9:07am



♦ Civil Engineers
 ♦ Municipal Consultants
 ♦ Established 1911

9133 Roosevelt Road
 Westchester, Illinois 60154-2788
 Phone: 708/965-4388
 Fax: 708/965-1312

DESIGNED	---	REVISED	---
DRAWN	---	REVISED	---
CHECKED	---	REVISED	---
DATE	03/25/11	REVISED	---

STATE OF ILLINOIS
DEPARTMENT OF TRANSPORTATION

MONTROSE AVENUE PAVING PLAN

SCALE: 1" = 30' SHEET NO. 5 OF 5 SHEETS STA. 54+60 TO STA. 66+45

F.A.U. RTE.	SECTION	COUNTY	TOTAL SHEETS	SHEET NO.
2729	10-00060-00-RS	COOK	17	9
FED. ROAD DIST. NO. 1 ILLINOIS			CONTRACT NO. 63582	
			FED. AID PROJECT	