

**INSIDE ELEVATION OF WEST PARAPET**  
(East Parapet Similar)

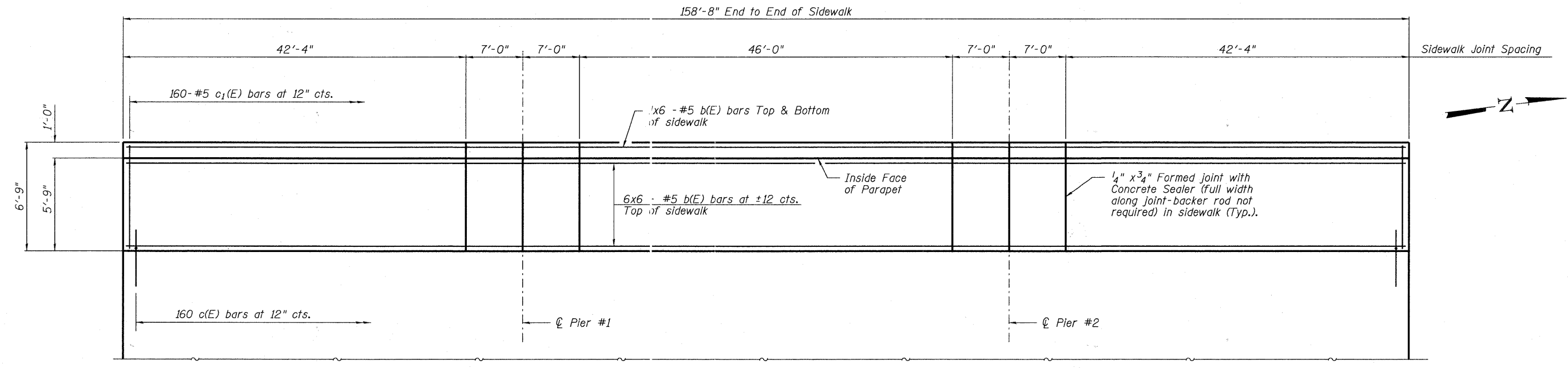

**WEST SIDEWALK PLAN**  
(East Sidewalk Similar)

Minimum Bar Lap  
#5 Bar = 2'-7"

Notes:  
Inside elevation at parapet view is exaggerated vertically to show reinforcement.  
Bars indicated this 6x6-#5 etc. indicates 6 lines of bars with 6 lengths per line.  
See Sheet 9 of 28 for Superstructure Details and Bill of Material.

FILE NAME = H:\755-010 Blivin Phase I\CAD\Drawings\Structural\755-010\_SIDEWALK PLAN AND PARAPET ELEV.dwg

**Bollinger, Lach & Associates, Inc.**  
ITASCA, ILLINOIS

|                       |                |           |
|-----------------------|----------------|-----------|
| USER NAME = gonzalo   | DESIGNED - SRT | REVISED - |
| PLOT SCALE =          | CHECKED - JJI  | REVISED - |
| PLOT DATE = 3/25/2011 | DRAWN - GM     | REVISED - |
|                       | CHECKED - JJI  | REVISED - |

**McHENRY COUNTY**  
**DIVISION OF TRANSPORTATION**  
**BLIVIN STREET OVER NIPPERSINK CREEK**

|  |                                       |
|--|---------------------------------------|
| <b>SIDEWALK PLAN AND PARAPET ELEVATION</b> |                                       |
| <b>STRUCTURE NO. 056-3191</b>              |                                       |
| SCALE:                                     | SHEET NO. 7 OF 28 SHEETS STA. TO STA. |

|                    |                |         |                           |           |
|--------------------|----------------|---------|---------------------------|-----------|
| F.A. RTE.          | SECTION        | COUNTY  | TOTAL SHEETS              | SHEET NO. |
|                    | 08-00355-00-BR | MCHENRY | 69                        | 32        |
| CONTRACT NO. 63583 |                |         | ILLINOIS FED. AID PROJECT |           |