

DATE	
BY	
REVISION	
NO. 1	
NO. 2	
NO. 3	
NO. 4	
NO. 5	
NO. 6	
NO. 7	
NO. 8	
NO. 9	
NO. 10	
NO. 11	
NO. 12	
NO. 13	
NO. 14	
NO. 15	
NO. 16	
NO. 17	
NO. 18	

DATE	
BY	
REVISION	
NO. 1	
NO. 2	
NO. 3	
NO. 4	
NO. 5	
NO. 6	
NO. 7	
NO. 8	
NO. 9	
NO. 10	
NO. 11	
NO. 12	
NO. 13	
NO. 14	
NO. 15	
NO. 16	
NO. 17	
NO. 18	

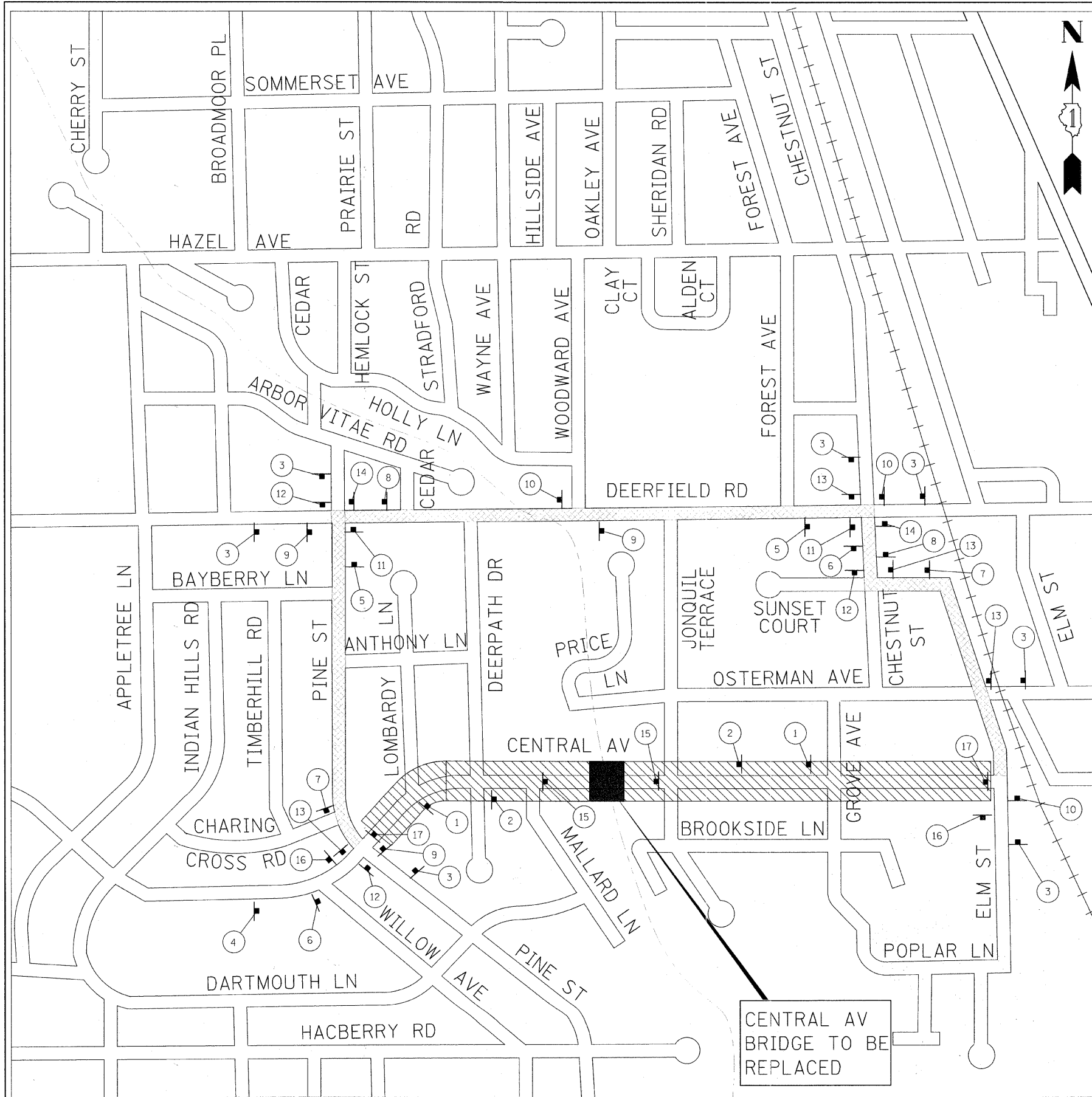

CENTRAL AV
BRIDGE TO BE
REPLACED

SIGN LEGEND

1 ROAD CONSTRUCTION AHEAD W20-1 48 X 48

2 ROAD CLOSED AHEAD W20-1 48 X 48

3 DETOUR AHEAD W20-2 48 X 48

4 DETOUR 500 FT W20-2 48 X 48

5 EAST CENTRAL AV DETOUR M3-4 24 X 12, M4-8 30 X 24, M 5-1R 21 X 15

6 EAST CENTRAL AV DETOUR M3-4 24 X 12, M4-8 30 X 24, M 5-1L 21 X 15

7 WEST CENTRAL AV DETOUR M3-2 24 X 12, M4-8 30 X 24, M 5-1R 21 X 15

8 WEST CENTRAL AV DETOUR M3-2 24 X 12, M4-8 30 X 24, M 5-1L 21 X 15

9 EAST CENTRAL AV DETOUR M3-2 24 X 12, M4-8 30 X 24, M 6-3 21 X 15

10 WEST CENTRAL AV DETOUR M3-2 24 X 12, M4-8 30 X 24, M 6-3 21 X 15

11 EAST CENTRAL AV DETOUR M3-4 24 X 12, M4-9R 30 X 24

12 EAST CENTRAL AV DETOUR M3-4 24 X 12, M4-9L 30 X 24

13 WEST CENTRAL AV DETOUR M3-4 24 X 12, M4-9R 30 X 24

14 WEST CENTRAL AV DETOUR M3-4 24 X 12, M4-9L 30 X 24

15 ROAD CLOSED R11-2 OR BRIDGE OUT R11-2 (MOUNTED ON TYPE III BARRICADE)

16 END DETOUR M4-8a 48 X 36

17 ROAD CLOSED TO THRU TRAFFIC R11-4 60 X 30 (MOUNTED ON TYPE III BARRICADE)

18 NO PEDESTRIAN

LEGEND

■ BRIDGE CONSTRUCTION (WORK ZONE)

▨ ROAD CLOSURE (LOCAL TRAFFIC ONLY)

▤ DETOUR ROUTE

⬇ TEMPORARY TRAFFIC ADVISORY SIGN

⊗ SIGN LEGEND NUMBER (SEE SIGN LEGEND)

DETOUR NOTES

- 1) THE CONTRACTOR SHALL COMPLETELY COVER ANY EXISTING SIGNS ALONG THE DETOUR ROUTE THAT ARE IN CONFLICT WITH DETOUR.
- 2) THE CONTRACTOR SHALL MAKE ANY ADJUSTMENT TO THE EXISTING TRAFFIC SIGNS, DETOUR SIGNING OR PAVEMENT MARKING ALONG THE DETOUR ROUTE AS NECESSARY OR AS DIRECTED BY ENGINEER.
- 3) ALL SIGNS 1-4 SHALL HAVE TYPE A FLASHING LIGHT

URS
100 S. WACKER DR.
SUITE 500
CHICAGO IL 60606
TEL (312) 939-1000
FAX (312) 939-4198

USER NAME: #005918
DESIGNED: []
DRAWN: []
CHECKED: []
DATE: []

REVISED: []
REVISED: []
REVISED: []
REVISED: []

**VILLAGE OF DEERFIELD
CENTRAL AVENUE OVER THE WEST FORK,
NORTH BRANCH OF THE CHICAGO RIVER**

TRAFFIC CONTROL AND DETOUR PLAN
SCALE: NTS SHEET NO. 6 OF 22 SHEETS STA. TO STA.

F.A.U. RTE.	SECTION	COUNTY	TOTAL SHEETS	SHEET NO.
	09-00085-00-BR	LAKE	22	6
CONTRACT NO. 63584				
FED. ROAD DIST. NO. ILLINOIS FED. AID PROJECT				