

- NOTES:**
- 1) PAVEMENT MARKINGS SHALL BE THERMOPLASTIC ON 55TH STREET.
 - 2) FINE GRADING OF PARKWAY TO PROVIDE POSITIVE DRAINAGE SHALL BE INCLUDED IN THE COST OF SODDING, SPECIAL.

LEGEND

[A]	STRUCTURE TO BE ADJUSTED
(A)	STRUCTURE TO BE ADJUSTED WITH NEW FRAME AND LID
[R]	STRUCTURE TO BE RECONSTRUCTED
(R)	STRUCTURE TO BE RECONSTRUCTED WITH NEW FRAME AND LID
*	DETECTABLE WARNINGS ON SIDEWALK RAMPS
[X]	SIDEWALK REMOVAL
(TRP)	TREE ROOT PRUNING (BY OTHERS)
(IF)	INLET FILTERS

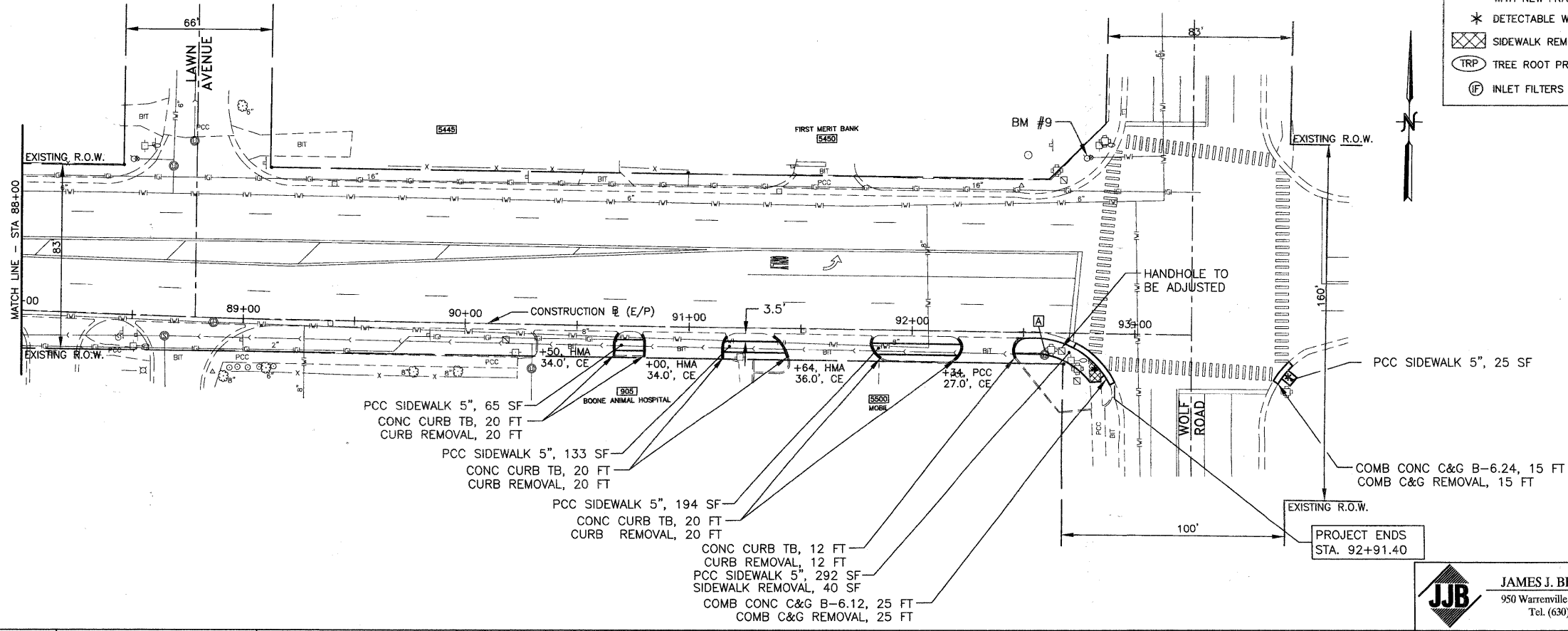

FILE NAME =	USER NAME =	DESIGNED -- BDH	REVISED --
		DRAWN -- SMP	REVISED --
		CHECKED -- BDH	REVISED --
		DATE -- 02-09-11	REVISED --

**STATE OF ILLINOIS
DEPARTMENT OF TRANSPORTATION**

**GEOMETRIC PLAN
55TH STREET**

SCALE: 1"=30' SHEET NO. 10 OF 25 SHEETS STA. 80+00 TO STA. 93+25

JJB JAMES J. BENES & ASSOCIATES, INC.
950 Warrenville Road, Suite 101, Lisle, Illinois 60532
Tel. (630) 719-7570 • Fax (630) 719-7589

F.A.U. RTE. 1504	SECTION 09-00090-00-SW	COUNTY COOK	TOTAL SHEETS 25	SHEET NO. 10
CONTRACT NO. 63596				
ILLINOIS FED. AID PROJECT				