

PROJECT BEGINS  
STA. 8+68.00

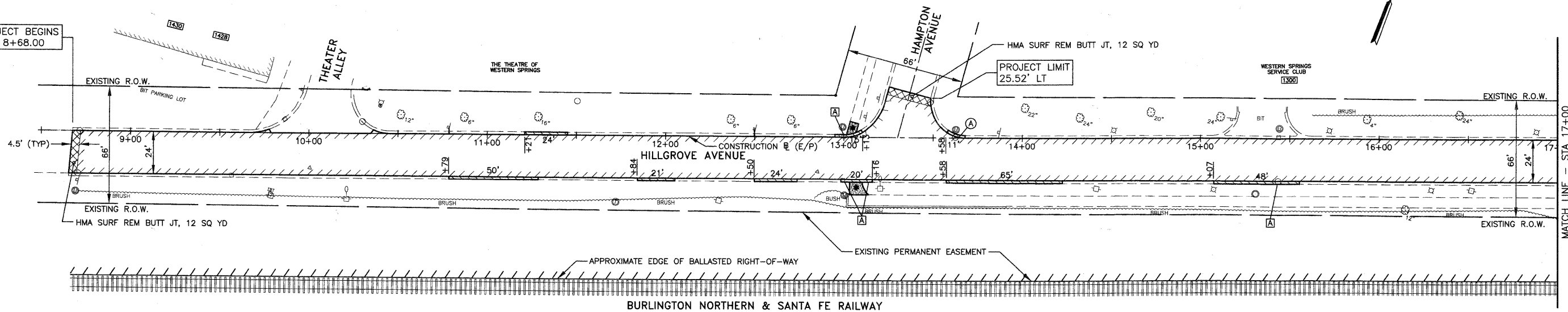

LEGEND

[A] STRUCTURE TO BE ADJUSTED	[REM] STRUCTURE TO BE REMOVED	EXISTING	PROPOSED
[R] STRUCTURE TO BE RECONSTRUCTED	[ASP] STRUCTURE TO BE ADJUSTED SPECIAL	⊗ VALVE VAULT	⊗
[F] FILLING EXISTING STRUCTURE	[ASP] STRUCTURE TO BE ADJUSTED SPECIAL WITH NEW FRAME AND LID	○ MANHOLE	●
[A] STRUCTURE TO BE ADJUSTED WITH NEW FRAME & LID	* CURB RAMP ACCESSIBLE TO THE DISABLED	○ CATCH BASIN	●
[R] STRUCTURE TO BE RECONSTRUCTED WITH NEW FRAME & LID		□ INLET	■
[Hatched] SIDEWALK REMOVAL AND REPLACEMENT		○ FIRE HYDRANT	●
[Hatched] HMA SURFACE REMOVAL-BUTT JOINT			
[Hatched] HMA SURFACE REMOVAL OR DRIVEWAY PAVEMENT REMOVAL			
[Hatched] COMBINATION CONCRETE CURB AND GUTTER REMOVAL AND REPLACEMENT			

HMA SC D N50 (2"), 272 TONS  
LEV BIND MM N50 (1 1/4"), 170 TONS  
HMA SURF REM 3 1/4", 2273 SY

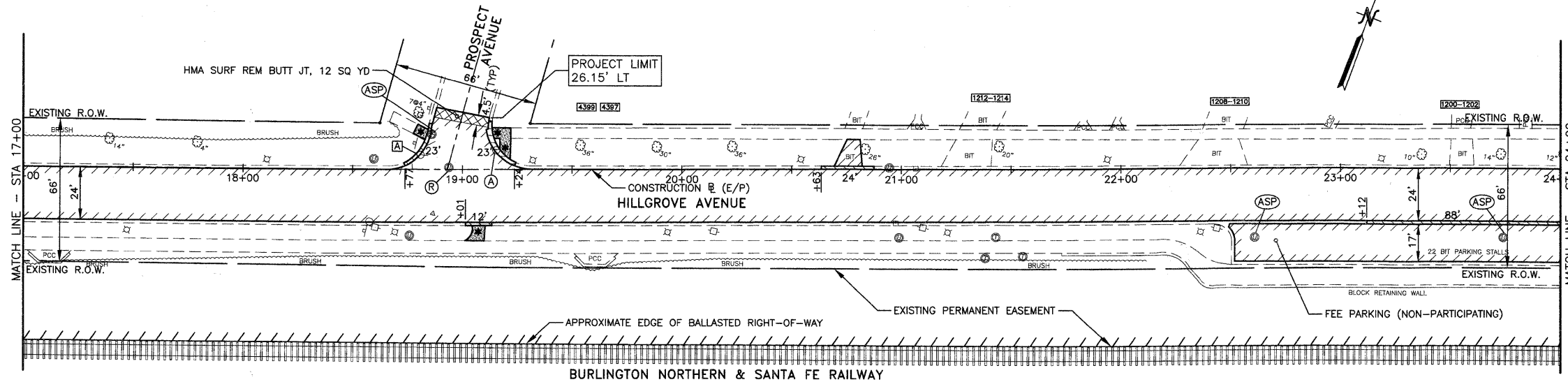

HMA SC D N50 (2"), 267 TONS  
LEV BIND MM N50 (1 1/4"), 167 TONS  
HMA SURF REM 3 1/4", 2239 SY

FILE NAME =	USER NAME =	DESIGNED -- BDH	REVISED --
		DRAWN -- SMP	REVISED --
		CHECKED -- BDH	REVISED --
		DATE -- 03/01/2011	REVISED --

STATE OF ILLINOIS  
DEPARTMENT OF TRANSPORTATION

RESURFACING PLAN  
HILLGROVE AVENUE

SCALE: 1"=30' SHEET NO. 7 OF 17 SHEETS STA. 8+50 TO STA. 24+00

<b>JAMES J. BENES &amp; ASSOCIATES, INC.</b> 950 Warrenville Road, Suite 101, Lisle, Illinois 60532 Tel. (630) 719-7570 • Fax (630) 719-7589				
F.A.U. RTE.	SECTION	COUNTY	TOTAL SHEETS	SHEET NO.
3782	10-00093-00-RS	COOK	17	7
			CONTRACT NO. 63600	
ILLINOIS FED. AID PROJECT				