

LEGEND

[A] STRUCTURE TO BE ADJUSTED	[REM] STRUCTURE TO BE REMOVED	EXISTING	PROPOSED
[R] STRUCTURE TO BE RECONSTRUCTED	[ASP] STRUCTURE TO BE ADJUSTED SPECIAL	⊗ VALVE VAULT	⊗
[F] FILLING EXISTING STRUCTURE	[ASP] STRUCTURE TO BE ADJUSTED SPECIAL WITH NEW FRAME AND LID	○ MANHOLE	●
[A] STRUCTURE TO BE ADJUSTED WITH NEW FRAME & LID	* CURB RAMP ACCESSIBLE TO THE DISABLED	○ CATCH BASIN	●
[R] STRUCTURE TO BE RECONSTRUCTED WITH NEW FRAME & LID		□ INLET	■
		○ FIRE HYDRANT	●
[Hatched] SIDEWALK REMOVAL AND REPLACEMENT			
[Hatched] HMA SURFACE REMOVAL-BUTT JOINT			
[Hatched] HMA SURFACE REMOVAL OR DRIVEWAY PAVEMENT REMOVAL			
[Hatched] COMBINATION CONCRETE CURB AND GUTTER REMOVAL AND REPLACEMENT			

HMA SC D N50 (2"), 558 TONS
 LEV BIND MM N50 (1 1/4"), 349 TONS
 HMA SURF REM 3 1/4", 4647 SY

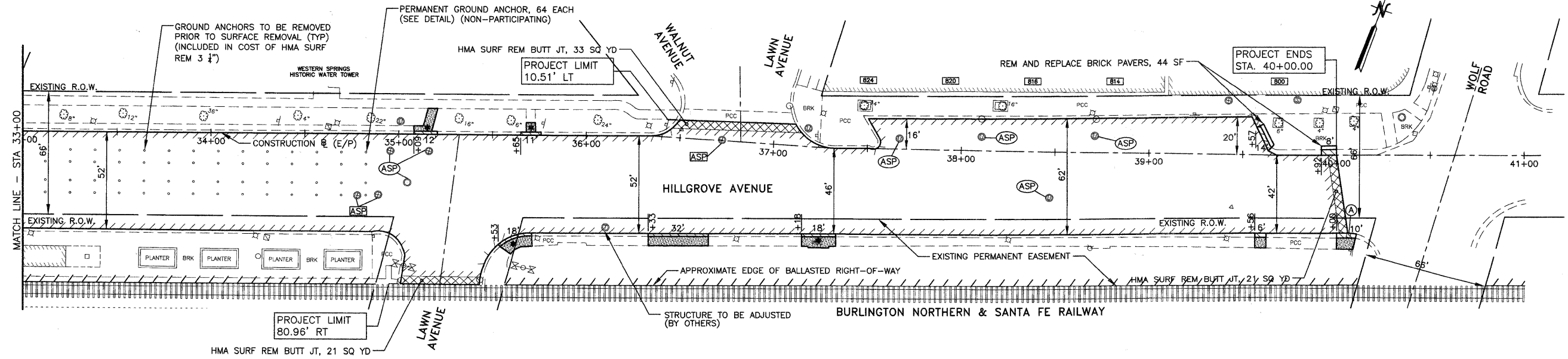

HMA SC D N50 (2"), 528 TONS
 LEV BIND MM N50 (1 1/4"), 330 TONS
 HMA SURF REM 3 1/4", 4384 SY

FILE NAME =	USER NAME =	DESIGNED — BDH	REVISED —
		DRAWN — SMP	REVISED —
		CHECKED — BDH	REVISED —
		DATE — 03/01/2011	REVISED —

**STATE OF ILLINOIS
 DEPARTMENT OF TRANSPORTATION**

**RESURFACING PLAN
 HILLGROVE AVENUE**

SCALE: 1"=30' SHEET NO. 8 OF 17 SHEETS STA. 24+00 TO STA. 41+00

JJB JAMES J. BENES & ASSOCIATES, INC.
 950 Warrenville Road, Suite 101, Lisle, Illinois 60532
 Tel. (630) 719-7570 • Fax (630) 719-7589

F.A.U. RTE.	SECTION	COUNTY	TOTAL SHEETS	SHEET NO.
3782	10-00093-00-RS	COOK	17	8
CONTRACT NO. 60600			ILLINOIS FED. AID PROJECT	