

NOTES:  
 1. ALL MARKINGS SHALL BE THERMOPLASTIC PAVEMENT MARKINGS, UNLESS OTHERWISE NOTED.

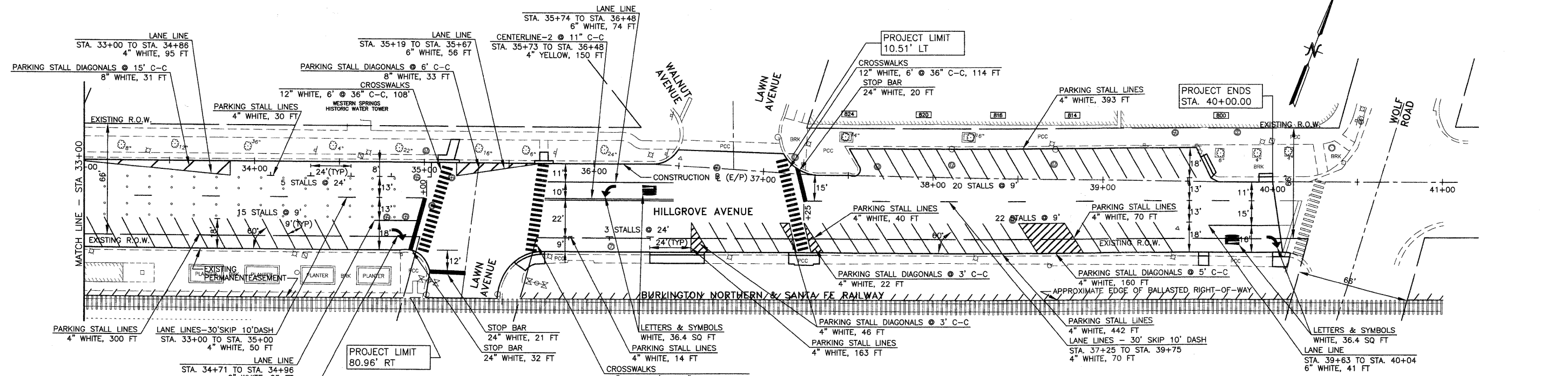
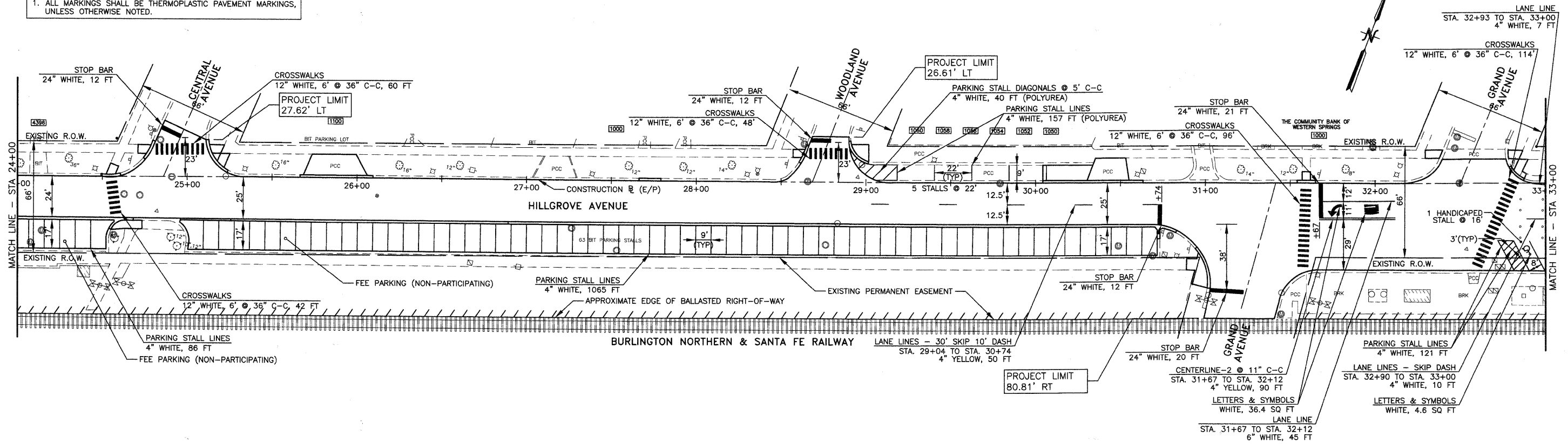

FILE NAME =	USER NAME =	DESIGNED - BDH	REVISED -
		DRAWN - SMP	REVISED -
		CHECKED - BDH	REVISED -
		DATE - 03/01/2011	REVISED -

**STATE OF ILLINOIS  
 DEPARTMENT OF TRANSPORTATION**

**PAVEMENT MARKING PLAN  
 HILLGROVE AVENUE**

SCALE: 1"=30'    SHEET NO. 10 OF 17 SHEETS    STA. 24+00 TO STA. 41+00

<b>JJB</b> JAMES J. BENES & ASSOCIATES, INC. 950 Warrenville Road, Suite 101, Lisle, Illinois 60532 Tel. (630) 719-7570 • Fax (630) 719-7589				
F.A.U. RTE.	SECTION	COUNTY	TOTAL SHEETS	SHEET NO.
3782	10-00093-00-RS	COOK	17	10
			CONTRACT NO. 63600	
ILLINOIS FED. AID PROJECT				