

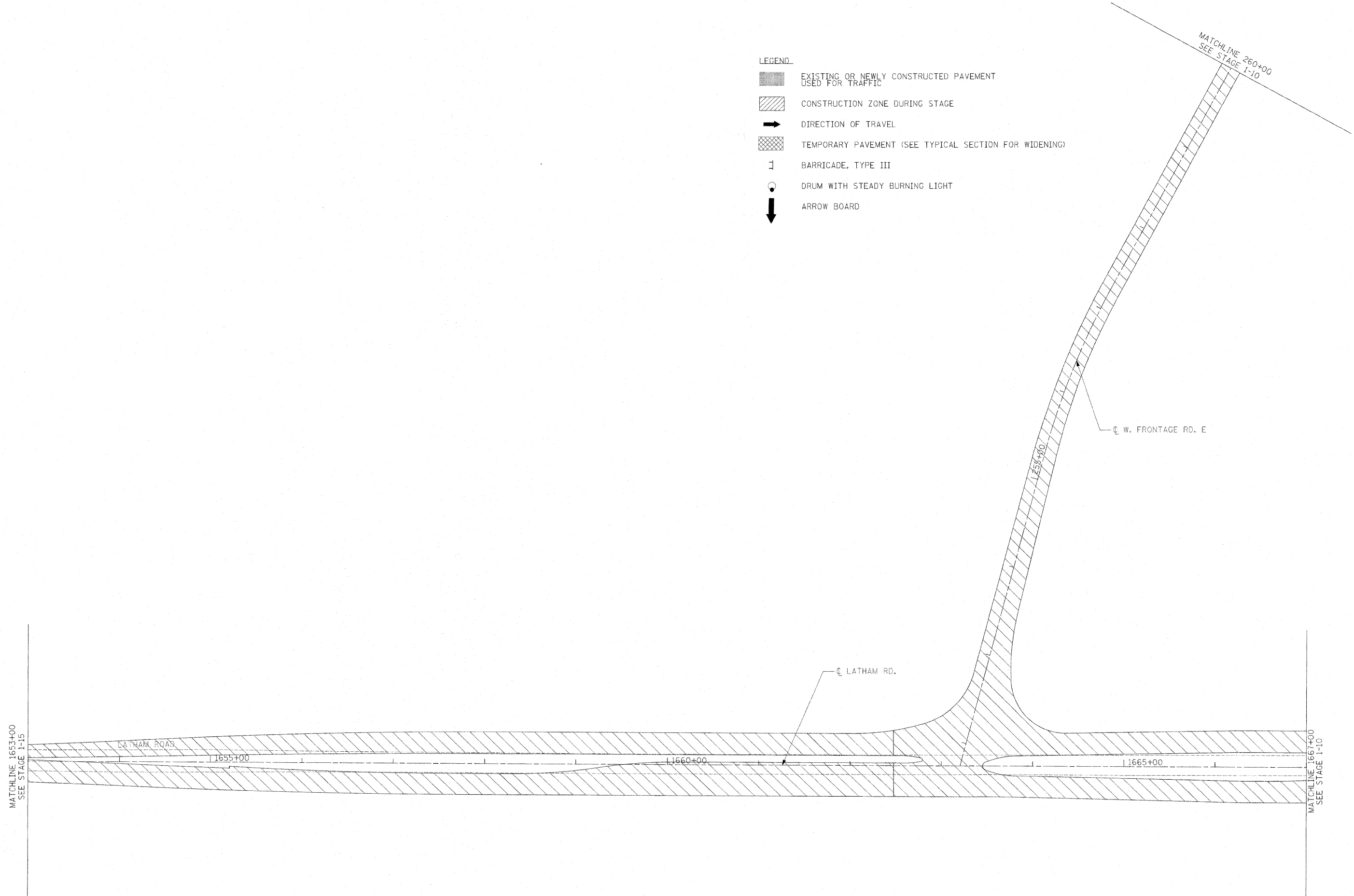

LEGEND

- EXISTING OR NEWLY CONSTRUCTED PAVEMENT USED FOR TRAFFIC
- CONSTRUCTION ZONE DURING STAGE
- DIRECTION OF TRAVEL
- TEMPORARY PAVEMENT (SEE TYPICAL SECTION FOR WIDENING)
- BARRICADE, TYPE III
- DRUM WITH STEADY BURNING LIGHT
- ARROW BOARD



I:\projects\1125A\segment_1\delmas\Naval\Traffic_Control\1125A-1125A-1125A-1125A.dwg

MATCHLINE 1653+00
SEE STAGE 1-15

MATCHLINE 1667+00
SEE STAGE 1-10

USER NAME = zuikovsd	DESIGNED STS/RDT	REVISED -
	DRAWN RDT	REVISED -
PLOT SCALE = 50,000 FT / IN.	CHECKED GC	REVISED -
PLOT DATE = 2/2/2011	DATE 01-14-11	REVISED -

**STATE OF ILLINOIS
DEPARTMENT OF TRANSPORTATION**

**ILLINOIS ROUTE 2
SUGGESTED STAGES OF CONSTRUCTION
AND TRAFFIC CONTROL STAGE 1 - 16**

SCALE: 1"=50' SHEET NO. 130 OF 530 SHEETS STA. 1653+00 TO STA. 1667+00

F.A.P. RTE.	SECTION	COUNTY	TOTAL SHEETS	SHEET NO.
734	77-2-2 & 77-2B-1	WINNEBAGO	530	130
FED. ROAD DIST. NO. ILLINOIS FED. AID PROJECT			CONTRACT NO. 64813	