

DATE	
BY	
DESIGNED	
DRAWN	
CHECKED	
DATE	
REVISIONS	
NO.	
DATE	
BY	
DESIGNED	
DRAWN	
CHECKED	
DATE	
REVISIONS	
NO.	

DATE	
BY	
DESIGNED	
DRAWN	
CHECKED	
DATE	
REVISIONS	
NO.	
DATE	
BY	
DESIGNED	
DRAWN	
CHECKED	
DATE	
REVISIONS	
NO.	

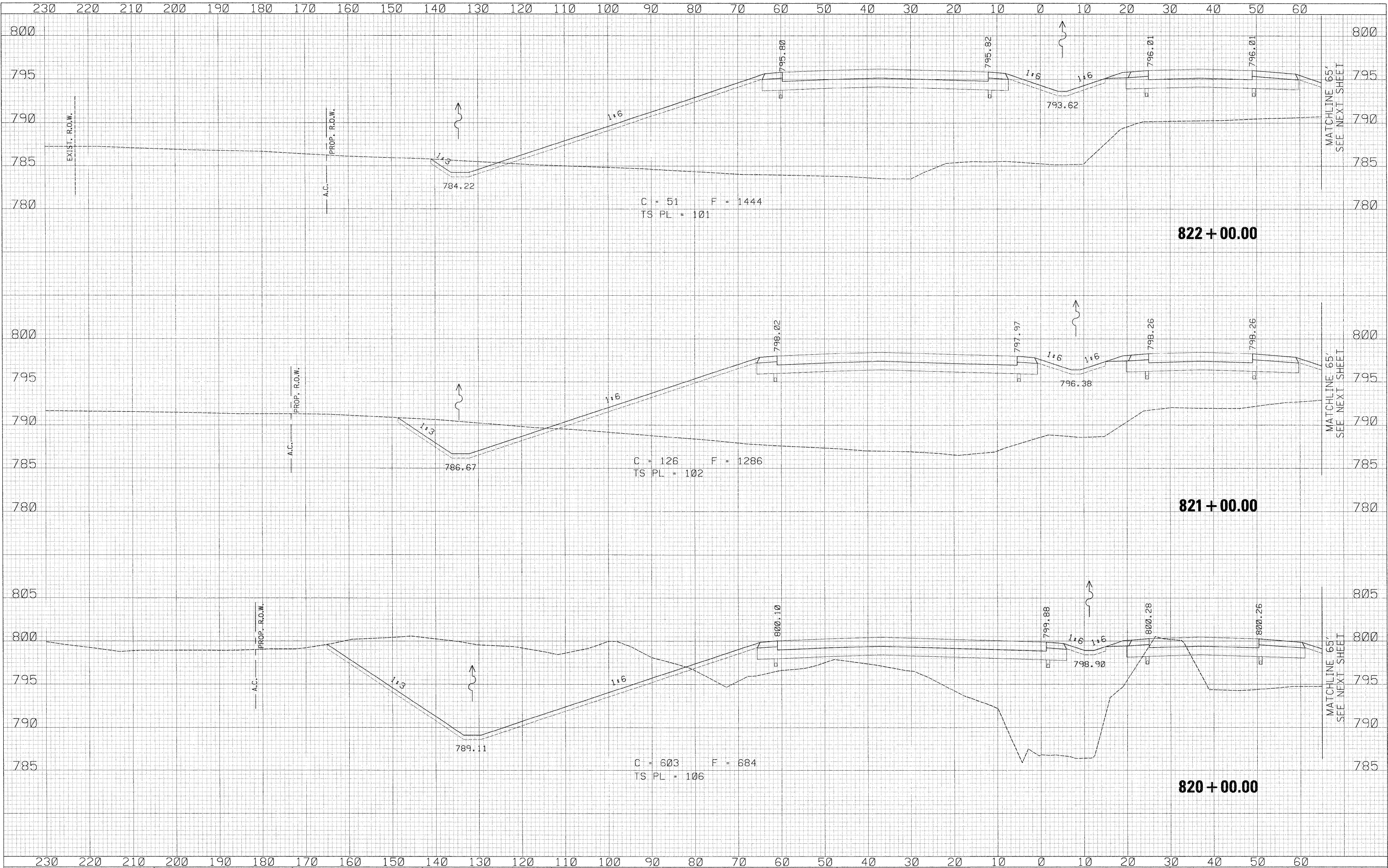

USER NAME = zulkowad	DESIGNED - RDT	REVISIONS
	DRAWN - RDT	REVISIONS
	CHECKED - GC	REVISIONS
	DATE - 01-14-11	REVISIONS

STATE OF ILLINOIS
DEPARTMENT OF TRANSPORTATION

ILLINOIS ROUTE 2
CROSS SECTIONS

SCALE: $\frac{1}{2}$ " = 10' SHEET NO. 448 OF 530 SHEETS STA. 820+00.00 TO STA. 822+00.00

F.A.P. RTE. 734	SECTION 77-2-2 & 77-2B-1	COUNTY WINNEBAGO	TOTAL SHEETS 530	SHEET NO. 448
CONTRACT NO. 64813			ILLINOIS FED. AID PROJECT	

\\projects\11254\segment\1\sheet\civil\section\0264813-sht-xsht-IL2.dgn