



**GENERAL NOTES**  
(Revised May 13, 2009)

THE THICKNESS OF HMA SHOWN ON THE PLANS IS THE NOMINAL THICKNESS. DEVIATIONS FROM THE NOMINAL THICKNESS WILL BE PERMITTED WHEN SUCH DEVIATIONS OCCUR DUE TO IRREGULARITIES IN THE EXISTING SURFACE OR BASE ON WHICH THE HMA IS PLACED.

THE HMA SURFACE OF ALL MAILBOX TURNOUTS, PRIVATE ENTRANCES, COMMERCIAL ENTRANCES, AND SIDE ROADS SHALL BE MADE NEATLY, IN A WORKMANLIKE MANNER, AND SHALL ACCURATELY CONFORM TO THE SHAPES AND DIMENSIONS SHOWN ON THE PLAN DETAILS. IF REQUIRED BY THE ENGINEER, THE CONTRACTOR SHALL BE REQUIRED TO SAW CUT THE HMA SURFACE TO CONFORM TO THE SHAPES AND DIMENSIONS SHOWN ON THE PLAN DETAILS. THIS WORK SHALL BE INCLUDED IN THE COST OF THE HMA SURFACE.

THE ENGINEER WILL BE THE SOLE JUDGE CONCERNING CURING TIME FOR THE VARIOUS HMA LIFTS.

FOR STABILIZATION, ALL TYPE III BARRICADES SHALL REQUIRE A MINIMUM OF FOUR SAND BAGS PER BARRICADE.

SEEDING SHALL NOT BE PERMITTED AT ANY TIME WHEN THE GROUND IS FROZEN, WET, OR IN AN UNTILLABLE CONDITION. LOCATIONS TO BE SEEDED WILL BE DETERMINED BY THE ENGINEER.

FOR NEW CONSTRUCTION, PLACE CURB RAMPS FOR SIDEWALKS (STANDARD 424001) AT ALL LOCATIONS WHERE PROPOSED SIDEWALK ABUTS CURB AT STREET ENTRANCES.

ANY REFERENCE TO A STANDARD IN THESE PLANS SHALL BE INTERPRETED TO MEAN THE EDITION AS INDICATED BY THE SUBNUMBER SHOWN IN THE LIST OF STANDARDS OR THE COPY INCLUDED IN THESE PLANS.

THE FOLLOWING RATES OF APPLICATION HAVE BEEN USED IN CALCULATING PLAN QUANTITIES:

GRANULAR MATERIALS	2.05	TONS / CU YD
BIT MATERIALS (PRIME COAT) ON AGGREGATE BASES	0.375	GAL / SQ YD
BITUMINOUS MATERIALS (PRIME COAT)	0.08	GAL / SQ YD
FOR ADDITIONAL HMA LIFTS "FOG COAT"	0.05	GAL / SQ YD
AGGREGATE PRIME COAT	0.002	TONS / SQ YD
HMA RESURFACING	112	LBS / SQ YD / IN
SHORT TERM PAVEMENT MARKING	10	FT / 100 FT OF APPLICATION
MIX FOR CRACKS, JTS & FLGWS	0.0003	TONS / SQ YD
LEVEL BINDER (HAND METHOD)	0.0005	TONS / SQ YD
SUPPLEMENTAL WATERING	3	GAL / SQ YD / APPLICATION

THE CONTRACTOR SHALL CONTACT JULIE AT LEAST 48 HOURS PRIOR TO EXCAVATION TO DETERMINE WHICH UTILITIES ARE IN THE AREA.

COMMITMENT:  
ENVIRONMENTAL COORDINATION

**IMPROVEMENT BEGINS**  
**STA. 889 + 60 (IL 92)**

**IMPROVEMENT ENDS**  
**STA. 908 + 10 (IL 92)**

**PROJECT BEGINS**  
**STA 950+52 (US 34)**

**PROJECT ENDS**  
**RADIUS RETURN**  
**IL 89**

**PROJECT ENDS**  
**STA 1012+51 (US 34)**

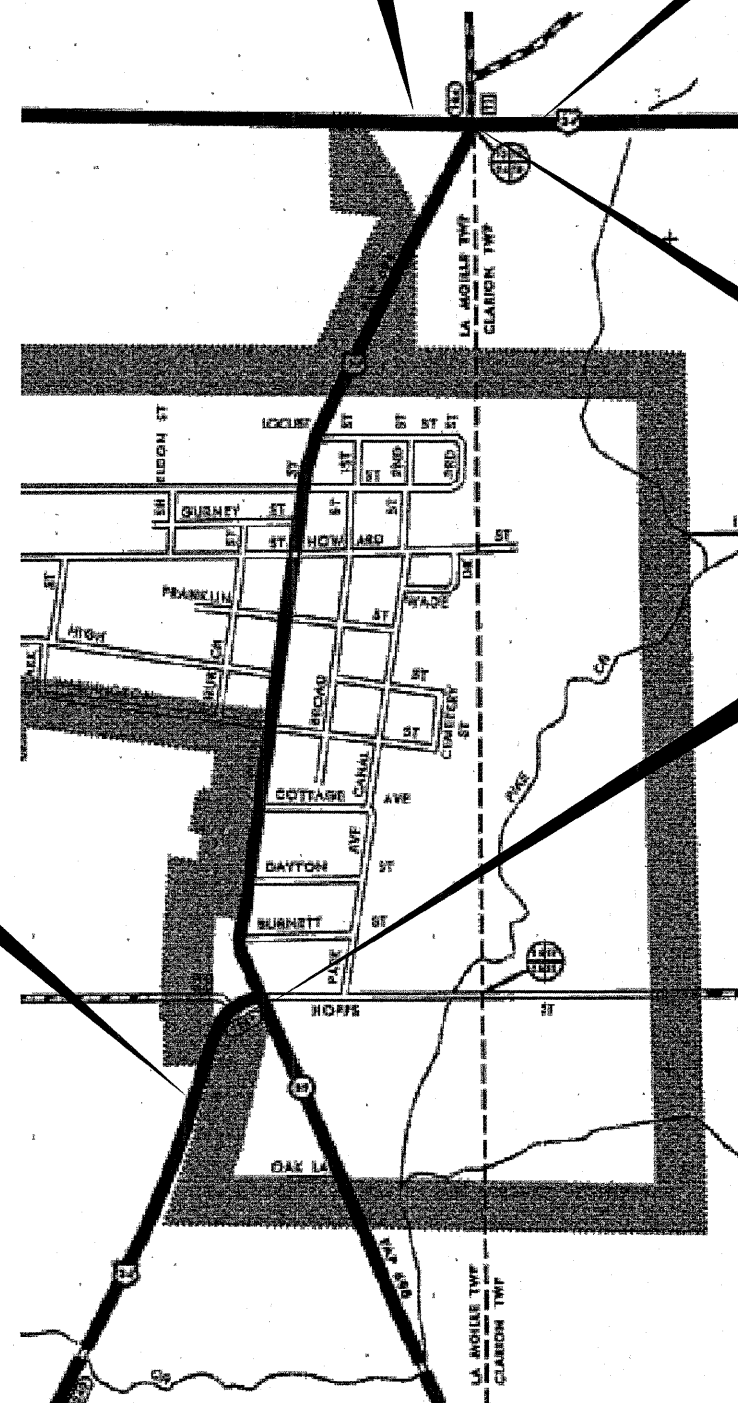

STATE OF ILLINOIS  
DEPARTMENT OF TRANSPORTATION  
DISTRICT THREE

PREPARED BY: David Brank  
DISTRICT STUDIES & PLANS ENGINEER

DATE: 4-19-11

EXAMINED BY: [Signature]  
DISTRICT CONSTRUCTION ENGINEER

Wayne Hulley  
DISTRICT MATERIALS ENGINEER

James A. Hueston  
DISTRICT OPERATIONS ENGINEER

FILE NAME =	USER NAME = monallysr	DESIGNED -	REVISED -	<b>STATE OF ILLINOIS DEPARTMENT OF TRANSPORTATION</b>	<b>GENERAL NOTES, LOCATION MAP</b>	F.A.P. RTE.	SECTION	COUNTY	TOTAL SHEETS	SHEET NO.
es:\pw_work\pwwork\monallysr\d0125888\d38917-sht-details.DGN		DRAWN -	REVISED -			698	(22)RS-5	BUREAU	18	2
PLOT SCALE = 58.6469' / in.		CHECKED -	REVISED -			SCALE: SHEET NO. OF SHEETS STA. TO STA.		CONTRACT NO. 66917		
PLOT DATE = 4/19/2011		DATE -	REVISED -			ILLINOIS FED. AID PROJECT				

SUMMARY OF QUANTITIES				80% FED./20% STATE
CODE NO.	ITEM	UNIT	TOTAL QUANTITY	CONSTRUCTION CODE
				ROADWAY 0005
20101700	SUPPLEMENTAL WATERING	UNIT	1	1
20400800	FURNISHED EXCAVATION	CU YD	26	26
25200110	SODDING, SALT TOLERANT	SQ YD	62	62
40600100	BITUMINOUS MATERIALS (PRIME COAT)	GALLON	2701	2701
40600300	AGGREGATE (PRIME COAT)	TON	68	68
40600400	MIXTURE FOR CRACKS, JOINTS, AND FLANGEWAYS	TON	17	17
40600525	LEVELING BINDER (HAND METHOD), N50	TON	16	16
40600990	TEMPORARY RAMP	SQ YD	354	354
40600625	LEVELING BINDER (MACHINE METHOD), N50	TON	1304	1304
40603310	HOT-MIX ASPHALT SURFACE COURSE, MIX "C", N50	TON	2608	2608
40800050	INCIDENTAL HOT-MIX ASPHALT SURFACING	TON	288	288
42400100	PORTLAND CEMENT CONCRETE SIDEWALK 4 INCH	SQ FT	581.5	581.5
42400800	DETECTABLE WARNINGS	SQ FT	290	290
44000158	HOT-MIX ASPHALT SURFACE REMOVAL, 2 1/4"	SQ YD	31053	31053
44000600	SIDEWALK REMOVAL	SQ FT	938.5	938.5
48101200	AGGREGATE SHOULDERS, TYPE B	TON	647	647
60255500	MANHOLES TO BE ADJUSTED	EACH	4	4
66700205	PERMANENT SURVEY MARKERS, TYPE I	EACH	1	1
67000400	ENGINEER'S FIELD OFFICE, TYPE A	CAL MO	1	1
67100100	MOBILIZATION	L SUM	1	1
70102620	TRAFFIC CONTROL AND PROTECTION, STANDARD 701501	L SUM	1	1
70102640	TRAFFIC CONTROL AND PROTECTION, STANDARD 701801	L SUM	1	1
70300100	SHORT-TERM PAVEMENT MARKING	FOOT	1494.3	1494.3
70300210	TEMPORARY PAVEMENT MARKING - LETTERS AND SYMBOLS	SQ FT	140.6	140.6
70300220	TEMPORARY PAVEMENT MARKING - LINE 4"	FOOT	16729	16729
70300240	TEMPORARY PAVEMENT MARKING - LINE 6"	FOOT	1671	1671
70300250	TEMPORARY PAVEMENT MARKING - LINE 8"	FOOT	1262	1262
70300260	TEMPORARY PAVEMENT MARKING - LINE 12"	FOOT	619	619
70300280	TEMPORARY PAVEMENT MARKING - LINE 24"	FOOT	93	93
70301000	WORK ZONE PAVEMENT MARKING REMOVAL	SQ FT	4659.3	4659.3
78000100	THERMOPLASTIC PAVEMENT MARKING - LETTERS AND SYMBOLS	SQ FT	140.6	140.6

SUMMARY OF QUANTITIES				80% FED./20% STATE
CODE NO.	ITEM	UNIT	TOTAL QUANTITY	CONSTRUCTION CODE
				ROADWAY 0005
* 78000200	THERMOPLASTIC PAVEMENT MARKING - LINE 4"	FOOT	16729	16729
* 78000400	THERMOPLASTIC PAVEMENT MARKING - LINE 6"	FOOT	1671	1671
* 78000500	THERMOPLASTIC PAVEMENT MARKING - LINE 8"	FOOT	1262	1262
* 78000600	THERMOPLASTIC PAVEMENT MARKING - LINE 12"	FOOT	619	619
* 78000650	THERMOPLASTIC PAVEMENT MARKING - LINE 24"	FOOT	93	93
* 78100100	RAISED REFLECTIVE PAVEMENT MARKER	EACH	147	147
78300200	RAISED REFLECTIVE PAVEMENT MARKER REMOVAL	EACH	88	88
X4240420	PORTLAND CEMENT CONCRETE SIDEWALK 4 INCH, SPECIAL	SQ FT	527	527
X4400500	COMBINATION CURB AND GUTTER REMOVAL (SPECIAL)	FOOT	48	48
X4401198	HOT-MIX ASPHALT SURFACE REMOVAL, VARIABLE DEPTH	SQ YD	2708	2708
X4404700	SIDEWALK REMOVAL (SPECIAL)	SQ FT	106	106
X6061700	COMBINATION CONCRETE CURB AND GUTTER, TYPE B,(SPECIAL)	FOOT	48	48

\*SPECIALTY ITEMS

Rev.

	HMA LEVEL BINDER	HMA SURFACE
PG GRADE	PG 64-22	PG 64-22
DESIGN AIR VOIDS	4.0% @ N50	4.0% @ N50
MIXTURE COMPOSITION	IL 9.5	IL 9.5
FRICTION AGGREGATE		MIXTURE C
DENSITY CONTROL LIMITS	Cores	Cores

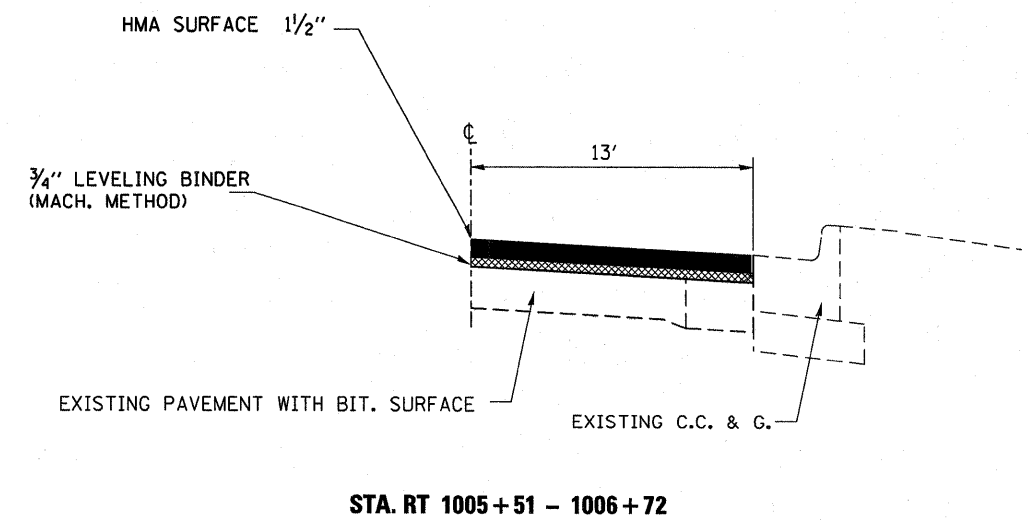
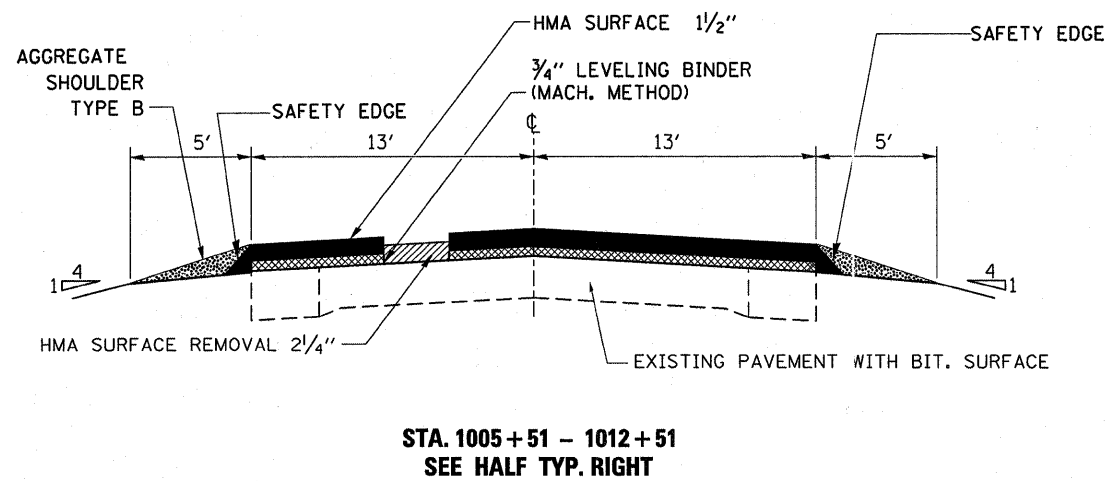
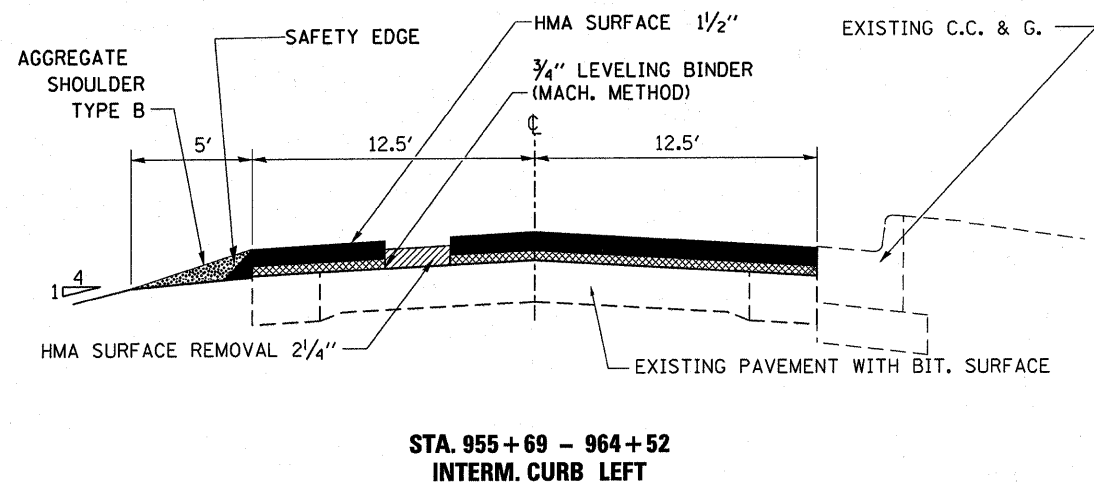
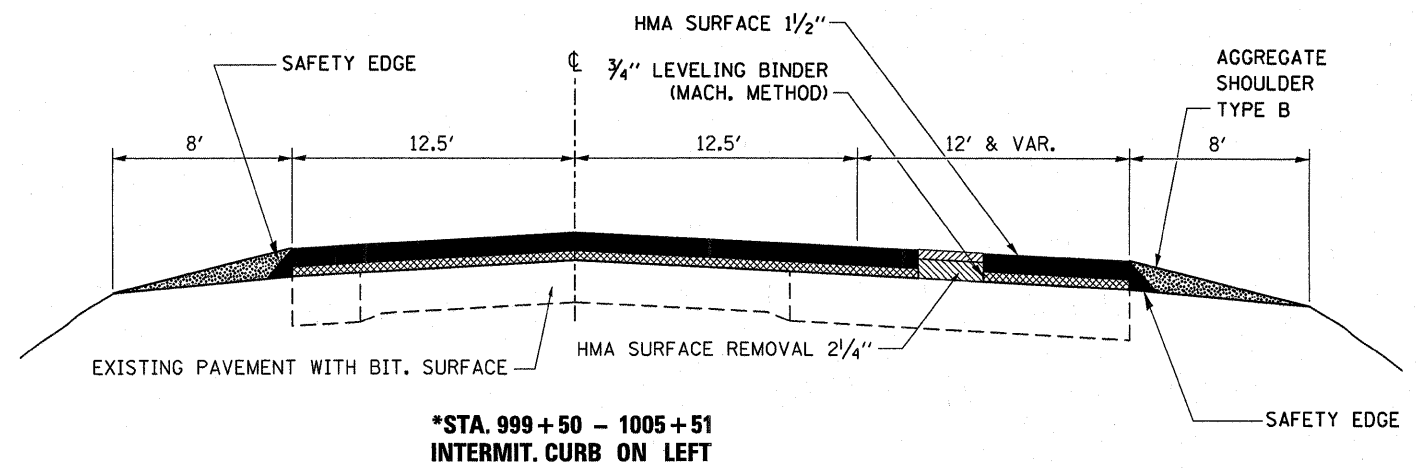

FILE NAME =	USER NAME = mcnallysr	DESIGNED -	REVISED -	<b>STATE OF ILLINOIS DEPARTMENT OF TRANSPORTATION</b>	<b>TYPICAL SECTIONS</b>			F.A. RTE.	SECTION	COUNTY	TOTAL SHEETS	SHEET NO.
c:\pwwork\pwwork\mcnallysr\d0125888\d386917-ah-t-detail.s.dgn		DRAWN -	REVISED -		SCALE:	SHEET NO. 1 OF 1 SHEETS	STA. 950+79 TO STA. 1000+00	698	(22)RS-5	BUREAU	18	4
		CHECKED -	REVISED -					CONTRACT NO. 66917				
		DATE -	REVISED -		ILLINOIS FED. AID PROJECT							

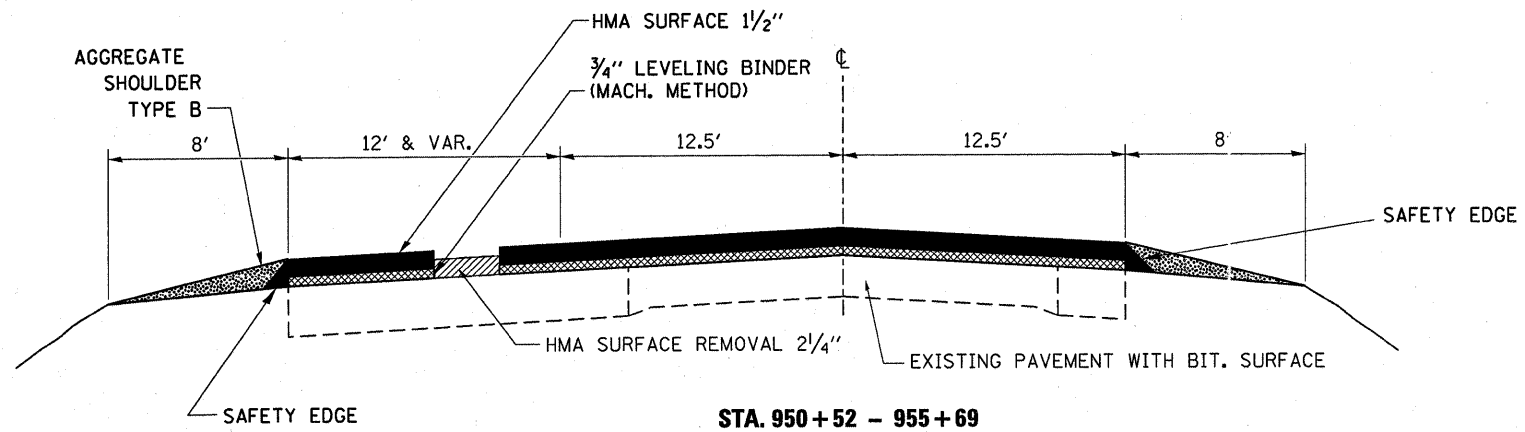

**STA. 950+52 - 955+69**

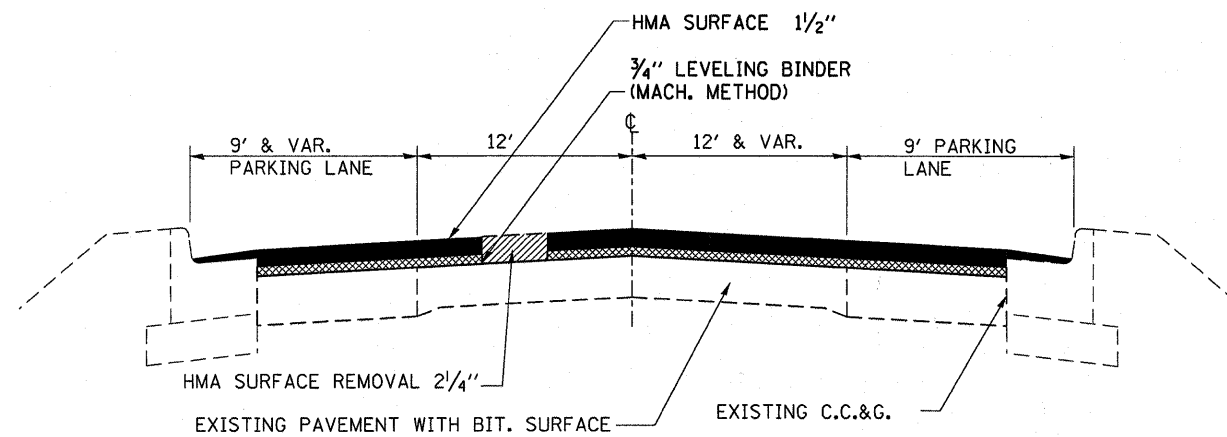

**STA. 970+88 - 993+40**

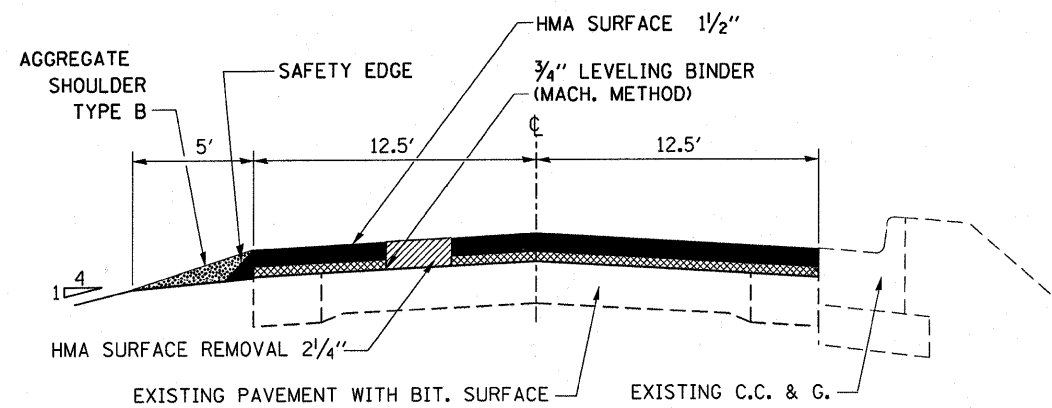

**STA. 964+52 - 970+88**

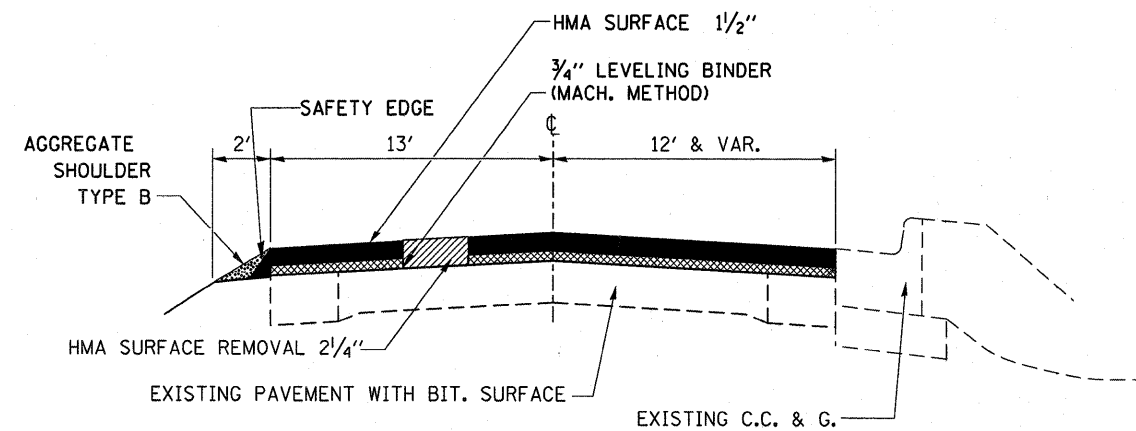

**STA. 993+40 - 999+50**

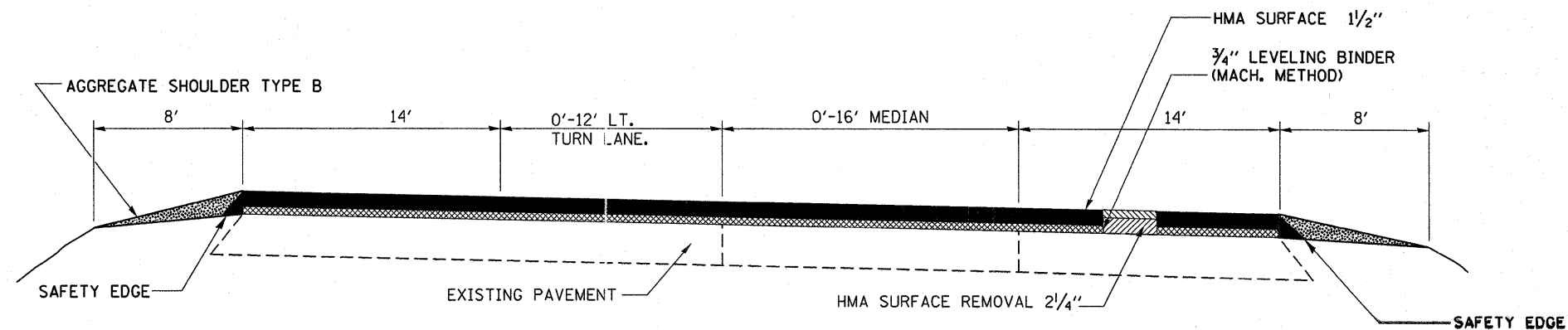

**IL.92  
STA. 889+60 - 908+10**

FILE NAME =	USER NAME = monellyr	DESIGNED -	REVISED -
c:\pwwork\pwwork\monellyr\d0125088\0366917-sht-details.DGN		DRAWN -	REVISED -
PLOT SCALE = 50.2743 ' / 1"		CHECKED -	REVISED -
PLOT DATE = 4/19/2011		DATE -	REVISED -

**STATE OF ILLINOIS  
DEPARTMENT OF TRANSPORTATION**

**TYPICAL SECTIONS**

SCALE: SHEET NO. 1 OF 1 SHEETS STA. 950+79 TO STA. 1000+00

F.A. RTE.	SECTION	COUNTY	TOTAL SHEETS	SHEET NO.
698	(22)RS-5	BUREAU	18	5
CONTRACT NO. 66917			ILLINOIS FED. AID PROJECT	

MAINLINE SCHEDULE											
LOCATION	LENGTH	AREA	HMA SURF REMOVAL 2 1/4"	HMA SURF CSE N50	LEVEL BINDER (HM) N50	LEVEL BINDER (MM) N50	TEMP RAMP	BIT MATL (PR CT)	AGG (PR CT)	MIX FOR CRACKS, JTS & FLGWYS	AGG SHLD TY B
	FOOT	SQ YD	SQ YD	TON	TON	TON	SQ YD	GALLON	TON	TON	TON
US 34											
950+52 - 950+79	27	159	159	13.4	0.1	6.7		12.7	0.3	0.0	5.5
950+79 - 951+51	72	437.6	437.6	36.8	0.2	18.4		35.0	0.9	0.1	14.7
951+51 - 952+99	148	608.4	608.4	51.1	0.3	25.6		48.7	1.2	0.2	30
952+99 - 955+69	270	945	945	79.4	0.5	39.7		75.6	1.9	0.3	54.8
955+69 - 964+52	883	2550.9	2550.9	214.3	1.3	107.1		204.1	5.1	0.8	112
964+52 - 970+88	636	1837.3	1837.3	154.3	0.9	77.2		147.0	3.7	0.6	40.3
970+88 - 971+28	40	126.7	126.7	10.6	0.1	5.3		10.1	0.3	0.0	
971+28 - 971+70	42	156.3	156.3	13.1	0.1	6.6		12.5	0.3	0.0	
971+70 - 972+60	90	370	370	31.1	0.2	15.5		29.6	0.7	0.1	
972+60 - 975+64	304	1418.7	1418.7	119.2	0.7	59.6		113.5	2.8	0.4	
975+64 - 977+61	197	1050.7	1050.7	88.3	0.5	44.1		84.1	2.1	0.3	
977+61 - 993+00	1539	7182	7182	603.3	3.6	301.6		574.6	14.4	2.2	
993+00 - 993+90	90	340	340	28.6	0.2	14.3		27.2	0.7	0.1	
993+90 - 998+00	410	1184.4	1184.4	99.5	0.6	49.7		94.8	2.4	0.4	10.4
998+00 - 999+50	150	483.3	483.3	40.6	0.2	20.3		38.7	1.0	0.1	3.8
999+50 - 1005+51	601	2470	2470	207.5	1.2	103.7	32.2	197.6	4.9	0.7	
1005+51 - 1012+51	700	2022	2022	169.8	1.0	84.9	32.2	161.8	4.0	0.6	
IL 92											
889+60 - 890+00	40	117.8	117.8	9.9	0.1	4.9	31.1	9.4	0.2	0.1	8.1
890+00 - 891+18	118	373.7	373.7	31.4	0.2	15.7		29.9	0.7	0.1	23.9
891+18 - 896+26	508	2201.3	2201.3	184.9	1.1	92.5		176.1	4.4	0.7	103.1
896+26 - 897+29	103	549.3	549.3	46.1	0.3	23.1		43.9	1.1	0.2	20.9
897+29 - 898+04	75	387.5	387.5	32.6	0.2	16.3		31.0	0.8	0.1	15.2
898+04 - 900+34	230	1150	1150	96.6	0.6	48.3		92.0	2.3	0.3	46.7
900+34 - 905+44	510	2125	2125	178.5	1.1	89.3		170.0	4.3	0.6	103.5
905+44 - 907+12	168	522.7	522.7	43.9	0.3	22.0		41.8	1.0	0.2	34.1
907+12 - 908+10	98	283.1	283.1	23.8	0.1	11.9	31.1	22.6	0.6	0.1	19.9
<b>TOTALS</b>		<b>31053</b>	<b>31053</b>	<b>2608</b>	<b>16</b>	<b>1304</b>	<b>127</b>	<b>2484</b>	<b>62</b>	<b>9</b>	<b>647</b>

SIDE ROAD AND ENTRANCE SCHEDULE										
LOCATION	TYPE	DESCRIPTION	LENGTH	AREA	BIT MATLS PR CT	AGG PRIME COAT	HMA SURF REMOVAL VAR DEPTH	INC HMA SURFACE	TEMP RAMP	FURNISHED EXCAVATION
STA			FOOT	SQ YD	GAL	TON	SQ YD	TON	SQ YD	CU YD
SIDE ROADS										
971+00	BIT	LOCUST ST.	30	143.3	11.5	0.3	143.3	15.2	14.0	2
974+22 LT	BIT	RAILROAD ST	30	135	10.8	0.3	135.0	14.4	20.0	2
974+82 RT	BIT	RAILROAD ST	30	103.3	8.3	0.2	103.3	11.0	20.0	2
976+47 RT	BIT	GURNEY ST	30	150	12.0	0.3	150.0	16.0	30.0	2
982+00 LT	BIT	FRANKLIN ST	30	131.7	10.5	0.3	131.7	14.0	24.7	2
982+00 RT	BIT	FRANKLIN ST	30	120	9.6	0.2	120.0	12.8	20.0	2
985+40 RT	BIT	HIGH ST	30	96.7	7.7	0.2	96.7	10.3	13.3	2
988+55 LT	BIT	WASHINGTON ST	30	103.3	8.3	0.2	103.3	11.0	13.3	2
988+55 RT	BIT	WASHINGTON ST	30	96.7	7.7	0.2	96.7	10.3	13.3	2
993+52 LT	BIT	COTTAGE ST	30	98.3	7.9	0.2	98.3	10.5	12.7	2
997+91 LT	BIT	DAYTON ST	30	116.7	9.3	0.2	116.7	12.4	12.0	2
1001+11	BIT	BURNETTE	30	100	8.0	0.2	100.0	10.6	14.0	2
1005+51	BIT	HOPPS	30	165	13.2	0.3	165.0	17.6	20.0	2
ENTRANCES										
953+16 RT	BIT	CE	30	201.7	16.1	0.4	201.7	21.5		
954+74 RT	BIT	CE	30	370	29.6	0.7	370.0	39.4		
958+39 RT	BIT	CE	30	342	27.4	0.7	342.0	36.4		
965+00 LT	BIT	CE	22	73.3	5.9	0.1	73.3	7.8		
968+79 LT	BIT	CE	20	66.7	5.3	0.1	66.7	7.1		
990+59 LT	BIT	PE	10	13.3	1.1	0.0	13.3	1.4		
995+20 LT	BIT	PE	12	53.3	4.3	0.1	53.3	5.7		
996+14 LT	BIT	PE	10	27.2	2.2	0.1	27.2	2.9		
<b>TOTALS</b>					<b>217</b>	<b>5</b>	<b>2708</b>	<b>288</b>	<b>227</b>	<b>26</b>

\*FURNISHED EXCAVATION SHALL BE MULCHED, SEEDED, AND FERTILIZED. COST WILL BE INCLUDED IN FURNISHED EXCAVATION PAY ITEM

FILE NAME =	USER NAME = monallysr	DESIGNED -	REVISED -	<b>STATE OF ILLINOIS DEPARTMENT OF TRANSPORTATION</b>	<b>SCHEDULES</b>				F.A.P. RTE.	SECTION	COUNTY	TOTAL SHEETS	SHEET NO.
ot\pwwork\pwwork\monallysr\d0125088\d35917-sht-details.DGN		DRAWN -	REVISED -		SCALE:	SHEET NO.	OF	SHEETS	STA.	TO STA.	BUREAU	18	6
PLOT SCALE = 50.0000' / in.		CHECKED -	REVISED -		CONTRACT NO. 66917								
PLOT DATE = 4/19/2011		DATE -	REVISED -		ILLINOIS FED. AID PROJECT								

TEMPORARY PAVEMENT MARKING												
LOCATION	LENGTH	SHORT TERM PAVEMENT MARKING	WORK ZONE PAVMT MARK REMOVAL	TEMPORARY PAVEMENT MARKING LINE								LETTERS & SYMBOLS SQ FT
				4 INCH	4 INCH	6 INCH	6 INCH	8 INCH	12 INCH	12 INCH	24 INCH	
				WHITE	YELLOW	WHITE	YELLOW	WHITE	WHITE	YELLOW	WHITE	
STA		FOOT	SQ FT	FOOT	FOOT	FOOT	FOOT	FOOT	FOOT	FOOT	FOOT	
IL 92												
889+60 - 891+18	158	16	6	316			40					
891+18 - 894+17	299	119	39	598	1196					80		
894+17 - 895+97	180	72	24	360	720			46		64		15.6
895+97 - 896+97	100	40	13	200	400			100		16	26	15.6
896+97 - 898+06	109											
898+06 - 900+31	225	90	30	450	900			225		32	26	15.6
900+31 - 902+90	259	103	34	518	1036			66		60		15.6
902+90 - 905+45	255	102	34	510	1020					44		
905+45 - 908+10	265	27	9	530			70					
IL 34												
950+52 - 951+98	146	30	10	292	292			209		68	29	31.2
951+98 - 955+00	302	60	20	604	604			76				
955+00 - 964+60	960	96	32	1920			240					
964+60 - 971+31	671	67	22	671			170					
971+31 - 993+90	2259	226	75				570					
993+90 - 999+50	560	56	18	560			140					
999+50 - 1005+51	601	180.3	1983.3	1202		160	151	350				47
1005+51 - 1012+51	700	210	2310	1300	410		110	190	190	65		
LaMoille Road												
0+13 - 0+70	57			120			20				12	
TOTALS		1494.3	4659.3	10151	6578	160	1511	1262	190	429	93	140.6

PAVEMENT MARKING										
LOCATION	LENGTH	THERMOPLASTIC PAVEMENT MARKING LINE								LETTERS & SYMBOLS SQ FT
		4 INCH	4 INCH	6 INCH	6 INCH	8 INCH	12 INCH	12 INCH	24 INCH	
		WHITE	YELLOW	WHITE	YELLOW	WHITE	WHITE	YELLOW	WHITE	
STA		FOOT	FOOT	FOOT	FOOT	FOOT	FOOT	FOOT	FOOT	
IL 92										
889+60 - 891+18	158	316				40				
891+18 - 894+17	299	598	1196					80		
894+17 - 895+97	180	360	720			46		64		15.6
895+97 - 896+97	100	200	400			100		16	26	15.6
896+97 - 898+06	109									
898+06 - 900+31	225	450	900			225		32	26	15.6
900+31 - 902+90	259	518	1036			66		60		15.6
902+90 - 905+45	255	510	1020					44		
905+45 - 908+10	265	530			70					
IL 34										
950+52 - 951+98	146	292	292			209		68	29	31.2
951+98 - 955+00	302	604	604			76				
955+00 - 964+60	960	1920			240					
964+60 - 971+31	671	671			170					
971+31 - 993+90	2259				570					
993+90 - 999+50	560	560			140					
999+50 - 1005+51	601	1202		160	151	350				47
1005+51 - 1012+51	700	1300	410		110	190	190	65		
LaMoille Road										
0+13 - 0+70	57	120			20				12	
TOTALS		10151	6578	160	1511	1262	190	429	93	140.6

FILE NAME =	USER NAME = mcnallyer	DESIGNED -	REVISED -	<b>STATE OF ILLINOIS DEPARTMENT OF TRANSPORTATION</b>	<b>SCHEDULES</b>				F.A.P. RTE.	SECTION	COUNTY	TOTAL SHEETS	SHEET NO.
ot\pwork\pwork\mcnallyer\d0125088\d36917-sht-details.DGN		DRAWN -	REVISED -		SCALE:	SHEET NO.	OF	SHEETS	STA.	TO STA.	BUREAU	18	7
PLOT SCALE = 50.0000' / in.		CHECKED -	REVISED -		CONTRACT NO. 66917								
PLOT DATE = 4/19/2011		DATE -	REVISED -		ILLINOIS FED. AID PROJECT								



SIDEWALK SCHEDULE FOR NEW RAMP INSTALLATION										
LOCATION SIDE STREET QUAD	PCC SIDEWALK 4" SQ FT	PCC SIDEWALK 4" SPECIAL SQ FT	DETECTABLE WARNINGS		CC&G (SPEC) FOOT	SIDEWALK REMOVAL SQ FT	CC&G REMOV (SPEC) FOOT	SIDEWALK REMOVAL (SPEC)	SOD, SALT TOLERANT SQ YD	SUPPLEMENTAL WATERING UNITS
			US/34 SQ FT	SIDE ROAD ACCESS SQ FT						
HOPPS										
NE	20			8	8	20	8		2	0.02
SE	20			8	8	20	8		2	0.02
BURNETTE										
NE	20			8	0	20	0		2	0.02
SE	20			8	0	20	0		2	0.02
DAYTON ST										
NE	20			8	0	20	0		2	0.02
SE	20			8	0	20	0		2	0.02
COTTAGE										
NE	20			8	0	20	0		2	0.02
SE	20			8	0	20	0		2	0.02
WASHINGTON										
NW	20			8	0	20	0		2	0.02
NE	20			8	0	20	0		2	0.02
SW	20			8	0	20	0		2	0.02
SE	20			9	0	20	0		2	0.02
High ST										
NW	64			9					0	0.00
SW		96	8	8	0	76	0	20	6	0.05
E	20			8		20			0	0.00
FRANKLIN										
NW		243	9	9	0	198	0	45	6	0.05
NE		68	8	8	0	52	0	16	4	0.04
SW		120		10	0	95	0	25	6	0.05
SE	20			20	0	20	0	0	2	0.02
MARTIN										
NW	25			10	7	25	7		0	0.00
NE	25			10	7	25	7		0	0.00
SW	25			10	7	25	7		0	0.00
SE	22.5			10	7	22.5	7		2	0.02
GURNEY										
NW	22.5			9	0	22.5	0		2	0.02
SW	22.5			9	4	22.5	4		0	0.00
RAILROAD										
NW	22.5			9	0	22.5			4	0.04
NE	25			10	0	25	0		2	0.02
SW	22.5			9	0	22.5	0		4	0.04
SE	25			10		25			0	0
TOTAL	581.5	527	25	265	48	938.5	48	106	62	0.56

RAISED REFLECTIVE PAVEMENT MARKER					
LOCATION	TYPE			RAISED REFLECTIVE PAVEMENT MARKER EACH	RAISED REFL PVT MARKER REMOVAL EACH
	ONE-WAY AMBER	TWO-WAY AMBER	ONE-WAY CRYSTAL		
STA	EACH	EACH	EACH	EACH	EACH
IL 92					
889+60 - 891+18		3		3	3
891+18 - 894+17	10	6		16	16
894+17 - 895+97	6	2		8	8
895+97 - 896+97		6	3	9	9
896+97 - 898+06					
898+06 - 900+31		12	6	18	18
900+31 - 902+90	12	2		14	14
902+90 - 905+45	6	6		12	12
905+45 - 908+10		3		3	3
US 34					
950+52 - 951+98		2	3	5	5
951+98 - 999+50		59		59	
TOTALS	34	101	12	147	88

MANHOLE SCHEDULE		
LOCATION	OFFSET	MANHOLE TO BE ADJUSTED
STA	LT/RT	EACH
978+00	LT	1
978+50	LT	1
988+38	RT	1
993+29	RT	1
1005+51	LT	1
TOTAL		5

FILE NAME =	USER NAME = monallyer	DESIGNED -	REVISED -	<b>STATE OF ILLINOIS DEPARTMENT OF TRANSPORTATION</b>	<b>SCHEDULES</b>			F.A.P RTE.	SECTION	COUNTY	TOTAL SHEETS	SHEET NO.	
ot\pw_work\p\ridot\monallyer\d0125088\d36917-sht-details.DGN		DRAWN -	REVISED -		SCALE:	SHEET NO.	OF	SHEETS	STA.	TO STA.	BUREAU	18	8
PLOT SCALE = 50.0000' / in.		CHECKED -	REVISED -		CONTRACT NO. 66917								
PLOT DATE = 4/19/2011		DATE -	REVISED -		ILLINOIS FED. AID PROJECT								



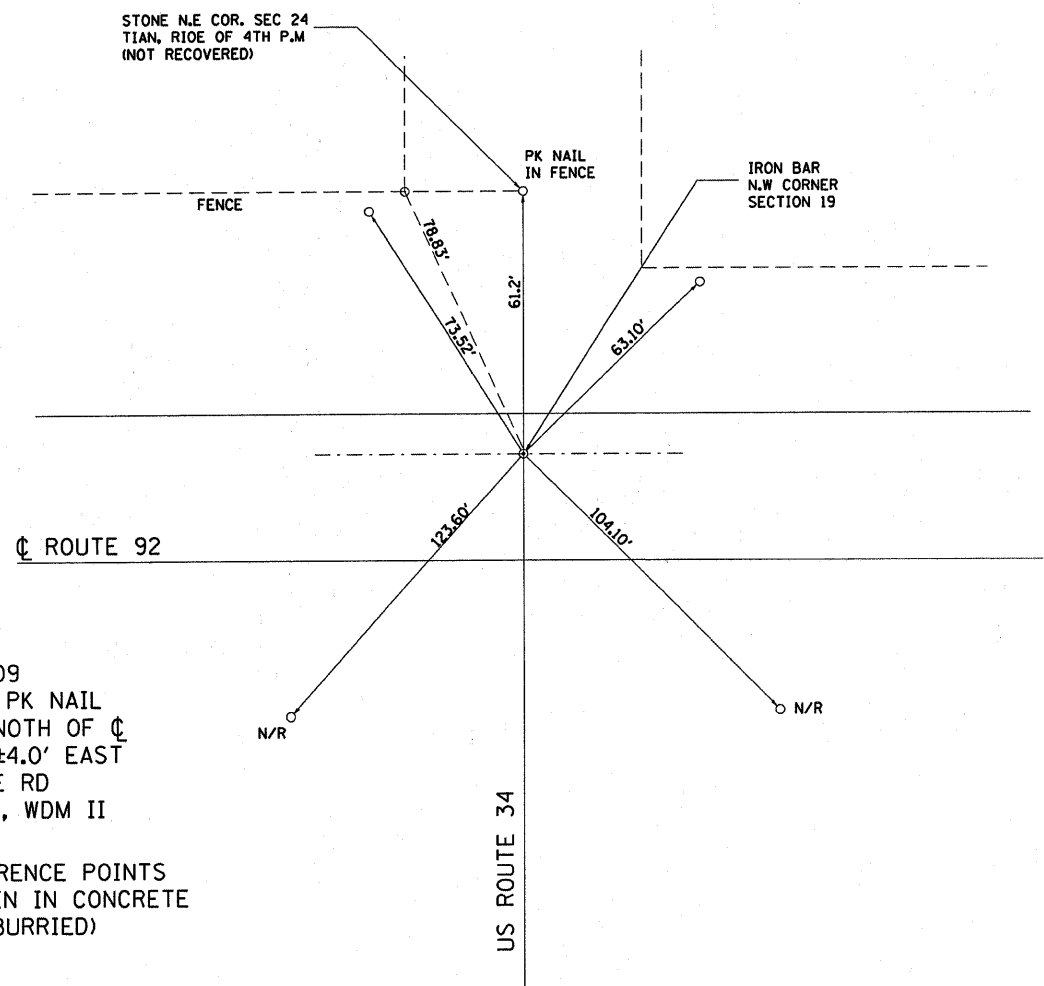

2/09/09  
 FOUND PK NAIL  
 ±9.0' NOTH OF  $\dot{C}$   
 RT92 ±4.0' EAST  
 $\dot{C}$  300E RD  
 RM, GB, WDM II

⊙ REFERENCE POINTS  
 IRON PIN IN CONCRETE  
 POST (BURRIED)

• PERMANENT PAVEMENT MARKERS  
 SHALL BE ESTABLIS BY RESIDENT  
 ENGINEER

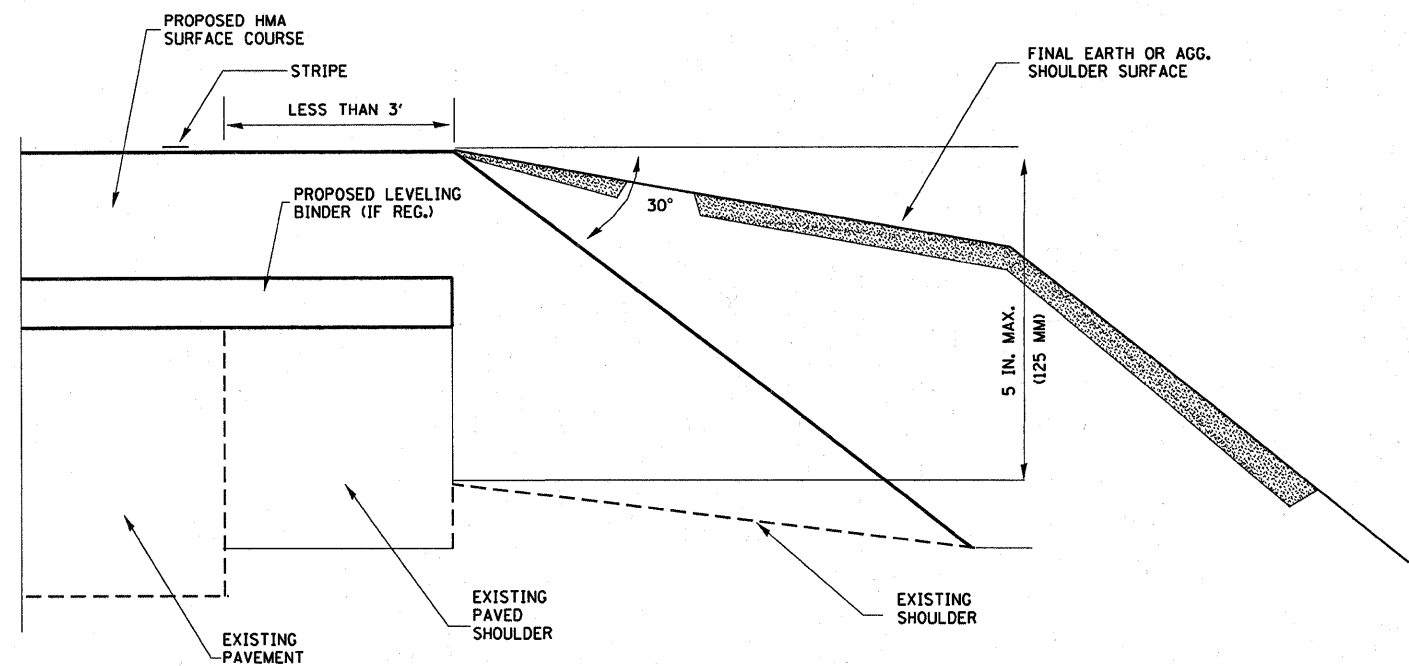

SAFETY EDGE

\*SAFETY EDGE TO BE USED AT ALL LOCATIONS  
 OUTSIDE OF CURB AND GUTTER AREA.

FILE NAME =	USER NAME = monallysr	DESIGNED -	REVISED -	<b>STATE OF ILLINOIS DEPARTMENT OF TRANSPORTATION</b>	<b>TIE POINTS</b>		F.A. RTE.	SECTION	COUNTY	TOTAL SHEETS	SHEET NO.
ci\pw_work\p\dot\monallysr\d0125088\d366917-sht-details.DGN		DRAWN -	REVISED -		698	(22)RS-5	BUREAU	18	9		
PLOT SCALE = 50.0000 ' / in.		CHECKED -	REVISED -		CONTRACT NO. 66917						
PLOT DATE = 4/19/2011		DATE -	REVISED -		SCALE:	SHEET NO. 1 OF 1 SHEETS	STA. 950+79 TO STA. 1000+00	ILLINOIS FED. AID PROJECT			



EXISTING R.O.W.

EXISTING R.O.W.

PROJECT BEGINS  
STA. 889+60

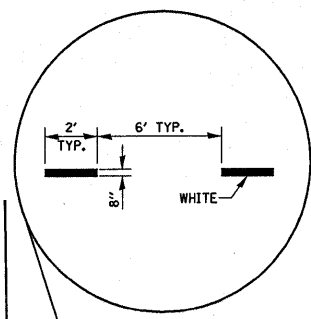
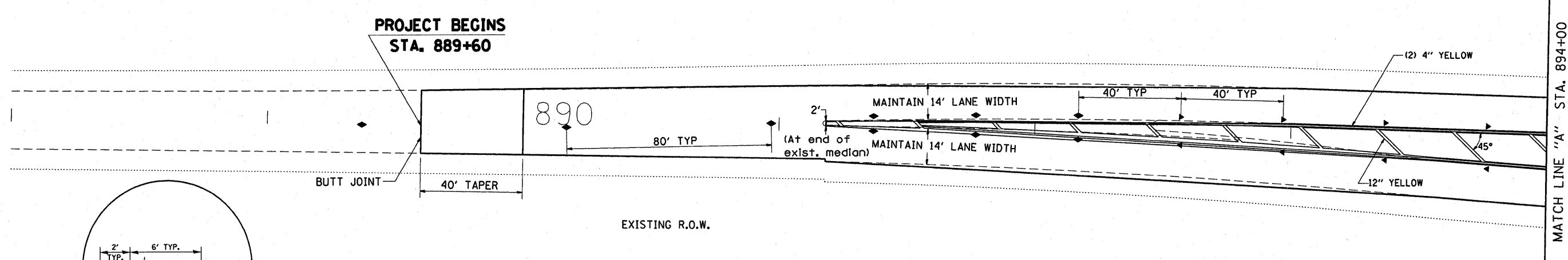

EXISTING R.O.W.

EXISTING R.O.W.

EXISTING R.O.W.

MATCH LINE "B" STA. 900+00

PROPOSED STRIPING TO  
MATCH EXISTING MEDIAN

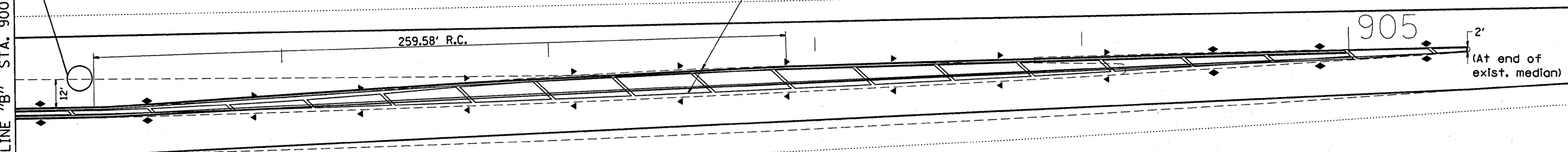

MATCH LINE "C" STA. 906+00

**LEGEND**

- ◆ TWO-WAY YELLOW Raised Reflective Pavement Marker
- ◁ ONE-WAY WHITE Raised Reflective Pavement Marker
- ◄ ONE-WAY YELLOW Raised Reflective Pavement Marker



MATCH LINE "C" STA. 906+00

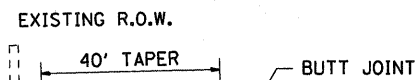

PROJECT ENDS  
STA. 908+10

FILE NAME =	USER NAME = monallyer	DESIGNED -	REVISED -	<b>STATE OF ILLINOIS DEPARTMENT OF TRANSPORTATION</b>	<b>PAVEMENT MARKINGS IL 92</b>			F.A. RTE.	SECTION	COUNTY	TOTAL SHEETS	SHEET NO.
o:\pwork\pwork\monallyer\d0125088\d36917-sht-details.DGN		DRAWN -	REVISED -		698	(22)RS-5	BUREAU	18	11			
PLOT SCALE = 50.0000' / 1"		CHECKED -	REVISED -		CONTRACT NO. 66917							
PLOT DATE = 4/19/2011		DATE -	REVISED -		ILLINOIS FED. AID PROJECT							
				SCALE:	SHEET NO. 1 OF 1 SHEETS	STA. 950+79	TO STA. 1000+00					

# PAVEMENT MARKING DETAILS IL 89/US 34 INTERSECTION



NOTE. THESE STATIONS ARE IN METRIC.  
THIS IS FOR THE LAYOUT OF THE STRIPING  
AT THIS INTERSECTION ONLY. THE REST OF THE  
PROJECT IS IN ENGLISH

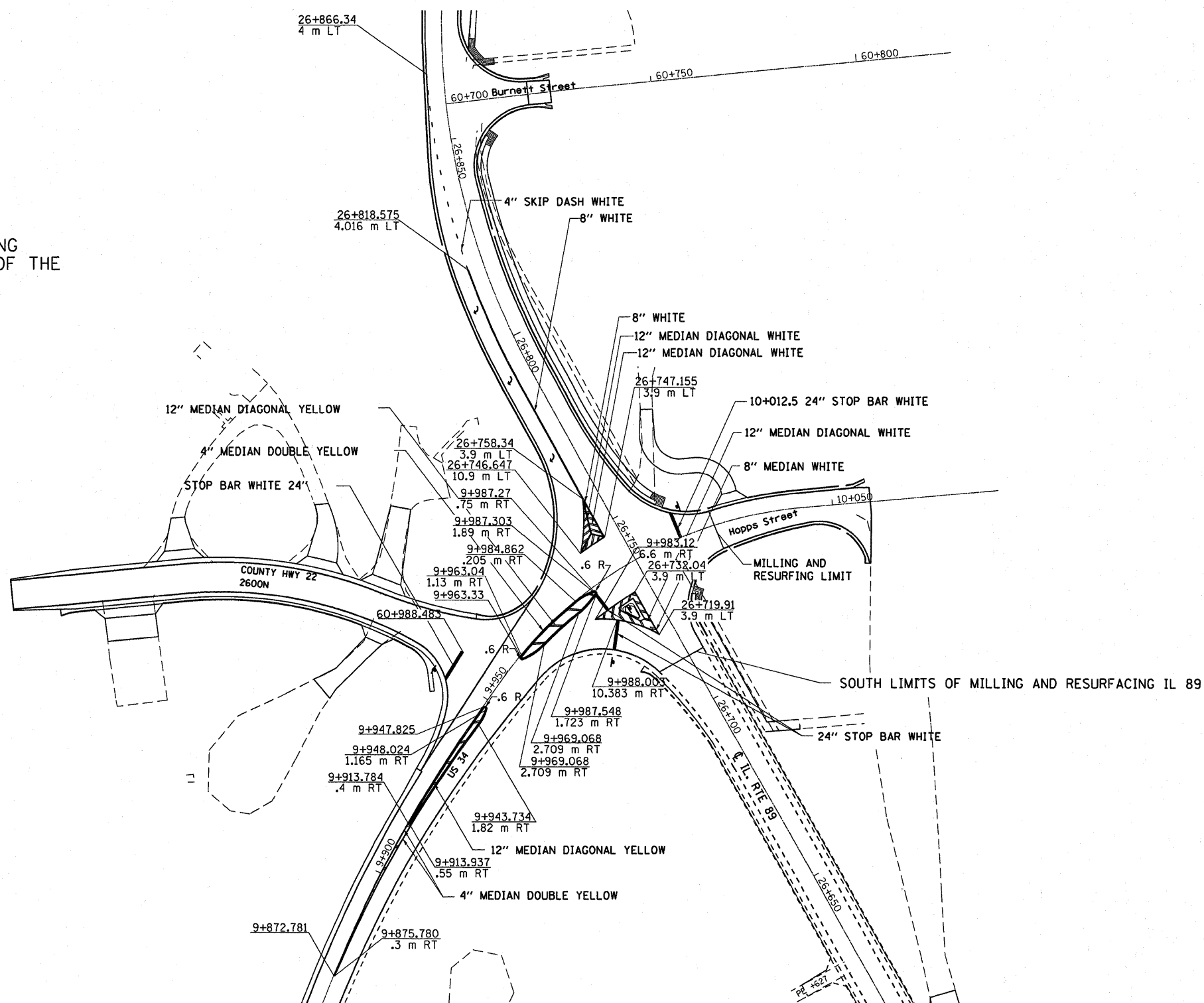

FILE NAME =	USER NAME = monallyer	DESIGNED -	REVISED -	<b>STATE OF ILLINOIS DEPARTMENT OF TRANSPORTATION</b>	<b>PAVEMENT MARKINGS-IL 89/US 34 INTERSECTION</b>	F.A. RTE.	SECTION	COUNTY	TOTAL SHEETS	SHEET NO.	
ci:\pw_work\pvidot\monallyer\d0125088\d36917-sht-details.DGN		DRAWN -	REVISED -			698	(22)RS-5	BUREAU	18	12	
PLOT SCALE = 50.0000' / in.		CHECKED -	REVISED -			CONTRACT NO. 66917					
PLOT DATE = 4/19/2011		DATE -	REVISED -			SCALE:	SHEET NO. 1 OF 1 SHEETS	STA. 950+79	TO STA. 1000+00	ILLINOIS FED. AID PROJECT	

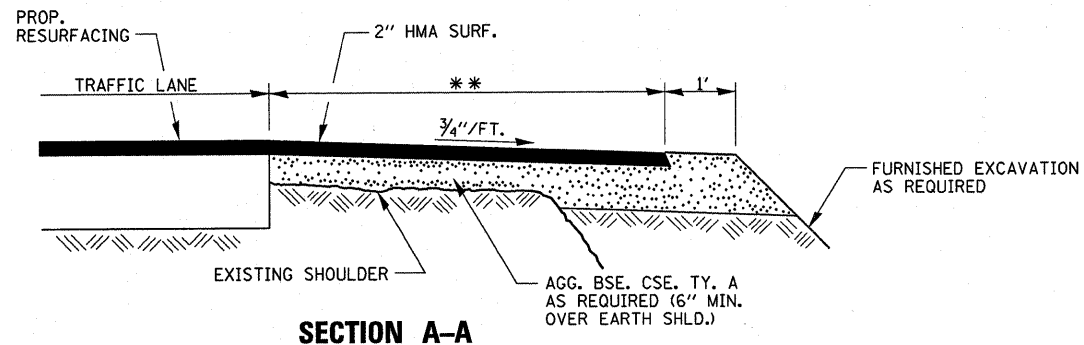
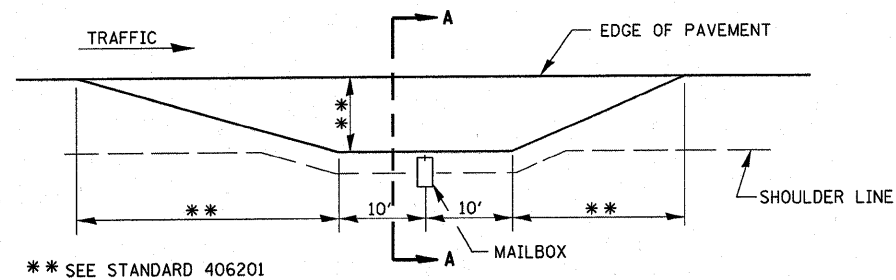

**RURAL MAILBOX TURNOUT DETAILS**

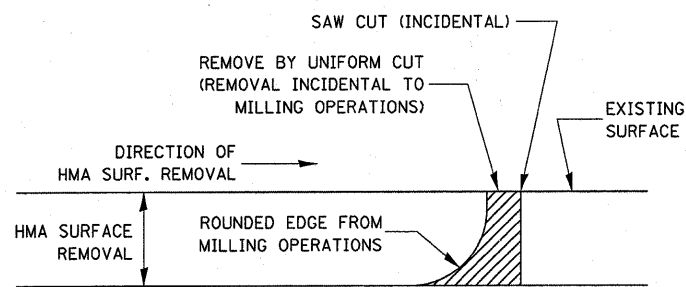

NOTE:  
WHEN MILLING OPERATIONS PRODUCE A ROUNDED EDGE, THEN A SAW CUT SHALL BE USED TO MANUFACTURE A PERPENDICULAR EDGE AS SHOWN IN THE DETAIL. THE ENGINEER SHALL BE THE SOLE JUDGE CONCERNING THE USE OF THIS DETAIL.

**HMA DETAIL AT BUTT JOINTS**

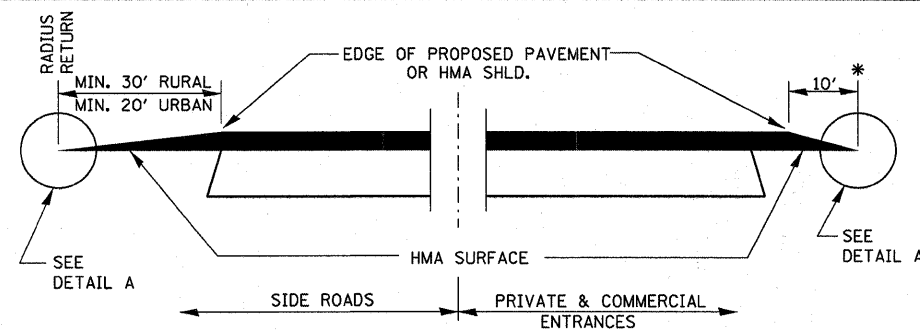

**SECTION A-A  
DETAILS AT ENTRANCES & SIDE ROADS**

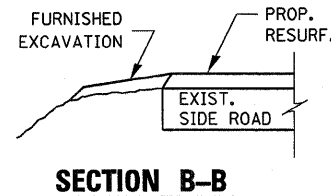

THE COST OF REMOVAL AT EXISTING HMA OR P.C.C. LOCATIONS SHALL BE PAID FOR PER SQ. YD. BY THE APPROPRIATE PAY ITEM. REMOVAL AT THE EXISTING AGG. LOCATIONS SHALL BE INCIDENTAL TO THE HMA. A-3 LOCATIONS SHALL BE FEATHER TAPERED.

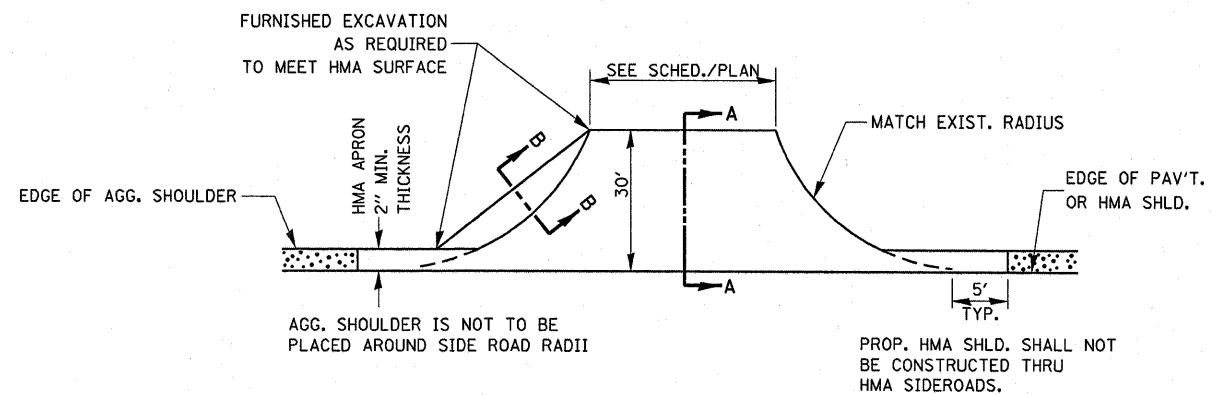
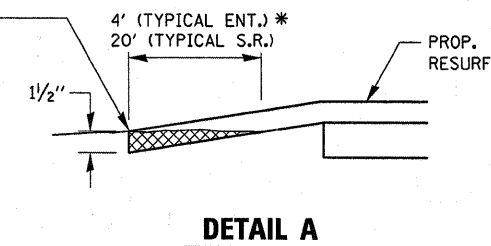

**PLAN AT SIDE ROADS**

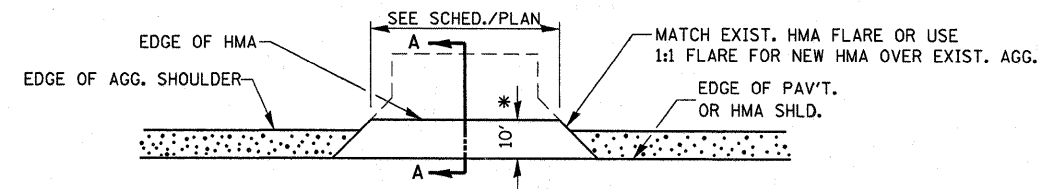

**PLAN AT PRIVATE & COMMERCIAL ENTRANCES**

(DO NOT RESURFACE FIELD ENTRANCES)

\* PROPOSED HMA RESURFACING AT PUBLIC EDUCATIONAL FACILITY ENTRANCES SHALL BE EXTENDED TO THE RIGHT-OF-WAY LIMITS.

FILE NAME =	USER NAME = mcnallys	DESIGNED -	REVISED -	<b>STATE OF ILLINOIS DEPARTMENT OF TRANSPORTATION</b>	<b>DETAILS</b>			F.A. RTE.	SECTION	COUNTY	TOTAL SHEETS	SHEET NO.	
ci\pw_work\pwidot\mcnallys\40125088\d365917-sht-details.DGN		DRAWN -	REVISED -		SCALE:	SHEET NO. 1 OF 1 SHEETS	STA. 950+79	TO STA. 1000+00	698	(22)RS-5	BUREAU	18	13
PLOT SCALE = 50,0000' / in.		CHECKED -	REVISED -		<b>CONTRACT NO. 66917</b>								
PLOT DATE = 4/19/2011		DATE -	REVISED -		ILLINOIS FED. AID PROJECT								

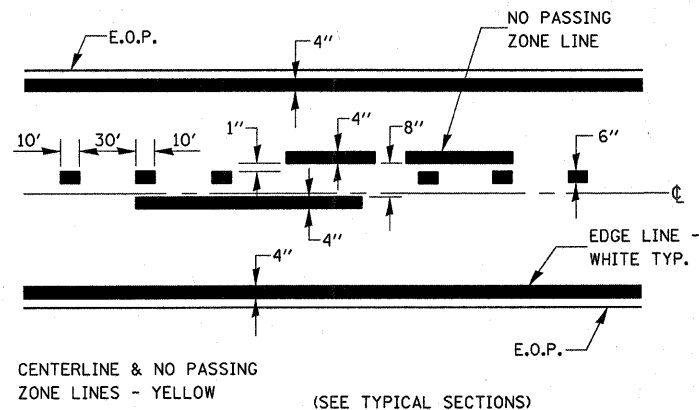
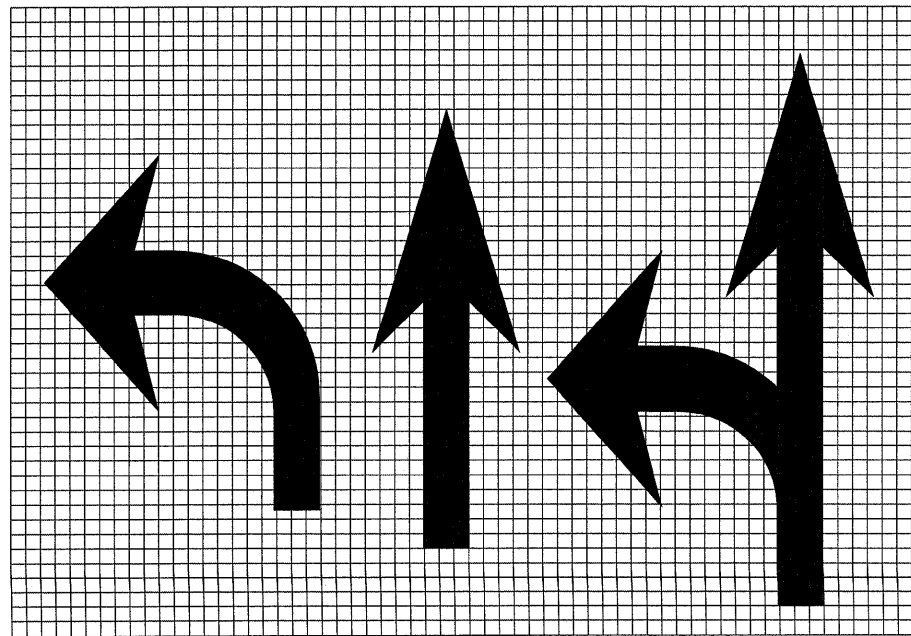

**PAVEMENT MARKING**

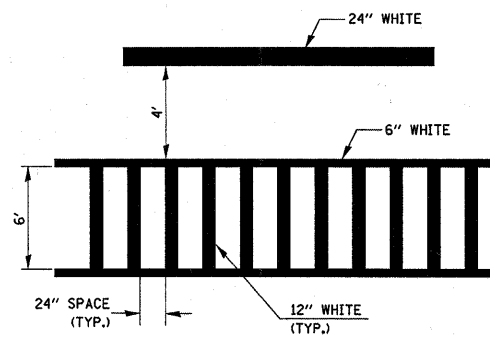

**TYPICAL SPACING DETAIL FOR CROSSWALKS AND STOP BARS**

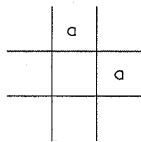

LEGEND HEIGHT	ARROW SIZE	a
6'	SMALL	2.9
8'	LARGE	3.8

THE SPACE BETWEEN ADJACENT LETTERS OR NUMERALS SHOULD BE APPROXIMATELY 3' FOR 6' LEGEND AND 4' FOR 8' LEGEND.

**LETTER AND ARROW GRID SCALE**

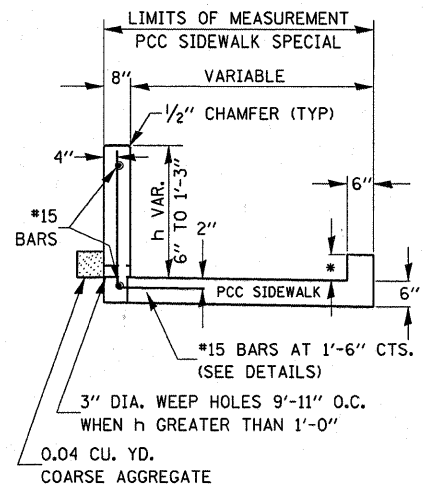

**TYPE 1**  
APPLIED AT LOCATIONS WHERE WALL HEIGHT VARIES FROM 6" TO 1'-3"

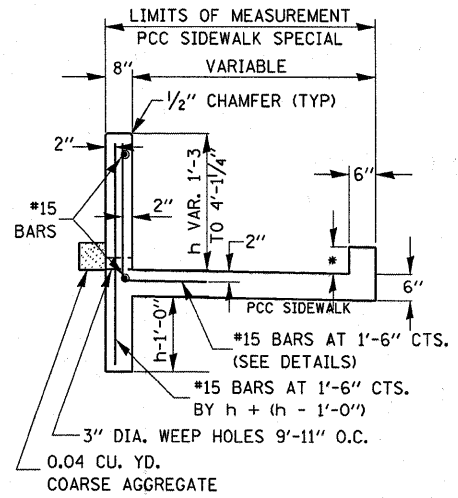

**TYPE 2**  
APPLIED AT LOCATIONS WHERE WALL HEIGHT VARIES FROM 1'-3" TO 4'-1/4"

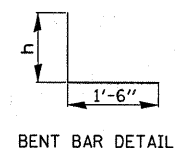

BENT BAR DETAIL

**PCC SIDEWALK SPECIAL WITH RETAINING WALL**

AT FRANKLIN ST & US34, NW, SW, NE QUADRANTS

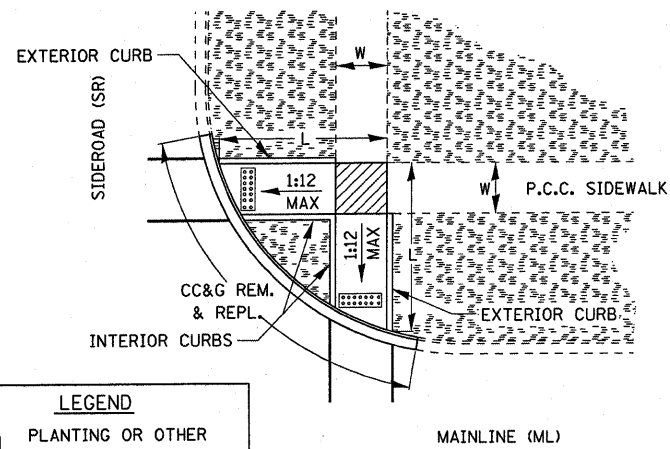

- LEGEND**
- PLANTING OR OTHER NON-WALKING SURFACE
  - SLOPE = 2% MAX.
  - DETECTABLE WARNING

**ADA SIDEWALK ACCESSIBILITY RAMPS  
METHOD 1**

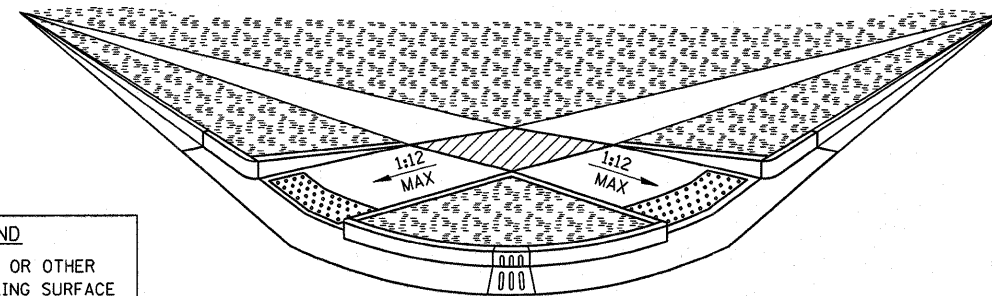

- LEGEND**
- PLANTING OR OTHER NON-WALKING SURFACE
  - SLOPE = 2% MAX.
  - DETECTABLE WARNING

**ADA SIDEWALK ACCESSIBILITY RAMPS  
METHOD 1 PERSPECTIVE WITH SIDE CURBS**

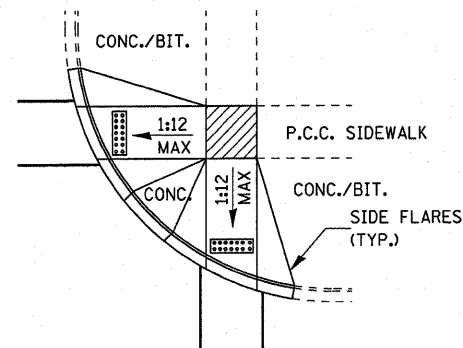

- LEGEND**
- PLANTING OR OTHER NON-WALKING SURFACE
  - SLOPE = 2% MAX.
  - DETECTABLE WARNING

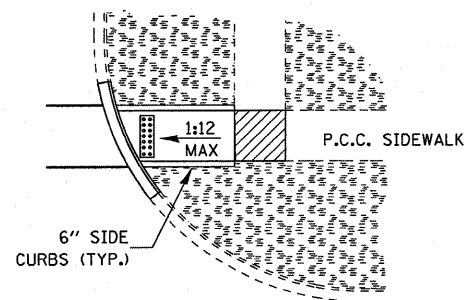
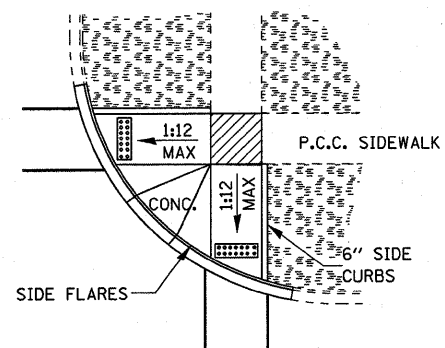

**TYPICAL CURB APPLICATIONS FOR METHOD 1**

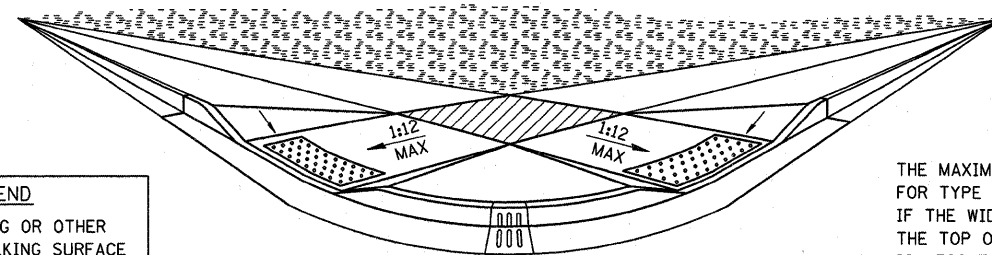

- LEGEND**
- PLANTING OR OTHER NON-WALKING SURFACE
  - SLOPE = 2% MAX.
  - DETECTABLE WARNING

THE MAXIMUM SLOPE OF THE SIDE FLARE FOR TYPE B RAMPS SHALL BE 1:10; HOWEVER, IF THE WIDTH OF THE LANDING AREA BETWEEN THE TOP OF THE RAMP AND AN OBSTRUCTION IS LESS THAN 4'-0" THEN THE MAXIMUM SLOPE SHALL BE 1:12.

**ADA SIDEWALK ACCESSIBILITY RAMPS  
METHOD 1 PERSPECTIVE WITH SIDE FLARES**

FILE NAME =	USER NAME = monellysr	DESIGNED -	REVISED -	<b>STATE OF ILLINOIS DEPARTMENT OF TRANSPORTATION</b>	<b>DETAILS</b>	F.A. RTE.	SECTION	COUNTY	TOTAL SHEETS	SHEET NO.	
os:\pw\work\pwidot\monellysr\d8125088\d36917-sht-details.DGN	PLOT SCALE = 50.0000' / in.	DRAWN -	REVISED -			698	(22)RS-5	BUREAU	18	15	
PLOT DATE = 4/19/2011	DATE -	CHECKED -	REVISED -			CONTRACT NO. 66917					
						ILLINOIS FED. AID PROJECT					
						SCALE:	SHEET NO. 1 OF 1 SHEETS		STA. 950+79 TO STA. 1000+00		



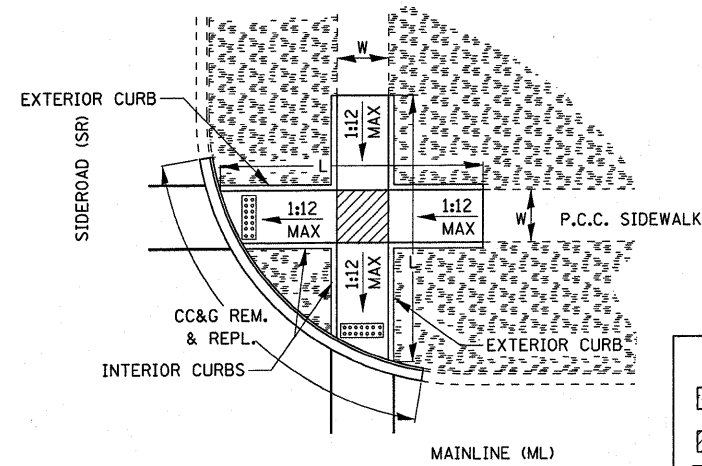

- LEGEND**
- PLANTING OR OTHER NON-WALKING SURFACE
  - SLOPE = 2% MAX.
  - DETECTABLE WARNING

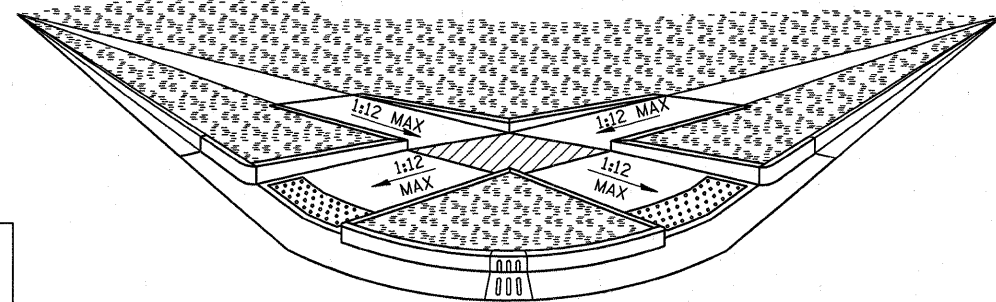

- LEGEND**
- PLANTING OR OTHER NON-WALKING SURFACE
  - SLOPE = 2% MAX.
  - DETECTABLE WARNING

**ADA SIDEWALK ACCESSIBILITY RAMPS  
METHOD 2**

**ADA SIDEWALK ACCESSIBILITY RAMPS  
METHOD 2 PERSPECTIVE WITH SIDE CURBS**

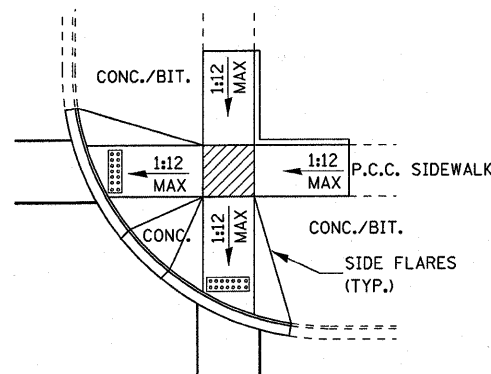

- LEGEND**
- PLANTING OR OTHER NON-WALKING SURFACE
  - SLOPE = 2% MAX.
  - DETECTABLE WARNING

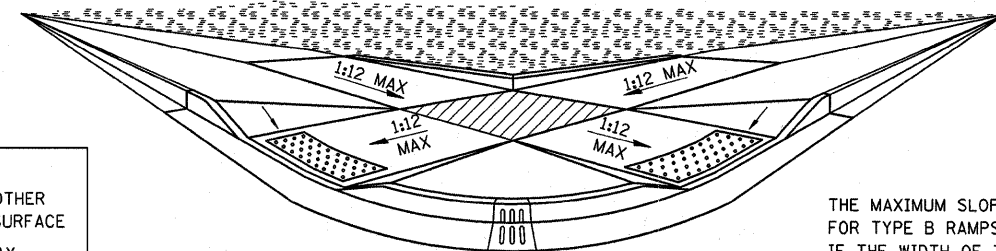

THE MAXIMUM SLOPE OF THE SIDE FLARE FOR TYPE B RAMPS SHALL BE 1:10; HOWEVER, IF THE WIDTH OF THE LANDING AREA BETWEEN THE TOP OF THE RAMP AND AN OBSTRUCTION IS LESS THAN 4'-0" THEN THE MAXIMUM SLOPE SHALL BE 1:12.

**ADA SIDEWALK ACCESSIBILITY RAMPS  
METHOD 2 PERSPECTIVE WITH SIDE FLARES**

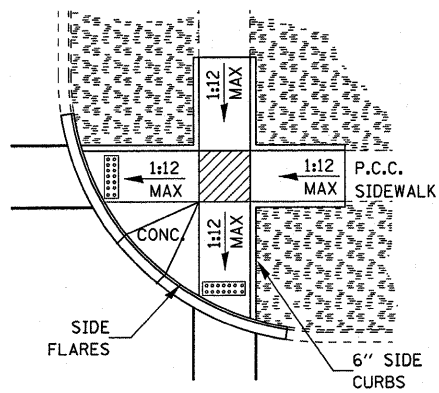

- LEGEND**
- PLANTING OR OTHER NON-WALKING SURFACE
  - SLOPE = 2% MAX.
  - DETECTABLE WARNING

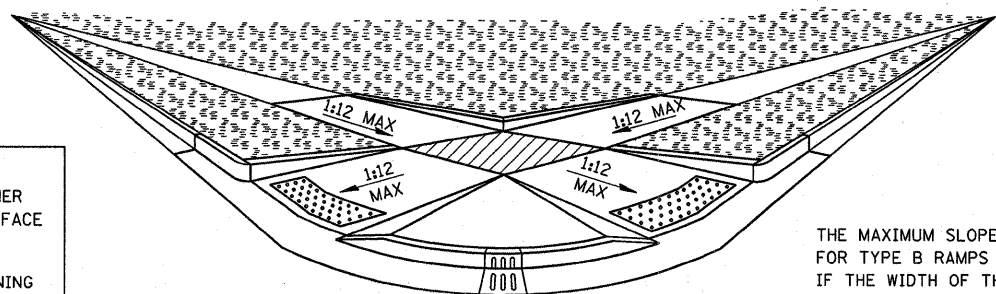

THE MAXIMUM SLOPE OF THE SIDE FLARE FOR TYPE B RAMPS SHALL BE 1:10; HOWEVER, IF THE WIDTH OF THE LANDING AREA BETWEEN THE TOP OF THE RAMP AND AN OBSTRUCTION IS LESS THAN 4'-0" THEN THE MAXIMUM SLOPE SHALL BE 1:12.

**ADA SIDEWALK ACCESSIBILITY RAMPS  
METHOD 2 PERSPECTIVE WITH SIDE CURBS AND SIDE FLARES**

**TYPICAL CURB APPLICATIONS FOR METHOD 2**

FILE NAME =	USER NAME = monallysr	DESIGNED -	REVISED -	<b>STATE OF ILLINOIS DEPARTMENT OF TRANSPORTATION</b>	<b>DETAILS</b>	F.A. RTE.	SECTION	COUNTY	TOTAL SHEETS	SHEET NO.	
cr:\pw_work\pwidot\monallysr\d0125088\d365917-sht-details.DGN	PLOT SCALE = 50.0000' / in.	DRAWN -	REVISED -			698	(22)RS-5	BUREAU	18	16	
PLOT DATE = 4/19/2011	DATE -	CHECKED -	REVISED -			CONTRACT NO. 66917					
						SCALE:	SHEET NO. 1 OF 1 SHEETS	STA. 950+79	TO STA. 1000+00	ILLINOIS FED. AID PROJECT	

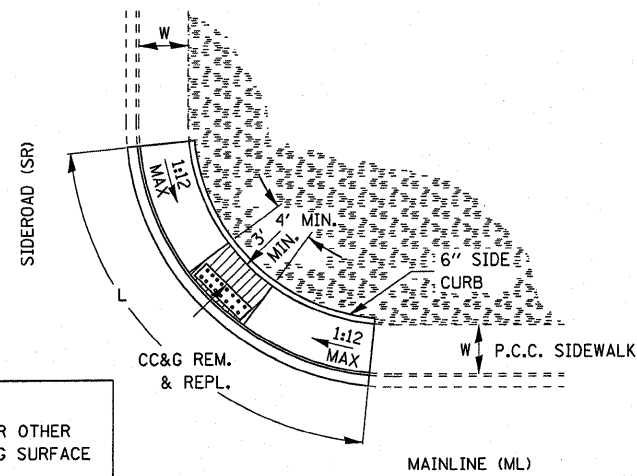

**LEGEND**

- PLANTING OR OTHER NON-WALKING SURFACE
- SLOPE = 2% MAX.
- DETECTABLE WARNING

**ADA SIDEWALK ACCESSIBILITY RAMPS  
METHOD 3**

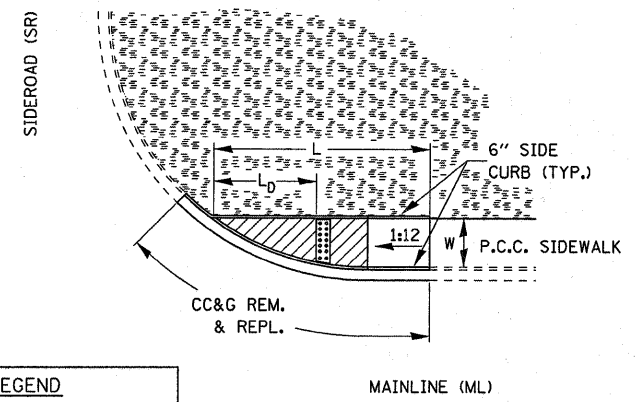

$L_D \leq 5'$

**LEGEND**

- PLANTING OR OTHER NON-WALKING SURFACE
- SLOPE = 2% MAX.
- DETECTABLE WARNING

**ADA SIDEWALK ACCESSIBILITY RAMPS  
METHOD 4**

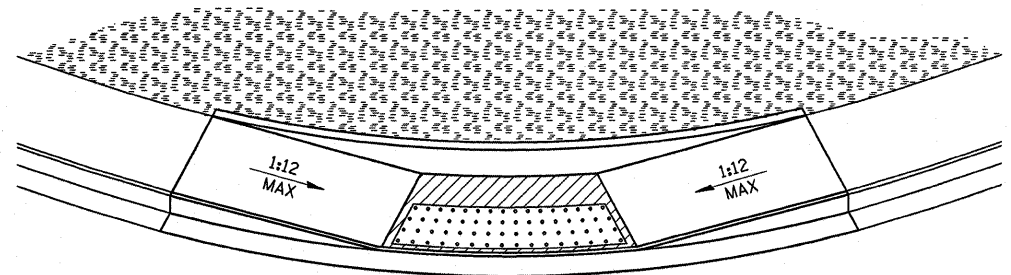

**LEGEND**

- PLANTING OR OTHER NON-WALKING SURFACE
- SLOPE = 2% MAX.
- DETECTABLE WARNING

**ADA SIDEWALK ACCESSIBILITY RAMPS  
METHOD 3 PERSPECTIVE**

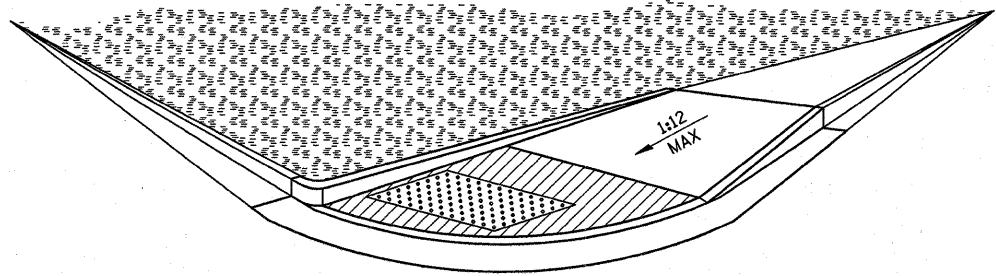

**LEGEND**

- PLANTING OR OTHER NON-WALKING SURFACE
- SLOPE = 2% MAX.
- DETECTABLE WARNING

**ADA SIDEWALK ACCESSIBILITY RAMPS  
METHOD 4 PERSPECTIVE**

FILE NAME =	USER NAME = monallyr	DESIGNED -	REVISED -	<b>STATE OF ILLINOIS DEPARTMENT OF TRANSPORTATION</b>	<b>DETAILS</b>				F.A. RTE.	SECTION	COUNTY	TOTAL SHEETS	SHEET NO.
or\pw_work\pwwdot\monallyr\d0125088\d36917-sht-details.DGN		DRAWN -	REVISED -		SCALE:	SHEET NO. 1 OF 1 SHEETS	STA. 950+79	TO STA. 1000+00	698	(22)RS-5	BUREAU	18	17
PLOT SCALE = 50.0000' / 1in.		CHECKED -	REVISED -		CONTRACT NO. 66917								
PLOT DATE = 4/19/2011		DATE -	REVISED -		ILLINOIS FED. AID PROJECT								

## TYPICAL PAVEMENT MARKING FOR FLUSH MEDIAN

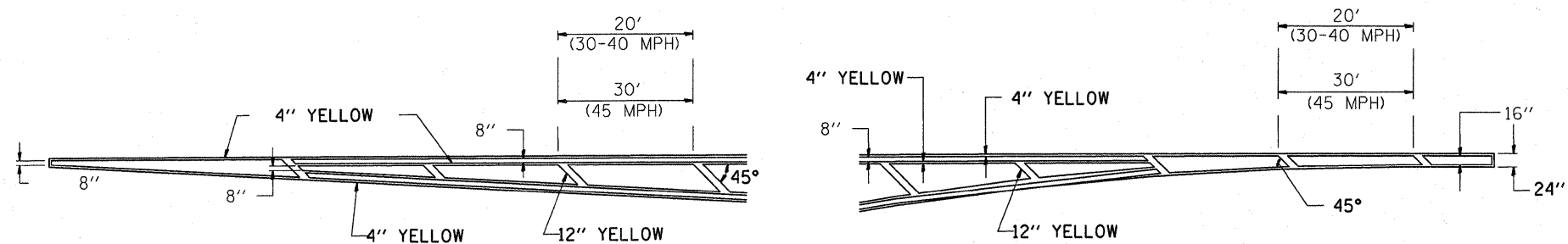

## TYPICAL MARKING FOR PAINTED ISLANDS

NOTE:  
\* 45° TO LOCAL TAN.

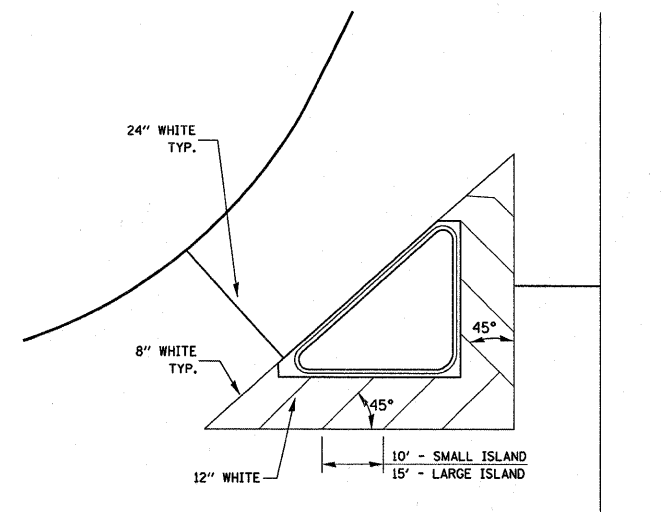
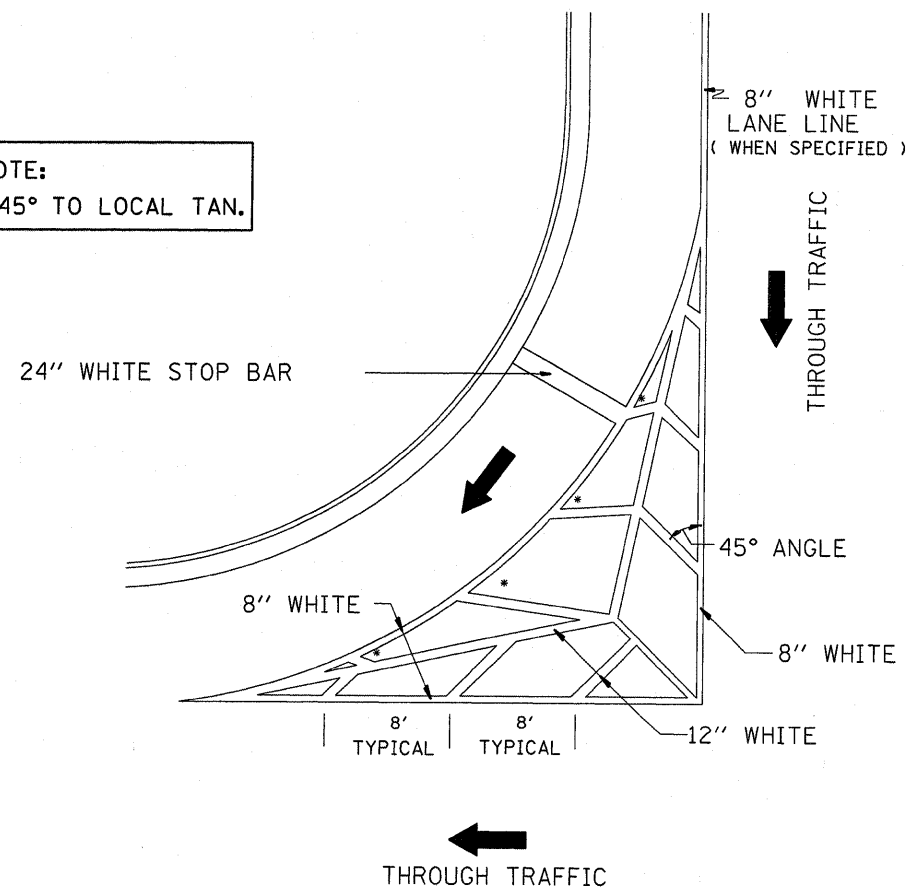

**TYPICAL ISLAND**  
**780-21**

FILE NAME =	USER NAME = monallyer	DESIGNED -	REVISED -	<b>STATE OF ILLINOIS</b>	<b>DETAILS</b>	F.A. RTE.	SECTION	COUNTY	TOTAL SHEETS	SHEET NO.
ci:\pw\work\p\dot\monallyer\d0125088\d36917-sht-details.DGN		DRAWN -	REVISED -	<b>DEPARTMENT OF TRANSPORTATION</b>		698	(22)RS-5	BUREAU	18	18
	PLOT SCALE = 50.0000' / in.	CHECKED -	REVISED -		SCALE:	SHEET NO. 1 OF 1 SHEETS		STA. 950+79	TO STA. 1000+00	
	PLOT DATE = 4/19/2011	DATE -	REVISED -		ILLINOIS FED. AID PROJECT					
						<b>CONTRACT NO. 66917</b>				