

STATE OF ILLINOIS
DEPARTMENT OF TRANSPORTATION
DIVISION OF HIGHWAYS

**PROPOSED
HIGHWAY PLANS**

FAI ROUTE 80 (I-80)
SECTION (50-2,3,4,5)I-2

INTERMITTANT CENTERLINE
MICRO-SURFACING (JOINT REPAIR)

LASALLE COUNTY

C-93-081-11

| F.A.I. RTE. | SECTION | COUNTY | TOTAL SHEETS | SHEET NO. |
|-------------|-----------------|----------|--------------------|-----------|
| 80 | (50-2,3,4,5)I-2 | LASALLE | 6 | 1 |
| | | ILLINOIS | CONTRACT NO. 66B17 | |

D-93-065-11

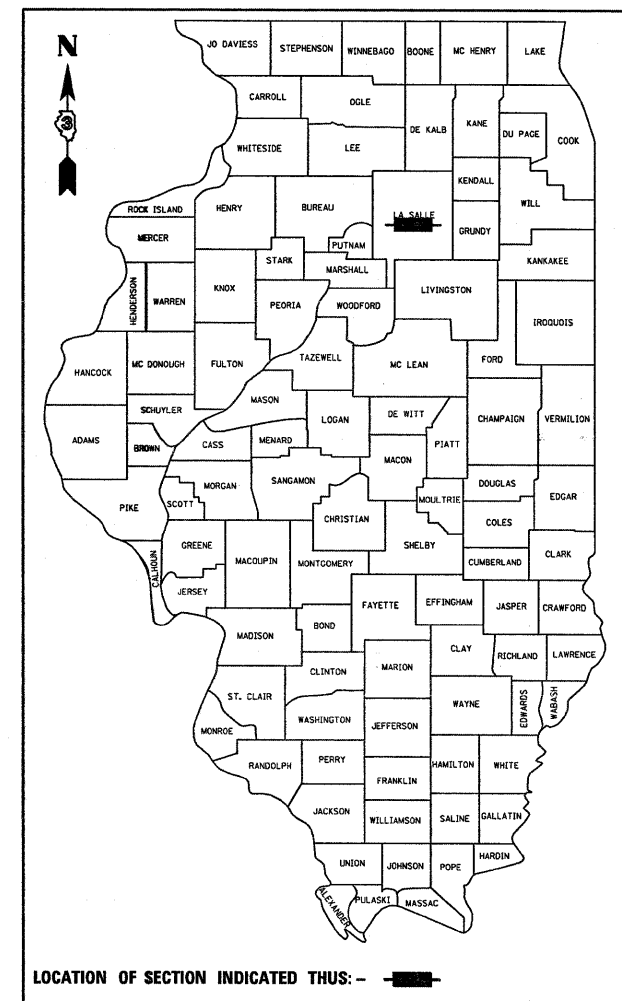

FUNCTIONAL CLASSIFICATION

INTERSTATE

2010 ADT = 29800

P.V. = 66.2% S.U. = 3.9% M.U. = 29.9%

STATE OF ILLINOIS
DEPARTMENT OF TRANSPORTATION
DIVISION OF HIGHWAYS

SUBMITTED MARCH 30 2011

Eric S. Therkelsen
DEPUTY DIRECTOR OF HIGHWAYS, REGION ENGINEER

May 13 2011
Scott E. Stitt, P.E.
acting ENGINEER OF DESIGN AND ENVIRONMENT

May 13 2011
Christine M. Reed
DIRECTOR OF HIGHWAYS, CHIEF ENGINEER

INDEX OF SHEETS

| | |
|-----|---|
| 1 | COVER SHEET |
| 2 | GENERAL NOTES AND SUMMARY OF QUANTITIES |
| 3 | TYPICAL SECTIONS |
| 4 | SCHEDULE OF QUANTITIES |
| 5-6 | DETAILS |

STANDARDS

| | |
|-----------|---|
| 000001-06 | STANDARD SYMBOLS, ABBREVIATIONS AND PATTERNS |
| 001006 | DECIMAL OF AN INCH AND OF A FOOT |
| 701101-02 | OFF-ROAD OPERATIONS MULTILANE, 15' (4.5 m) TO 24" (600 mm) FROM PAVEMENT EDGE |
| 701106-02 | OFF-ROAD OPERATIONS, MULTILANE, MORE THAN 15' (4.5 m) AWAY |
| 701401-06 | LANE CLOSURE, FREEWAY/EXPRESSWAY |
| 701426-04 | LANE CLOSURE, MULTILANE INTERMITTENT OR MOVING OPERATION, FOR SPEEDS ≥ 45 MPH |
| 701901-01 | TRAFFIC CONTROL DEVICES |
| 780001-02 | TYPICAL PAVEMENT MARKINGS |

PROJECT BEGINS
M.P. 74.25

PROJECT ENDS
M.P. 96.4

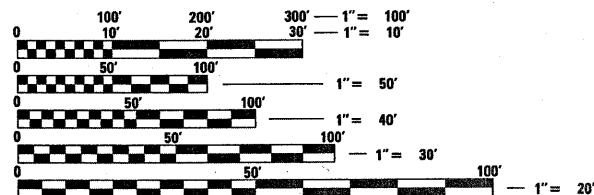

FULL SIZE PLANS HAVE BEEN PREPARED USING STANDARD ENGINEERING SCALES. REDUCED SIZED PLANS WILL NOT CONFORM TO STANDARD SCALES. IN MAKING MEASUREMENTS ON REDUCED PLANS, THE ABOVE SCALES MAY BE USED.

J.U.L.I.E.
JOINT UTILITY LOCATION INFORMATION FOR EXCAVATION
1-800-892-0123
OR 811

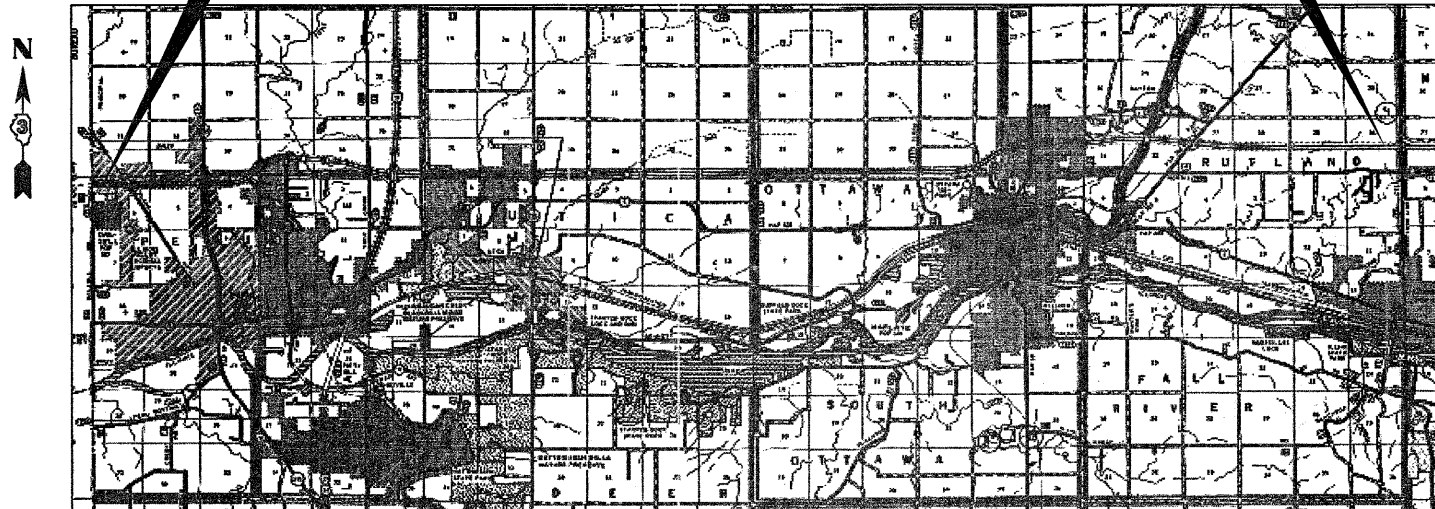

GROSS LENGTH = NET LENGTH = 116,952 FT. = 22.15 MILE

PROJECT ENGINEER: JOE KANNEL
SQUAD LEADER: NATHAN SELL

CONTRACT NO. 66B17

PRINTED BY THE AUTHORITY
OF THE STATE OF ILLINOIS