

PLAN SURVEYED BY DATE
 PLOTTED BY
 CHECKED BY
 NO. OF WAY CHECKED
 CADD FILE NAME

PROFILE SURVEYED BY DATE
 PLOTTED BY
 CHECKED BY
 NO. OF WAY CHECKED
 STRUCTURE NOTATIONS CHKD

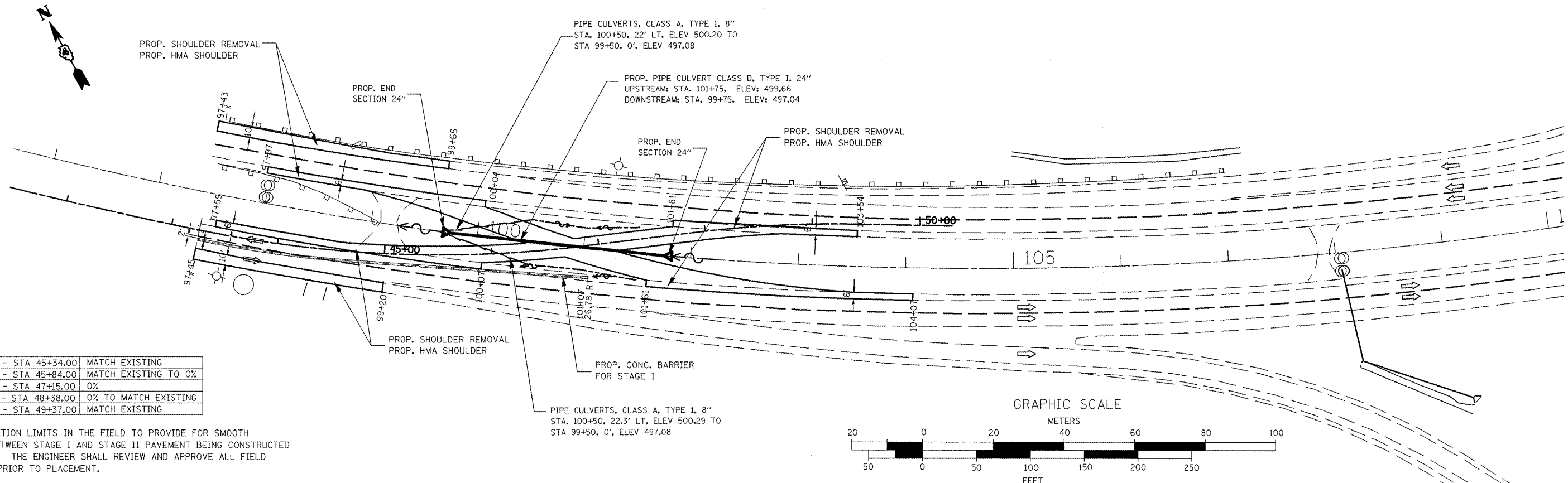

STA 43+40.00 - STA 45+34.00	MATCH EXISTING
STA 45+34.00 - STA 45+84.00	MATCH EXISTING TO 0%
STA 45+84.00 - STA 47+15.00	0%
STA 47+15.00 - STA 48+38.00	0% TO MATCH EXISTING
STA 48+38.00 - STA 49+37.00	MATCH EXISTING

ADJUST TRANSITION LIMITS IN THE FIELD TO PROVIDE FOR SMOOTH TRANSITION BETWEEN STAGE I AND STAGE II PAVEMENT BEING CONSTRUCTED CONCURRENTLY. THE ENGINEER SHALL REVIEW AND APPROVE ALL FIELD ADJUSTMENTS PRIOR TO PLACEMENT.

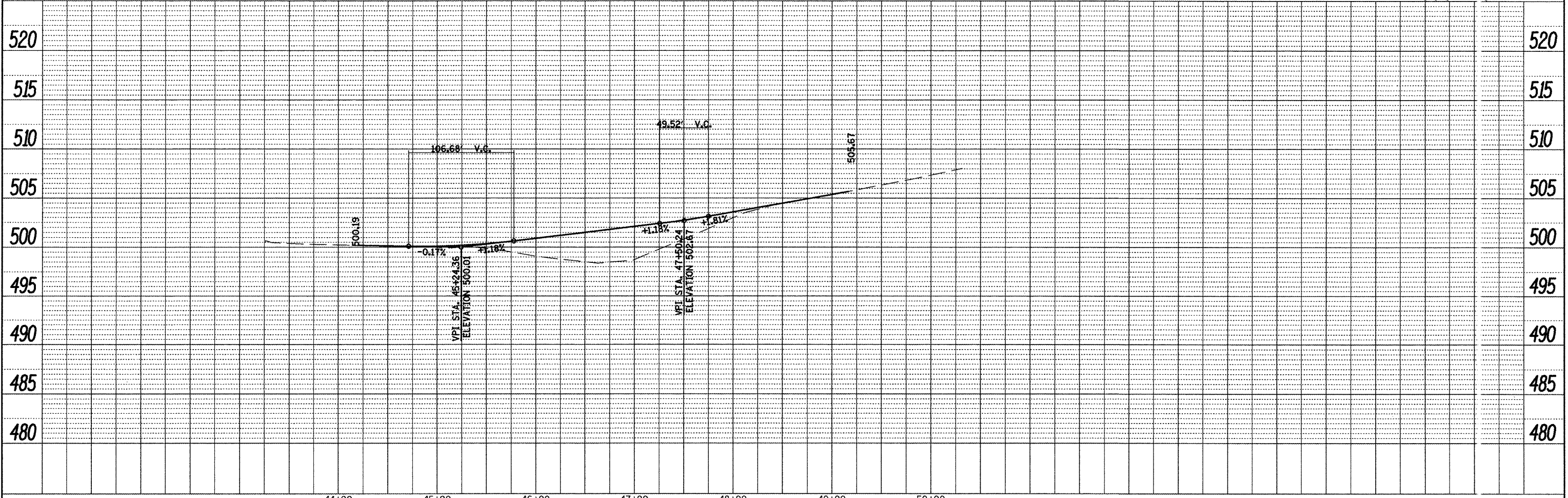

FILE NAME = Stage I sheets East & West.dgn

USER NAME = labobidism
 DESIGNED -
 DRAWN -
 CHECKED -
 DATE -

REVISED -
 REVISED -
 REVISED -
 REVISED -

STATE OF ILLINOIS
 DEPARTMENT OF TRANSPORTATION

MAINTENANCE OF TRAFFIC PLAN AND PROFILE STAGE I EAST
 SCALE: SHEET NO. OF SHEETS STA. TO STA.

F.A.T. RTE. 474	SECTION (72, 9015B)I-2	COUNTY PEO-AZ	TOTAL SHEETS 129	SHEET NO. 20
CONTRACT NO. 68069			ILLINOIS FED. AID PROJECT	