

**BILL OF MATERIAL**

Item	Unit	Quantity
Hot-Mix Asphalt Wearing Surface Removal, Deck	Sq. Yc	894
Bridge Deck Scarification, 3/4"	Sq. Yc	894
Bridge Deck Latex Concrete Overlay, 2 1/4"	Sq. Yc	874
Plug Existing Deck Drains	Each	36
Floor Drains	Each	34
*Deck Slab Repair (Full Depth Type I)	Sq. Yc	9.1

\* At Floor Drain Replacement Locations

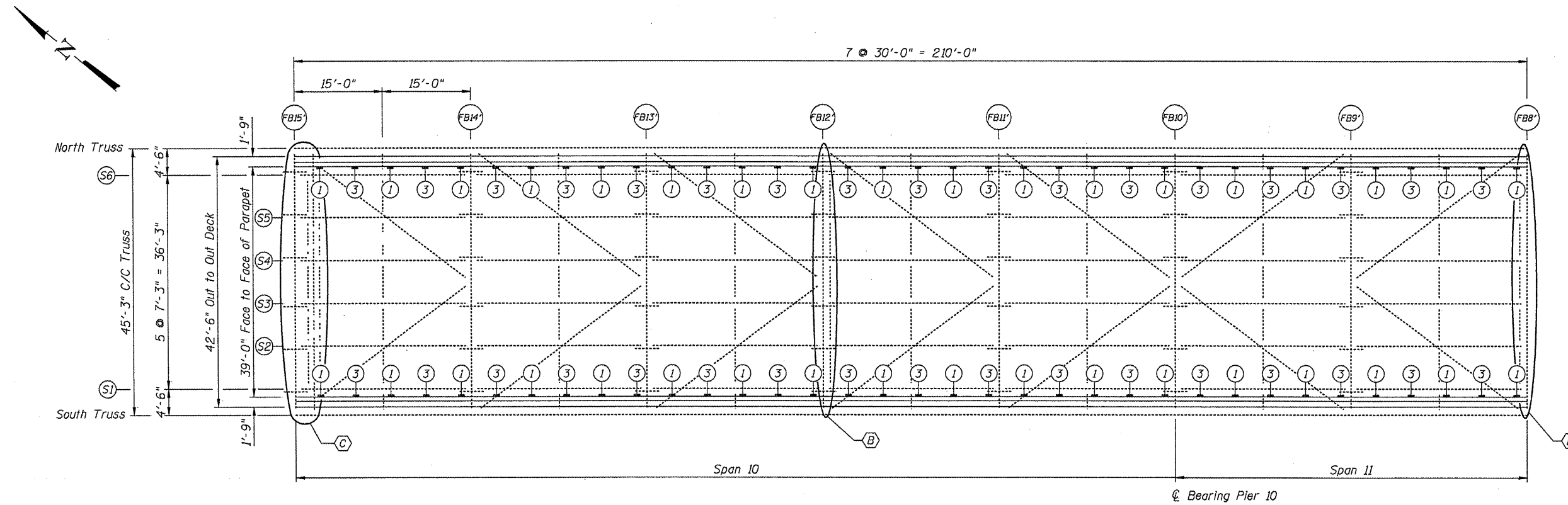

**PARTIAL FRAMING PLAN SPANS 10 & 11**

Westbound Lanes

**LEGEND**

- ① Plug Existing Floor Drains
- ③ Remove Existing Floor Drain and Install new 6"φ Drain
- ⓑ Replace Existing Relief Joints with Preformed Joint Strip Seal.
- ⓒ Replace Existing Finger Joints with Preformed Joint Strip Seal.

FILE NAME =	USER NAME = *USER*	DESIGNED - JAN	REVISED -	<b>STATE OF ILLINOIS DEPARTMENT OF TRANSPORTATION</b>	<b>GENERAL PLAN &amp; REPAIR LOCATION WESTBOUND SPANS 10 &amp; 11 FB15 TO FB8 S.N. 090-0109</b>	F.A.I. RTE.	SECTION	COUNTY	TOTAL SHEETS	SHEET NO.
#FILEL#	PLOT SCALE = *SCALE*	CHECKED - BTO	REVISED -			474		PEORIA & TAZEWELL	129	44
	PLOT DATE = *DATE*	DRAWN - MJK	REVISED -			CONTRACT NO. 68069		ILLINOIS FED. AID PROJ. #		
		CHECKED - JAN	REVISED -			SHEET NO. 10 OF 65 SHEETS				