

BILL OF MATERIAL

Item	Unit	Quantity
Hot-Mix Asphalt Wearing Surface Removal, Deck	Sq. Yd	1,044
Bridge Deck Scarification, 3/4"	Sq. Yd	1,044
Bridge Deck Latex Concrete Overlay, 2 1/4"	Sq. Yd	1,008
Plug Existing Deck Drains	Each	40
Floor Drains	Each	40
*Deck Slab Repair (Full Depth Type I)	Sq. Yd	10.7

* At Floor Drain Replacement Locations

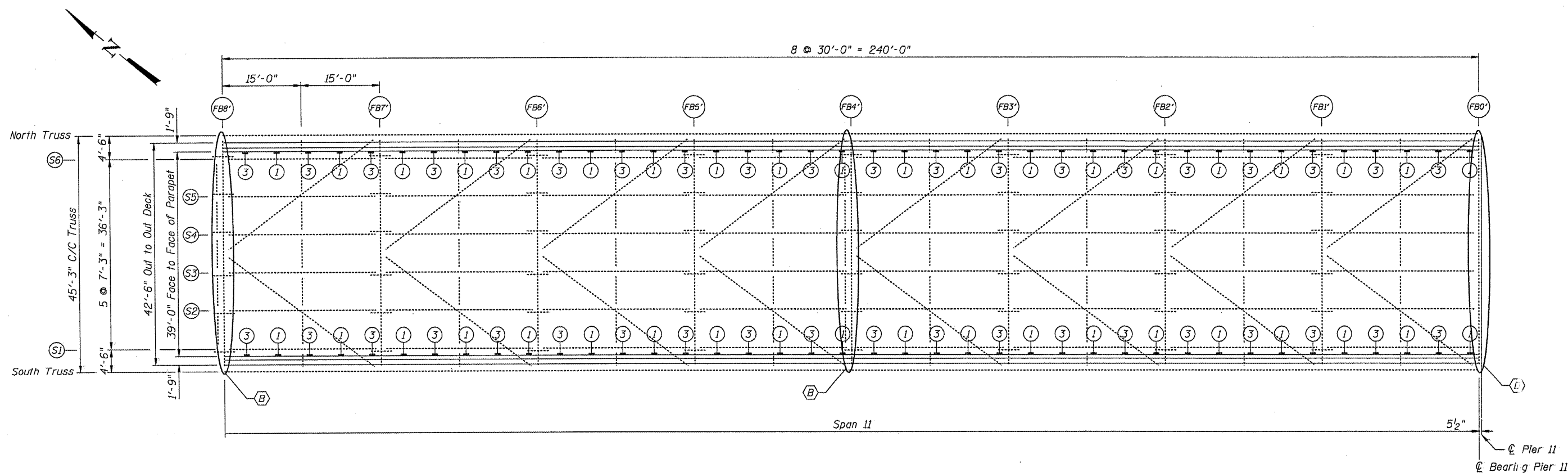

PARTIAL FRAMING PLAN SPAN II
Eastbound Lanes

LEGEND

- ① Plug Existing Floor Drains
- ③ Remove Existing Floor Drain and Install new 6" Drain
- ⓑ Replace Existing Relief Joints with Preformed Joint Strip Seal.
- ⓓ Expansion Joint Trough Installation

FILE NAME -	USER NAME - *USER*	DESIGNED - JAN	REVISED -	STATE OF ILLINOIS DEPARTMENT OF TRANSPORTATION	GENERAL PLAN & REPAIR LOCATION EASTBOUND SPAN 11 FB8 TO FB0 S.N. 090-0108	F.A.I. RTE.	SECTION	COUNTY	TOTAL SHEETS	SHEET NO.	
FILE#	PLOT SCALE = *SCALE*	CHECKED - BTO	REVISED -			474		PEORIA & TAZEWELL	129	52	
	PLOT DATE = *DATE*	DRAWN - MJK	REVISED -			CONTRACT NO. 68069					
		CHECKED - JAN	REVISED -			ILLINOIS FED. AID PROJECT					