

PLAN	SURVEYED	BY	DATE
	ALIGNED		
	GRADES CHECKED		
	RT. OF WAY CHECKED		
	NO. _____		
	FILE NAME		

PROFILE	SURVEYED	BY	DATE
	GRADES CHECKED		
	RT. OF WAY CHECKED		
	NO. _____		
	STRUCTURE NOTATION CRNO		

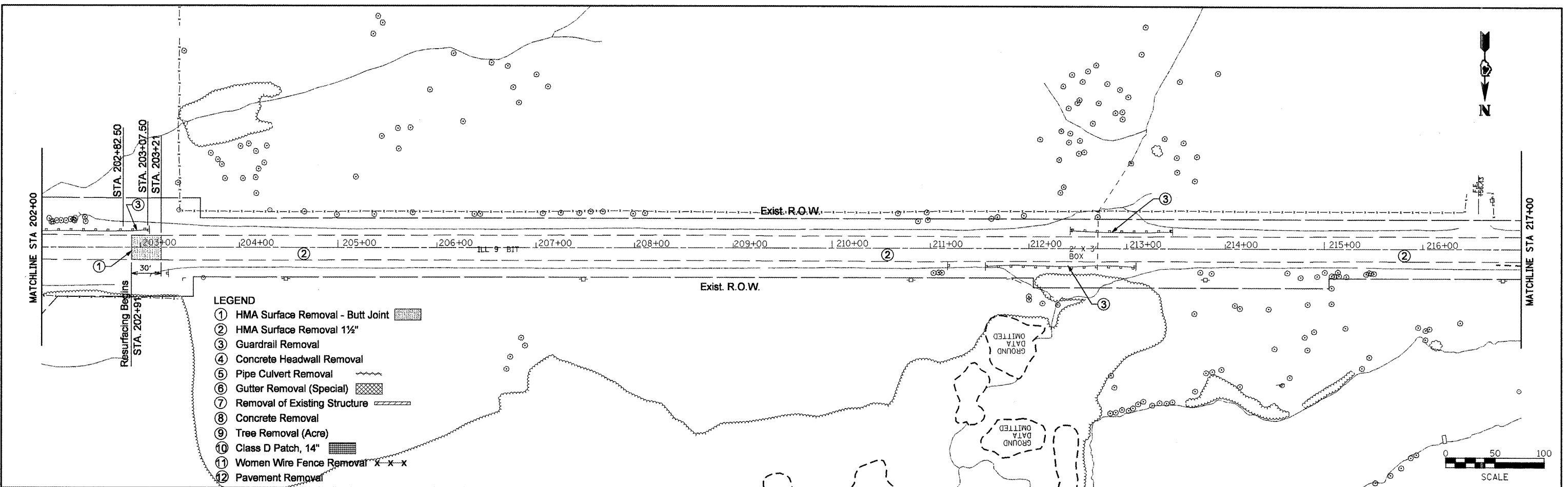

- LEGEND**
- ① HMA Surface Removal - Butt Joint
 - ② HMA Surface Removal 1½"
 - ③ Guardrail Removal
 - ④ Concrete Headwall Removal
 - ⑤ Pipe Culvert Removal
 - ⑥ Gutter Removal (Special)
 - ⑦ Removal of Existing Structure
 - ⑧ Concrete Removal
 - ⑨ Tree Removal (Acre)
 - ⑩ Class D Patch, 14"
 - ⑪ Women Wire Fence Removal X-X-X
 - ⑫ Pavement Removal

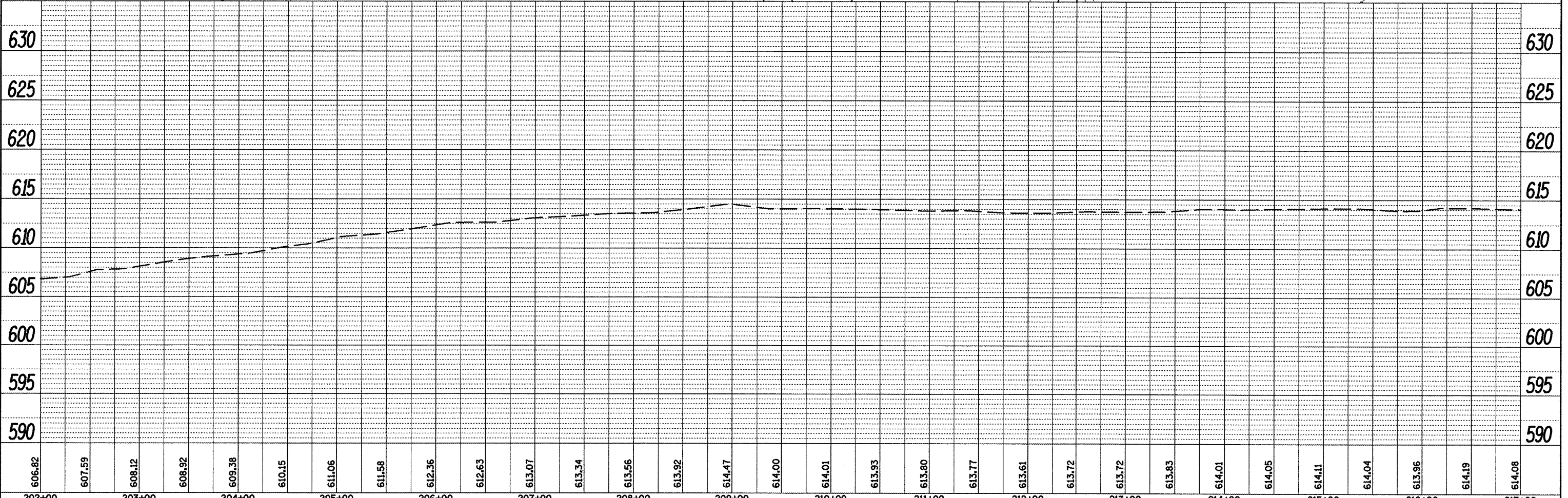

FILE NAME = Removal Plans2.dgn	USER NAME = mendezp	DESIGNED -	REVISED -	STATE OF ILLINOIS DEPARTMENT OF TRANSPORTATION	EXISTING & REMOVAL PLANS		F.A.P. RTE. 685	SECTION **	COUNTY *	TOTAL SHEETS 329	SHEET NO. 38	
		DRAWN -	REVISED -		SCALE: _____	SHEET NO. _____	OF _____	SHEETS _____	STA. _____	TO STA. _____	CONTRACT NO. 68599	
		CHECKED -	REVISED -		ILLINOIS FED. AID PROJECT							
		DATE -	REVISED -		** (37,38)RS-3,39RS-5(38) • Fulton, McDonough							