

PLAN  
 SURVEYED BY: \_\_\_\_\_ DATE: \_\_\_\_\_  
 PLOTTED BY: \_\_\_\_\_ DATE: \_\_\_\_\_  
 NOTE BOOK NO. \_\_\_\_\_  
 CHECKED BY: \_\_\_\_\_  
 CAD FILE NAME: \_\_\_\_\_

PROFILE  
 SURVEYED BY: \_\_\_\_\_ DATE: \_\_\_\_\_  
 PLOTTED BY: \_\_\_\_\_ DATE: \_\_\_\_\_  
 NOTE BOOK NO. \_\_\_\_\_  
 CHECKED BY: \_\_\_\_\_  
 STRUCTURE ANTENNA CHKD: \_\_\_\_\_

- LEGEND**
- ① HMA Surface Removal - Butt Joint
  - ② HMA Surface Removal 1 1/2"
  - ③ Guardrail Removal
  - ④ Concrete Headwall Removal
  - ⑤ Pipe Culvert Removal
  - ⑥ Gutter Removal (Special)
  - ⑦ Removal of Existing Structure
  - ⑧ Concrete Removal
  - ⑨ Tree Removal (Acre)
  - ⑩ Class D Patch, 14"
  - ⑪ Women Wire Fence Removal x-x-x
  - ⑫ Pavement Removal

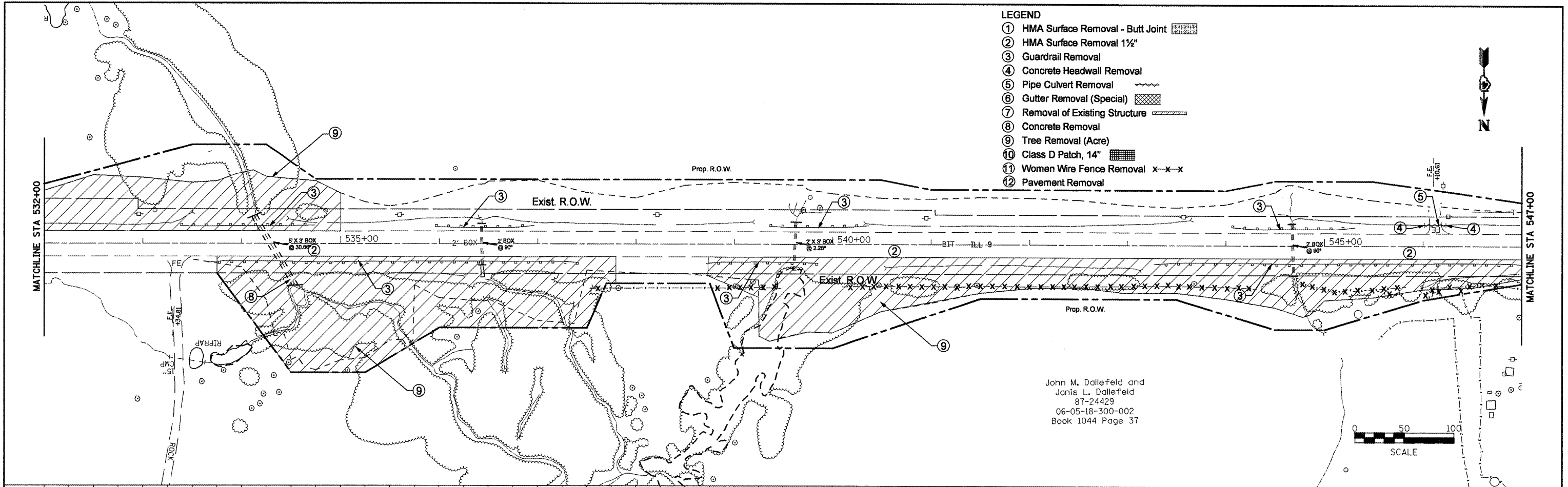

John M. Dallefeld and  
 Janis L. Dallefeld  
 87-24429  
 06-05-18-300-002  
 Book 1044 Page 37

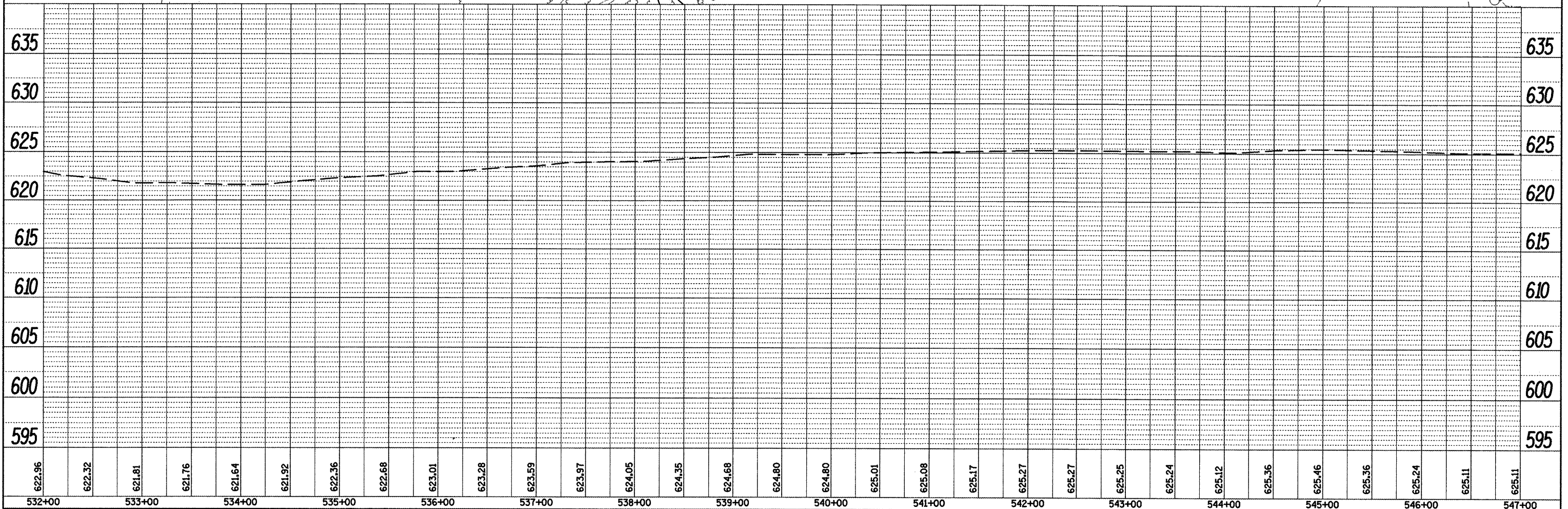

FILE NAME = Removal Plans2.dgn	USER NAME = mendeppj	DESIGNED -	REVISED -	<b>STATE OF ILLINOIS DEPARTMENT OF TRANSPORTATION</b>	<b>EXISTING &amp; REMOVAL PLANS</b>				F.A.P. RTE. 685	SECTION **	COUNTY *	TOTAL SHEETS 329	SHEET NO. 61
		DRAWN -	REVISED -										
		CHECKED -	REVISED -										
		DATE -	REVISED -										
PLOT SCALE = 100.0000' / IN.		DATE = 3/25/2011		SCALE:		SHEET NO. OF SHEETS		STA. TO STA.		CONTRACT NO. 68599			