

PLAN	SURVEYED	BY	DATE
	PLOTTED		
	CHECKED		
	DATE		
	NO.		
	FILE NAME		

PROFILE	SURVEYED	BY	DATE
	PLOTTED		
	CHECKED		
	DATE		
	NO.		
	FILE NAME		

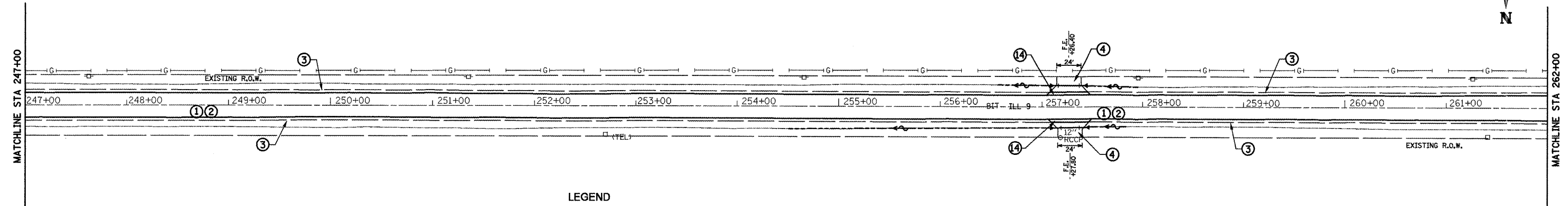

- LEGEND**
- ① H.M.A. Surface Course Mix D, N 50, 1 1/2"
 - ② Poly. Leveling Binder (MM), 3/4"
 - ③ Aggregate Shoulders, Type B
 - ④ Aggregate Surface Course, Type B
 - ⑤ H.M.A. Shoulders, 8"
 - ⑥ Concrete Gutter, Type A (Special)
 - ⑦ Concrete Gutter Type B
 - ⑧ Class SI Concrete (Outlet)
 - ⑨ Proposed Widening
 - ⑩ Guardrail Aggregate Erosion Control
 - ⑪ SPBGR, Type A, 6 ft. Post
 - ⑫ Traffic Barrier Terminal Type 1, Special (Tangent)
 - ⑬ Proposed Retaining Wall
 - ⑭ Incidental HMA Surface

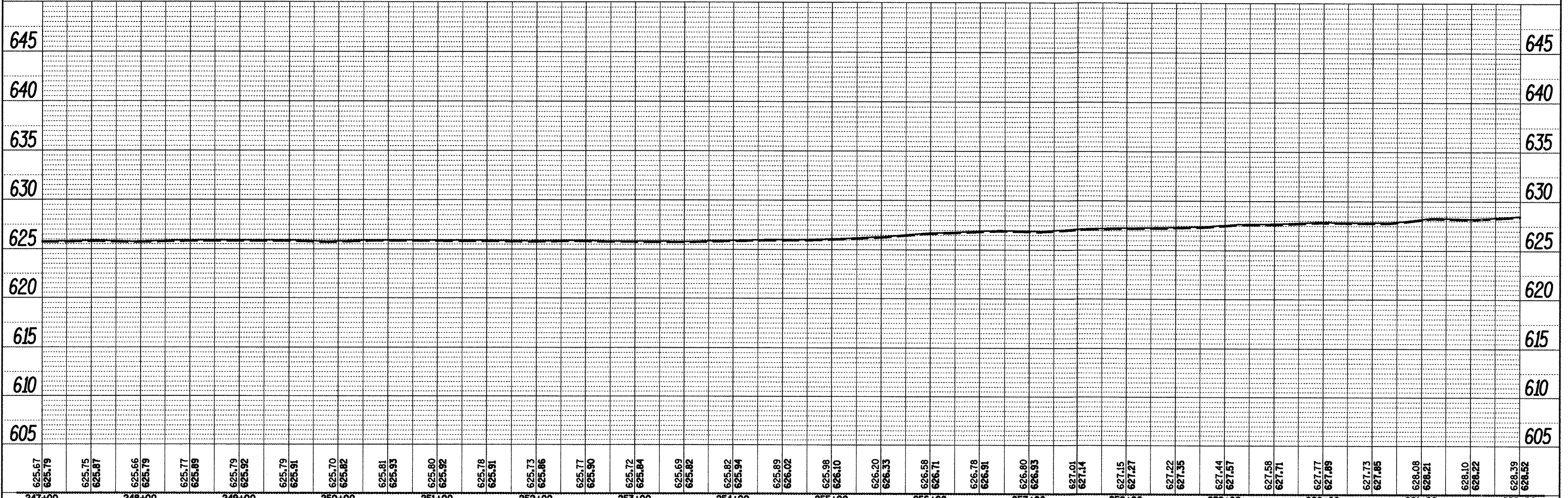
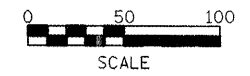

FILE NAME = Plan Sheets2.dgn	USER NAME = mandezp	DESIGNED -	REVISED -	STATE OF ILLINOIS DEPARTMENT OF TRANSPORTATION	DESIGN PLAN AND PROFILE			F.A.P. RTE. = 685	SECTION = **	COUNTY = *	TOTAL SHEETS = 329	SHEET NO. = 70
		DRAWN -	REVISED -		SCALE: _____	SHEET NO. _____	OF _____	SHEETS _____	STA. _____	TO STA. _____	CONTRACT NO. 68599	
		CHECKED -	REVISED -		ILLINOIS FED. AID PROJECT							
		DATE = 3/25/2011	REVISED -		(37,38)RS-3,39RS-5(38)1 Fuiton, McDonough							