

DATE: \_\_\_\_\_ BY: \_\_\_\_\_  
 SURVEYED: \_\_\_\_\_  
 PLOTTED: \_\_\_\_\_  
 CHECKED: \_\_\_\_\_  
 NOTE BOOK NO. \_\_\_\_\_  
 ROAD FILE NAME: \_\_\_\_\_

DATE: \_\_\_\_\_ BY: \_\_\_\_\_  
 SURVEYED: \_\_\_\_\_  
 PLOTTED: \_\_\_\_\_  
 CHECKED: \_\_\_\_\_  
 NOTE BOOK NO. \_\_\_\_\_  
 STRUCTURE NOTATION: \_\_\_\_\_

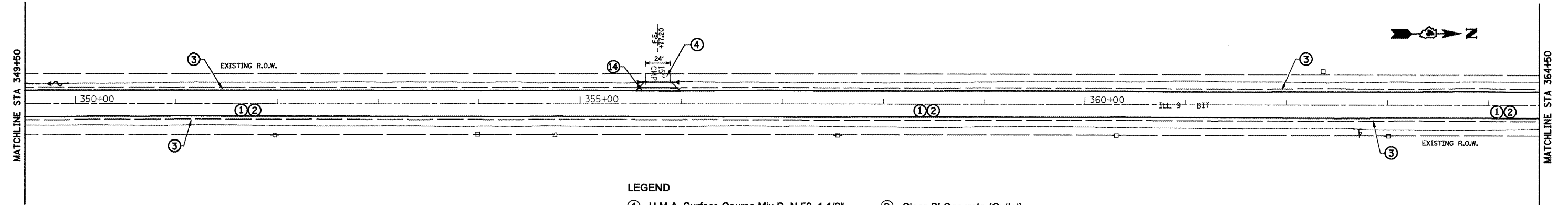

- LEGEND**
- ① H.M.A. Surface Course Mix D, N 50, 1 1/2"
  - ② Poly. Leveling Binder (MM), 3/4"
  - ③ Aggregate Shoulders, Type B
  - ④ Aggregate Surface Course, Type B
  - ⑤ H.M.A. Shoulders, 8"
  - ⑥ Concrete Gutter, Type A (Special)
  - ⑦ Concrete Gutter Type B
  - ⑧ Class SI Concrete (Outlet)
  - ⑨ Proposed Widening
  - ⑩ Guardrail Aggregate Erosion Control
  - ⑪ SPBGR, Type A, 6 ft. Post
  - ⑫ Traffic Barrier Terminal Type 1, Special (Tangent)
  - ⑬ Proposed Retaining Wall
  - ⑭ Incidental HMA Surface

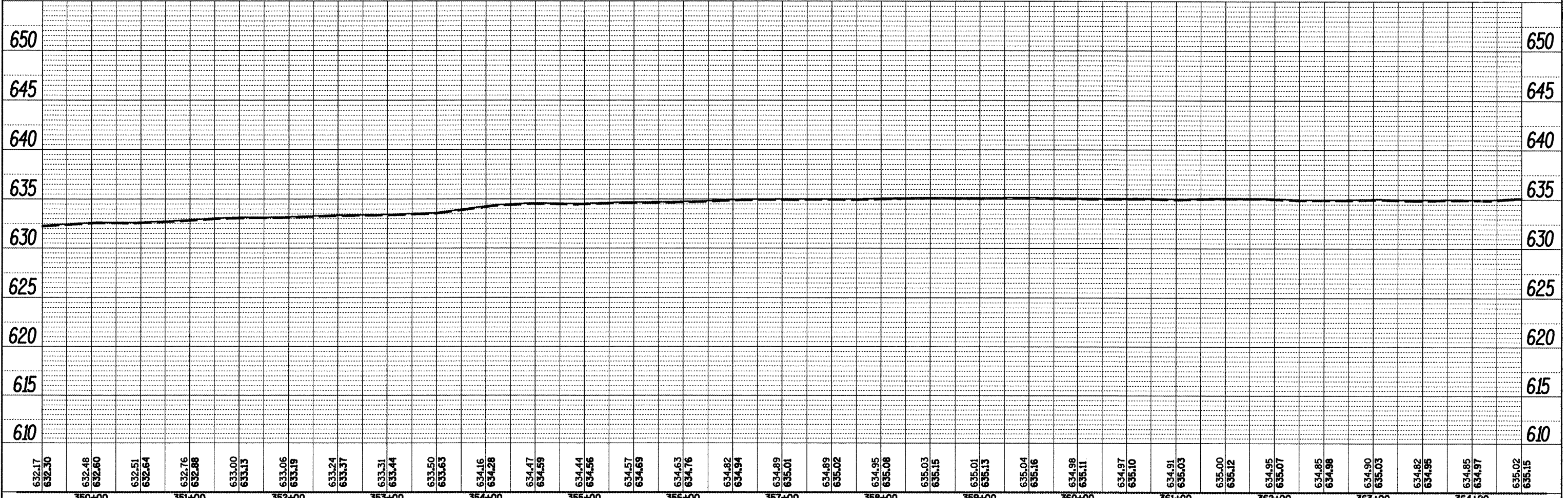
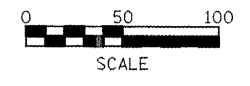

FILE NAME = Plan Sheets2.dgn	USER NAME = mendezp.j	DESIGNED -	REVISED -	<b>STATE OF ILLINOIS DEPARTMENT OF TRANSPORTATION</b>	<b>DESIGN PLAN AND PROFILE</b>			F.A.P. RTE. 685	SECTION ..	COUNTY ..	TOTAL SHEETS 329	SHEET NO. 77
		DRAWN -	REVISED -		SCALE:	SHEET NO.	OF	SHEETS	STA.	TO STA.	CONTRACT NO. 68599	
		CHECKED -	REVISED -		ILLINOIS FED. AID PROJECT							
		DATE -	REVISED -		(37,38)RS-3,39RS-5(38)I							