

PLAN	SURVEYED	BY	DATE
	PLotted		
	Checked		
	By		
	Checked		
	By		
	Checked		
	By		

PROFILE	SURVEYED	BY	DATE
	Plotted		
	Checked		
	By		
	Checked		
	By		
	Checked		
	By		

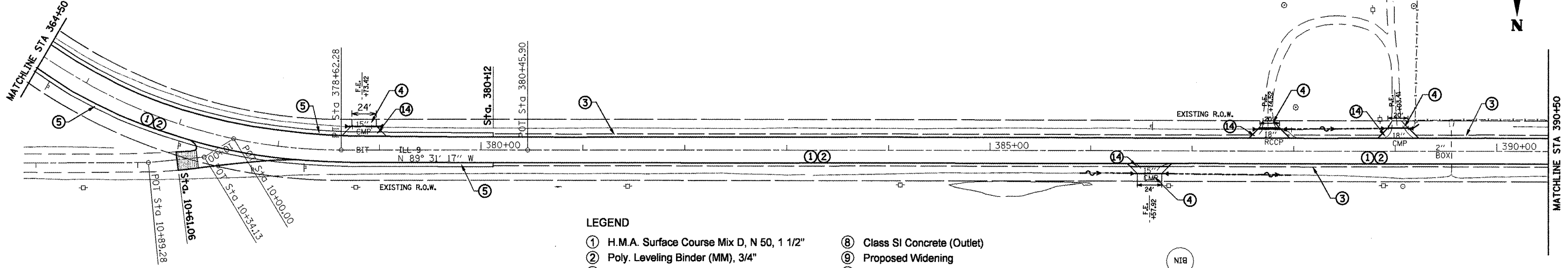

- LEGEND**
- ① H.M.A. Surface Course Mix D, N 50, 1 1/2"
 - ② Poly. Leveling Binder (MM), 3/4"
 - ③ Aggregate Shoulders, Type B
 - ④ Aggregate Surface Course, Type B
 - ⑤ H.M.A. Shoulders, 8"
 - ⑥ Concrete Gutter, Type A (Special)
 - ⑦ Concrete Gutter Type B
 - ⑧ Class SI Concrete (Outlet)
 - ⑨ Proposed Widening
 - ⑩ Guardrail Aggregate Erosion Control
 - ⑪ SPBGR, Type A, 6 ft. Post
 - ⑫ Traffic Barrier Terminal Type 1, Special (Tangent)
 - ⑬ Proposed Retaining Wall
 - ⑭ Incidental HMA Surface

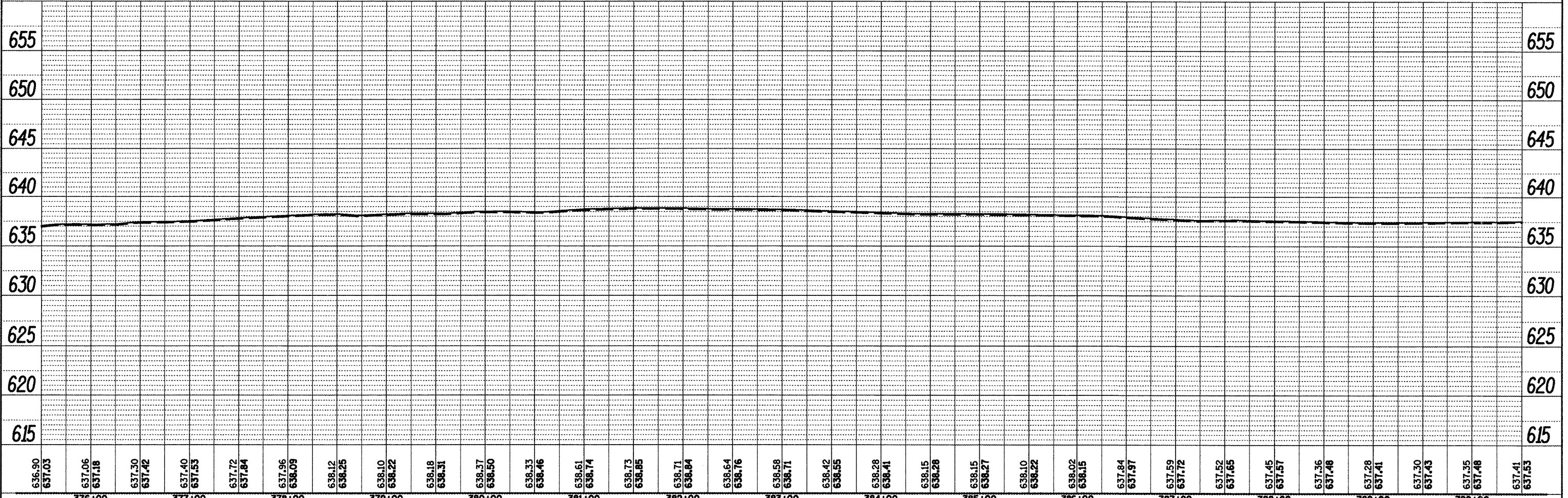

FILE NAME = Plan Sheets2.dgn	USER NAME = mendzpj	DESIGNED -	REVISED -	STATE OF ILLINOIS DEPARTMENT OF TRANSPORTATION	DESIGN PLAN AND PROFILE		F.A.P. RTE. 685	SECTION ..	COUNTY ..	TOTAL SHEETS 329	SHEET NO. 79	
	PLLOT SCALE = 100.0000' / IN.	CHECKED -	REVISED -		SCALE:	SHEET NO.	OF	SHEETS	STA.	TO STA.	CONTRACT NO. 68599	
	PLLOT DATE = 3/25/2011	DATE -	REVISED -		ILLINOIS FED. AID PROJECT							
					** (37,38)RS-3,39RS-5(38) • Fuiton, McDonough							