

PLAN	SURVEYED	BY	DATE
	PLOTTED		
	CHECKED		
	REVISIONS		
	NO. _____		
	DATE _____		
	BY _____		
	DATE _____		

PROFILE	SURVEYED	BY	DATE
	PLOTTED		
	CHECKED		
	REVISIONS		
	NO. _____		
	DATE _____		
	BY _____		
	DATE _____		

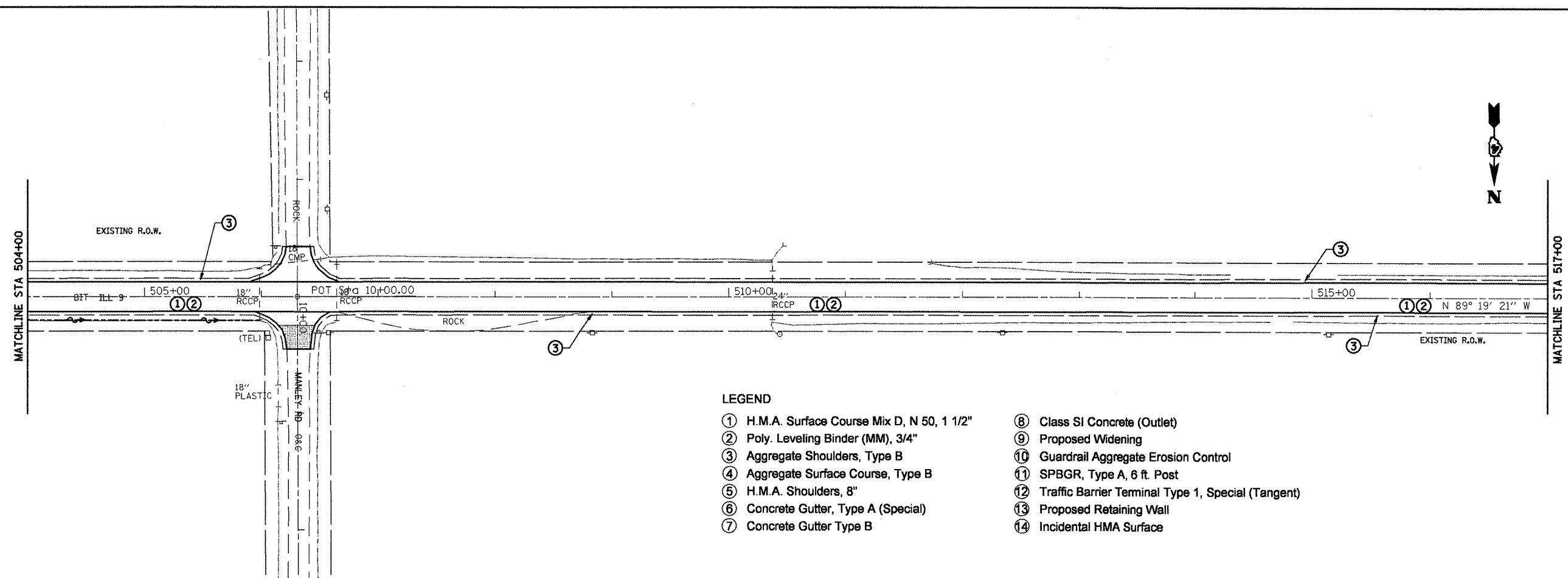

- LEGEND**
- ① H.M.A. Surface Course Mix D, N 50, 1 1/2"
 - ② Poly. Leveling Binder (MM), 3/4"
 - ③ Aggregate Shoulders, Type B
 - ④ Aggregate Surface Course, Type B
 - ⑤ H.M.A. Shoulders, 8"
 - ⑥ Concrete Gutter, Type A (Special)
 - ⑦ Concrete Gutter Type B
 - ⑧ Class SI Concrete (Outlet)
 - ⑨ Proposed Widening
 - ⑩ Guardrail Aggregate Erosion Control
 - ⑪ SPBGR, Type A, 6 ft. Post
 - ⑫ Traffic Barrier Terminal Type 1, Special (Tangent)
 - ⑬ Proposed Retaining Wall
 - ⑭ Incidental HMA Surface

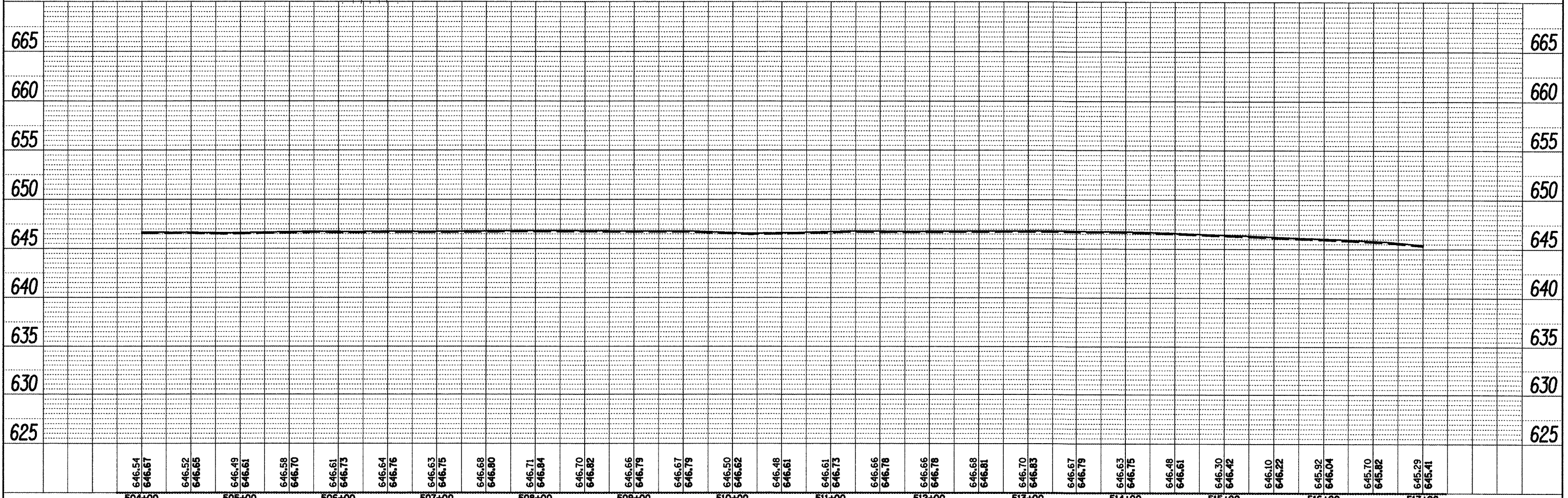

FILE NAME = Plan Sheets2.dgn	USER NAME = mendezpj	DESIGNED -	REVISED -	STATE OF ILLINOIS DEPARTMENT OF TRANSPORTATION	DESIGN PLAN AND PROFILE				F.A.P. RTE. 685	SECTION ..	COUNTY ..	TOTAL SHEETS 329	SHEET NO. 88
		DRAWN -	REVISED -		SCALE:	SHEET NO.	OF	SHEETS	STA.	TO STA.	CONTRACT NO. 68599		
		CHECKED -	REVISED -		ILLINOIS FED. AID PROJECT								
		PLDT SCALE = 100.0000' / IN.	REVISED -		** (37,38)RS-3,39RS-5;(38)I								
		PLDT DATE = 3/25/2011	DATE -		Fulton, McDonough								