

DATE	
BY	
PLAN	
SURVEYED	CHECKED
ALIGNED	CHECKED
BY	DATE
NO.	
NO.	

DATE	
BY	
PROFILE	
SURVEYED	CHECKED
GRADES	CHECKED
BY	DATE
NO.	
NO.	

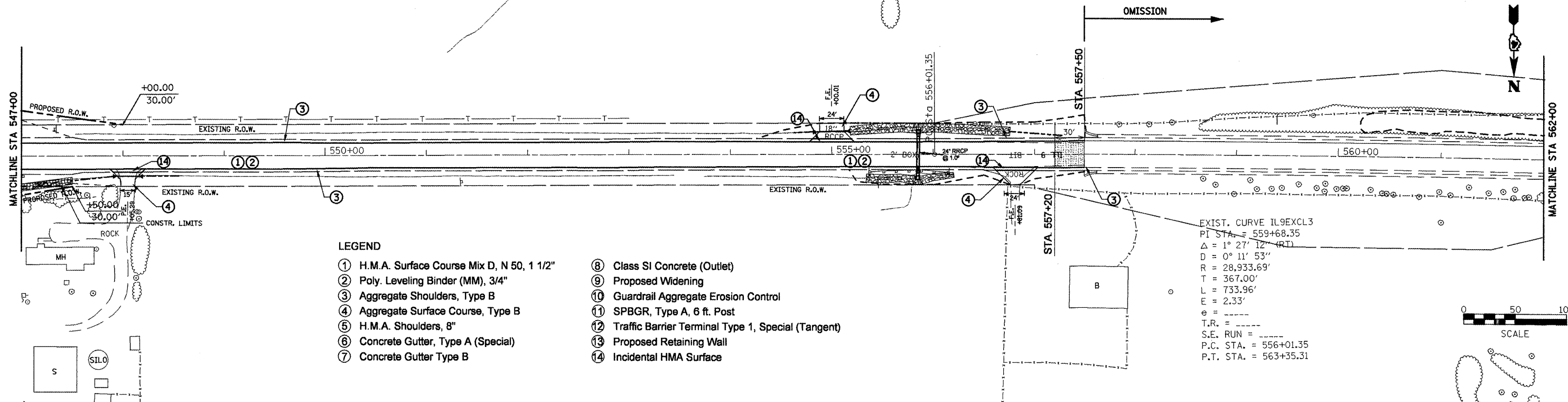

- LEGEND**
- ① H.M.A. Surface Course Mix D, N 50, 1 1/2"
  - ② Poly. Leveling Binder (MM), 3/4"
  - ③ Aggregate Shoulders, Type B
  - ④ Aggregate Surface Course, Type B
  - ⑤ H.M.A. Shoulders, 8"
  - ⑥ Concrete Gutter, Type A (Special)
  - ⑦ Concrete Gutter Type B
  - ⑧ Class SI Concrete (Outlet)
  - ⑨ Proposed Widening
  - ⑩ Guardrail Aggregate Erosion Control
  - ⑪ SPBGR, Type A, 6 ft. Post
  - ⑫ Traffic Barrier Terminal Type 1, Special (Tangent)
  - ⑬ Proposed Retaining Wall
  - ⑭ Incidental HMA Surface

EXIST. CURVE IL9EXCL3  
 PI STA. = 559+68.35  
 $\Delta = 1^\circ 27' 12''$  (RT)  
 $D = 0^\circ 11' 53''$   
 $R = 28,933.69'$   
 $T = 367.00'$   
 $L = 733.96'$   
 $E = 2.33'$   
 $\theta =$   
 $T.R. =$   
 $S.E. RUN =$   
 $P.C. STA. = 556+01.35$   
 $P.T. STA. = 563+35.31$

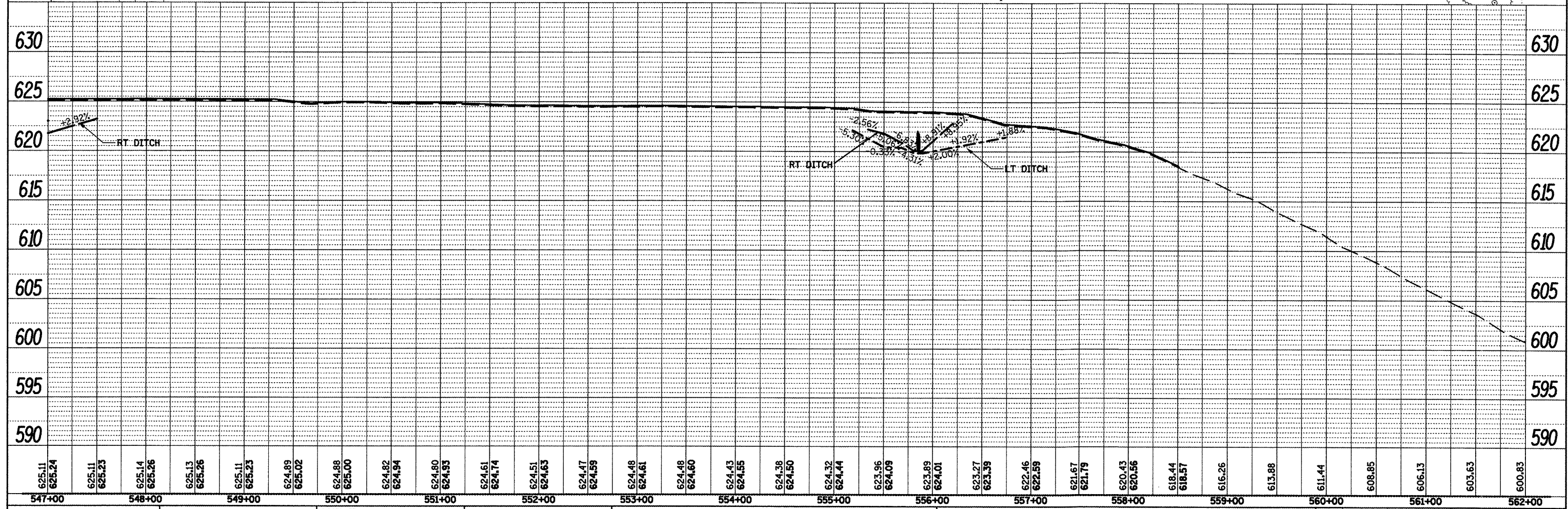

FILE NAME = Plan Sheets2.dgn	USER NAME = mendezpj	DESIGNED -	REVISED -	<b>STATE OF ILLINOIS DEPARTMENT OF TRANSPORTATION</b>	<b>DESIGN PLAN AND PROFILE</b>	F.A.P. RTE. 685	SECTION **	COUNTY *	TOTAL SHEETS 329	SHEET NO. 91	
PLT SCALE = 1/8" = 100.0000' / IN.	CHECKED -	REVISED -	REVISED -			CONTRACT NO. 68599		ILLINOIS FED. AID PROJECT			
PLT DATE = 3/25/2011	DATE -	REVISED -	REVISED -			SCALE:	SHEET NO. OF SHEETS	STA. TO STA.			
** (37,38)RS-3,39RS-5(38)I * Fulton, McDonough											