

Benchmark: Chisled "C" in N.W. Corner of East Headwall for Field Entrance, North side of IL Rt. 9, across from House #2416, Sta. ±431+36. Elev. 639.639.
 Chisled "C" on S.E. Corner of West Headwall for culvert under entrance to farm, South side of IL Rt. 9, across from Fredrick Rd., Sta. ±400+00. Elev. 636.291.
 Existing Structure: None

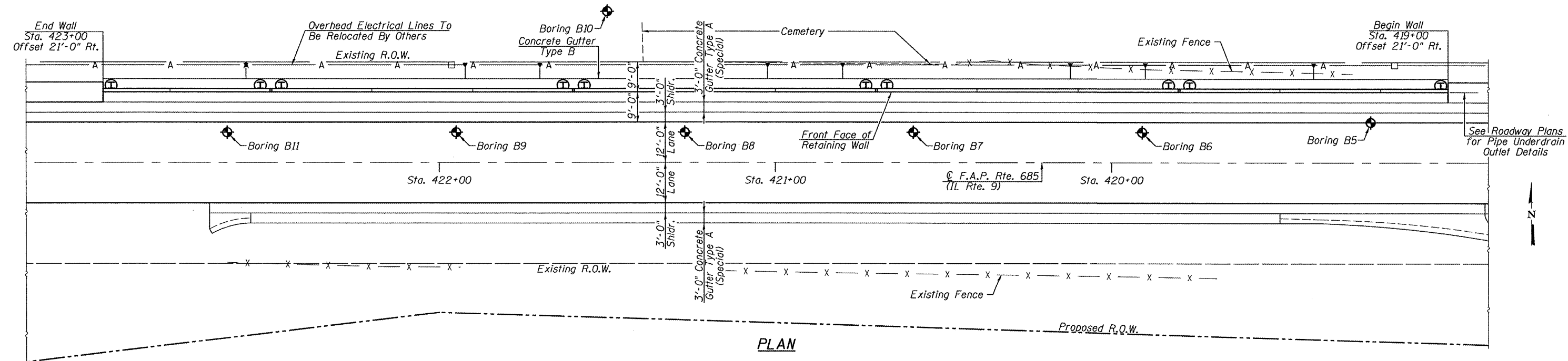

APPROVED
 For Structural Adequacy Only
D. Carl Prueger
 Engineer of Bridges & Structures

Date: 3/17/2011
 Seal: GERALD B. ROTHBAM, 081-005673, LICENSED STRUCTURAL ENGINEER, STATE OF ILLINOIS, Expiration: 4/30/2012
Gerald B. Rothbam

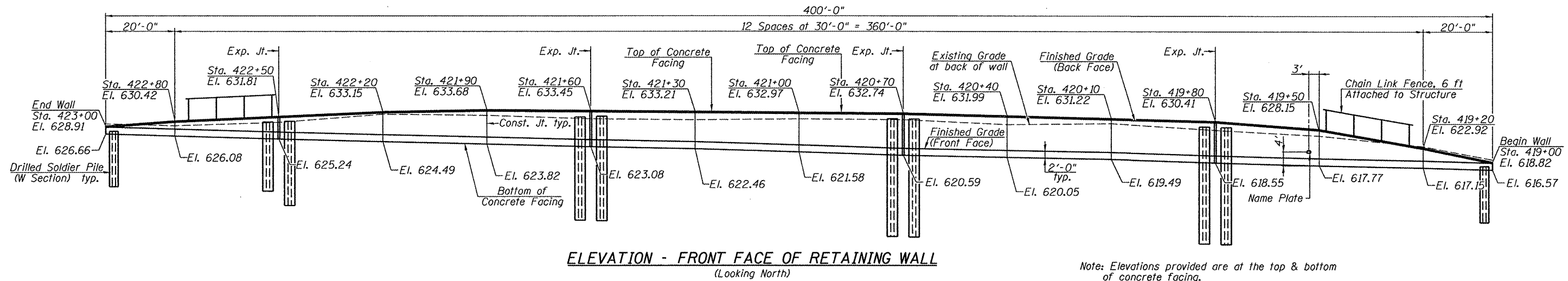
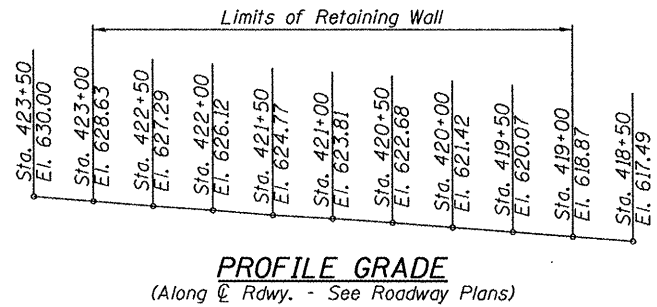

DESIGN SPECIFICATIONS
 2002 AASHTO
DESIGN STRESSES
 FIELD UNITS
 f'c = 3,500 psi
 fy = 60,000 psi (Reinforcement)
 ty = 36,000 psi (M270 Grade 36)

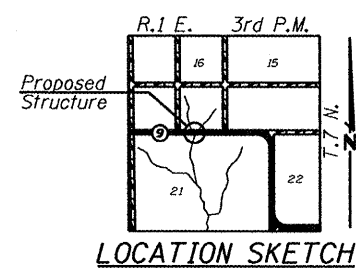

GENERAL PLAN
 RETAINING WALL
 ALONG IL ROUTE 9
 F.A.P. RTE. 685
 SECTION (37.38) RS-3, 39RS-5
 FULTON COUNTY
 STA. 419+00 TO STA. 423+00
 STRUCTURE NO. 029-8505

FILE NAME =	USER NAME =	DESIGNED -	REVISED -	Allen Henderson & Associates, Inc. Civil and Structural Engineers Springfield, IL 62703 Phone: (217)544-8033 IL Design Firm No. 184-001907	GENERAL PLAN SHEET NO. 1 OF 12 SHEETS	F.A.P. RTE. 685	SECTION (37,38) RS-3, 39RS-5	COUNTY FULTON	TOTAL SHEETS 329	SHEET NO. 157
PLDT SCALE =	DRAWN -	REVISED -	CONTRACT NO. 68599			[ILLINOIS] FED. AID PROJECT				
PLDT DATE =	CHECKED -	REVISED -								