

PROPOSED RIGHT OF WAY LINE
 EXISTING RIGHT OF WAY LINE
 PROPOSED TEMPORARY EASEMENT LINE

Section 19 T 7 N R 2 E 4th P.M.

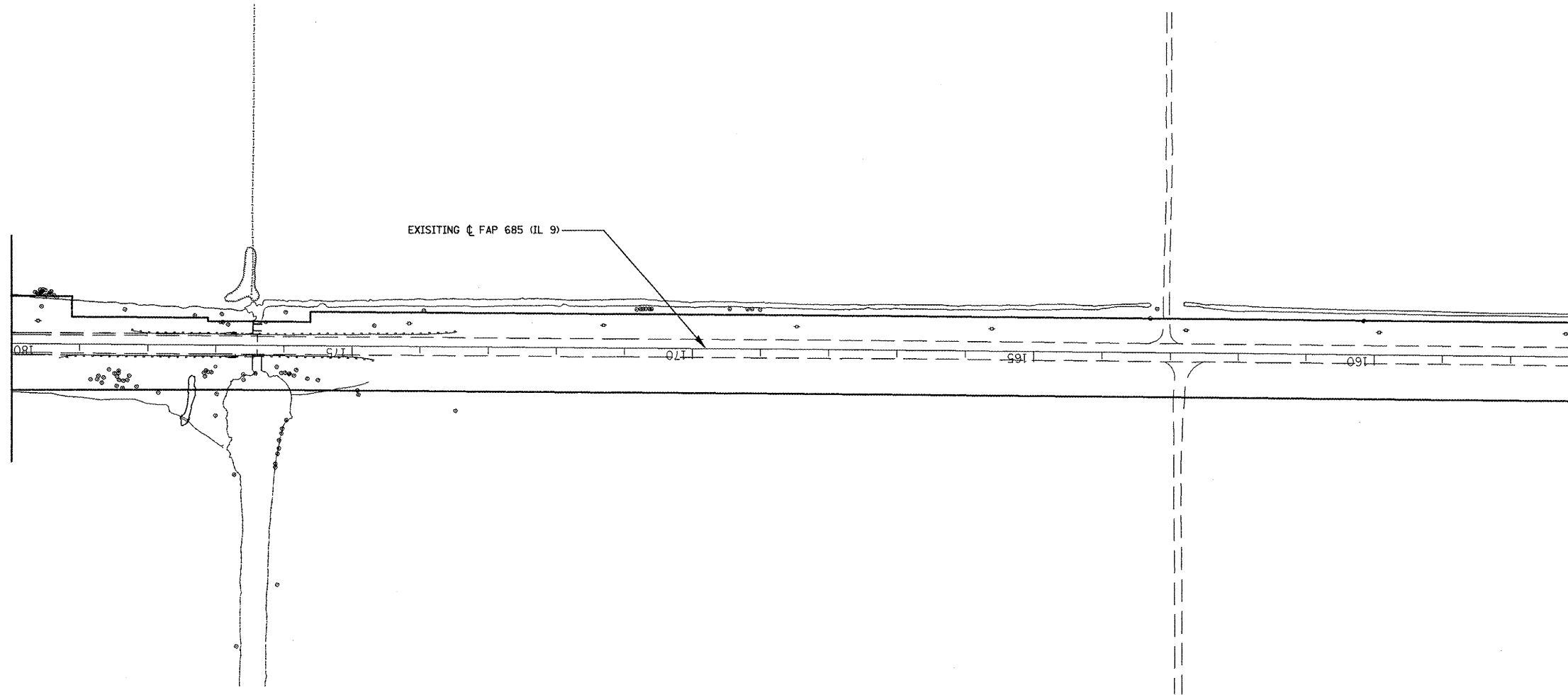

Section 30 T 7 N R 2 E 4th P.M.

FOR OLD R.O.W. SEE:
 PLANFILE 5 SHEETS 37, 37H, 37I
 Plat File: 39

FILE NAME = s10/s19.m32	USER NAME = crespole	DESIGNED - PCF	REVISED -
		DRAWN - MLA	REVISED -
		CHECKED - PCF	REVISED -
		DATE - 01-2011	REVISED -

**STATE OF ILLINOIS
 DEPARTMENT OF TRANSPORTATION**

RIGHT OF WAY PLANS			
SCALE: 1"=100'	SHEET NO.	OF SHEETS	STA. 157+00.00 TO STA. 180+00.00

F.A.P. RTE. 685	SECTION **	COUNTY *	TOTAL SHEETS 329	SHEET NO. 175
Cat.# 032750-02		CONTRACT NO. 68599		
ILLINOIS FED. AID PROJECT				

•• (37,38)RS-3,39RS-5(38) • Fulton, McDonough