

EXIST. CURVE 1W-1  
 P.I. STA. = 1482+87.30  
 P.L. STA. = 1482+26" (RT)  
 $\Delta = 5^{\circ} 00' 00''$   
 $R = 1,145.91'$   
 $T = 828.09'$   
 $L = 1,434.14'$   
 $E = 267.89'$   
 $\theta =$   
 I.R. RUN = 1474+59.21  
 S.E. STA. = 1488+93.35  
 P.C. STA. = 1488+93.35  
 P.T. STA. =

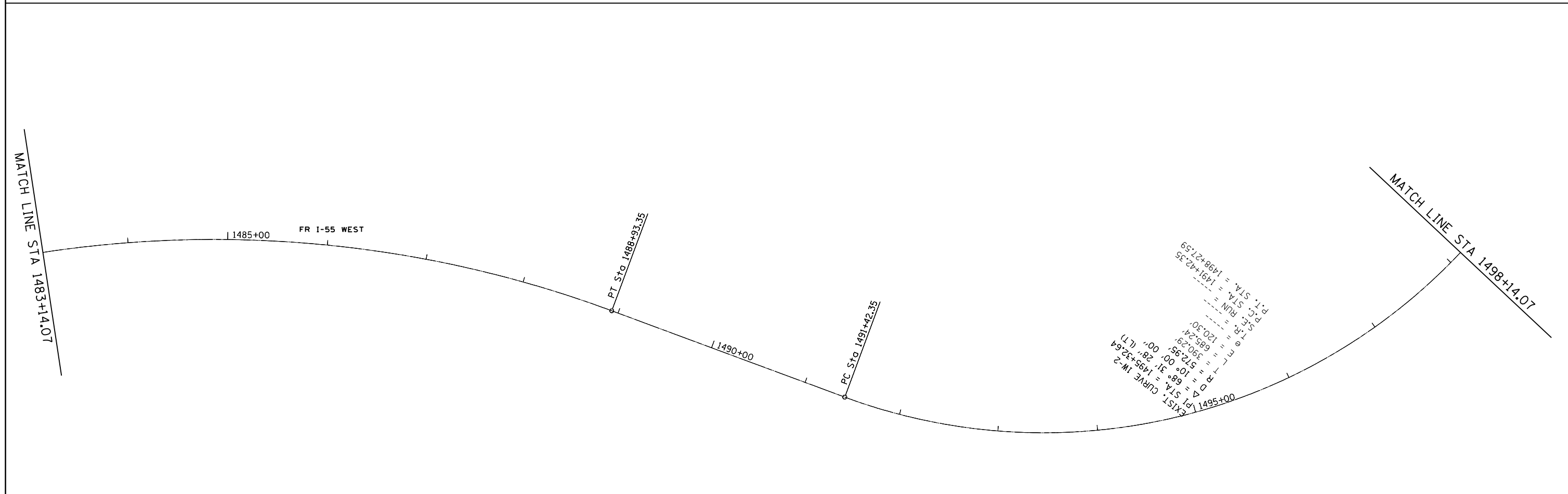

EXIST. CURVE 1W-2  
 P.I. STA. = 1495+32.64  
 P.L. STA. = 1495+28" (LT)  
 $\Delta = 10^{\circ} 00' 00''$   
 $R = 572.98'$   
 $T = 397.29'$   
 $L = 685.24'$   
 $E = 120.30'$   
 $\theta =$   
 I.R. RUN = 1491+42.35  
 S.E. STA. = 1498+27.59  
 P.C. STA. = 1498+27.59  
 P.T. STA. =

FILE NAME =	USER NAME = Sparksgw	DESIGNED -	REVISED -
c:\pwwork\pwwork\sparksgw\10229974\10672093-sht-plan41.dgn		DRAWN -	REVISED -
PLOT SCALE = 100.0000' / in.		CHECKED -	REVISED -
PLOT DATE = Apr-26-2011 11:02:02AM		DATE -	REVISED -

**STATE OF ILLINOIS  
 DEPARTMENT OF TRANSPORTATION**

**PLAN SHEET**

SCALE:      SHEET NO.      OF      SHEETS      STA.      TO      STA.

F.A.S. RTE.	SECTION	COUNTY	TOTAL SHEETS	SHEET NO.
1741	1120	MONTGOMERY	24	13
CONTRACT NO. 72D93				
ILLINOIS FED. AID PROJECT				